

LASER PEGS®

The Ultimate Toy For Kids®

MPS 100 AIRCRAFT

For Boys And Girls
Ages 5 And Up

4 Models+
Any creation you can build

LIGHTED
CONSTRUCTION SET INCLUDES:

- 2 Laser Pegs®
- 37 Construction Parts
- Mobile Power Source
- Instruction Manual

Batteries
Included



EN71, RoHS COMPLIANT
This product complies to all safety
requirements of ASTM F 963

MODEL INSTRUCTIONS

All additional model instructions can be
downloaded at www.LaserPegs.com

Laser Pegs® Parts List

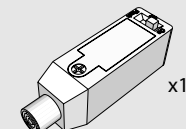

x1

MPS
MOBILE POWER SOURCE

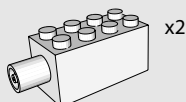

x2

STACKABLE



Laser Pegs® Stackable

Laser Pegs® link that allows you to
connect to other construction kits.

Construction Parts List

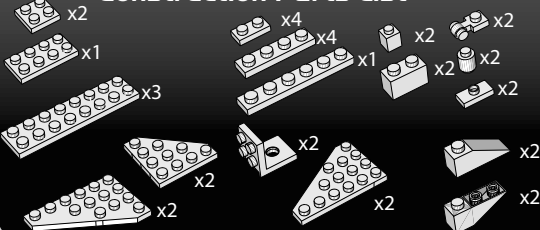

www.LaserPegs.com

This manual is copyright and cannot be reproduced or used online without Laser Pegs® Ventures LLC permission. Copyright 2013 © All Rights Reserved US Patent #7,731,558 Additional Global & Multiple Patents Pending. Laser Pegs® Ventures LLC, 8304 Consumer Ct., Sarasota FL, 34240. Contact: Support@LaserPegs.com

Connecting Pegs

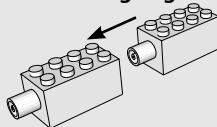

Construction Compatible

To construct with Laser Pegs®, slide two
pieces together to form a connection.
Slide each piece on and off smoothly.

Slide Power Switch to turn on/off/flash

Slide Power Switch to cycle
through different
light settings.

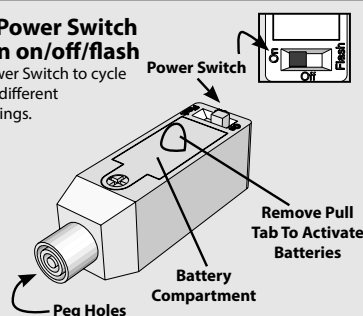

*To avoid short-circuits, keep metal objects and other
unauthorized materials from obstructing the peg holes.

Please dispose of batteries properly as per state and local regulations.

Replacing Batteries

1. Remove the Phillips head screw.
2. Remove the Battery Compartment Cover.
3. Place three LR 44 batteries in the correct position.
(Batteries are to be inserted with the correct polarity).
4. Replace the Battery Compartment Cover.
5. Replace the Phillips head screw.
6. Slide Power Switch to turn on!
7. Do not mix old and new batteries.
8. Do not mix alkaline, standard (carbon-zinc), or
rechargeable (nickel-cadmium, NiMH) batteries!
9. Exhausted batteries are to be removed from the power
base.
10. Never connect more than 4 Laser Pegs®
11. Non-rechargeable batteries are not to be recharged.
12. Rechargeable batteries are only to be recharged under
adult supervision.
13. Rechargeable batteries are to be removed from the toy
before being recharged.
14. The supply terminals are not to be short-circuited.
15. DO NOT THROW BATTERIES INTO FIRE!

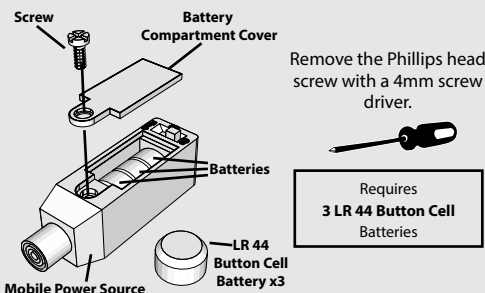

Remove the Phillips head
screw with a 4mm screw
driver.

Requires
3 LR 44 Button Cell
Batteries

WARNING! Each Laser Peg® draws current from the batteries. Therefore,
the more pegs you use, the quicker you will deplete your battery power! As
the power weakens, the current will slowly fail and some Laser Pegs® will
illuminate (typically the reds and yellows) and some won't. When the Laser
Pegs® dim, the Laser Pegs® are not broken, they just need stronger batteries.
You have 3 simple options...

1. Change the batteries.
2. Use high quality batteries. They will last a little longer, but they will still
deplete rapidly the more Laser Pegs® you connect!

CARGO TRANSPORT: A large, strong aircraft used to carry heavy
materials.



CARGO TRANSPORT

Model
Difficulty
Level

2

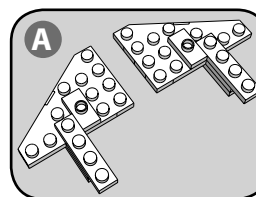
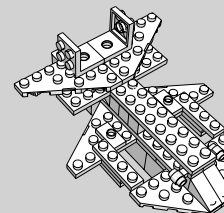

STEP

1

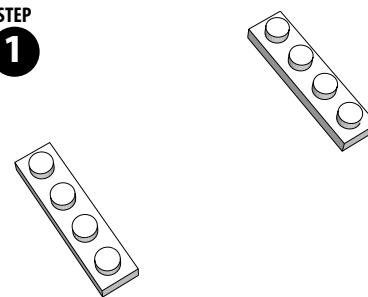

STEP

2

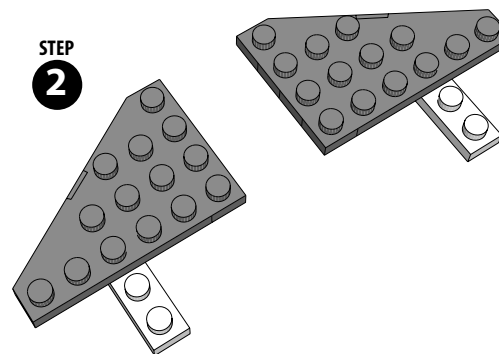

Environmental Phenomena

* The unit may malfunction if subjected to radio-frequency interference. It SHOULD revert to normal operation when the interference stops. If
not, it may become necessary to turn the power off and back on, or remove and reinstall the batteries. * In the unlikely event of an electrostatic
discharge, the unit may malfunction and lose memory, requiring the user to reset the device by removing and reinstalling the batteries.

STEP

3

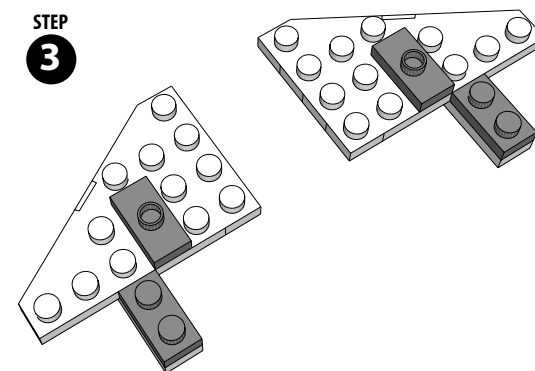

STEP

4

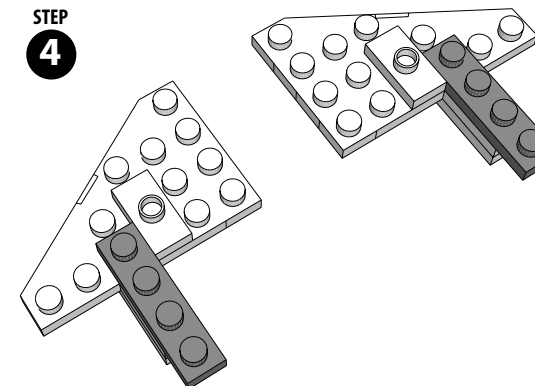

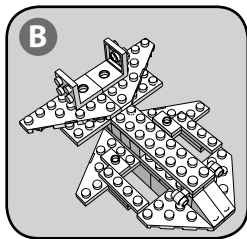

STEP
5

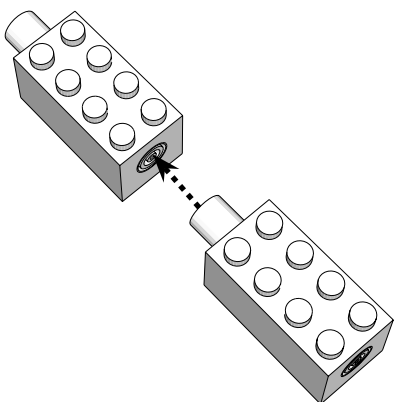

STEP
6

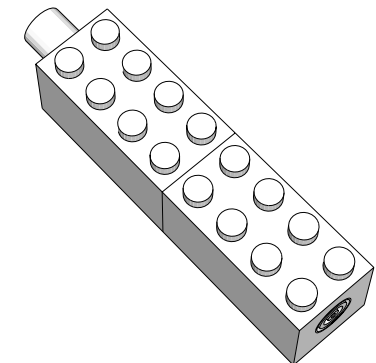

STEP
7

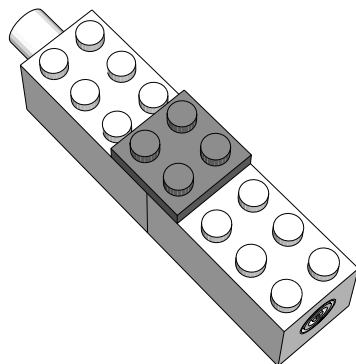

STEP
8

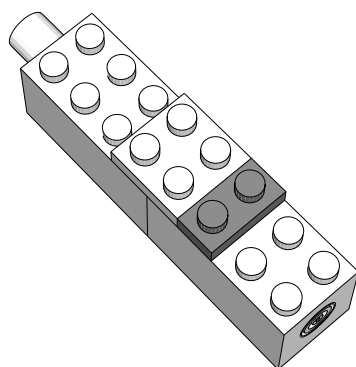

STEP
9

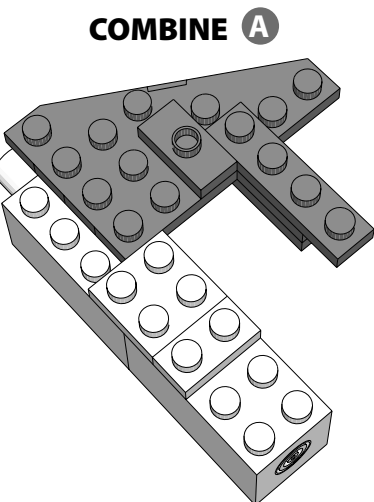

STEP
10

COMBINE A

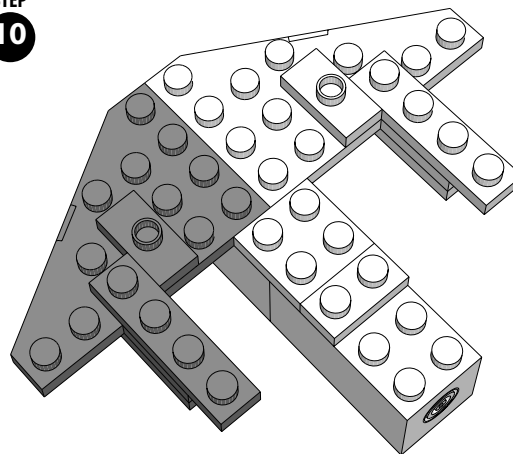

STEP
11

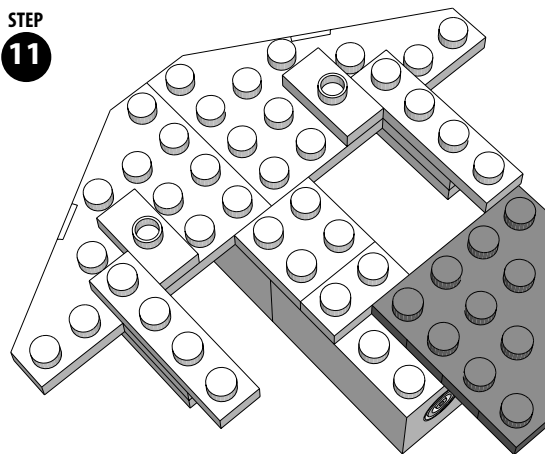

STEP
12

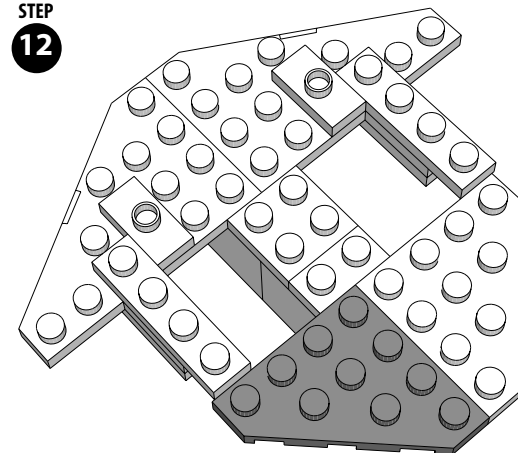

STEP
13

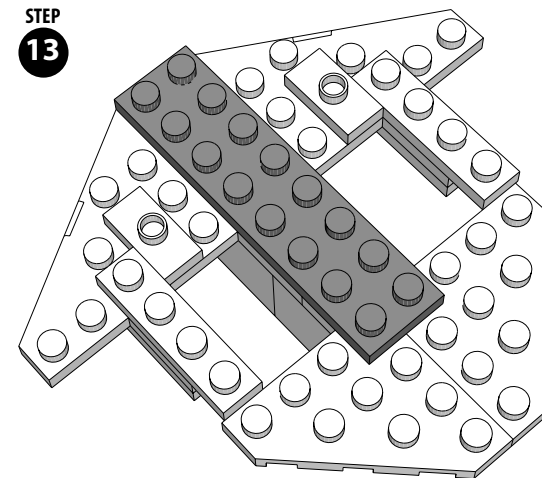

STEP
14

ATTACH THE
MOBILE POWER
SOURCE

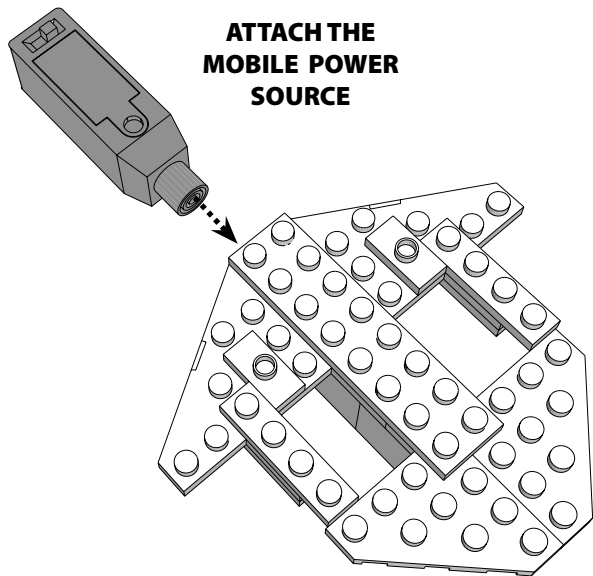

STEP
16

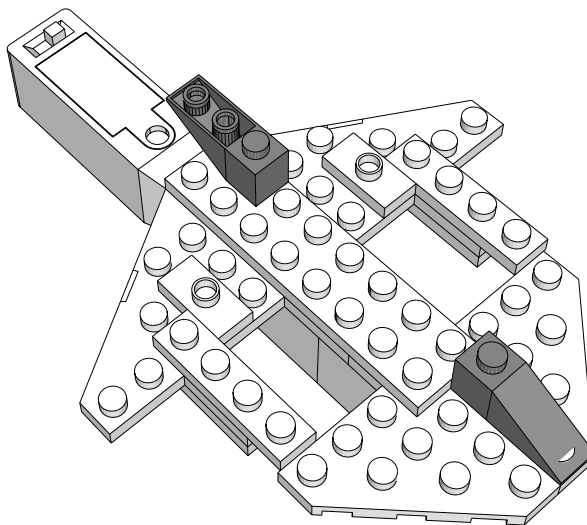

STEP
18

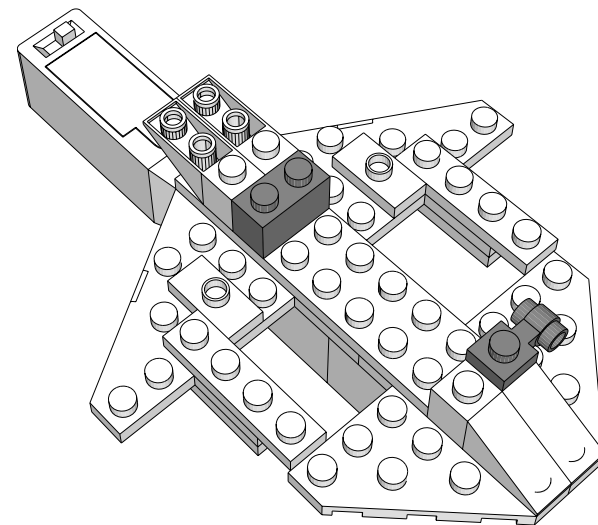

STEP
15

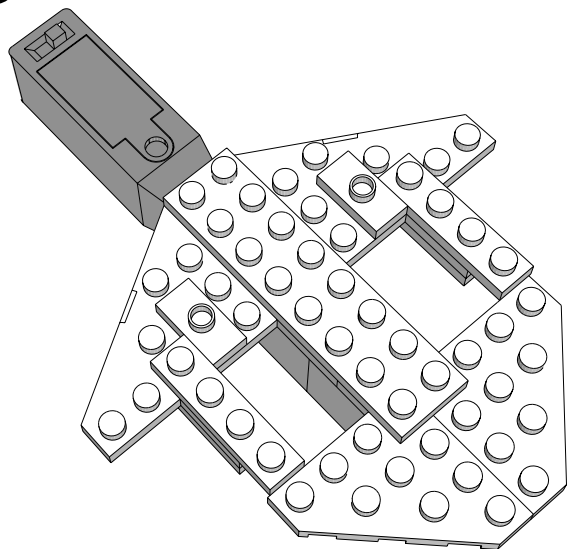

STEP
17

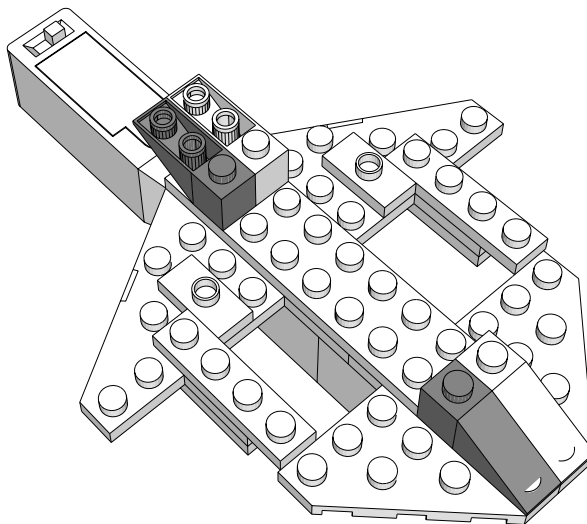

STEP
19

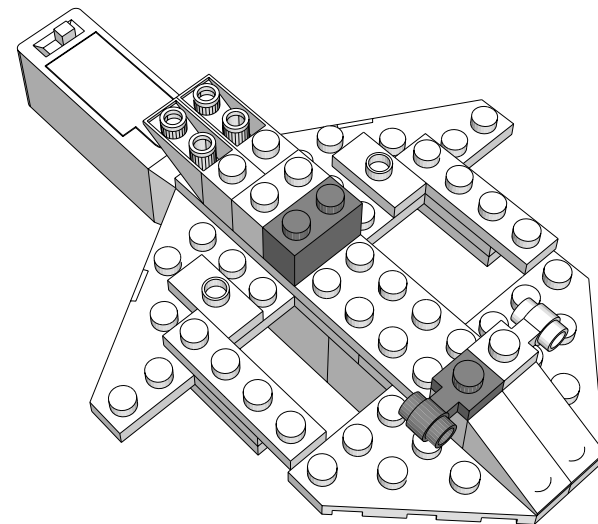

STEP
20

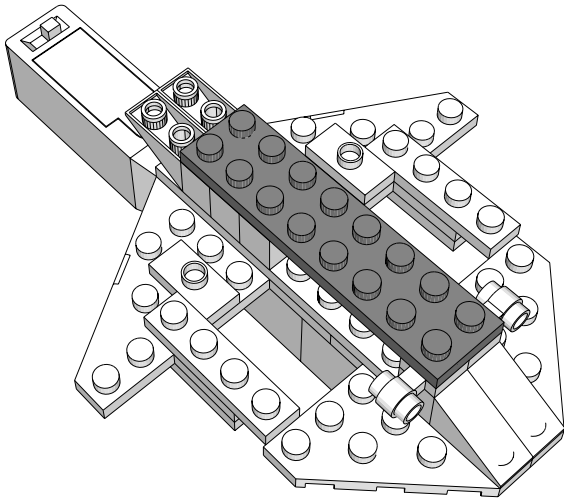

STEP
21

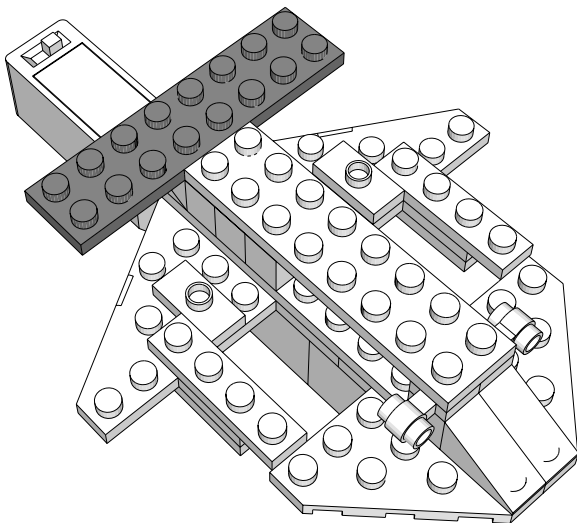

STEP
22

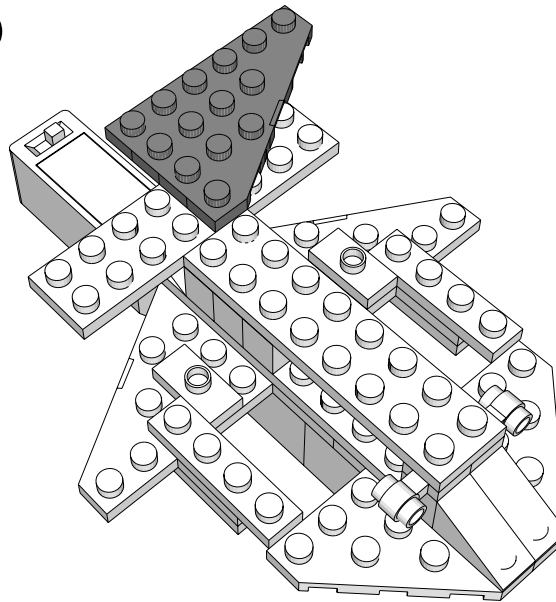

STEP
23

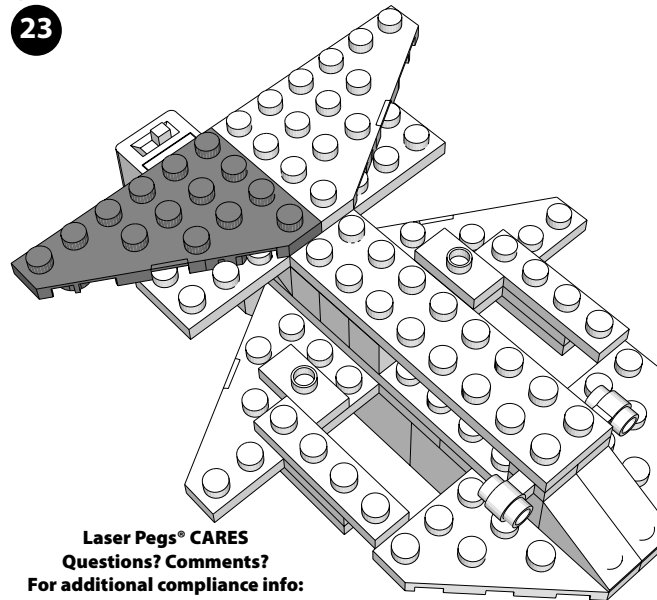

Laser Pegs® CARES
Questions? Comments?
For additional compliance info:
1-866-432-3735
Contact: Support@LaserPegs.com

STEP
24

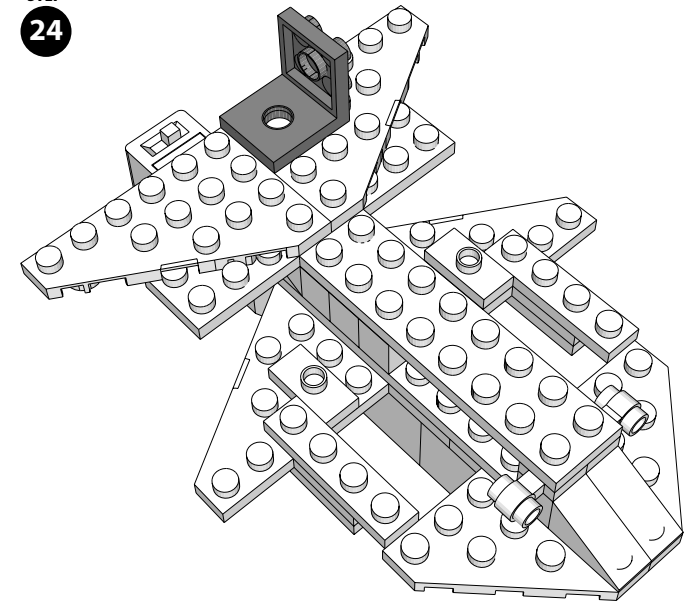

STEP
25

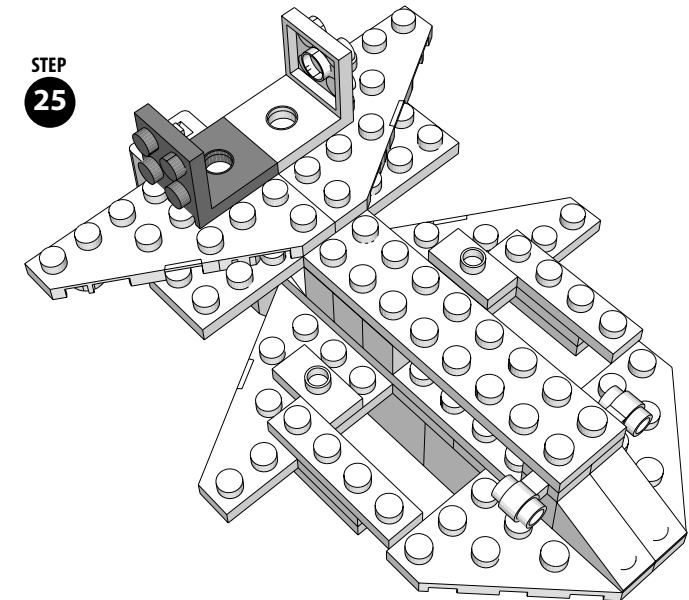

www.LaserPegs.com
Copyright 2013 © All Rights Reserved Global & Multiple Patents Pending.
US Patent #7,731,558
MADE IN CHINA

LASER PEGS®

The Ultimate Toy For Kids®

MPS 100 AIRCRAFT

For Boys And Girls
Ages 5 And Up

4 Models+
Any creation you can build

LIGHTED CONSTRUCTION SET INCLUDES:

- 2 Laser Pegs®
- 37 Construction Parts
- Mobile Power Source
- Instruction Manual

Batteries
Included



EN71, RoHS COMPLIANT
This product complies to all safety
requirements of ASTM F 963

MODEL INSTRUCTIONS

All additional model instructions can be
downloaded at www.LaserPegs.com

Laser Pegs® Parts List

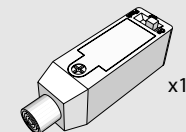

x1

MPS
MOBILE POWER SOURCE

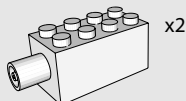

x2

STACKABLE



Laser Pegs® Stackable

Laser Pegs® link that allows you to
connect to other construction kits.

Construction Parts List

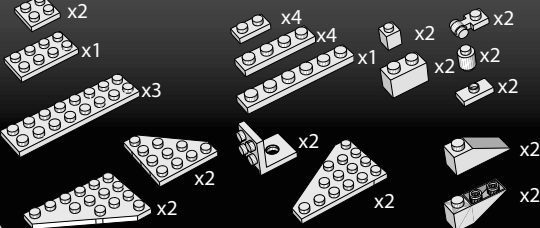

www.LaserPegs.com

This manual is copyright and cannot be reproduced or used online without Laser Pegs® Ventures LLC permission. Copyright 2013 © All Rights Reserved US Patent #7,731,558 Additional Global & Multiple Patents Pending. Laser Pegs® Ventures LLC, 8304 Consumer Ct., Sarasota FL, 34240. Contact: Support@LaserPegs.com

Connecting Pegs

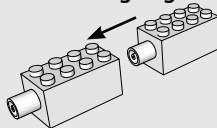

Construction Compatible

To construct with Laser Pegs®, slide two
pieces together to form a connection.
Slide each piece on and off smoothly.

Slide Power Switch to turn on/off/flash

Slide Power Switch to cycle
through different
light settings.

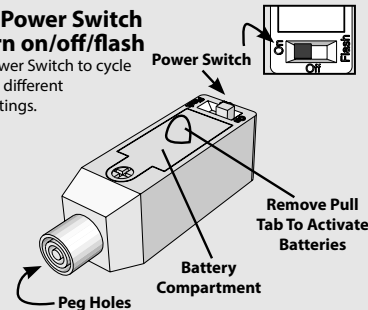

*To avoid short-circuits, keep metal objects and other
unauthorized materials from obstructing the peg holes.

Please dispose of batteries properly as per state and local regulations.

Replacing Batteries

1. Remove the Phillips head screw.
2. Remove the Battery Compartment Cover.
3. Place three LR 44 batteries in the correct position.
(Batteries are to be inserted with the correct polarity).
4. Replace the Battery Compartment Cover.
5. Replace the Phillips head screw.
6. Slide Power Switch to turn on!
7. Do not mix old and new batteries.
8. Do not mix alkaline, standard (carbon-zinc), or
rechargeable (nickel-cadmium, NiMH) batteries!
9. Exhausted batteries are to be removed from the power
base.
10. Never connect more than 4 Laser Pegs®
11. Non-rechargeable batteries are not to be recharged.
12. Rechargeable batteries are only to be recharged under
adult supervision.
13. Rechargeable batteries are to be removed from the toy
before being recharged.
14. The supply terminals are not to be short-circuited.
15. DO NOT THROW BATTERIES INTO FIRE!

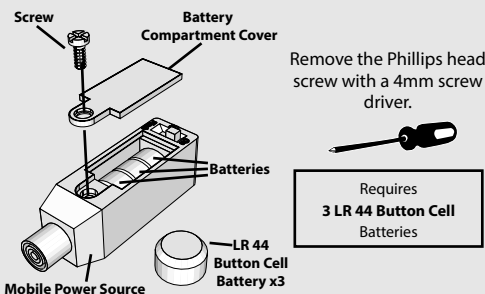

WARNING! Each Laser Peg® draws current from the batteries. Therefore,
the more pegs you use, the quicker you will deplete your battery power! As
the power weakens, the current will slowly fail and some Laser Pegs® will
illuminate (typically the reds and yellows) and some won't. When the Laser
Pegs® dim, the Laser Pegs® are not broken, they just need stronger batteries.
You have 3 simple options...

1. Change the batteries.
2. Use high quality batteries. They will last a little longer, but they will still
deplete rapidly the more Laser Pegs® you connect!

LIGHT BOMBER: A fast, military aircraft created to carry and drop
explosive devices.



LIGHT BOMBER

Model
Difficulty
Level

2

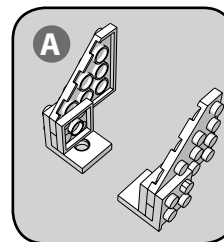
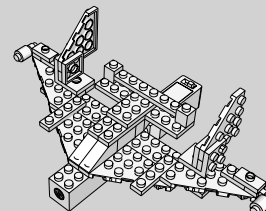

STEP
1

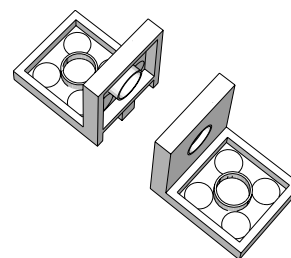

STEP
2

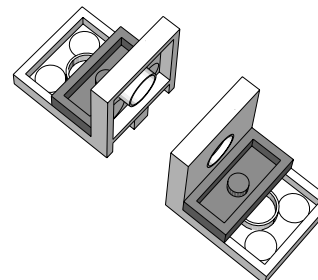

STEP
3

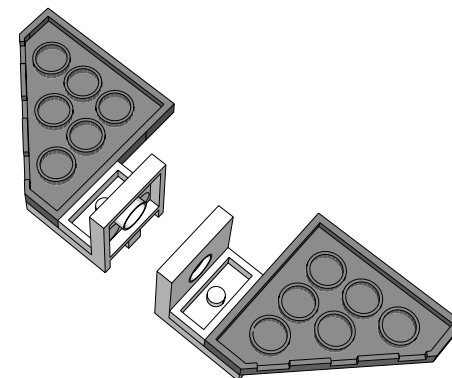

STEP
4

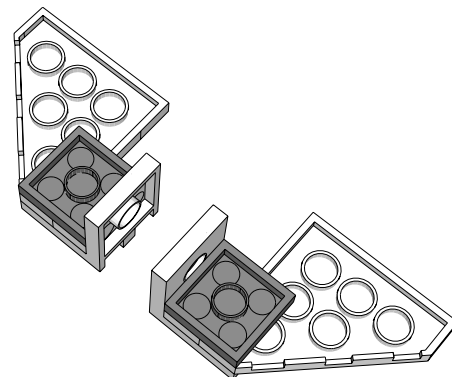

B

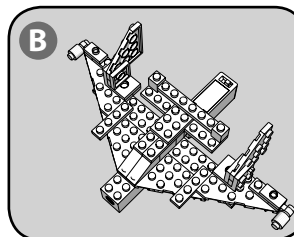

STEP
5

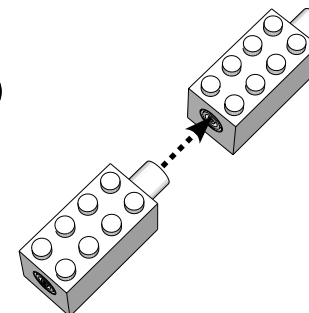

Environmental Phenomena

*The unit may malfunction if subjected to radio-frequency interference. It SHOULD revert to normal operation when the interference stops. If
not, it may become necessary to turn the power off and back on, or remove and reinstall the batteries. * In the unlikely event of an electrostatic
discharge, the unit may malfunction and lose memory, requiring the user to reset the device by removing and reinstalling the batteries.

STEP
6

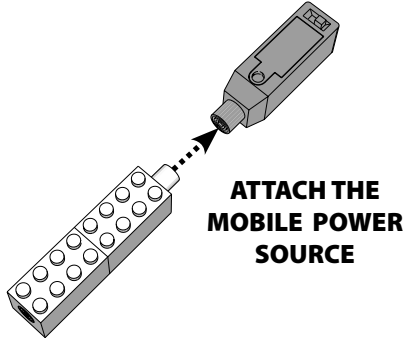

STEP
7

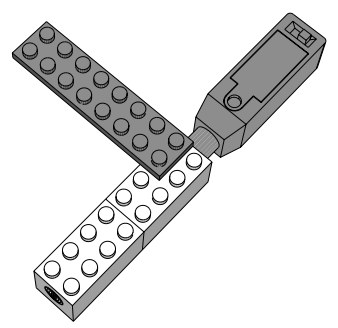

STEP
8

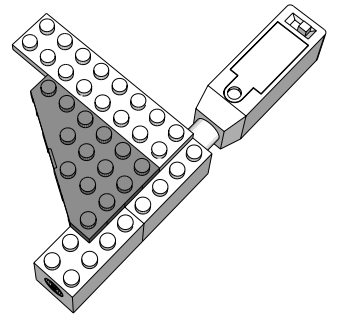

STEP
9

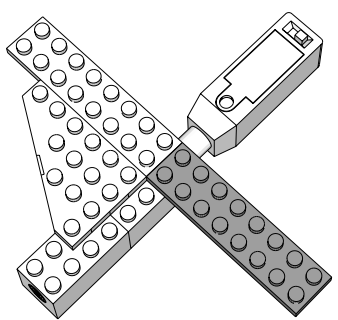

STEP
10

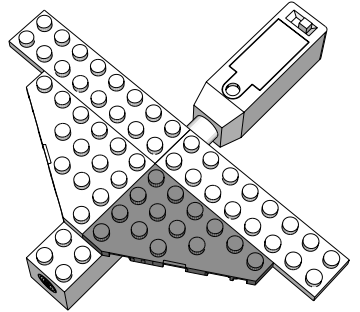

STEP
11

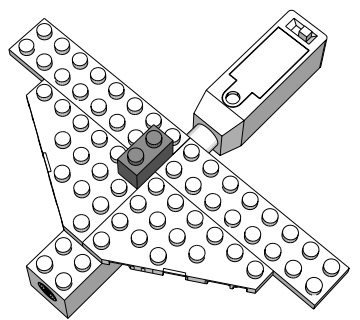

STEP
12

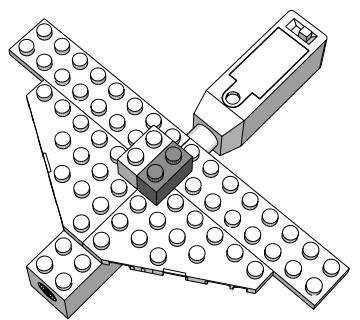

STEP
13

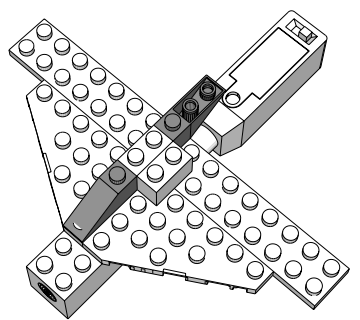

STEP
14

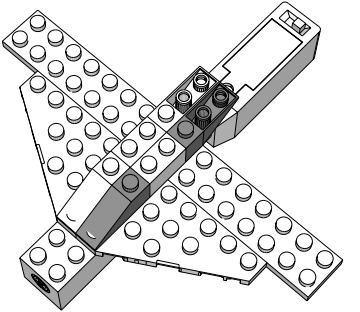

STEP
15

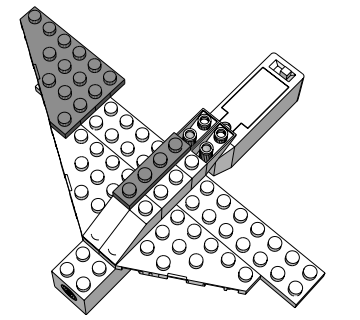

STEP
16

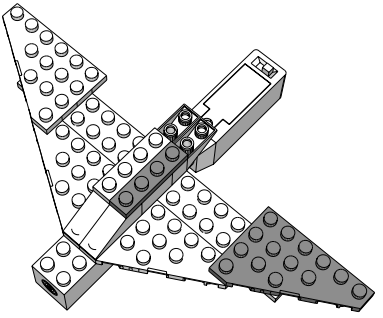

STEP
17

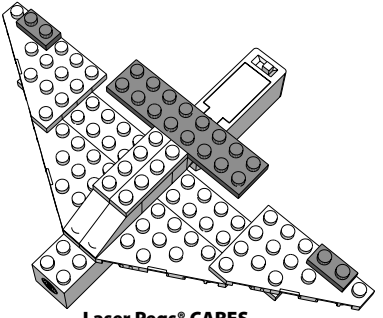

STEP
18

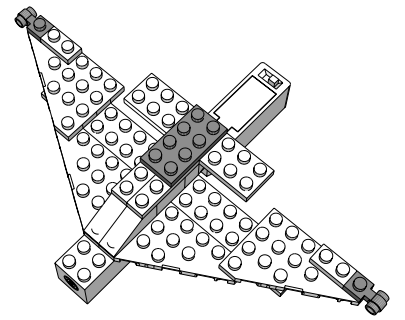

STEP
19

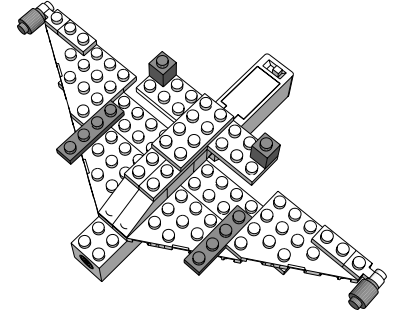

STEP
20

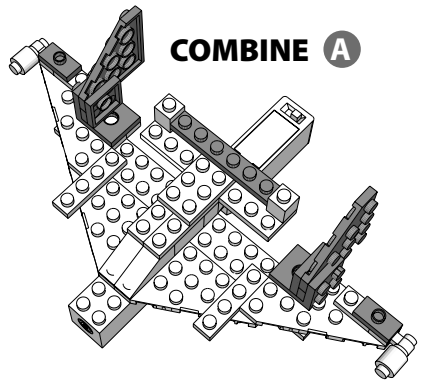

STEP
21

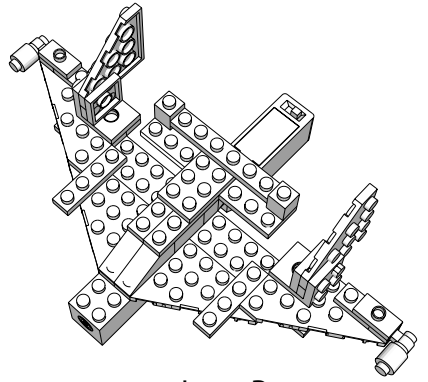

Laser Pegs® CARES
Questions? Comments?
For additional compliance info:
1-866-432-3735
Contact: Support@LaserPegs.com

www.LaserPegs.com
Copyright 2013 © All Rights Reserved Global & Multiple Patents Pending.
US Patent #7,731,558
MADE IN CHINA

LASER PEGS®

The Ultimate Toy For Kids®

MPS 100 AIRCRAFT

For Boys And Girls
Ages 5 And Up

4 Models+
Any creation you can build

LIGHTED CONSTRUCTION SET INCLUDES:

- 2 Laser Pegs®
- 37 Construction Parts
- Mobile Power Source
- Instruction Manual

Batteries
Included



EN71, RoHS COMPLIANT
This product complies to all safety
requirements of ASTM F 963

MODEL INSTRUCTIONS

All additional model instructions can be
downloaded at www.LaserPegs.com

Laser Pegs® Parts List

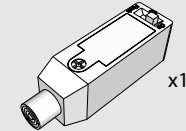

x1

MPS
MOBILE POWER SOURCE

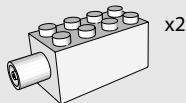

x2

STACKABLE



Laser Pegs® Stackable

Laser Pegs® link that allows you to
connect to other construction kits.

Construction Parts List

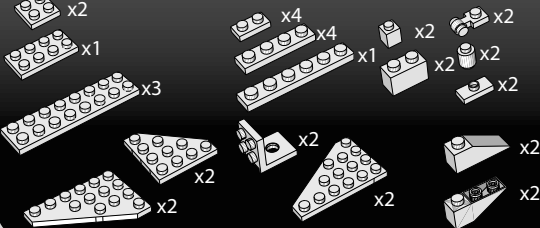

www.LaserPegs.com

This manual is copyright and cannot be reproduced or used online without Laser Pegs® Ventures LLC permission. Copyright 2013 © All Rights Reserved US Patent #7,731,558 Additional Global & Multiple Patents Pending. Laser Pegs® Ventures LLC, 8304 Consumer Ct., Sarasota FL, 34240. Contact: Support@LaserPegs.com

Connecting Pegs

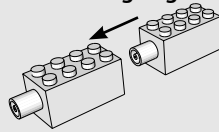

Construction Compatible

To construct with Laser Pegs®, slide two
pieces together to form a connection.
Slide each piece on and off smoothly.

Slide Power Switch to turn on/off/flash

Slide Power Switch to cycle
through different
light settings.

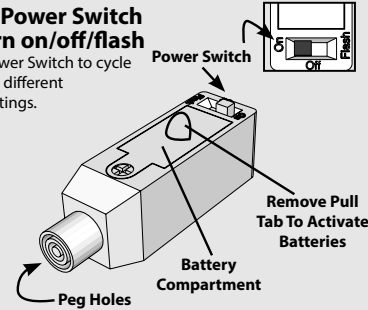

*To avoid short-circuits, keep metal objects and other
unauthorized materials from obstructing the peg holes.

Please dispose of batteries properly as per state and local regulations.

Replacing Batteries

1. Remove the Phillips head screw.
2. Remove the Battery Compartment Cover.
3. Place three LR 44 batteries in the correct position.
(Batteries are to be inserted with the correct polarity).
4. Replace the Battery Compartment Cover.
5. Replace the Phillips head screw.
6. Slide Power Switch to turn on!
7. Do not mix old and new batteries.
8. Do not mix alkaline, standard (carbon-zinc), or
rechargeable (nickel-cadmium, NiMH) batteries!
9. Exhausted batteries are to be removed from the power
base.
10. Never connect more than 4 Laser Pegs®
11. Non-rechargeable batteries are not to be recharged.
12. Rechargeable batteries are only to be recharged under
adult supervision.
13. Rechargeable batteries are to be removed from the toy
before being recharged.
14. The supply terminals are not to be short-circuited.
15. DO NOT THROW BATTERIES INTO FIRE!

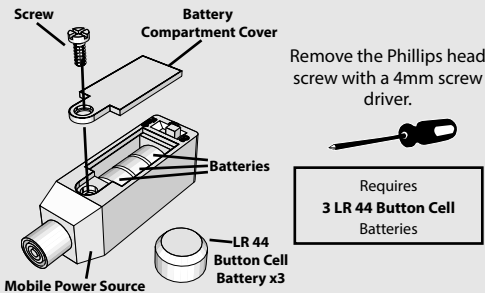

Requires
3 LR 44 Button Cell
Batteries

WARNING! Each Laser Peg® draws current from the batteries. Therefore,
the more pegs you use, the quicker you will deplete your battery power! As
the power weakens, the current will slowly fail and some Laser Pegs® will
illuminate (typically the reds and yellows) and some won't. When the Laser
Pegs® dim, the Laser Pegs® are not broken, they just need stronger batteries.
You have 3 simple options...

1. Change the batteries.
2. Use high quality batteries. They will last a little longer, but they will still
deplete rapidly the more Laser Pegs® you connect!

LIGHT GLIDER: A lightweight airplane able to fly long distances
without an engine.



LIGHT GLIDER

Model
Difficulty
Level

2

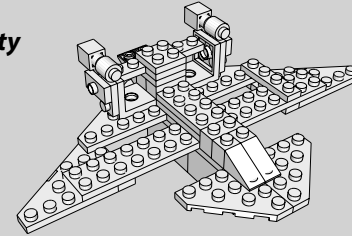

A

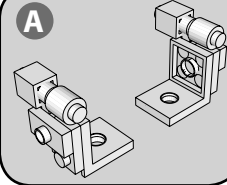

STEP
1

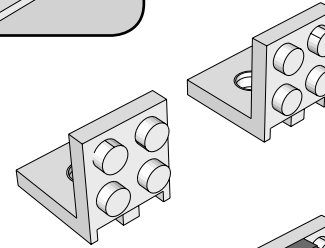

STEP
2

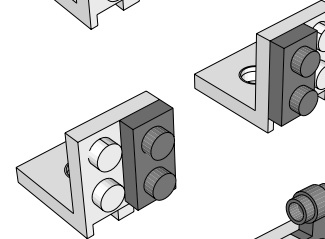

STEP
3

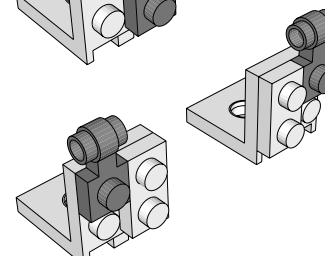

STEP
4

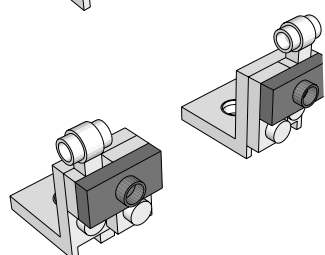

STEP
5

ROTATE

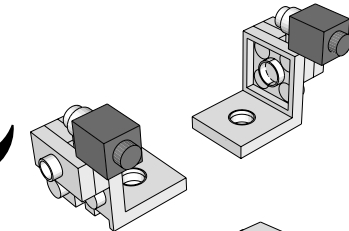

STEP
6

ROTATE

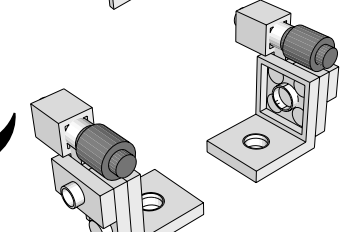

STEP
7

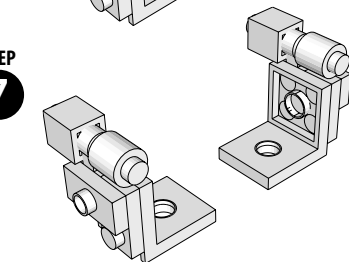

B

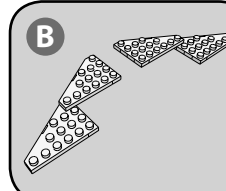

STEP
8

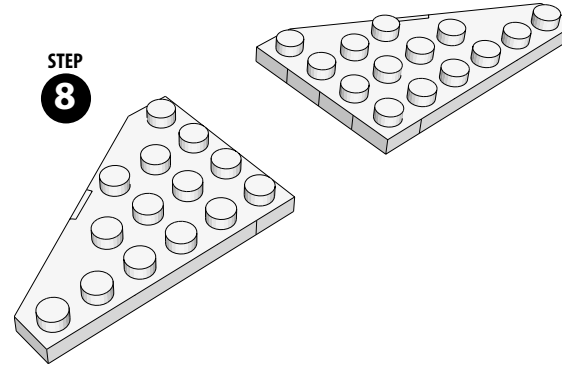

STEP
9

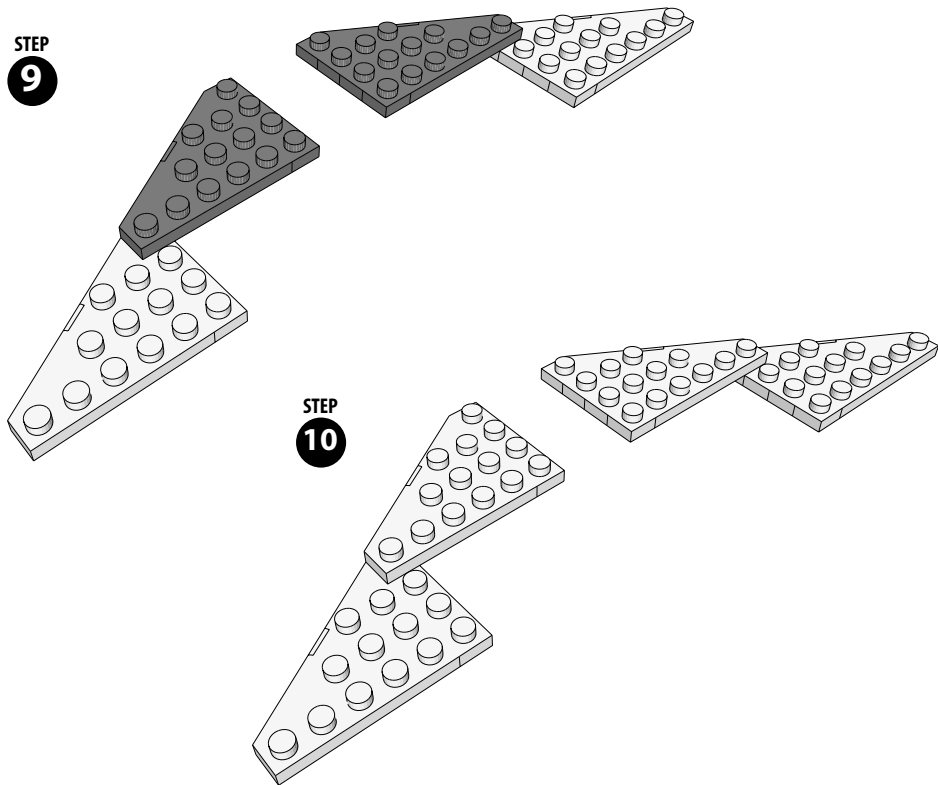

STEP
10

STEP
14

COMBINE

B

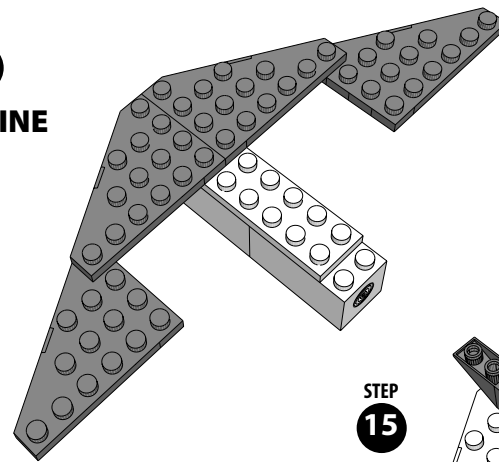

STEP
15

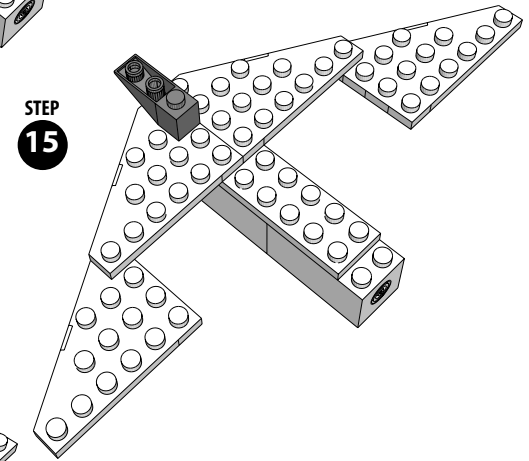

STEP
16

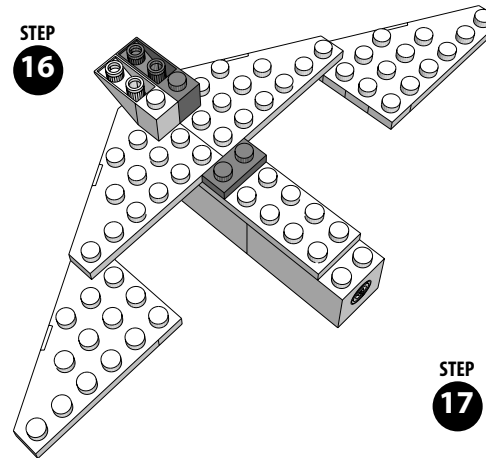

STEP
17

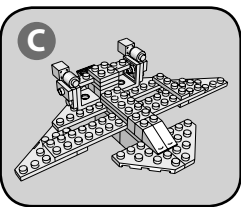
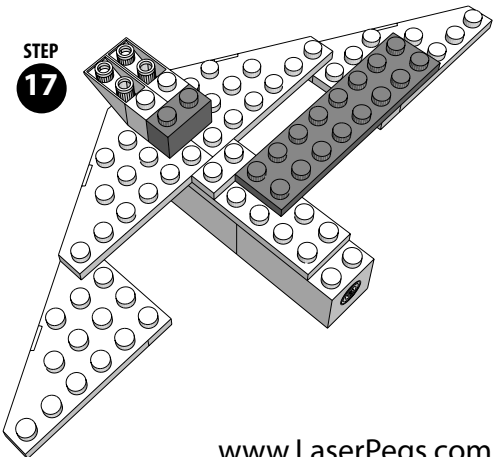

STEP
11

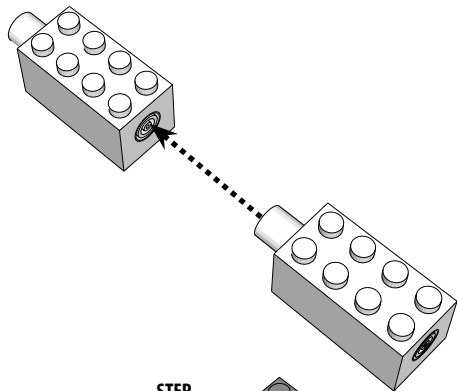

STEP
12

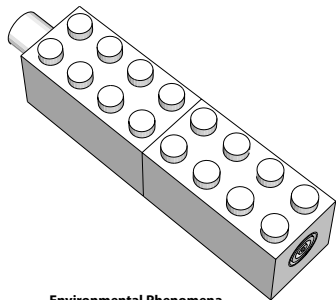

STEP
13

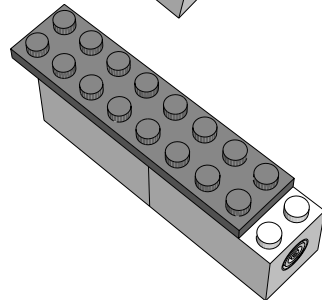

Environmental Phenomena

* The unit may malfunction if subjected to radio-frequency interference. It SHOULD revert to normal operation when the interference stops. If not, it may become necessary to turn the power off and back on, or remove and reinstall the batteries. * In the unlikely event of an electrostatic discharge, the unit may malfunction and lose memory, requiring the user to reset the device by removing and reinstalling the batteries.

www.LaserPegs.com

Copyright 2013 © All Rights Reserved Global & Multiple Patents Pending.
US Patent #7,731,558

18

A

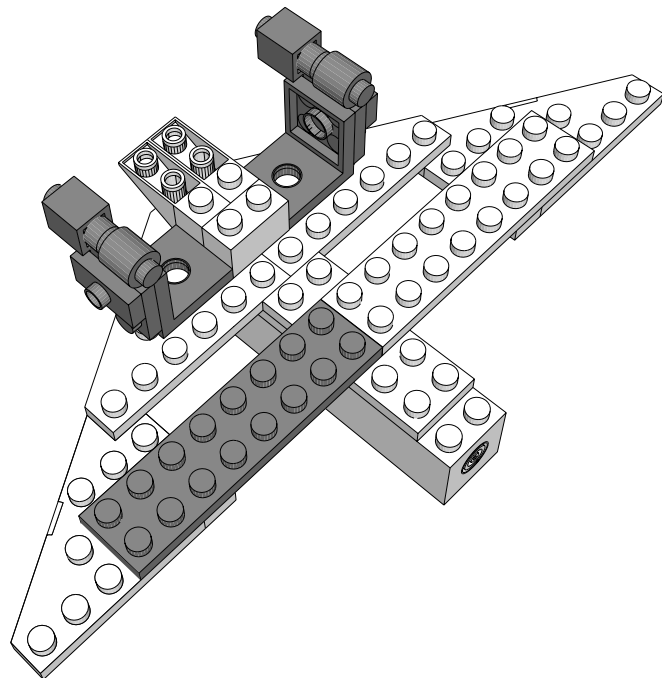

19

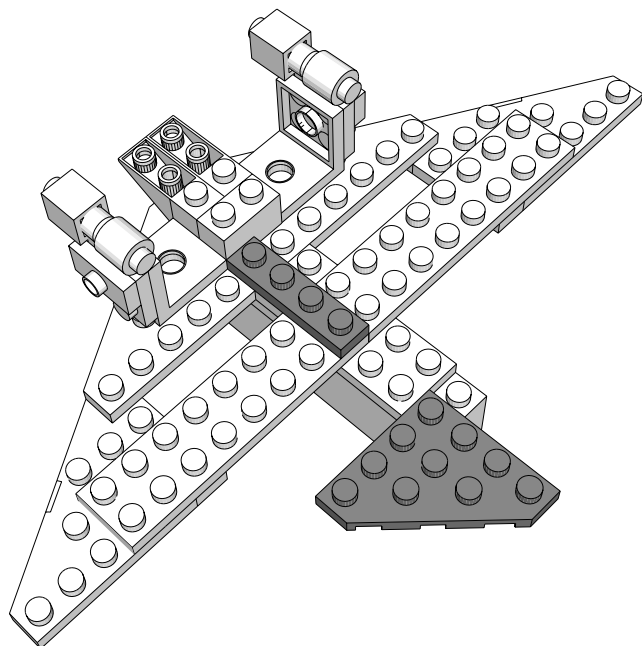

20

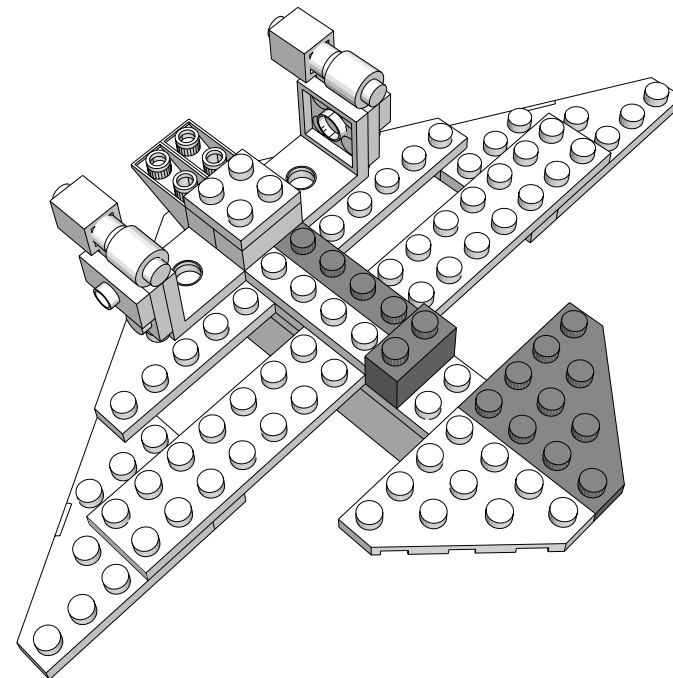

21

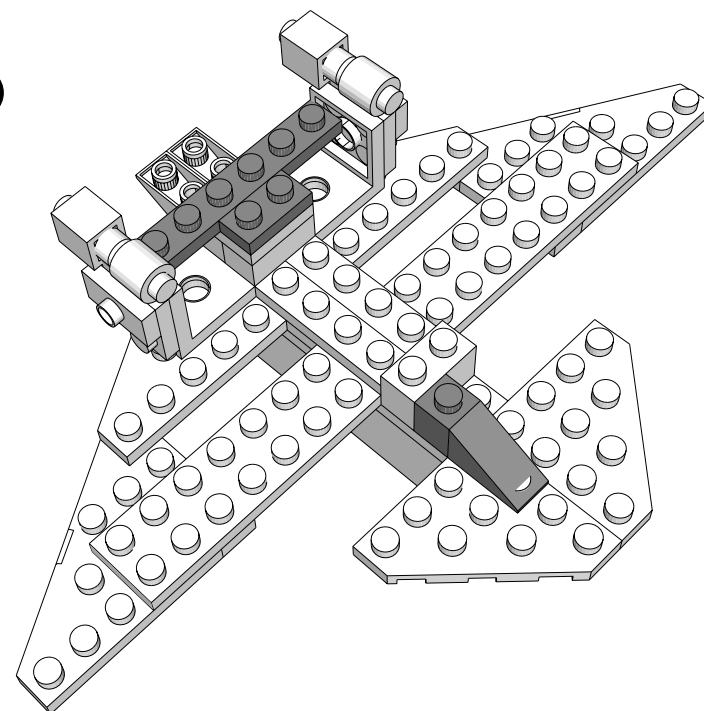

STEP
22

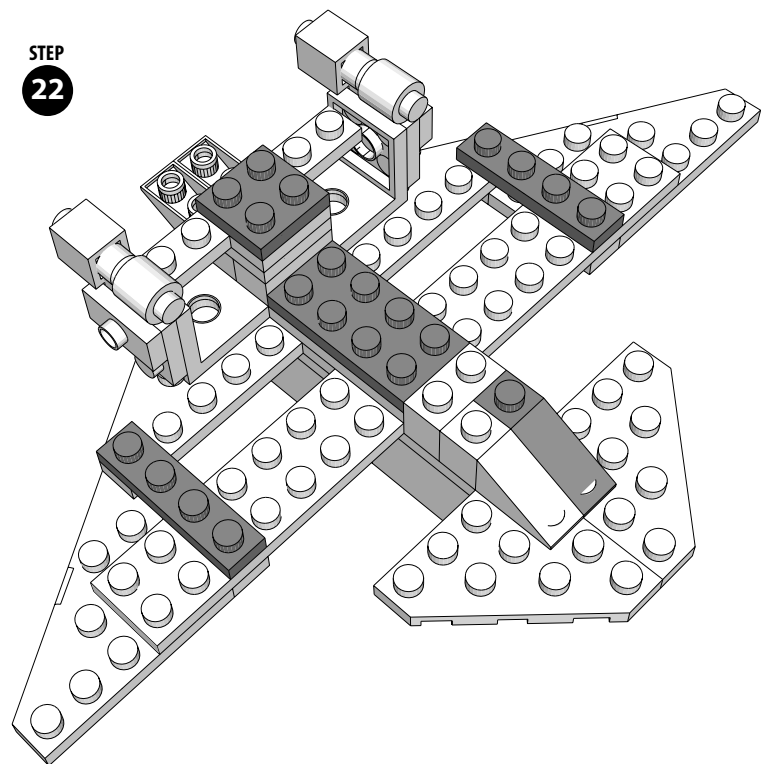

STEP
23

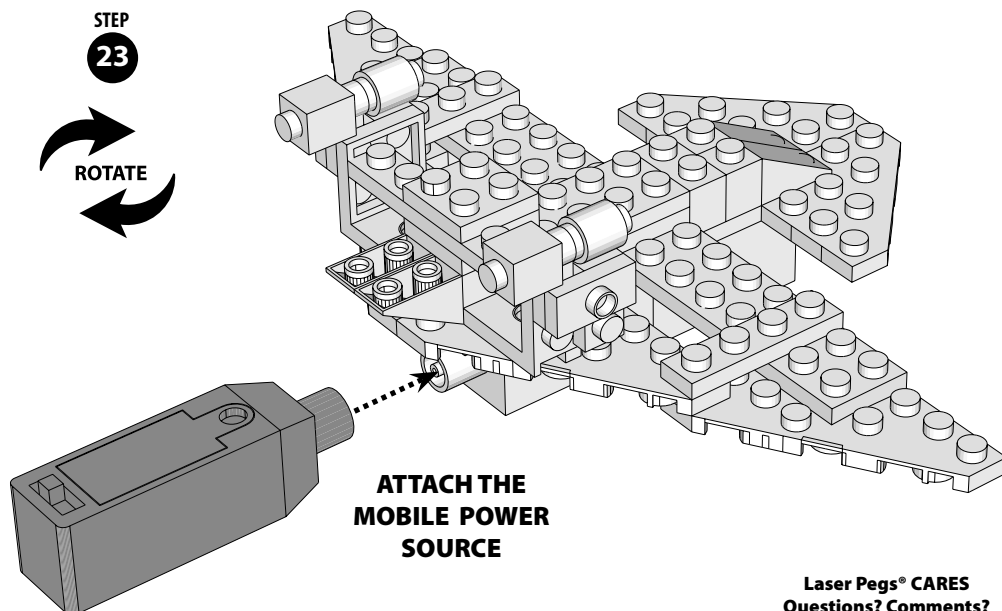
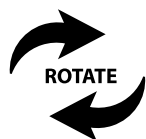

**ATTACH THE
MOBILE POWER
SOURCE**

Laser Pegs® CARES
Questions? Comments?
For additional compliance info:
1-866-432-3735
Contact: Support@LaserPegs.com

STEP
24

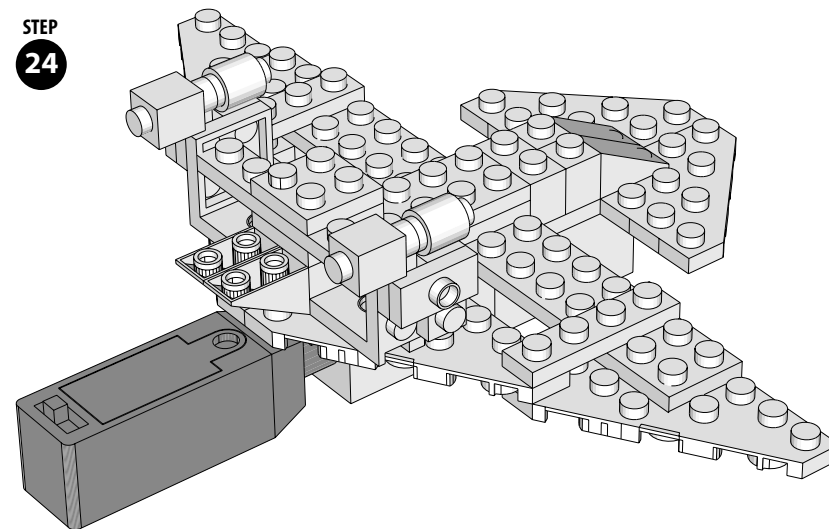

STEP
25

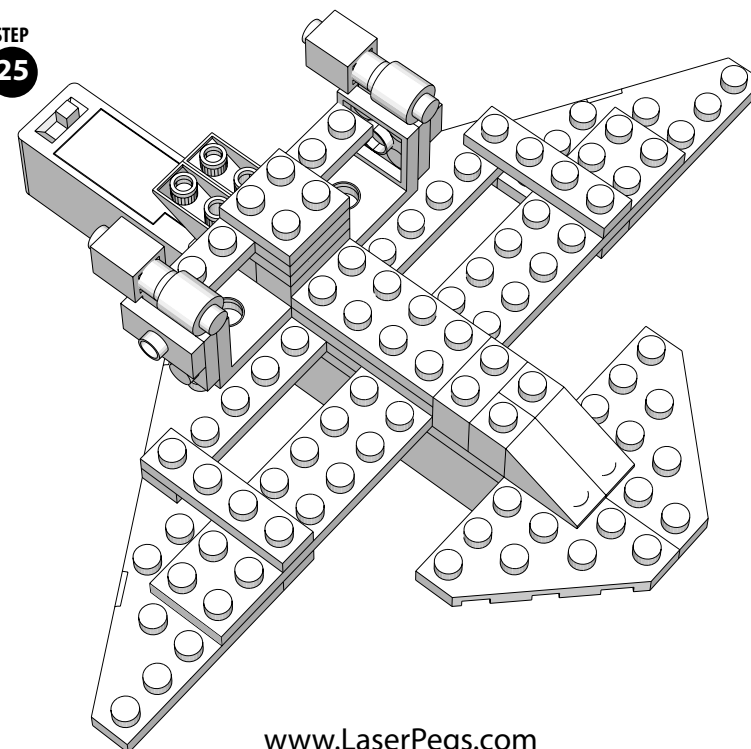

www.LaserPegs.com

Copyright 2013 © All Rights Reserved Global & Multiple Patents Pending.
US Patent #7,731,558

MADE IN CHINA

LASER PEGS®

The Ultimate Toy For Kids®

MPS 100 AIRCRAFT

For Boys And Girls
Ages 5 And Up

4 Models+
Any creation you can build

LIGHTED CONSTRUCTION SET INCLUDES:

- 2 Laser Pegs®
- 37 Construction Parts
- Mobile Power Source
- Instruction Manual

Batteries
Included



EN71, RoHS COMPLIANT
This product complies to all safety
requirements of ASTM F 963

MODEL INSTRUCTIONS

All additional model instructions can be
downloaded at www.LaserPegs.com

Laser Pegs® Parts List

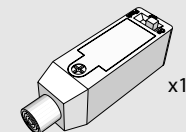

x1

MPS
MOBILE POWER SOURCE

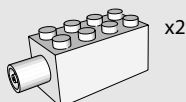

x2

STACKABLE



Laser Pegs® Stackable

Laser Pegs® link that allows you to
connect to other construction kits.

Construction Parts List

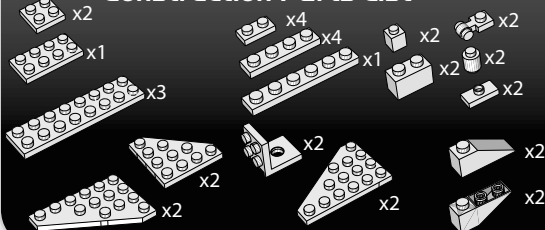

www.LaserPegs.com

This manual is copyright and cannot be reproduced or used online without Laser Pegs® Ventures LLC permission. Copyright 2013 © All Rights Reserved US Patent #7,731,558 Additional Global & Multiple Patents Pending. Laser Pegs® Ventures LLC, 8304 Consumer Ct., Sarasota FL, 34240. Contact: Support@LaserPegs.com

Connecting Pegs

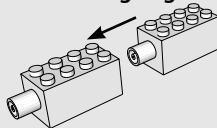

Construction Compatible

To construct with Laser Pegs®, slide two
pieces together to form a connection.
Slide each piece on and off smoothly.

Slide Power Switch to turn on/off/flash

Slide Power Switch to cycle
through different
light settings.

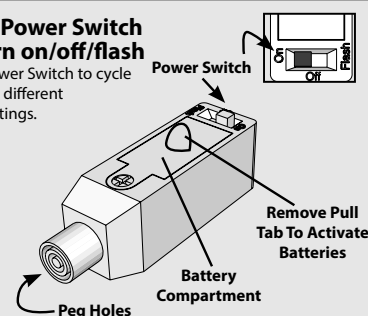

*To avoid short-circuits, keep metal objects and other
unauthorized materials from obstructing the peg holes.

Please dispose of batteries properly as per state and local regulations.

Replacing Batteries

1. Remove the Phillips head screw.
2. Remove the Battery Compartment Cover.
3. Place three LR 44 batteries in the correct position.
(Batteries are to be inserted with the correct polarity).
4. Replace the Battery Compartment Cover.
5. Replace the Phillips head screw.
6. Slide Power Switch to turn on!
7. Do not mix old and new batteries.
8. Do not mix alkaline, standard (carbon-zinc), or
rechargeable (nickel-cadmium, NiMH) batteries!
9. Exhausted batteries are to be removed from the power
base.
10. Never connect more than 4 Laser Pegs®
11. Non-rechargeable batteries are not to be recharged.
12. Rechargeable batteries are only to be recharged under
adult supervision.
13. Rechargeable batteries are to be removed from the toy
before being recharged.
14. The supply terminals are not to be short-circuited.
15. DO NOT THROW BATTERIES INTO FIRE!

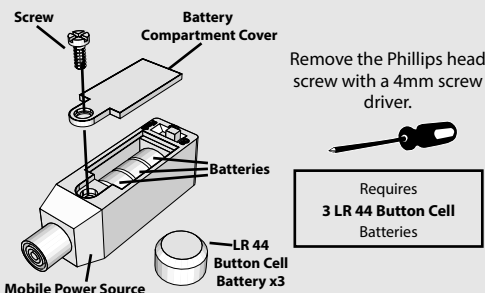

Requires
3 LR 44 Button Cell
Batteries

WARNING! Each Laser Pegs® draws current from the batteries. Therefore,
the more pegs you use, the quicker you will deplete your battery power! As
the power weakens, the current will slowly fail and some Laser Pegs® will
illuminate (typically the reds and yellows) and some won't. When the Laser
Pegs® dim, the Laser Pegs® are not broken, they just need stronger batteries.
You have 3 simple options...

1. Change the batteries.
2. Use high quality batteries. They will last a little longer, but they will still
deplete rapidly the more Laser Pegs® you connect!

LIGHT JET: A speedy little airplane powered by high performance
jet engines.



LIGHT JET

Model
Difficulty
Level

1

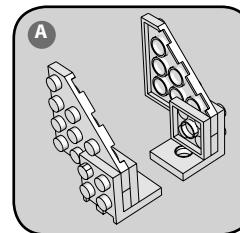
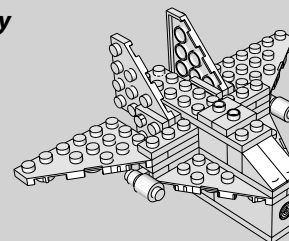

STEP 1

STEP 2

STEP 3

STEP 4

STEP 5

STEP 6

STEP 7

STEP 8

STEP 9

STEP 10

COMBINE

A

STEP 11

STEP 12

STEP 13

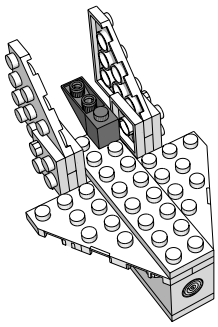
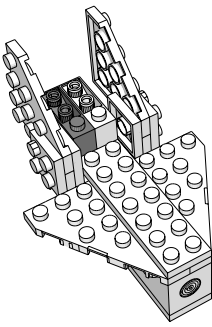
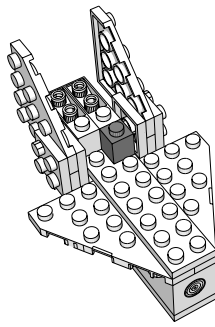
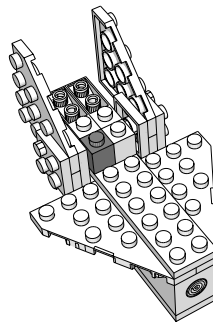
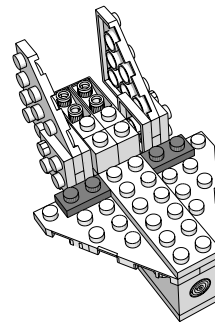
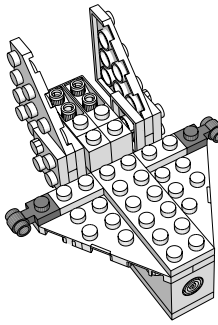
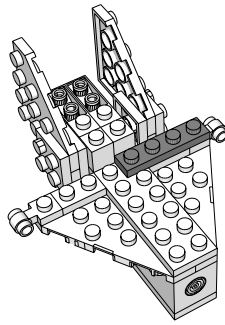
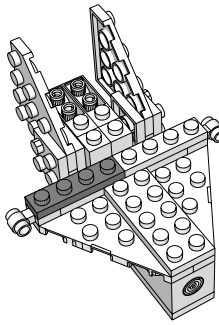
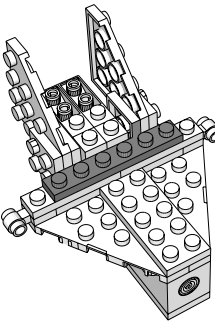
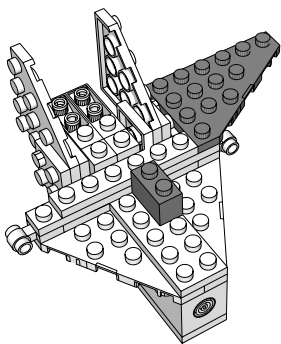
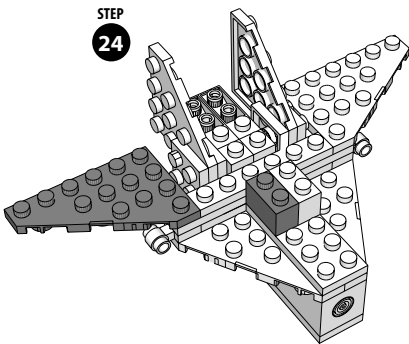
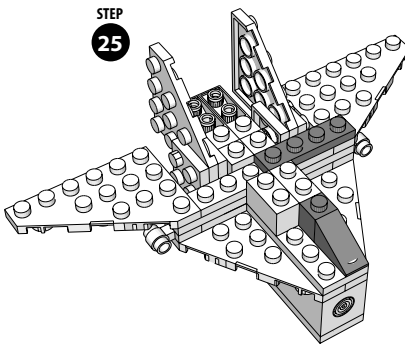
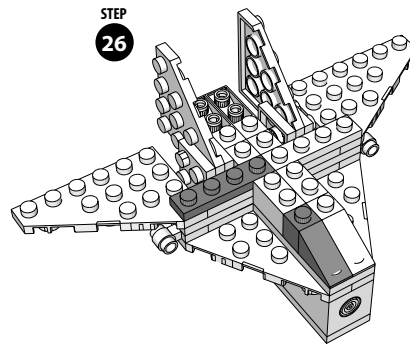
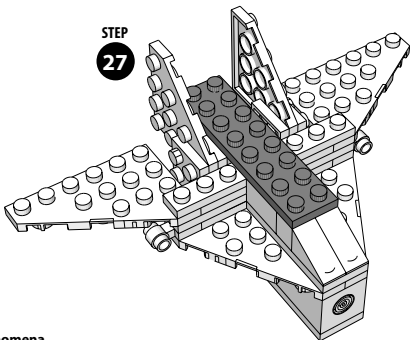
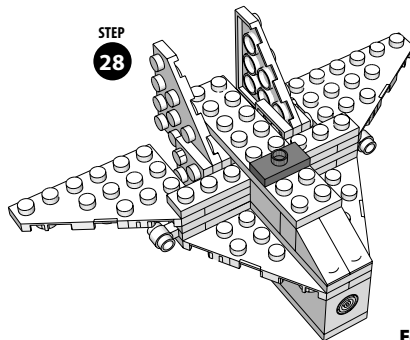
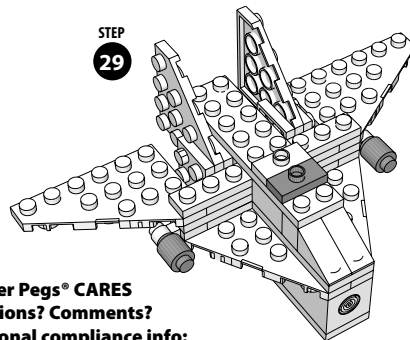
STEP
14STEP
15STEP
16STEP
17STEP
18STEP
19STEP
20STEP
21STEP
22STEP
23STEP
24STEP
25STEP
26STEP
27STEP
28STEP
29

Laser Pegs® CARES
Questions? Comments?
For additional compliance info:
1-866-432-3735
Contact: Support@LaserPegs.com

Environmental Phenomena
 * The unit may malfunction if subjected to radio-frequency interference. It SHOULD revert to normal operation when the interference stops. If not, it may become necessary to turn the power off and back on, or remove and reinstall the batteries. * In the unlikely event of an electrostatic discharge, the unit may malfunction and lose memory, requiring the user to reset the device by removing and reinstalling the batteries.

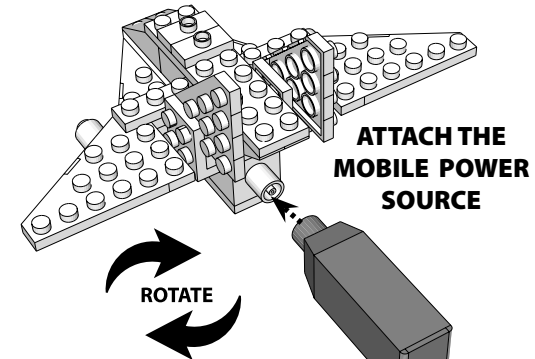
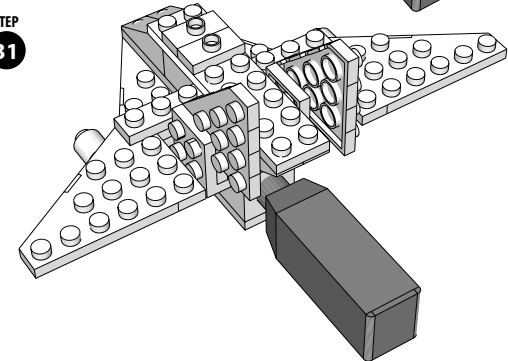
STEP
30STEP
31

www.LaserPegs.com

Copyright 2013 © All Rights Reserved Global & Multiple Patents Pending.
 US Patent #7,731,558
 MADE IN CHINA

MODEL INSTRUCTIONS

All additional model instructions can be
 downloaded at www.LaserPegs.com

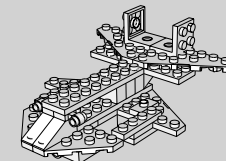

**CARGO
TRANSPORT**

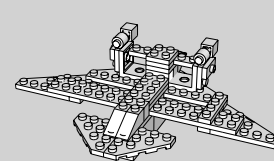

LIGHT GLIDER

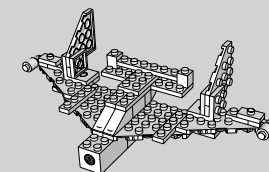

LIGHT BOMBER

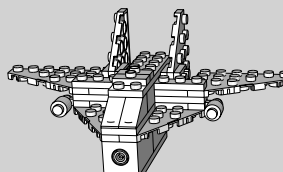

LIGHT JET