

SCALE
1/35
T-34/85
No.112 Factory production



ACADEMY
HOBBY MODEL KITS

13290



CAUTION!

-주의-

◀READ THIS BEFORE YOU BEGIN▶
◀ALLGEMEINE HINWEISE▶
◀LISEZ CE QUI SUIT AVANT DE COMMENCER LE MONTAGE▶
◀組み立てる前に▶
◀注意事項 必ず 読み 取ら せ じ ▶

◀READ THIS BEFORE YOU BEGIN▶

- Study the instructions before assembling. Check the fit of each piece before cementing into place.
- Do not use too much cement to join parts. Never use cement or paint near open flame.
- Open a window or make area well ventilated when cement or paint is in use.
- Tear up and throw away the empty plastic bags to avoid danger of suffocation for little children.

◀ALLGEMEINE HINWEISE▶

- Die Anordnung der Bauteile ist aus den Zeichnungen der Anleitung ersichtlich.
- Die Teile vor dem Verkleben ungenau zusammenhalten, um ihnen passend zu prüfen.
- Klebstoff nicht zu dick auftragen. Klebstoff und Farben niemals in der Nähe einer Flamme verwenden.
- Während der Bemalung mit Spritzpistole oder Pinsel für frische Luftzufuhr, z.B. öffnen des Fensters, sorgen.
- Basatz von kleinen Kindern fernhalten. Verhüten Sie, daß Kinder irgendwelche Bauteile in den Mund nehmen und Plastiktüten über den Kopf ziehen.

◀LISEZ CE QUI SUIT AVANT DE COMMENCER LE MONTAGE▶

- Étudier les schémas d'assemblage. Contrôler que chaque pièce soit bien conforme avant de la coller à sa place.
- N'utiliser pas trop de colle pour réunir les pièces. Ne jamais manipuler la colle ou la peinture à proximité d'une flamme.
- Adress soigneusement la pièce où vous peignez/peint le fond.
- Après avoir sorti les pièces du sac en plastique, déchlorer le sac afin d'éviter que les enfants ne le mettent sur la tête et ne s'étouffent.

◀組み立てる前に▶

- 組み立てる前に図面を確認をお願いします。 - 部品をランナーから取り出す時は指先やニッパーとカッターを使用します。
- 接着剤を少なからぬ量に使うことがおそれたいところですが、一度塗る前に部品を合わせて確かめます。
- 塗料や接着剤を使用する際は必ず換気扇や換気扇を開き換気をお願いします。
- 組み立てた後子供やペットが小さい部品を飲み込まないように注意して下さい。

◀注意事項 前に▶

- 部품을組み立てる前に調整作業を済ませておく必要があります。
- 接着剤が乾くまで部品の両面をしっかりと固定してください。
- 部品の両面を接着する際は必ず換気扇や換気扇を開き換気をお願いします。
- 接着剤を使用する際は必ず換気扇や換気扇を開き換気をお願いします。
- 組み立てた後子供やペットが小さい部品を飲み込まないように注意して下さい。



정확하게
Connect parts
Correctly
Connect



정확하게 맞춘다
Do not cement
fit any other
Not cement



반복 작업한다
Repeat operation
Repeat / Locking
Vorgang wiederholen



스티커를 붙인다
Stickers
Stickers
Aufkleber



무게를 맞춘다
Add weight
Gewicht



구멍이나 홈에 색칠한다
Use filler
Maillack
Schleifen



정확하게
Cut away
Cover
Schneiden



선택적인
Optional parts
Choose
Auswahloption



반대편에
Repeat for
opposite side
Repetition de la page
Wiederholung für gegenüberlie-
gende Seite



부품을 붙인다
Glue
Glue
Einkleben



구멍이나
Fume alertness
Hoch Warnlicht



색칠 및
Holes
filling
filling
Painting
holes
Lackieren
Lackieren

Before commencing assembly, referring to 'Painting & Decal placement'.

조립을 시작하기 전에 '색칠 및 전사지 붙이기'를 참조하십시오.

2차대전 참전형
World War II



한국전쟁
Korean War

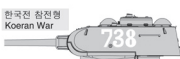

MAIN COLOR

RUSSIAN GREEN / 러시아 그린

FLAT BLACK / 무광검은색

WOOD BROWN / 우드 브라운

PAINT INDEX	Humbrol				GSI Creos				Lifecolor	TESTORS / MODELMASTER				Revell		Vallejo	
	ENAMEL	ACRYL.	AQUEOUS HOBBYCOLOR	MR. COLOR	ENAMEL	ACRYL.	ENAMEL	ACRYL.		MODEL COLOR	MODEL AIR						
FLAT BLACK FS 37038	33	33	H12	33	LC52	1749	4768	32108	36108	950	57	무광검은색					
RUSSIAN GREEN	114			136	UA008	1764	4729			894	14	러시아 그린					
WOOD BROWN	19		H37	43	UA125	1742	4709	32382	36382	874	79	우드 브라운					
STEEL	53	53	H18	28	LC76	1795	4681	32191	36191	863	72	스틸					
SILVER	11	11	H8	8	LC74	2914	4678	32190	36190	997	63	은색					

1

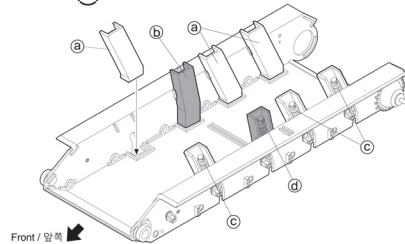
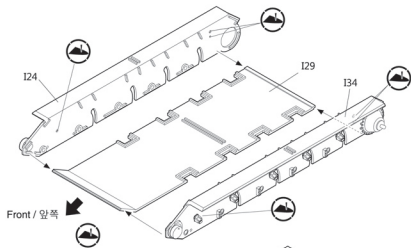
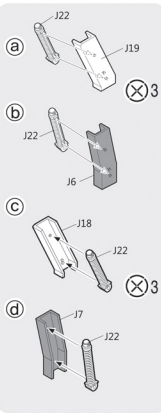

2

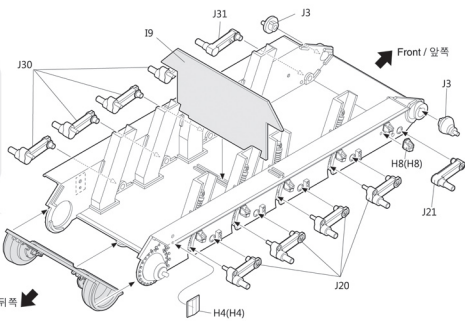
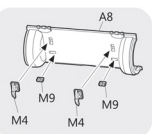

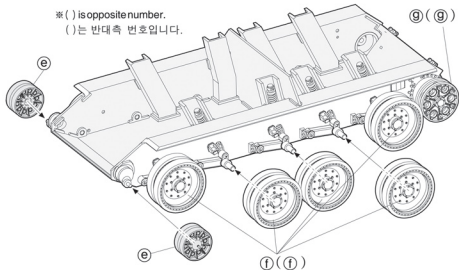
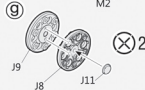
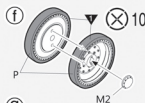
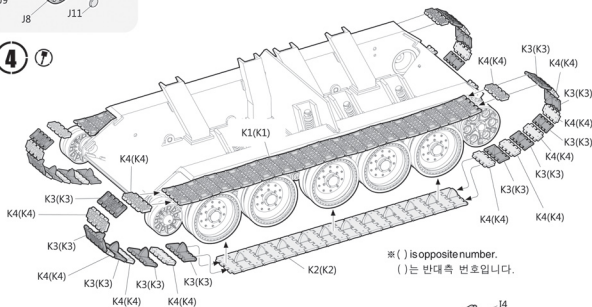
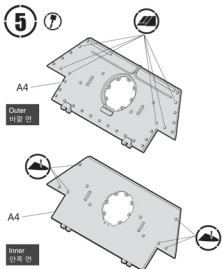
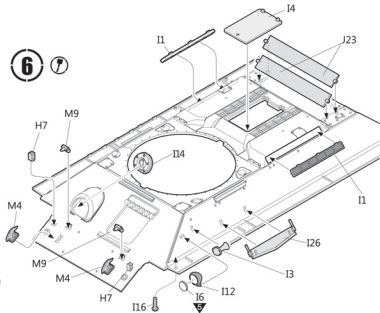
3 ※ () is opposite number.
()는 반대측 번호입니다.**4** ※ () is opposite number.
()는 반대측 번호입니다.**5** **6** 

7 

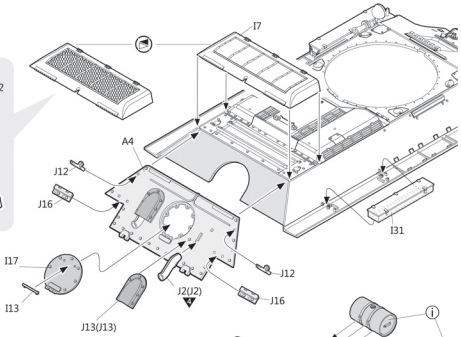
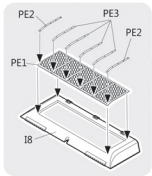

8 

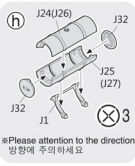

*Please attention to the direction 방향에 주의하세요



*Please attention to the direction 방향에 주의하세요

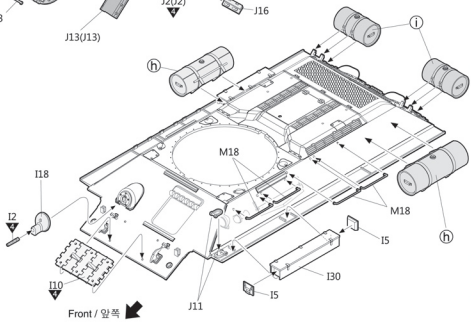

9 

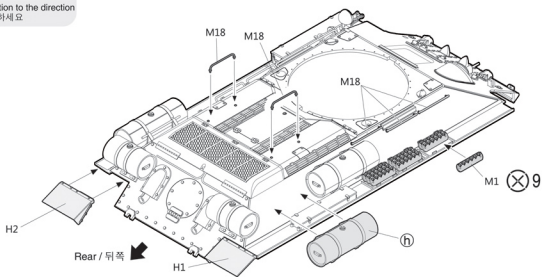

10

WWII (1945)
2차대전
참전형 (1945)

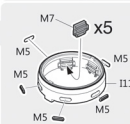
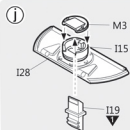
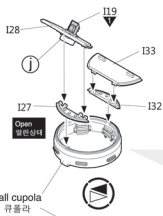
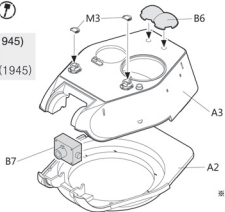

11

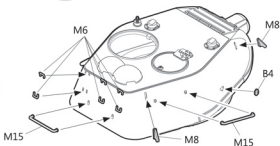
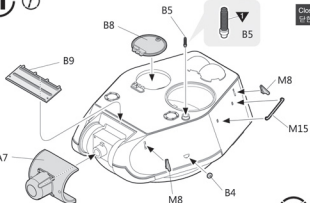

12

Korean war
(1950)
한국전 (1950)

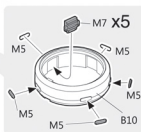
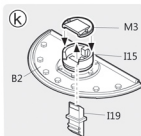
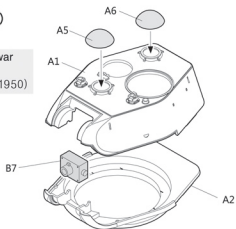

13

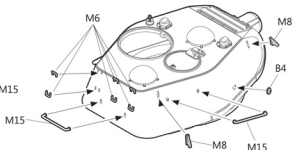
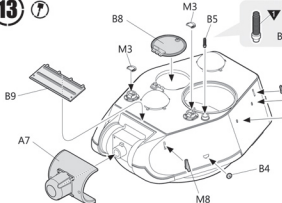

14

T-34/85 <World War II>
T-34/85 <2차대전형>

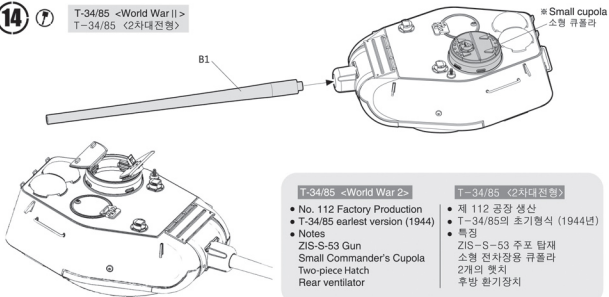

T-34/85 <World War 2>

- No. 112 Factory Production
- T-34/85 earliest version (1944)
- Notes
ZIS-S-53 Gun
Small Commander's Cupola
Two-piece Hatch
Rear ventilator

T-34/85 <2차대전형>

- 제 112 공장 생산
- T-34/85의 초기형식 (1944년)
- 특징
ZIS-S-53 주포 탑재
소형 전차장용 큐폴라
2개의 햇치
후방 환기장치

15

T-34/85 <Korean War>
T-34/85 <한국전 참전형>

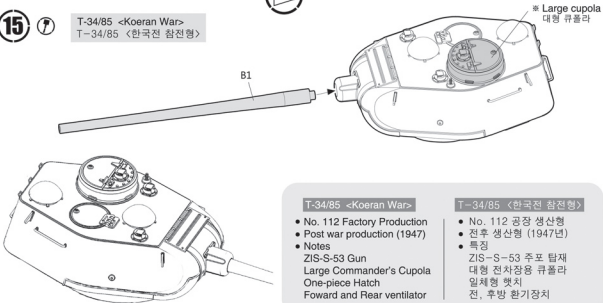

T-34/85 <Korean War>

- No. 112 Factory Production
- Post war production (1947)
- Notes
ZIS-S-53 Gun
Large Commander's Cupola
One-piece Hatch
Forward and Rear ventilator

T-34/85 <한국전 참전형>

- No. 112 공장 생산형
- 전후 생산형 (1947년)
- 특징
ZIS-S-53 주포 탑재
대형 전차장용 큐폴라
일체형 햇치
전, 후방 환기장치

16

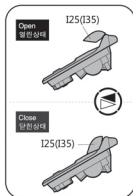
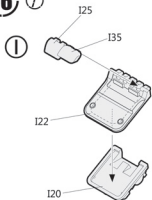

17

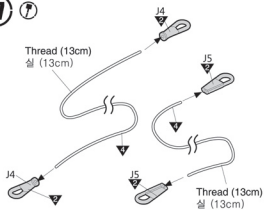

Open
열린 상태

Close
닫힌 상태

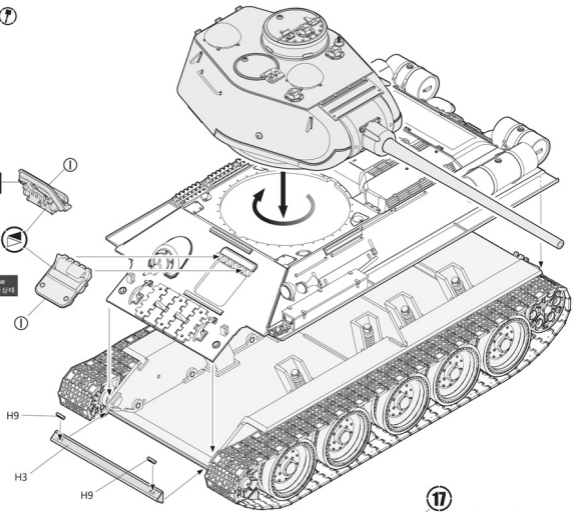

※ ② only (refer to page 9)
② 번 도장도만 적용 (9페이지 참조)

⊗ 2
Attach freely.
자유롭게 부착하세요.

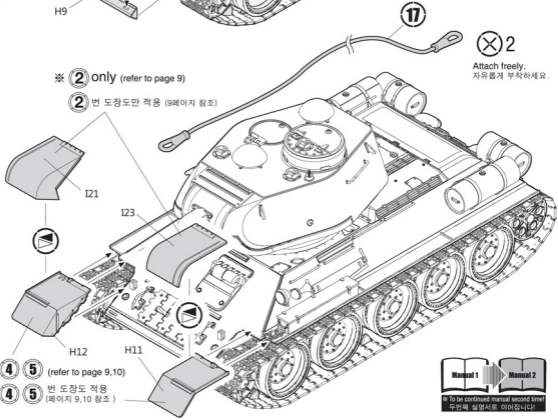

※ ① ③ ④ ⑤ (refer to page 9,10)
① 번 도장도만 적용 (페이지 9,10 참조)

T-34/85 No.112 Factory Production (WWII, 1945) / T-34/85 112공장 생산 (1945년 2차대전 참전형)

* () is opposite number.
()는 반대쪽 번호입니다.

①

Red Army T-34/85
No. 904. Berlin, Germany. (May, 1945.)
붉은 군대, T-34/85, 112 공장 생산형.
2차대전 말 1945년 5월 독일 베를린.
904번 차량

* Attached at both sides.
양측면에 붙여 주십시오.

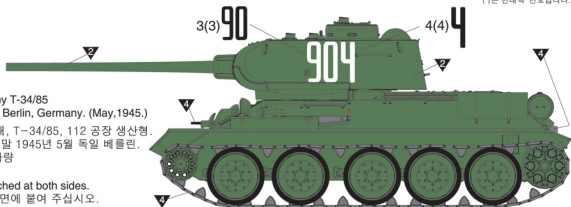

②

Red Army T-34/85
Berlin, Germany. (May, 1945.)
붉은 군대, T-34/85,
(2차대전 말 1945년 5월
독일 베를린.)

* Attached at both sides.
양측면에 붙여 주십시오.

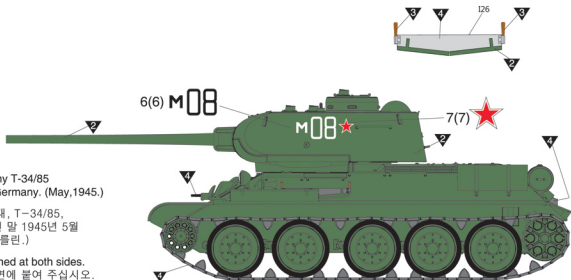

③

Red Army T-34/85
(Yugoslavia, Spring, 1945.)
붉은 군대, T-34/85
(2차대전 말 1945년 초 유고슬라비아.)

* Attached at both sides.
양측면에 붙여 주십시오.



T-34/85 No.112 Factory Production (Korean War. 1950) / T-34/85 제112공장 생산형 (1950년 한국전 참전형.)

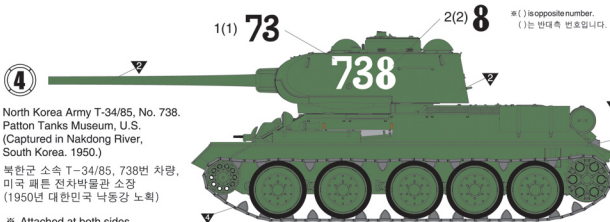

North Korea Army T-34/85, No. 738.
Patton Tanks Museum, U.S.
(Captured in Nakdong River,
South Korea. 1950.)

북한군 소속 T-34/85, 738번 차량,
미국 패튼 전차박물관 소장
(1950년 대한민국 낙동강 노획)

※ Attached at both sides.
양측면에 붙여 주십시오.



North Korea Army T-34/85,
No.229 (North Korea. 1950)

북한군 소속 T-34/85,
229번 차량 (1950년 한국)

※ Attached at both sides.
양측면에 붙여 주십시오.

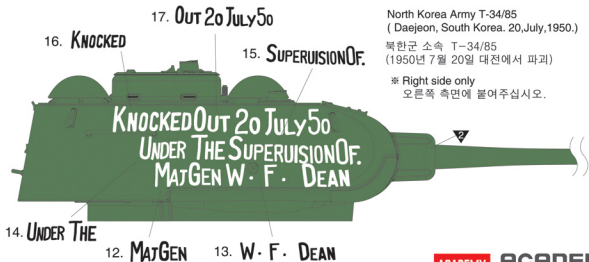

North Korea Army T-34/85
(Daejeon, South Korea. 20, July, 1950.)

북한군 소속 T-34/85
(1950년 7월 20일 대전에서 파괴)

※ Right side only
오른쪽 측면에 붙여 주십시오.

1)

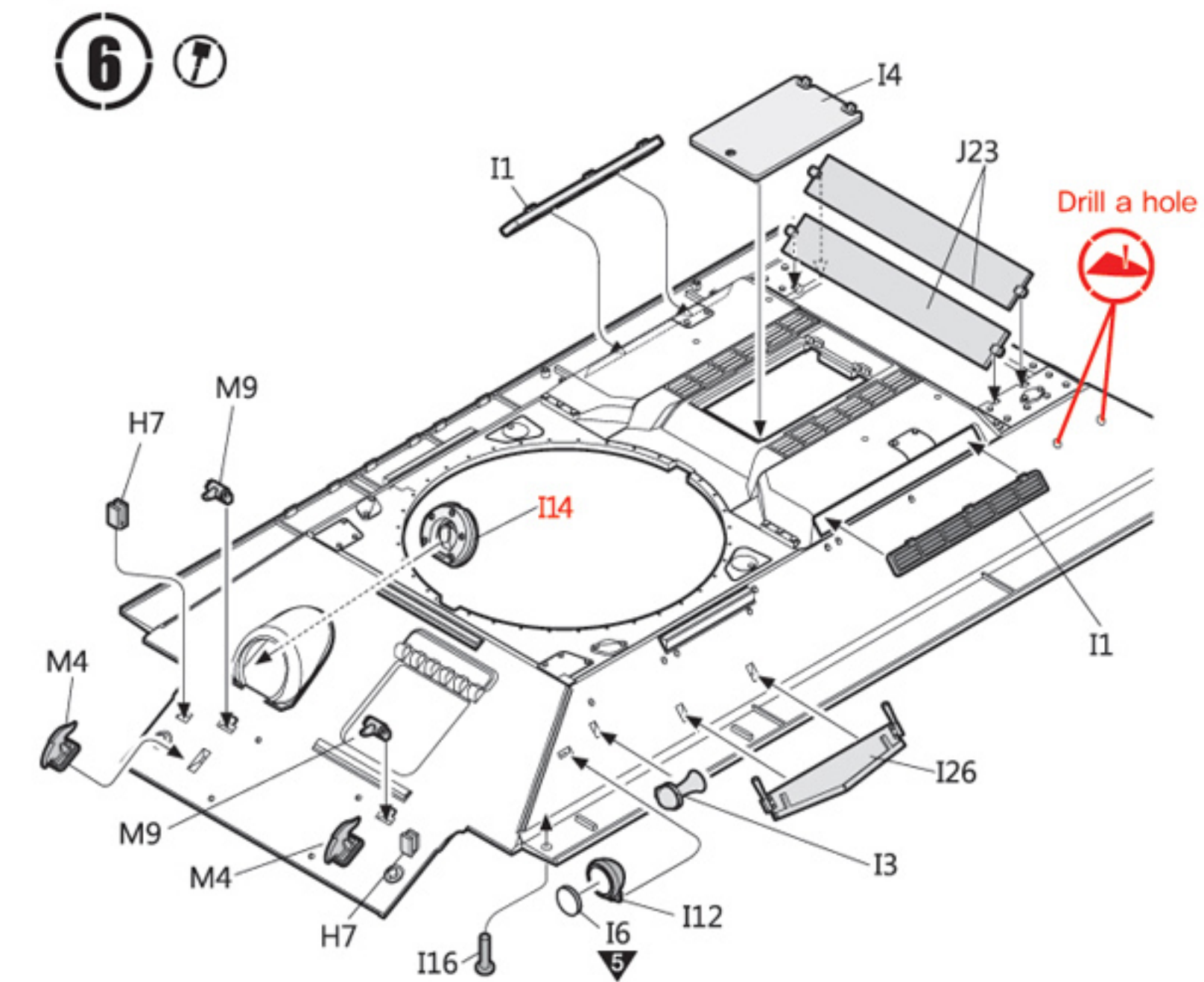

2)

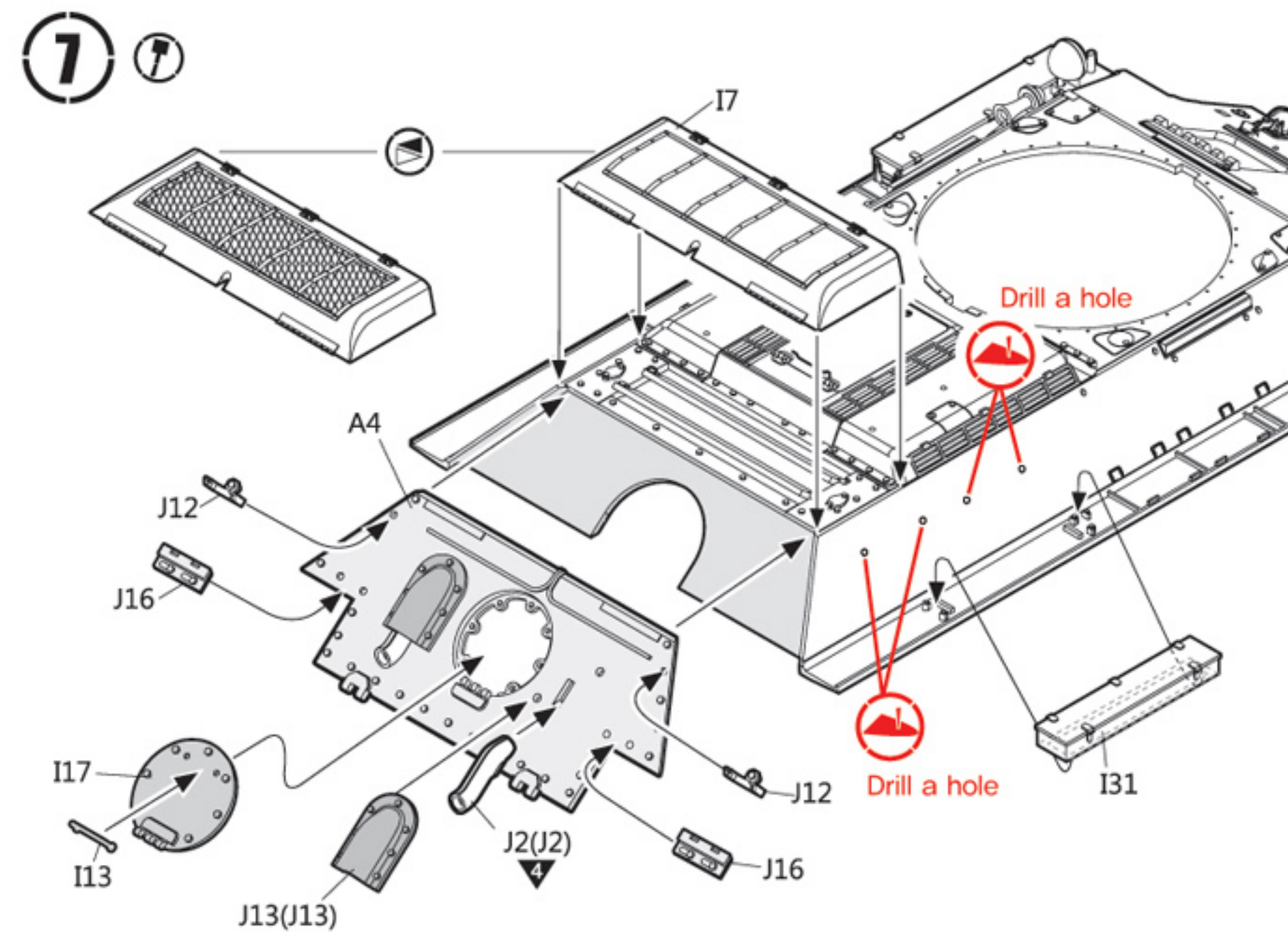

3)

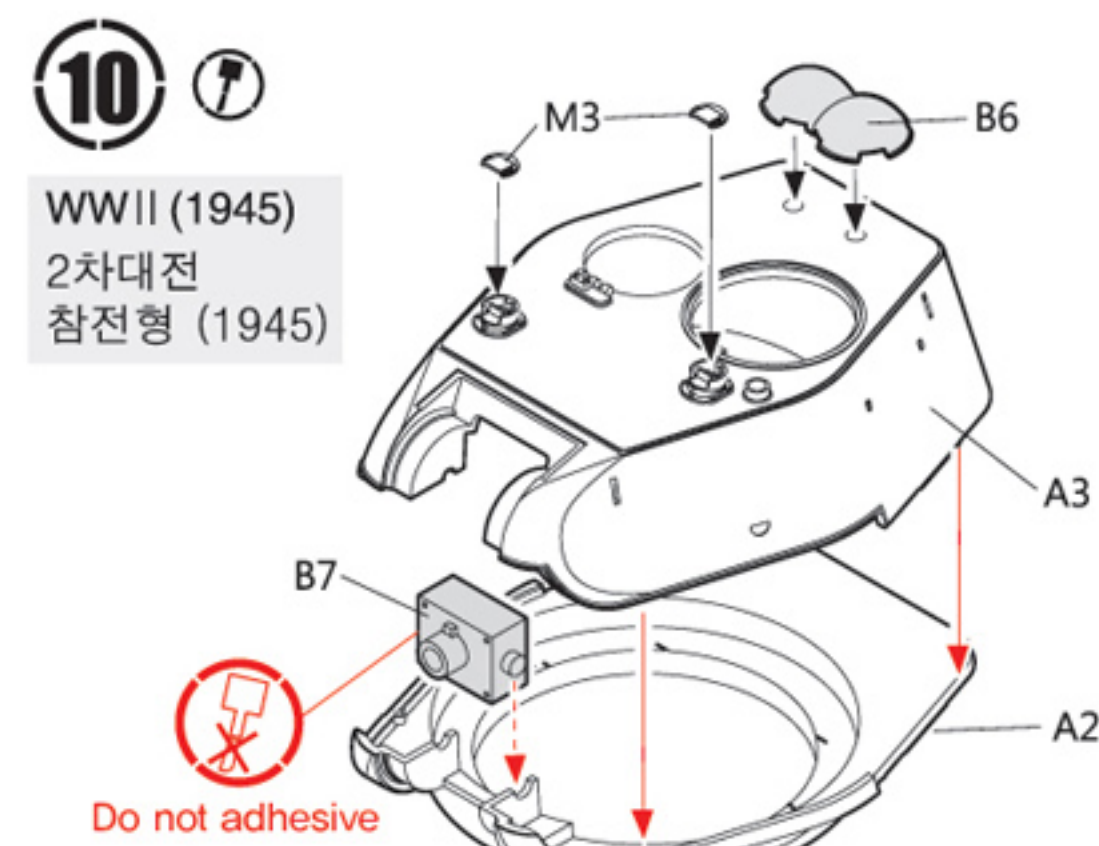

4)

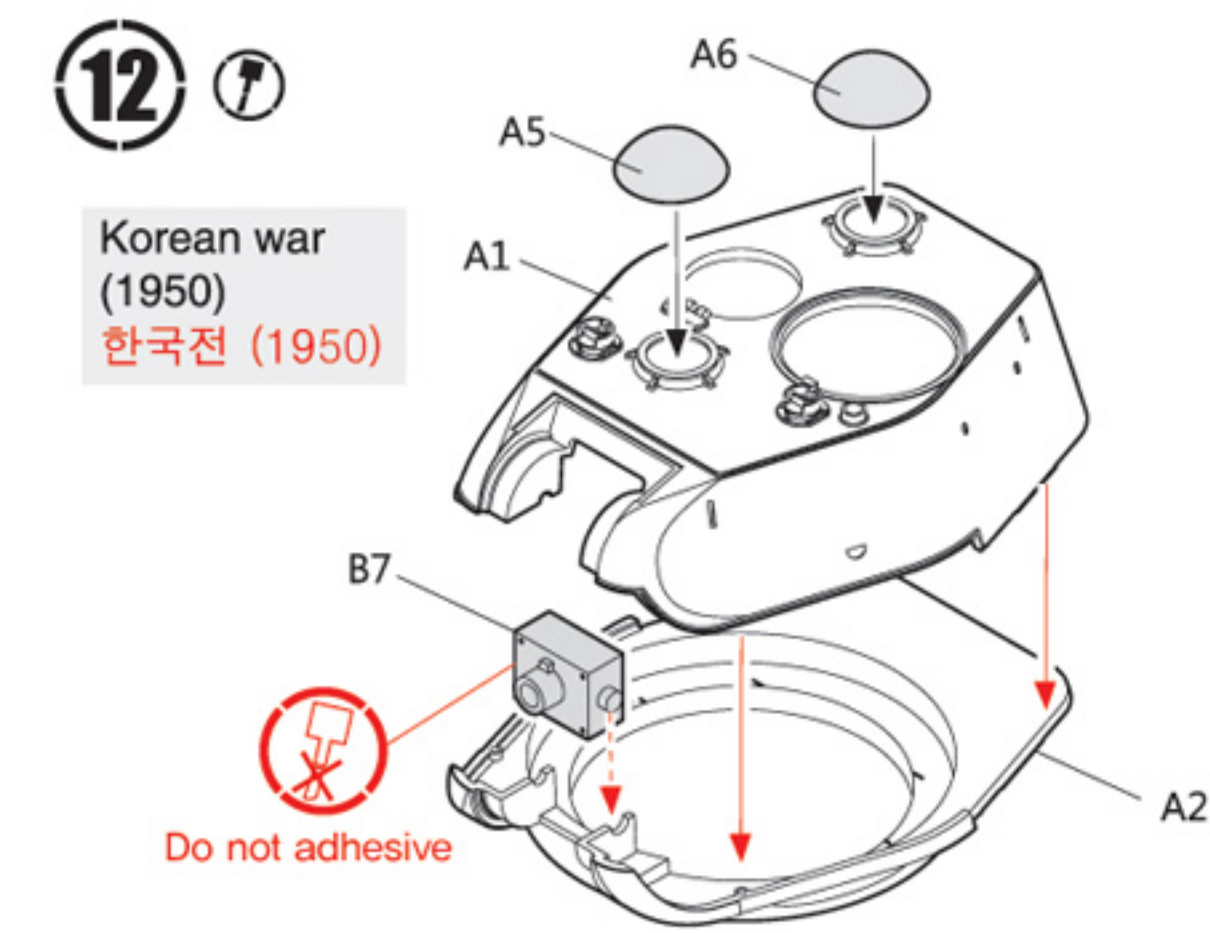

5)

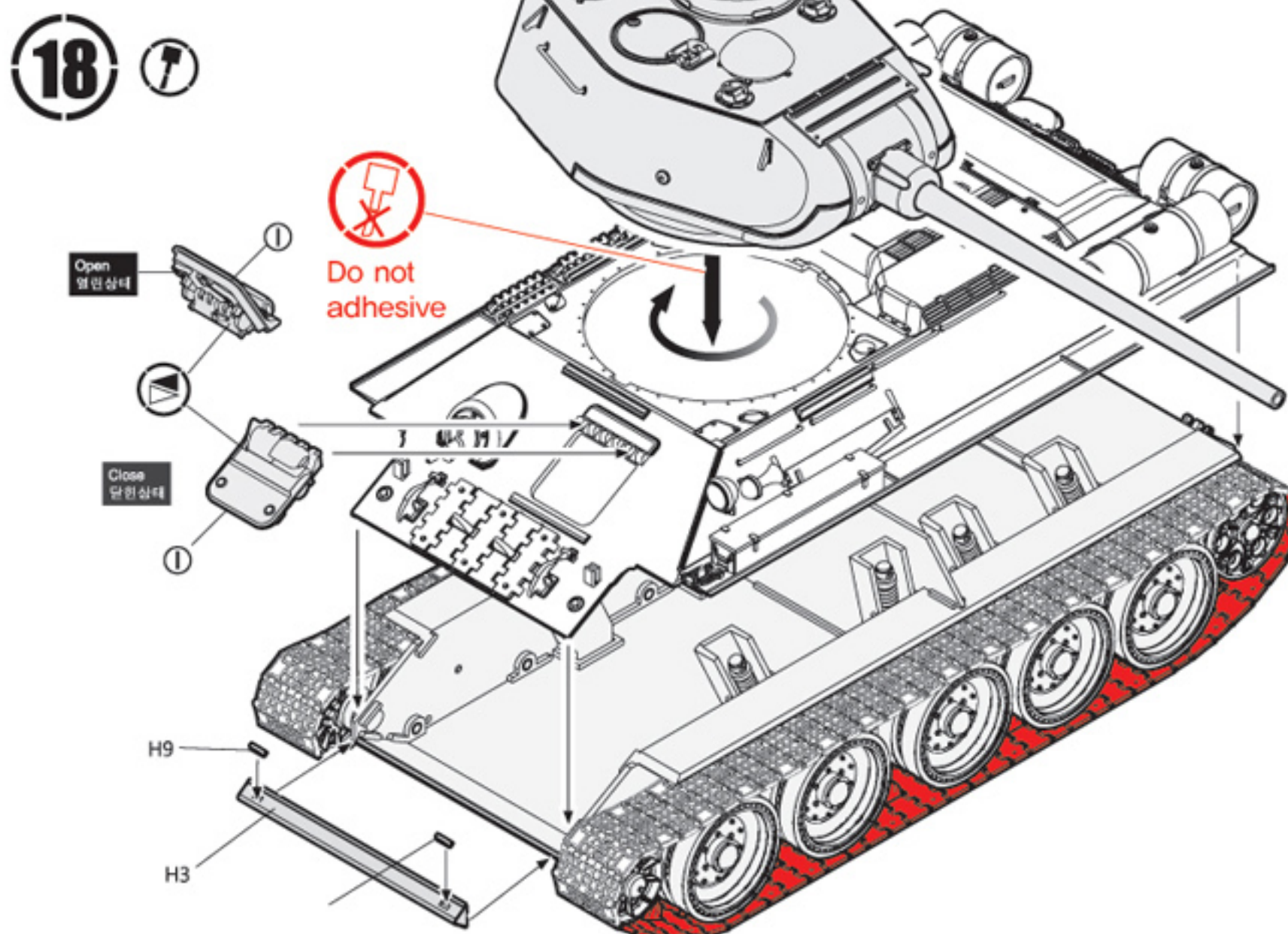

6)

