

① SS sPz, Abt.101, 1st Company Normandy France. July 1944  
 SS 제101중전차대대 1중대 1944년 7월 프랑스 노르망디

\* ( ) is opposite number.  
 (\*)는 반대쪽 번호입니다.

- SANDY YELLOW 5
- DARK GREEN 8
- RED BROWN 9



② SS sPz, Abt.101, 3rd company Amiens France. May 1944  
 SS 제101중전차대대 3중대 1944년 5월 프랑스 아미앵

- SANDY YELLOW 5
- DARK GREEN 8
- RED BROWN 9
- GERMAN GRAY 6



③ SS sPz, Abt.101, 3rd company Mons Belgium. Winter 1943-44  
 SS 제101중전차대대 3중대 1943~44년 겨울 벨기에 몬스

- SANDY YELLOW 5
- RED BROWN 9
- DARK GREEN 8



④ sPz, Abt.501, Eastern Front April 1944  
 제501중전차대대 1944년 4월 동부전선

- SANDY YELLOW 5
- DARK GREEN 8

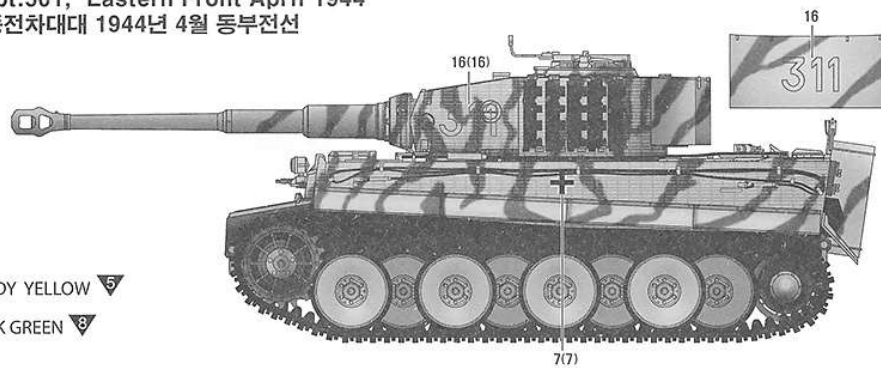

※ ( ) is opposite number.  
 ( )는 반대측 번호입니다.

⑤ Otto Carius, sPz, Abt.502, Battle of Malinava Latvia. July 1944  
 제502중전차대대 1944년 7월 마리나바 전투 오토 카리우스 탑승차량

- SANDY YELLOW 5
- DARK GREEN 8



⑥ sPz, Abt.502, Battle of Narva Estonia. Early 1944  
 제502중전차대대 1944년 초 겨울 나르바 전투 동계위장 차량

- FLAT WHITE 9
- SANDY YELLOW 5



⑦ sPz, Abt.506, Ukraine. April 1944  
 제506중전차대대 1944년 4월 우크라이나

- SANDY YELLOW 5
  - RED BROWN 3
- 10 12  
 1st Company 2nd Company

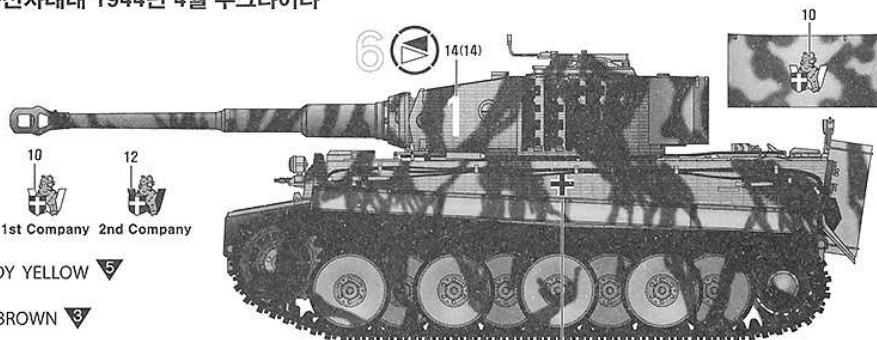

⑧ sPz, Abt.506, Ukraine. Winter 1943-44  
 제506중전차대대 1943-44년 겨울 우크라이나

- FLAT WHITE 9
- SANDY YELLOW 5
- RED BROWN 3

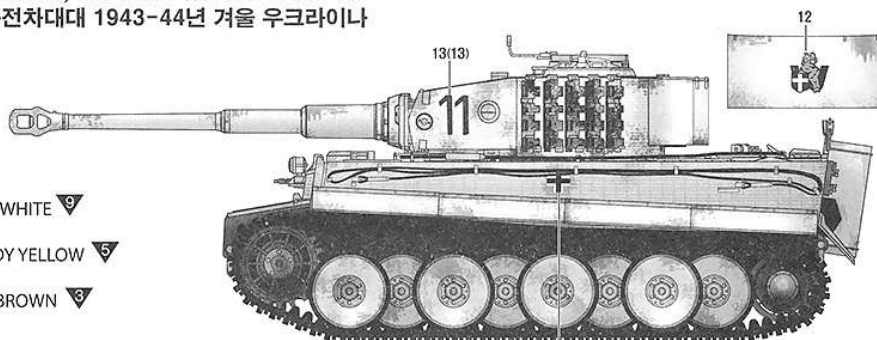

9 sPz, Abt.501, Eastern Front March 1944  
제501중전차대대 1944년 3월 동부전선

\* ( ) is opposite number.  
( )는 반대쪽 번호입니다.

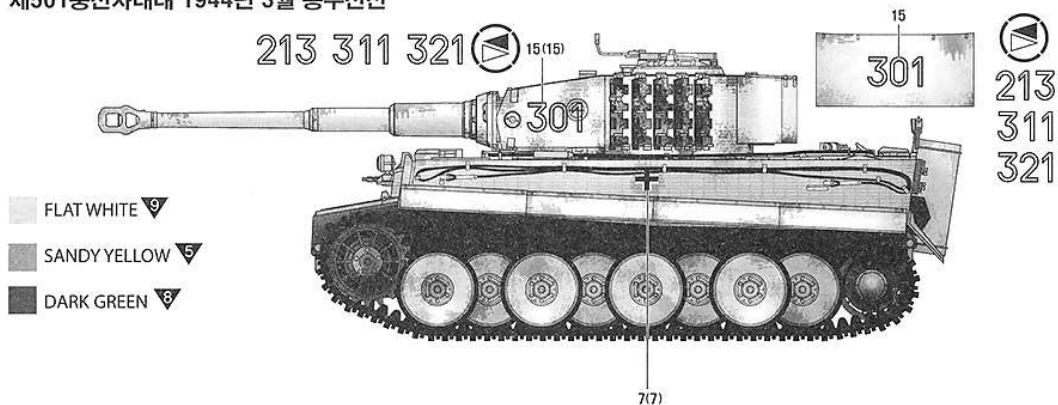

10 sPz, Abt.503, Eastern Front Winter 1943-44  
제503중전차대대 1943~44년 겨울 동부전선



11 sPz, Abt.508, Near Rome Italy February 1944  
제508중전차대대 1944년 2월 이탈리아 로마 인근



**A** X2

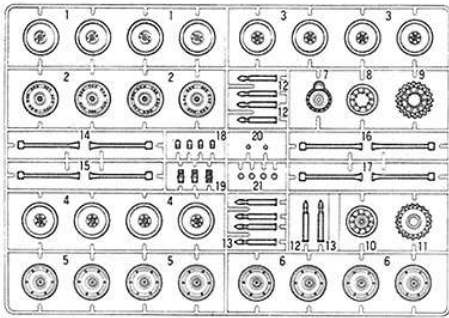

**B**

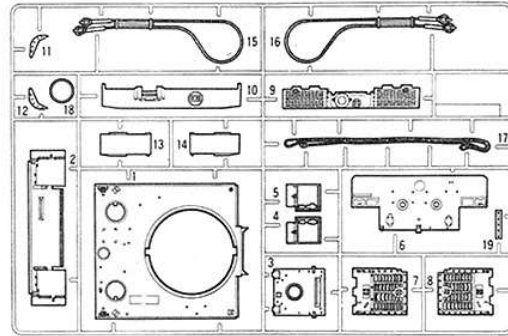

**D**

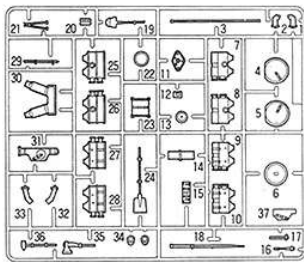

**E** X2

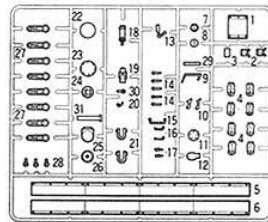

**K**

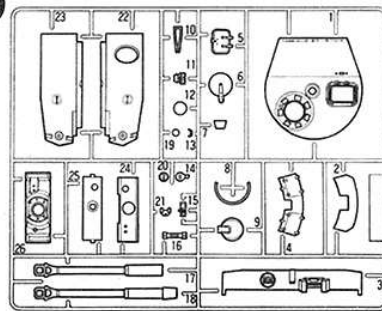

**L**

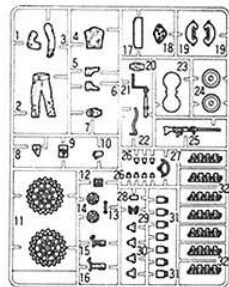

**P**

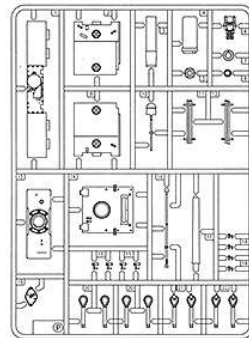

**S**

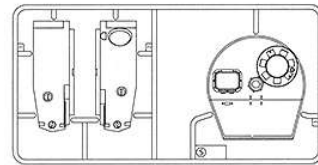

● Zimmerit Tool/찌메리트 도구



● Photo Etched/에칭

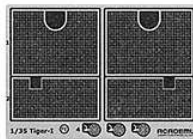

● Unused parts/불필요 부품

A9, A12, A13, A18X1, A19, A21, B3, B7, B8, B9, B10, D1, D2, D7, D8, D9, D10, D11, D12, D14, D15, D19, D20, D25, D26, D27, D28, D30, D32, D33, D34, E2, E4, E5X1, E6X1, E7, E8, E9, E10X1, E12, E16X1, E17, E18X1, E19X1, E22, E24X1, E28, E29, K1, K16, K17, K18, K22, K23, K26, L18, L21, L23, L24, L27, P11, P12, P15, P16, P20, P21, P22

- Decal/전사지
- Lower Hull/하체
- Poly/폴리부품
- Flexible Tracks X2/연질 캐터필러X2

PAINT INDEX	Humbrol		GSI Creos		Lifecolor	TESTORS / MODELMASTER		Revell		Vallejo		
	ENAMEL	Mr.COLOR	AQUEOUS HOBBY COLOR	Mr. COLOR		ENAMEL	ACRYL	ENAMEL	ACRYL	MODEL COLOR	MODEL AIR	
1 FLAT BLACK FS37038	33	33	H12	33	LC02	1749	4768	32108	36108	950	57	무광 검정색
2 STEEL	53	53	H18	28	LC76	1795	4681	32191	36191	863	72	스틸
3 RED BROWN	160		H47	41	UA205	2090	4797	32381	36381	984	41	레드 브라운
4 FLESH	61	61	H44	51	LC21	1516		32135	36135	917	76	플레시
5 SANDY YELLOW	84		H79	39	UA097	2052	4796	32116	36116	821	31	사막색
6 GERMAN GRAY	182			40	UA207	2040	4767	32109	36109	862	56	저먼 그레이
7 FIELD GRAY	92		H48		UA059	1793		32142	36142	893		필드 그레이
8 DARK GREEN	86	86	H36	70	UA206	1591	4734	32145	36361	890		다크 그린
9 FLAT WHITE FS37875	34	34	H11	62	LC01	1768	4769	32105	36105	951	1	무광 흰색