

ADA'S STUDIO

DG103



Brief Introduction

Tips of glue (The picture is for reference only.)

1. White glue is used for small wooden pieces. (Around 3 minutes to dry.)
2. Silicone liquid glue is used for big wooden parts and other materials.
3. Use appropriate glue to keep the material clean.



Tips of fabric

1. Cut the fabric according to the instruction.

E.g.



Tips of LED

1. Pay attention to the positive & negative electrode of cell.
Yellow wire: positive.
White wire: negative.
2. In cell box:
Red wire: positive.
Black wire: negative.
3. Test the LED after combination.



Warning

1. Children must use under the guidance of adults.
2. Put the remains back in the original bags after each step completed. (In case of missing).

Tools included



Tools excluded

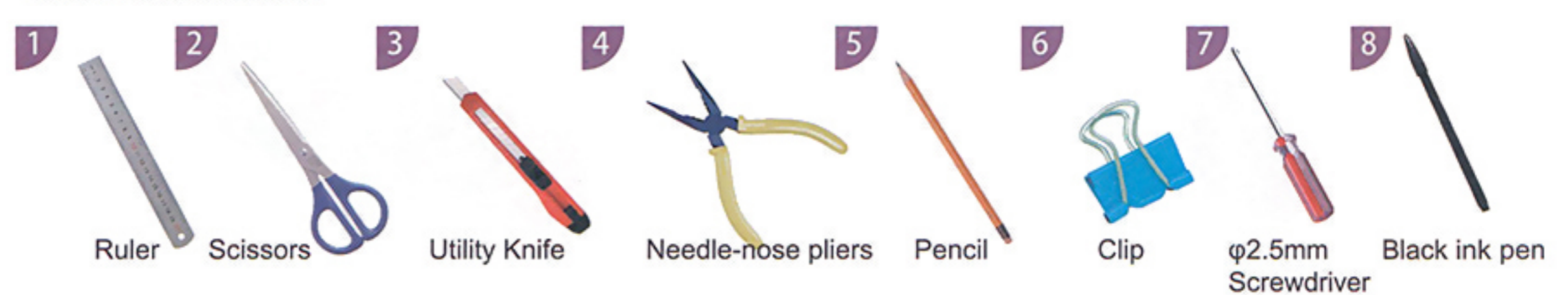

Tips of painting

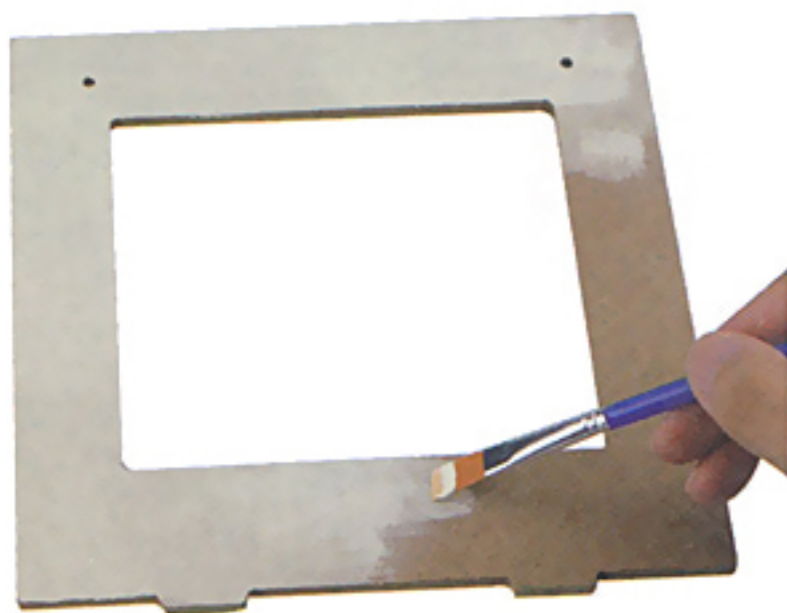

Paint before assembling.
(Paint again after dried.)

Tips of mark

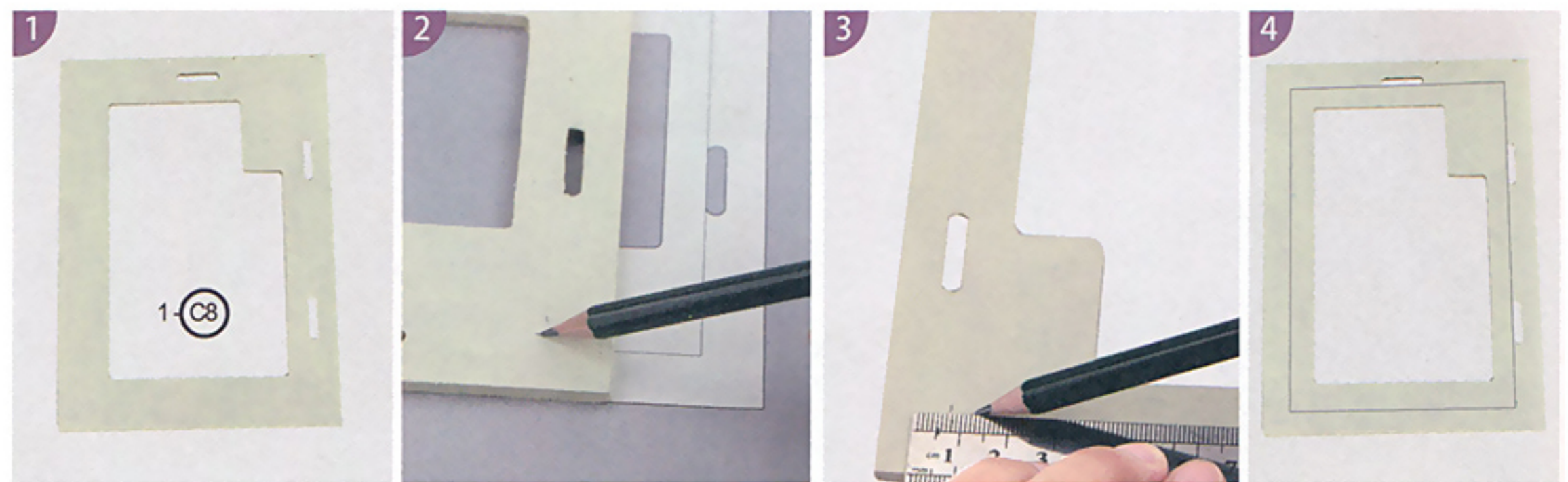

Find out the wooden pieces and correct paper (Matched numbers). Mark on the wooden pieces according paper.

! Part number explanation
(e.g.) 2-A23: (Bag No.)2- (Part No.)A23. (Only Part No. is indicated in detailed steps)

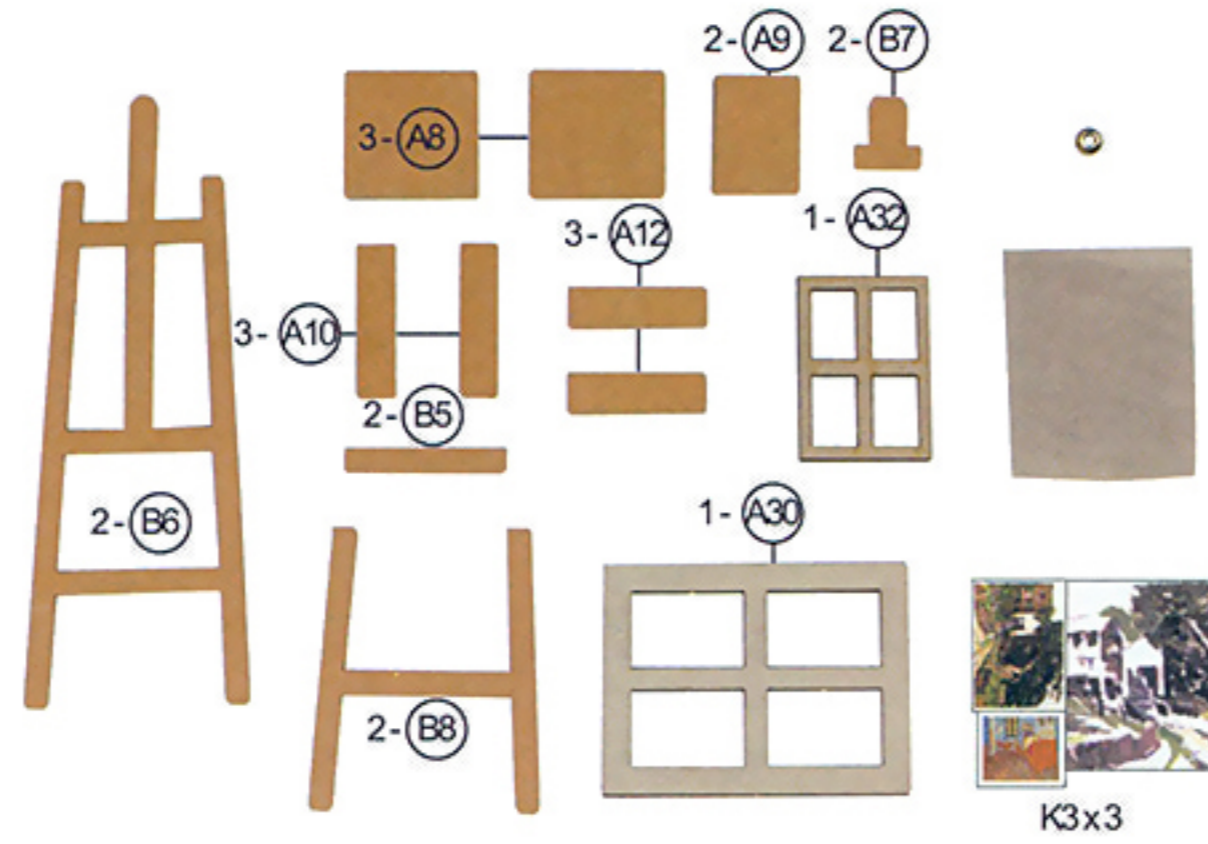

Easel

List

- Wooden pieces 13pcs
- Small golden beads 1pc (Bag No. 6)
- Fabric (Bag No.4) K3*3
- Paper

1

Cut the fabric (55*67mm)

2

Paste and cut as shown.

3

Paste K3 as shown.

4

Cut the fabric (40*50), and finish easel 2 in the same way.

5

Paste as shown.

6

Paste as shown. (Notice the size.)

7

Glue on the part 'a' as shown.

8

Insert step 5 into (B6) as shown, do it as shown.

9

complete.

Big table

List

- Wooden pieces 5pcs

1

Paste as shown.

2

Paste as shown.

Long cabinet

List

- Wooden pieces 7 pcs
- paper D1

1

Paste as shown.

2

Paste as shown. (Protrude B15 slightly)

3

paste (D1) as shown.



Small Stool

List

- ① Wooden pieces 3 pcs
- ② \varnothing 3mm, L33mm column 3 (Bag No.5)
- ③ Fabric 30*30mm (as shown) (Bag No.4)
- ④ Paper K17

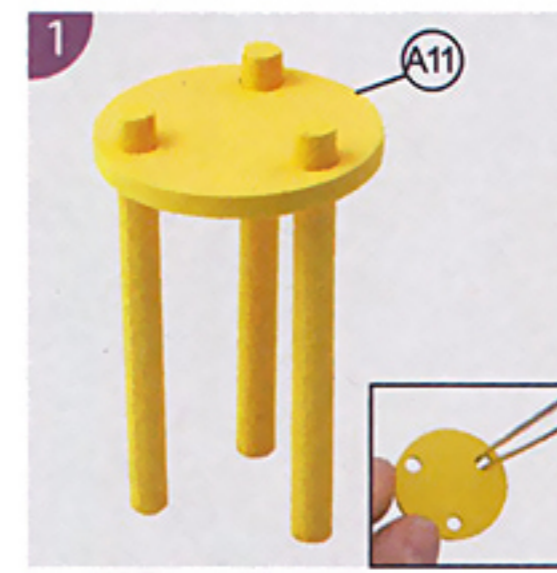
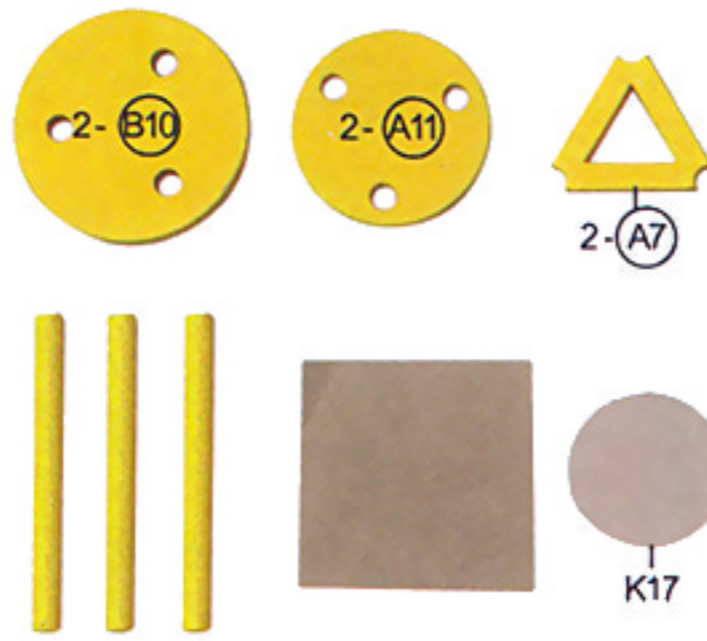

Assemble as shown.

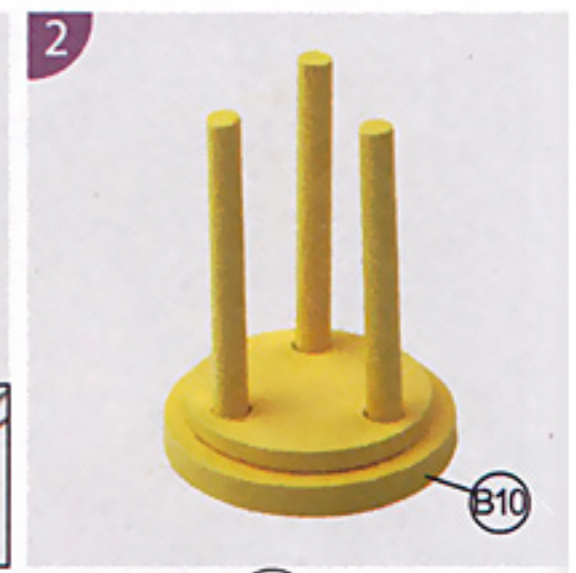

Paste B10 with A11.



Assemble A7.

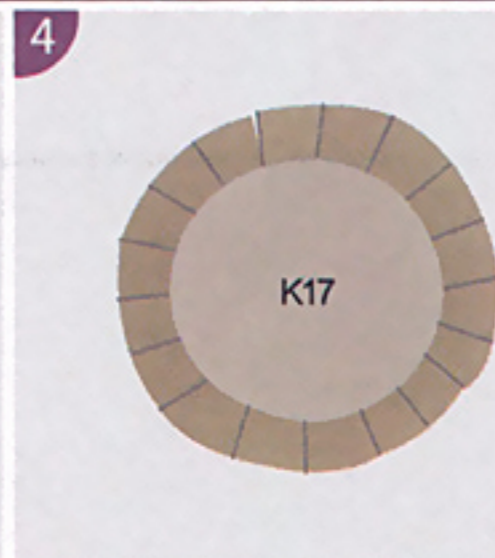

Cut K17 as shown.

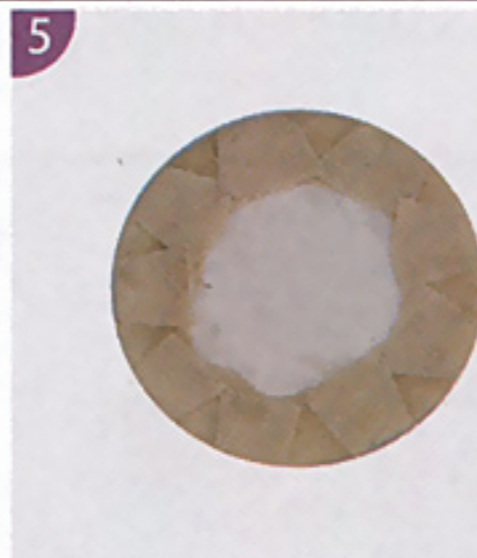

Paste as shown.



Complete.



Small Table

List

- ① Wooden pieces 1 pcs
- ② Brown thin wire L380mm (Bag No.4)

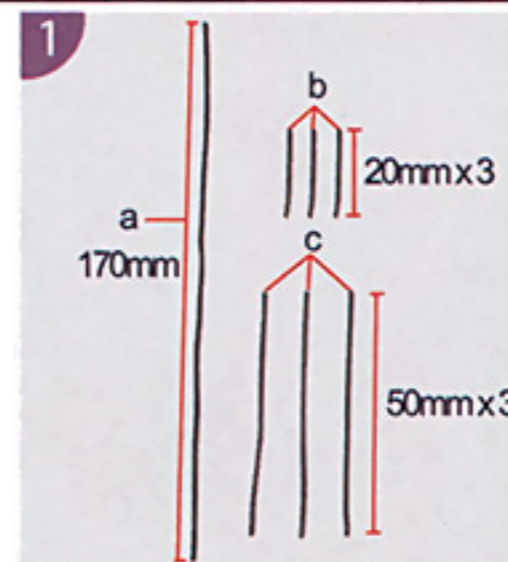

Cut brown wire as shown.

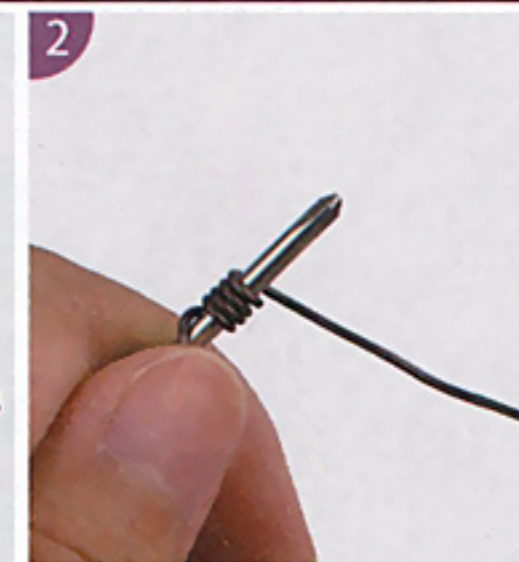

Bend 'a' as shown with screwdriver.

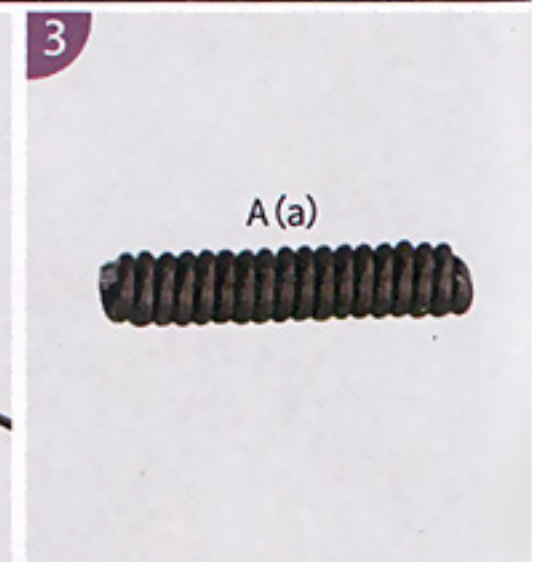

Cut the ends well.

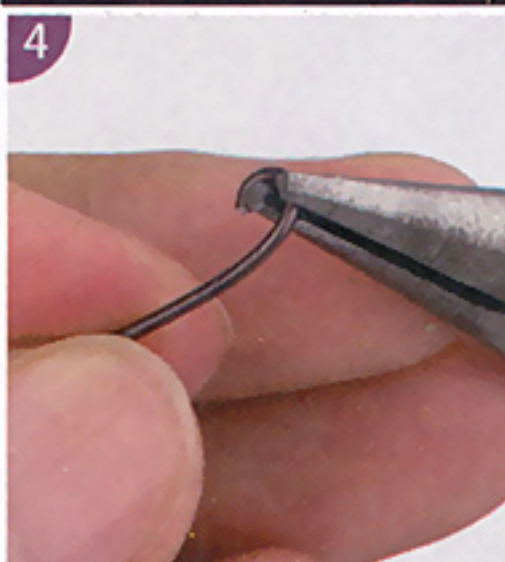

Bend "b" as shown.

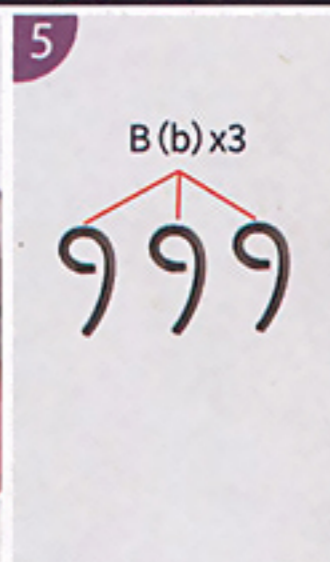

Three B in total.

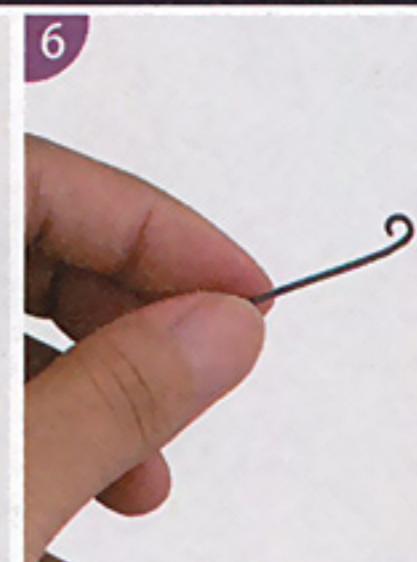

Bend "c" as shown in the same way.

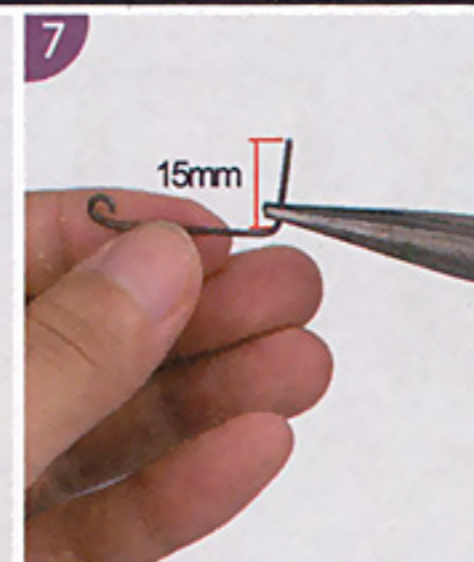

Bend another side of "c" as shown.

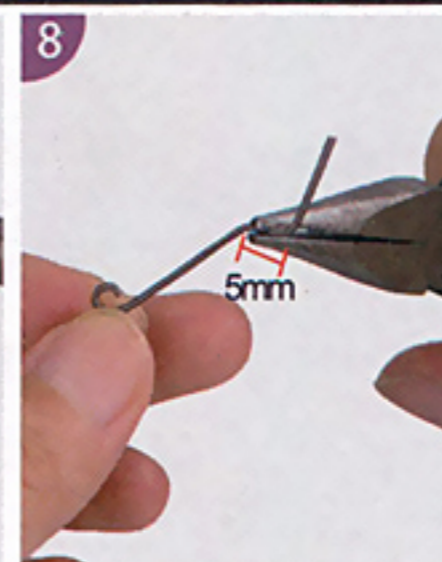

Bend as shown.

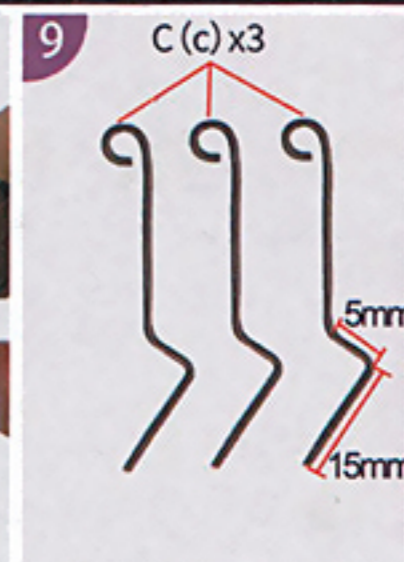

Three C in total.



Glue at one end of "A".

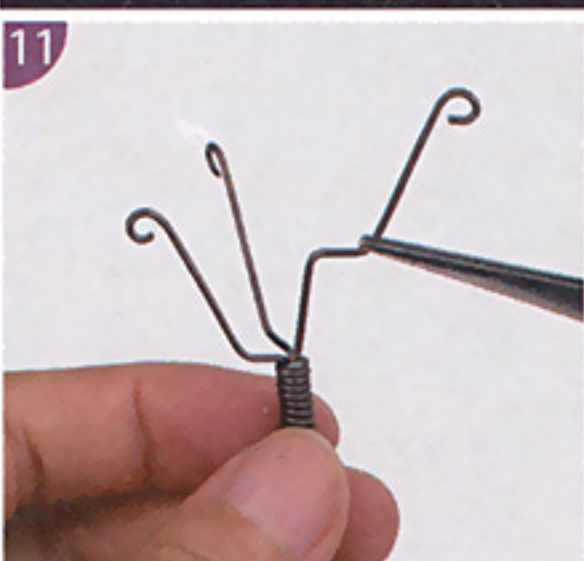

Insert C into the glued end of "A".



Glue at the other end of "A", insert B into it.



Fix A6 as shown.



Small box

List

- ① Wooden pieces 9 pcs

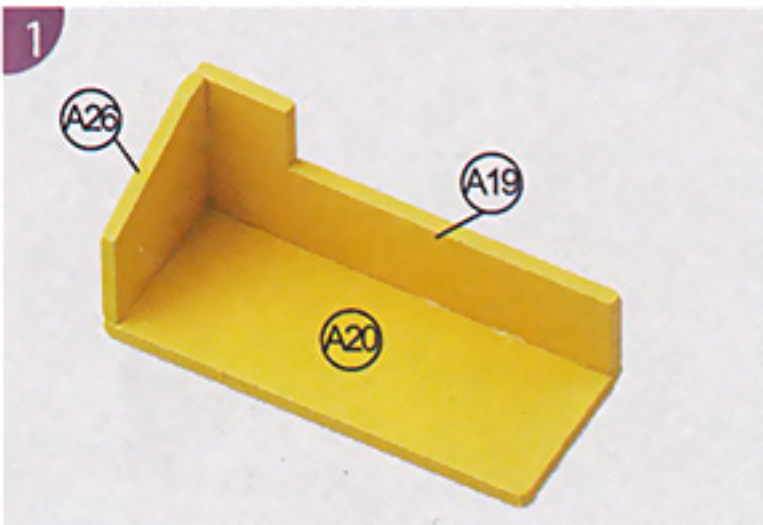
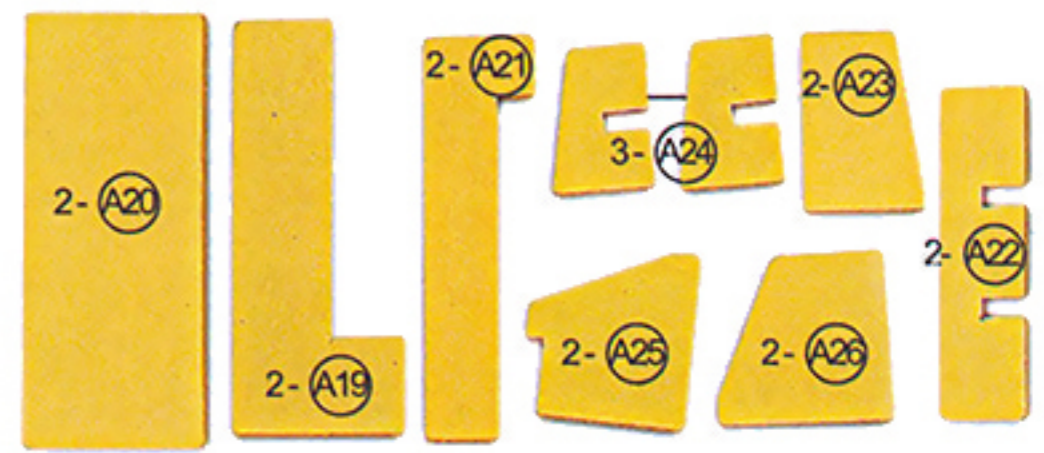

Paste as shown.

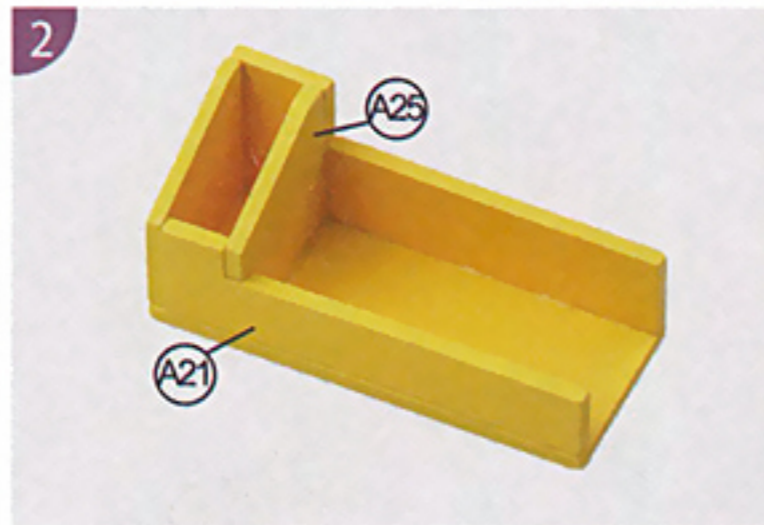

Paste as shown.

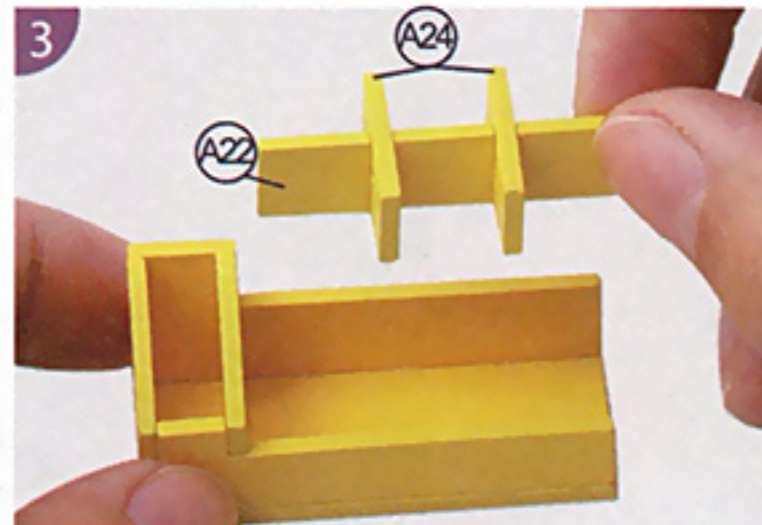

Paste as shown.

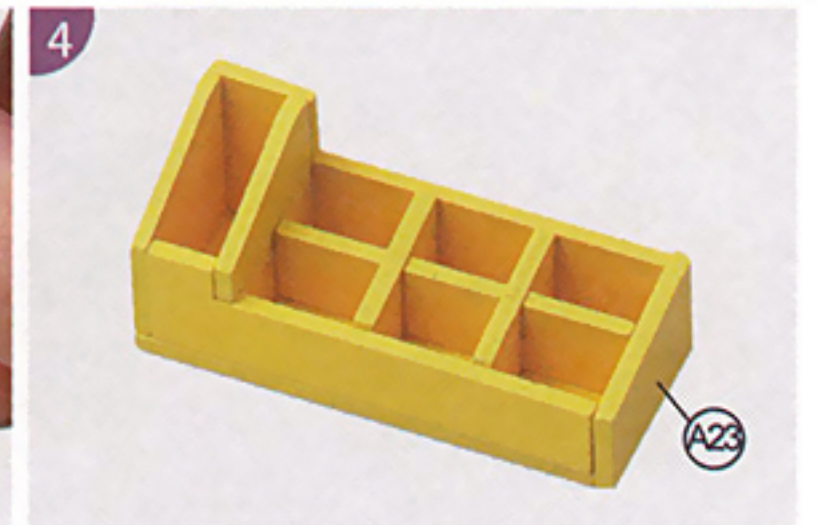

Complete.



Small Cabinet

List

- ① Wooden pieces 7 pcs

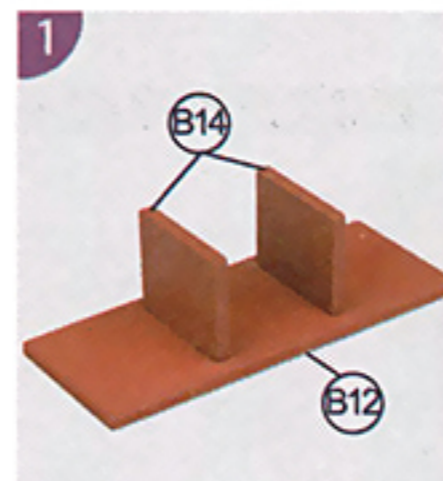
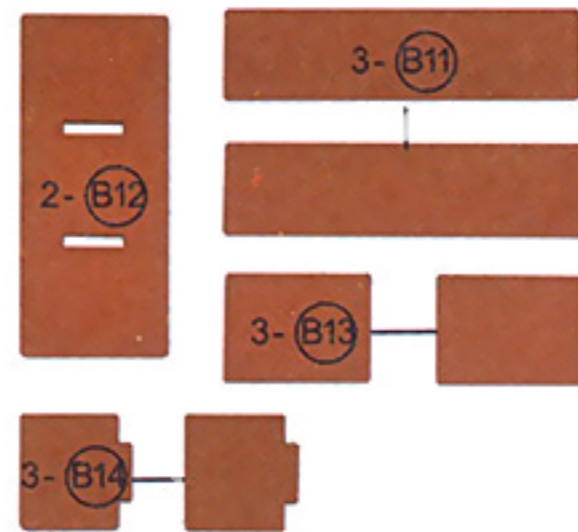

Paste as shown.



Paste as shown.



Complete.



Small square ark

List

- ① Wooden pieces 7 pcs

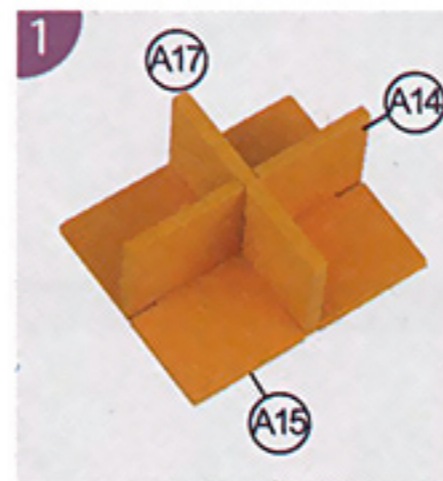
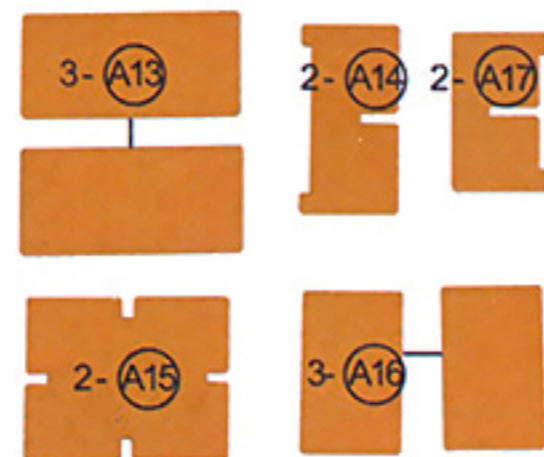

Paste as shown.

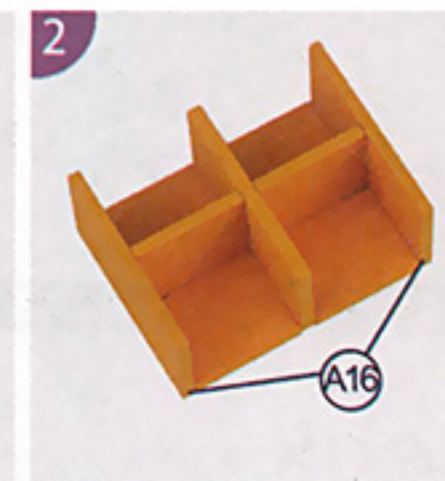

Paste as shown.



Complete.



Painting 1

List

- ① Paper K1*2, K2*4
- ② Wooden pieces 6 pcs

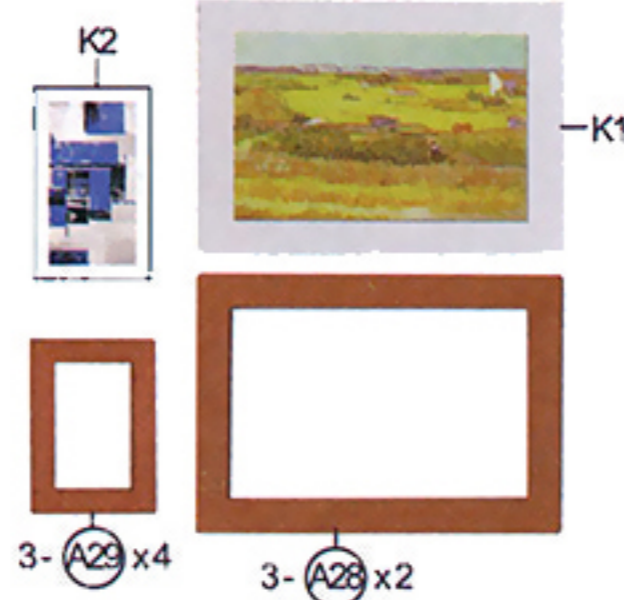

Paste K1 and A28.



Six in total.



Painting 2

List

- ① Paper K4
- ② Wooden pieces 1 pc

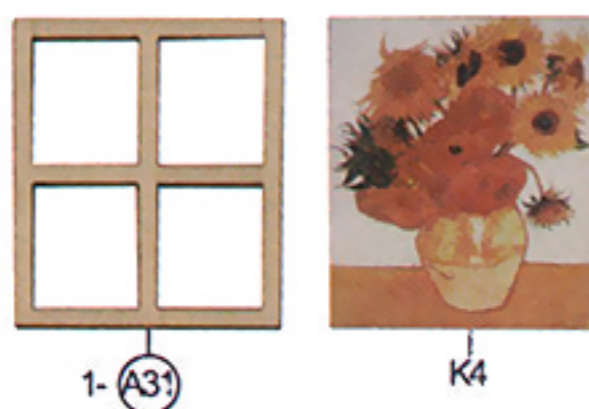

Paste as shown.



Ruler

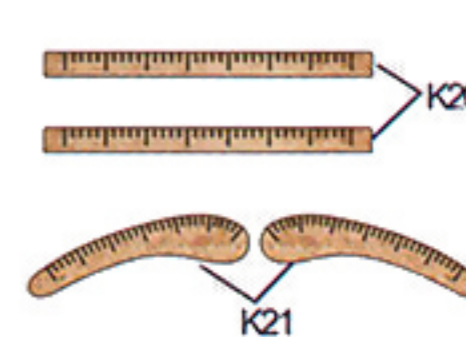

List

- ① Paper K20*2, K21*2



Paste as shown.



Book 1



L1



L2

List

- Paper L1-L4



1 Fold as shown.



2 Fold L1 as shown.

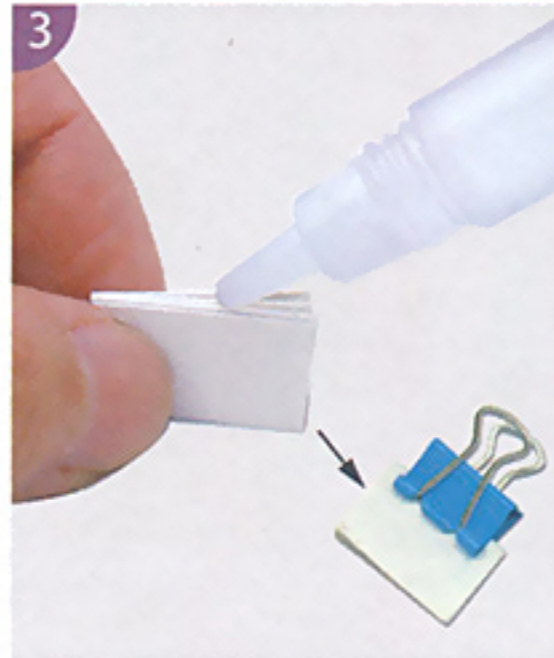

3 Glue the white spine and fix with clip.

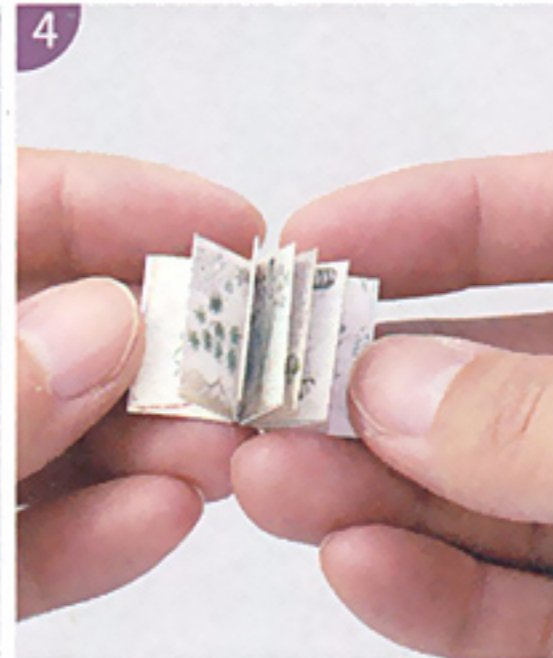

4 Combine book L2 with cover L1.



5 Complete 2 books in the same way.

Book 2

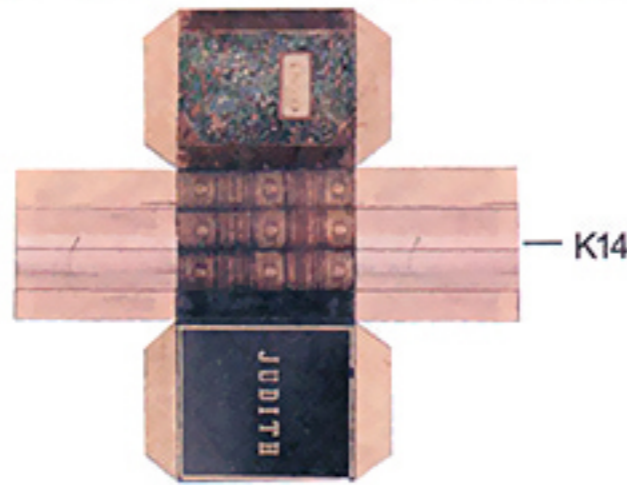

K14

List

- Paper K12, K13, K14



1 Fold as shown.



2 Three books in total.

Book 3



K9

1-A35 x4

List

- Paper K9*4
- Wooden pieces 4pcs

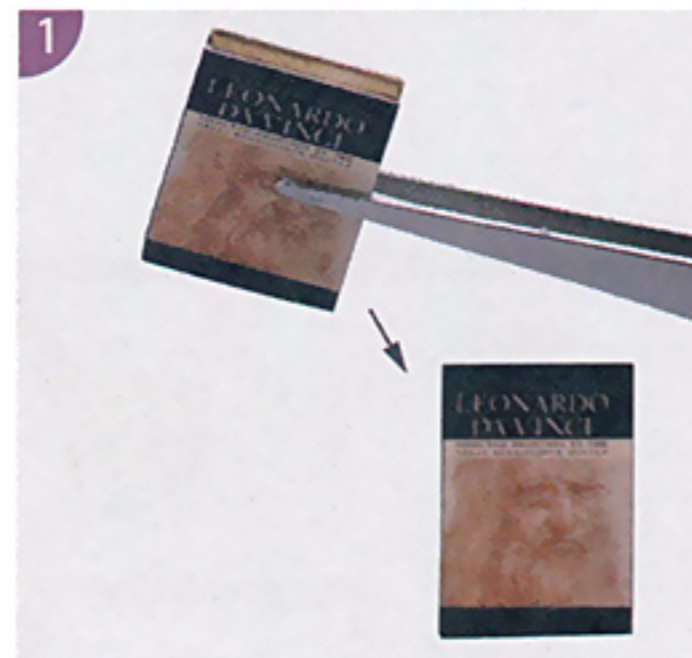

1 Paste as shown.



2 Four books in total.

Paper Bag

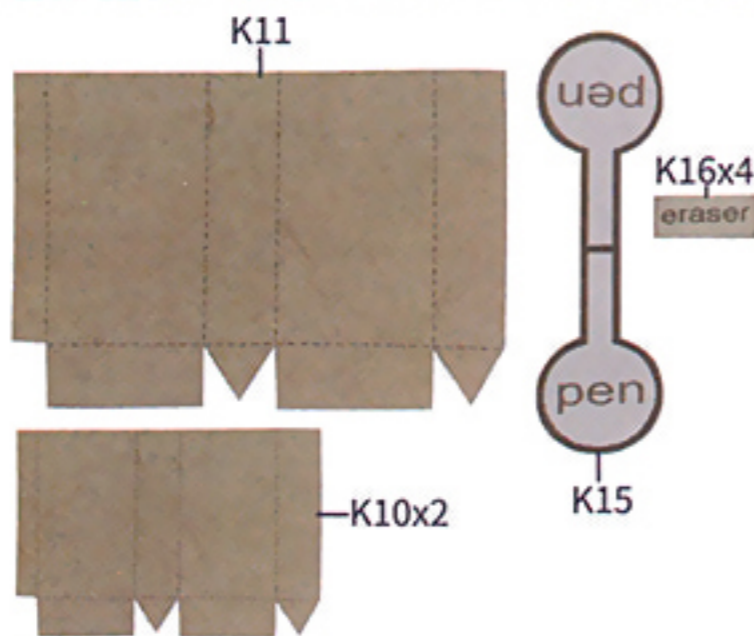

K10x2

K15

List

- Paper K10*2, K11, K15, K16*4

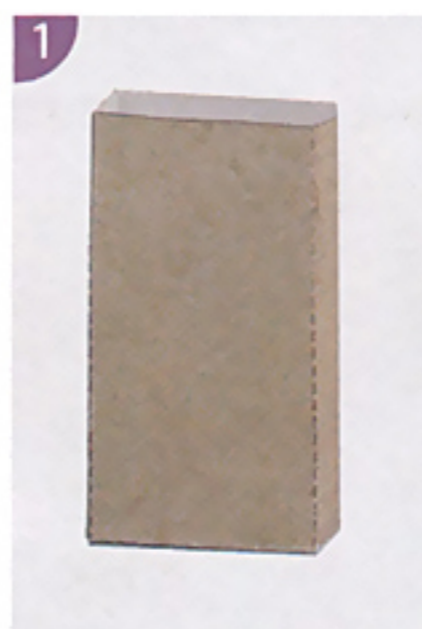

1 Fold K11 as shown.

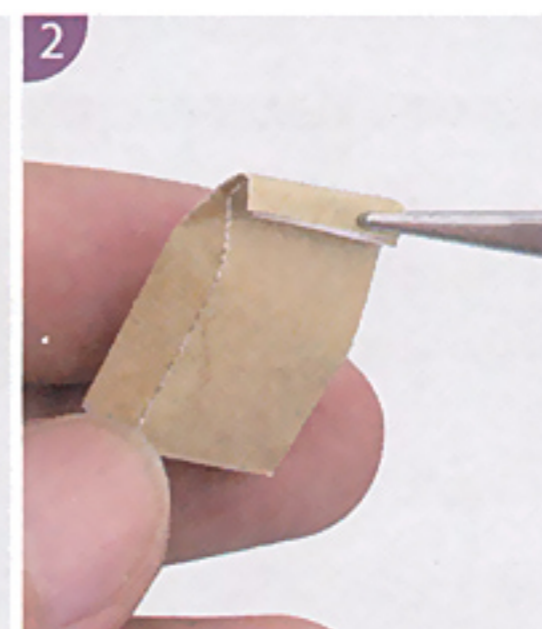

2 Bend the opening of K11 as shown.



3 Paste K15 as shown.



4 Make other two paper bags in same way. (Paste K16 as shown)

Pigments



- 1 Paper K6*12
- 2 Paper K5*12
- 3 Paper K8*12
- 4 Paper D2



Twine and paste as shown.



Twine and paste K5 as shown.

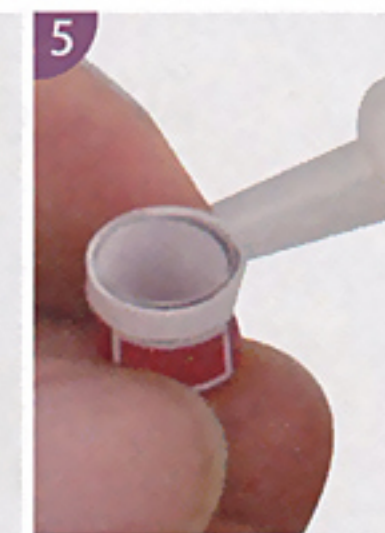
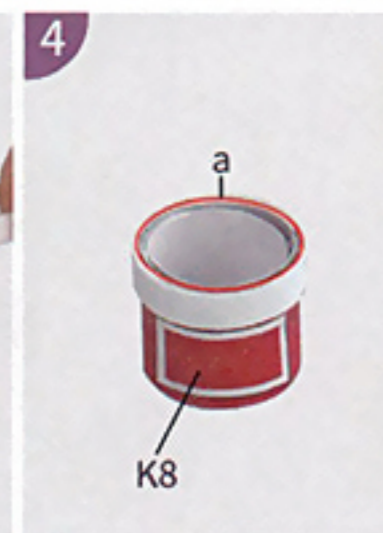
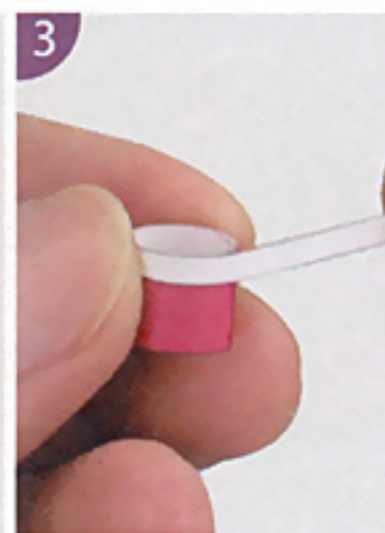

Glue as shown.



Paste as shown

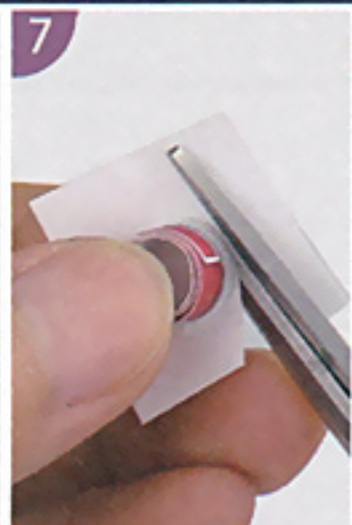

Cut extra paper after drying.



Finish the bottom.



12 pigments in total.

Palette



List

- 1 Transparent paper 25*35 mm 1pc(Bag No.4)
- 2 Paper K22



Cut transparent paper according to edge of K22.



Paste and complete.

Brush

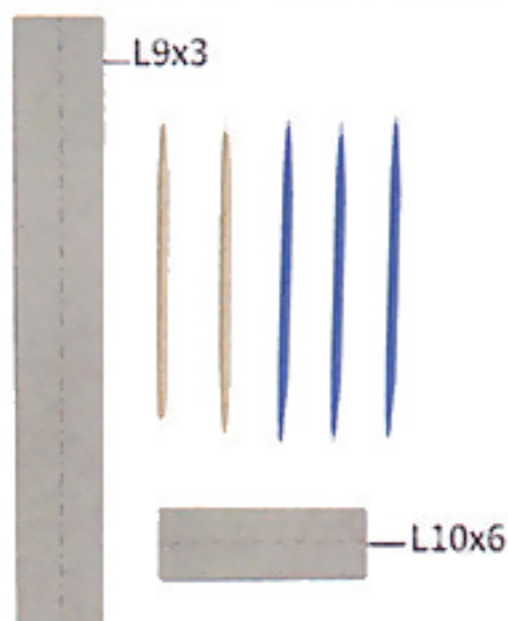
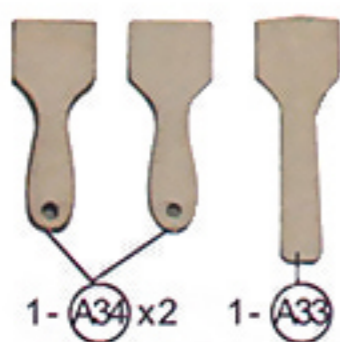

List

- 1 Aluminum sheet 1pc(Bag No.6)
- 2 Wooden pieces 3pcs
- 3 Paper L9*3, L10*6
- 4 Wooden toothpick 2 pcs (Bag No.5)
- 5 Blue toothpick 3 pcs (Bag No.5)

Keep one toothpick in Bag No.5 for the following steps.

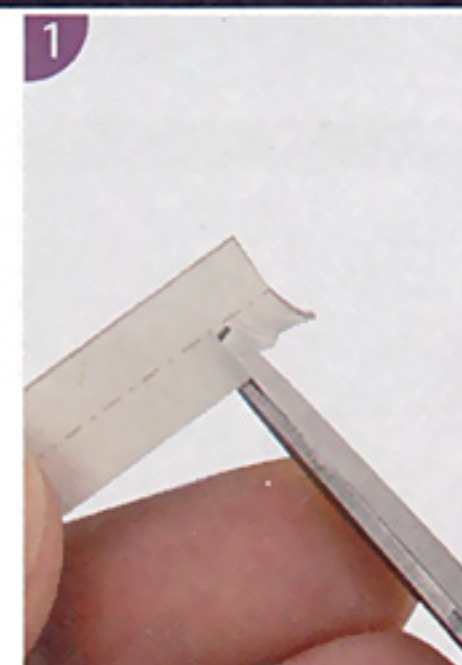

Cut L9 as shown.

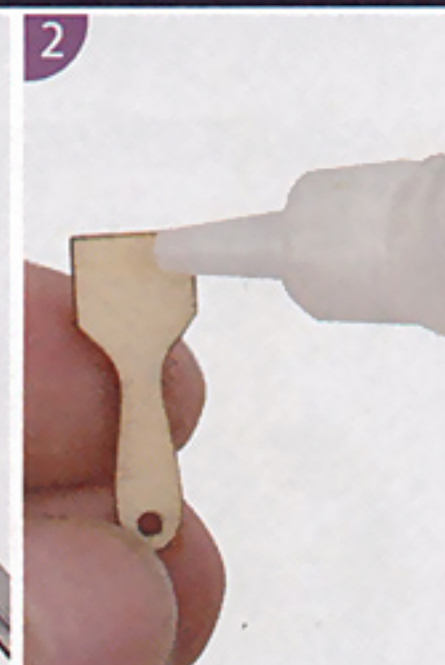

Glue as shown.



Twine L9 on A34.

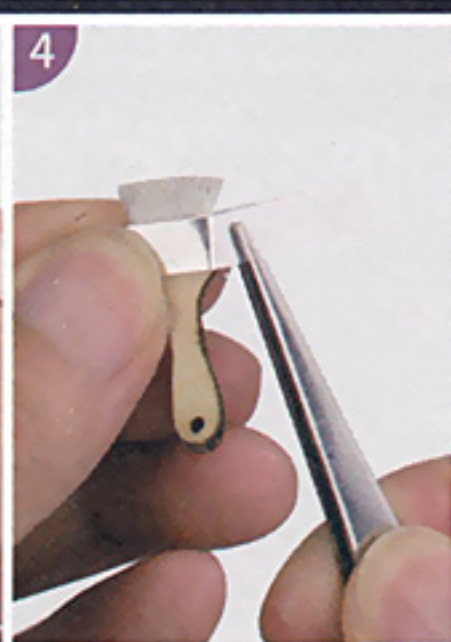

Cut aluminum sheet (5*25mm), wrap and paste



Fix with clipper.

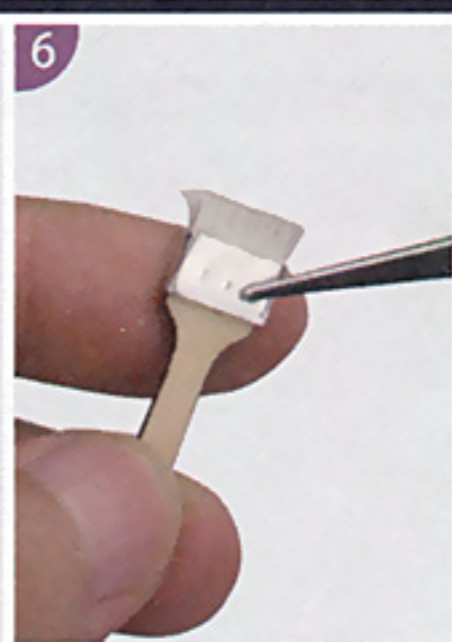

Mark with tweezers.



Make three brushes in same way.

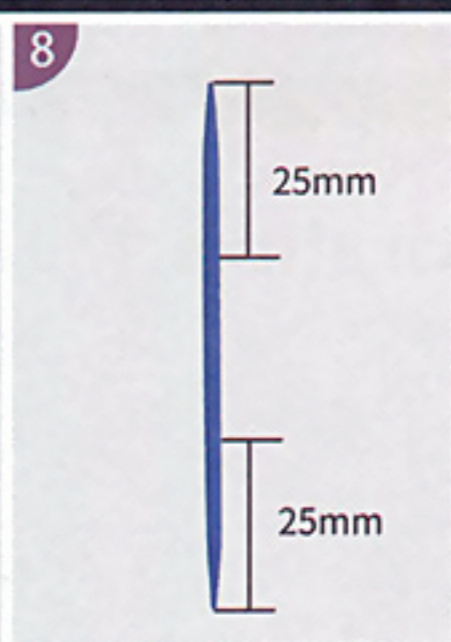

Mark on blue toothpick as shown.

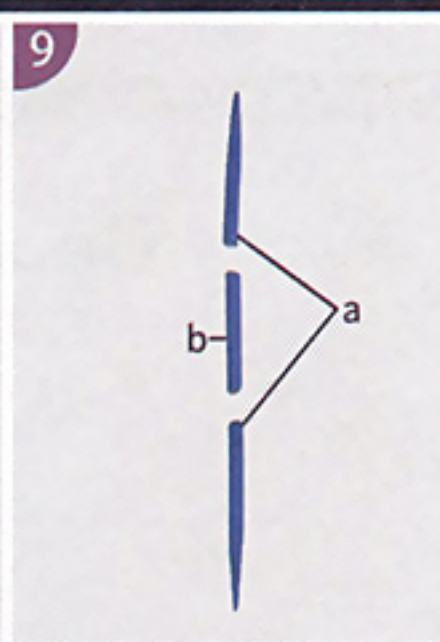

Cut blue toothpick into 3 sections.

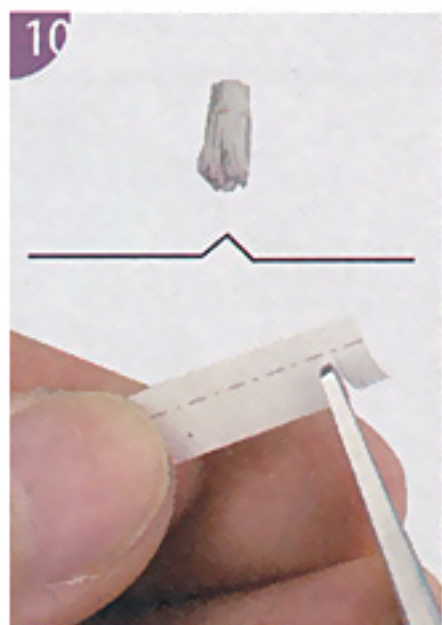

Cut, curl and paste L10 as shown.

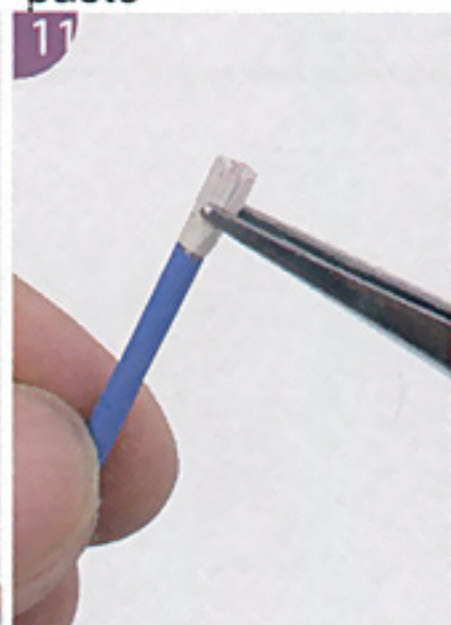

Polish brush edge of "a" and glue as pic, paste as shown.

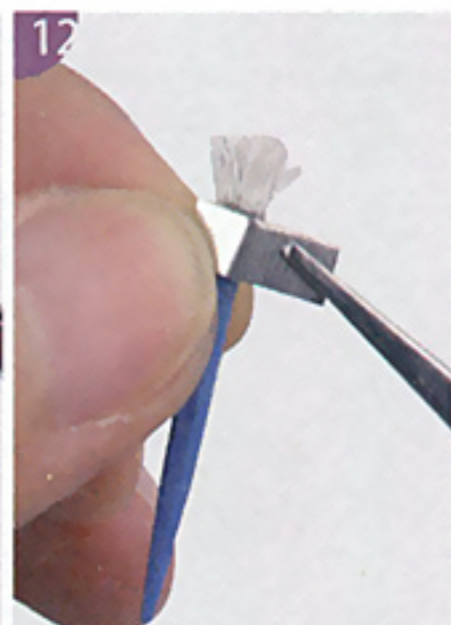

Cut aluminum sheet (5*15mm), wrap and stick it as shown.



Make six brushes in the same way.

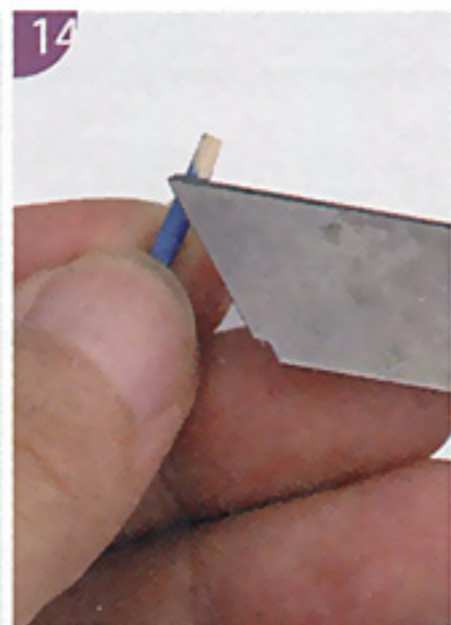

Sharpen one end of "b".



Blackening as shown.



Complete the collection.



Plant 1



List

- ① Green paper 1pc (bag No.4)
- Orange paper 1pc (bag No.4)
- Yellow paper 1pc (bag No.4)
- ② Yellow stamen 4pcs (bag No.4)
- ③ Coppery flowerpot 1pc (bag No.6)



Cut as shown(size 10*10mm).
8pcs in total.

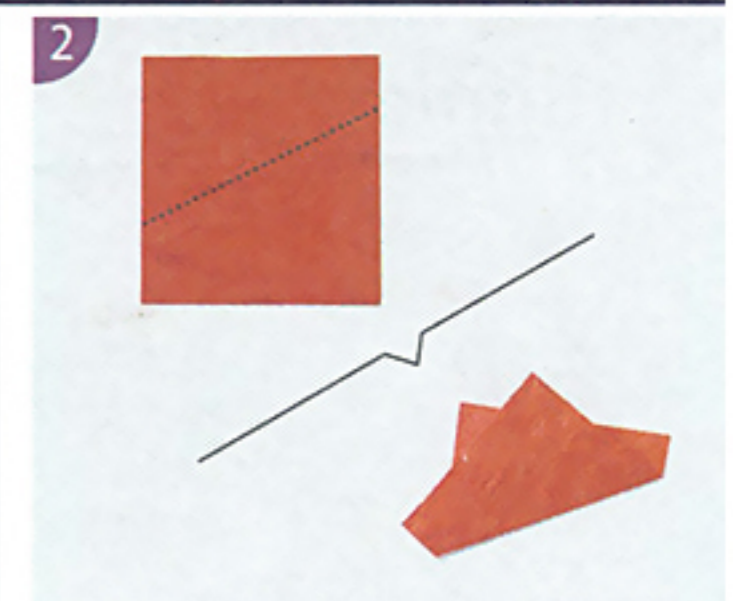

Fold as shown.



Wrap and glue.



Complete 8pcs in total.



Cut the green paper(size 30*30mm) as shown.

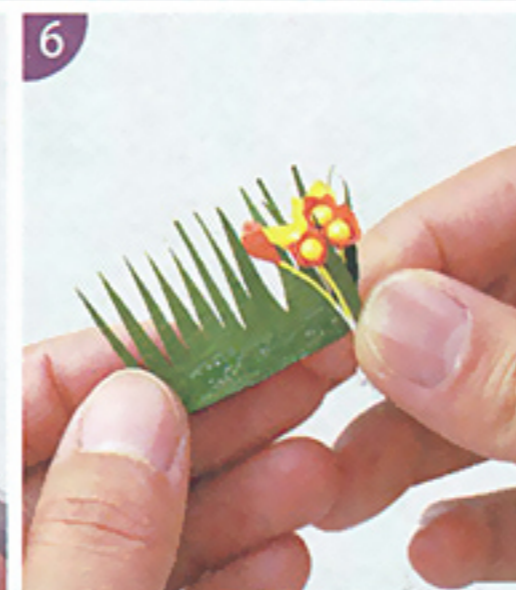

Paste as shown.



Complete.



Plant 2



List

- ① Green tree powder 1pc (Bag No.4)
- ② Green beads 1pc (Bag No.4)
- ③ Big golden torus 1pc (Bag No.6)



Glue as shown.



Paste as shown.

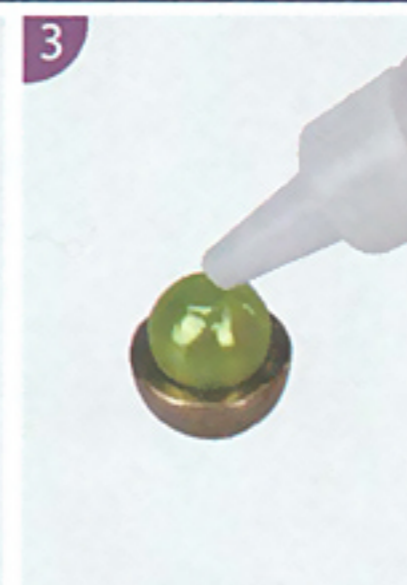

Glue one green bead.



Scatter green tree powder as shown.

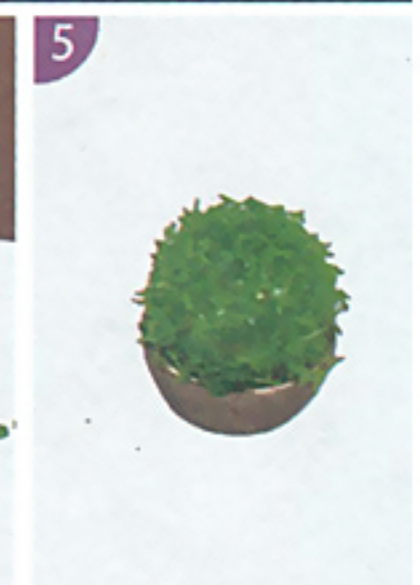

Complete.

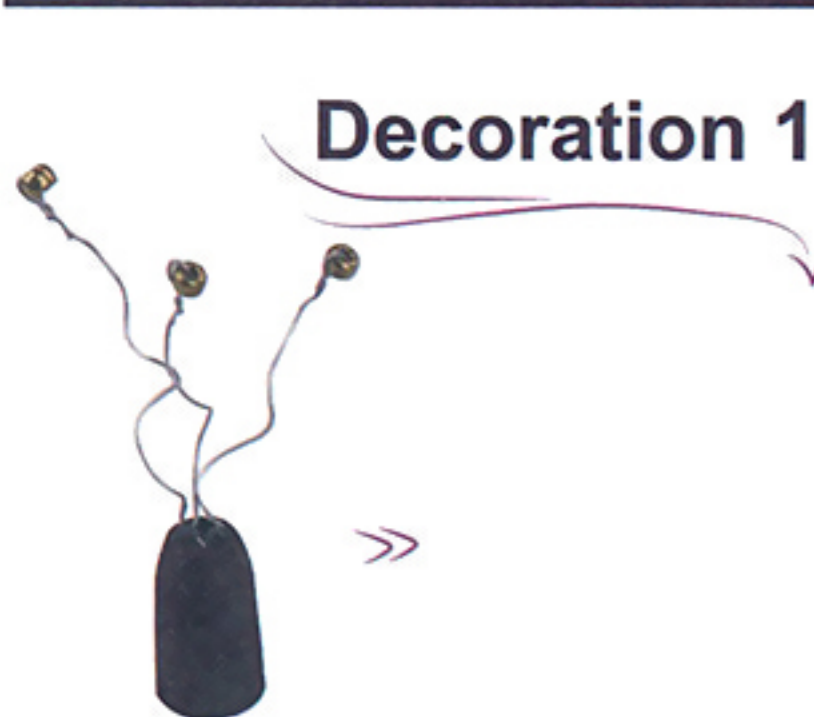

Decoration 1



List

- ① Silver wire 1pc (bag No.4)
- ② Black flowerpot 1pcs (bag No.6)
- ③ Small golden beads 3pc (bag No.6)



Cut wire (50mm) and pass it through bead and twine as shown.

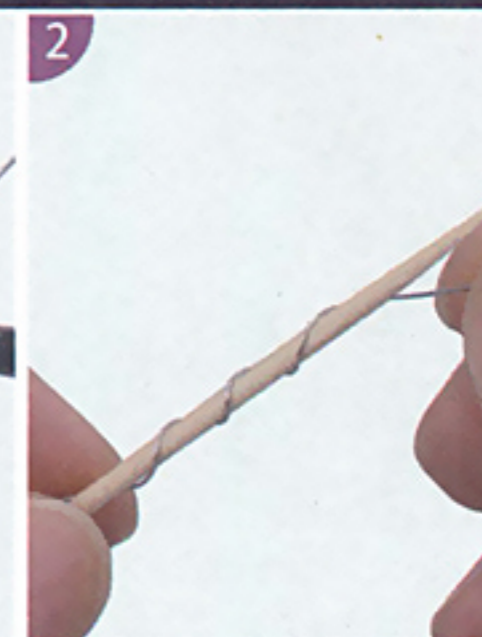

Twine on toothpick as shown.

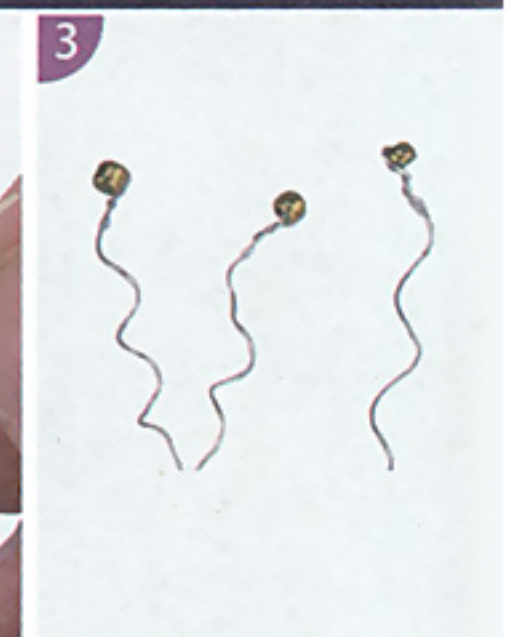

Complete the collection.

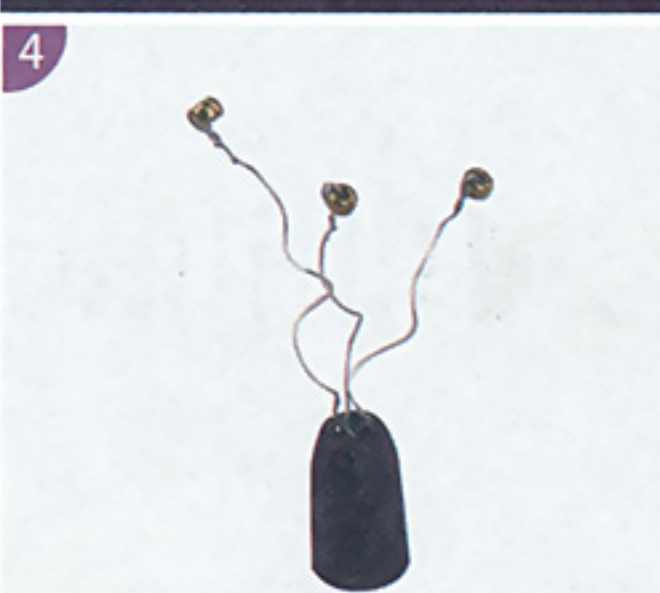

Glue at black flowerpot, and insert step3 into it.

Decoration 2

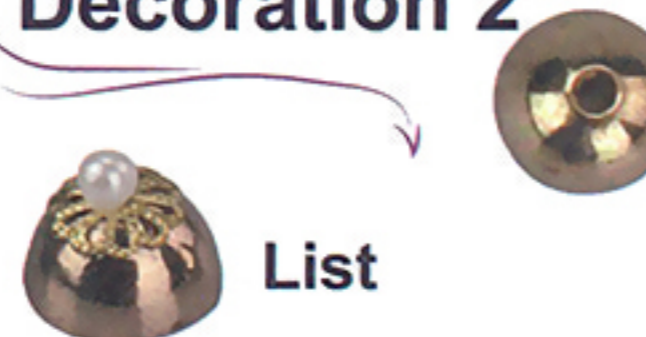

List

- ① Big golden torus 1pc (Bag No.6)
- ② Small golden torus 1pc (Bag No.6)
- ③ Small white bead 1pc (Bag No.6)



Glue as shown.



Paste as shown.



Complete.

Furniture (Do your own house. Below is for your reference.)



Small Green Window



List

- 1 Big transparent sheet
1pc (Bag No.4)
- 2 Wooden pieces
14 pieces

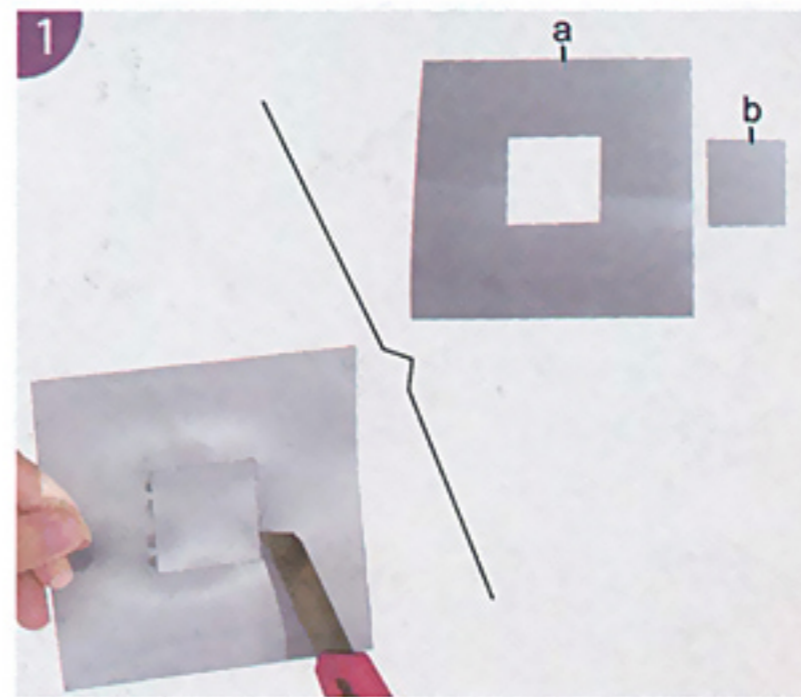
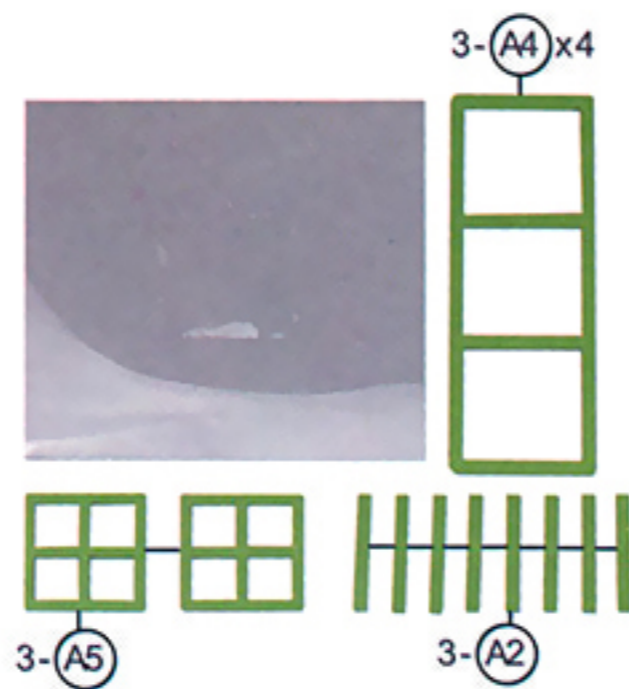

Separate big transparent sheet into two parts 'a' and 'b'.

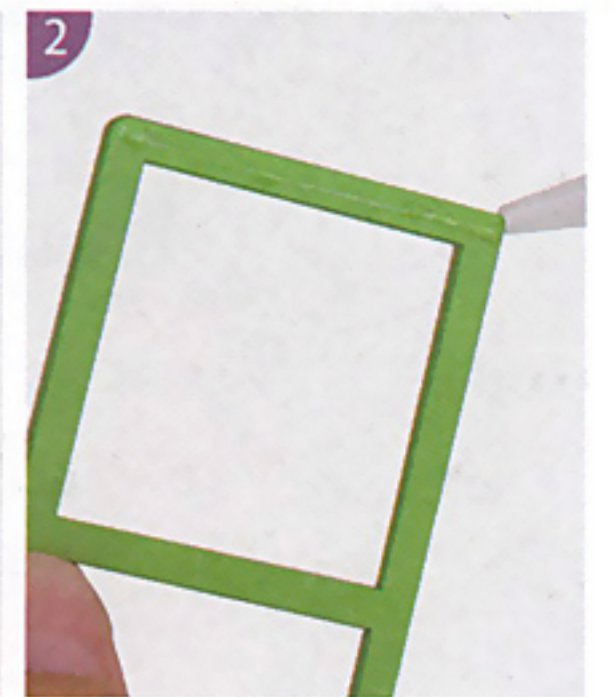

Glue the edge of A4.

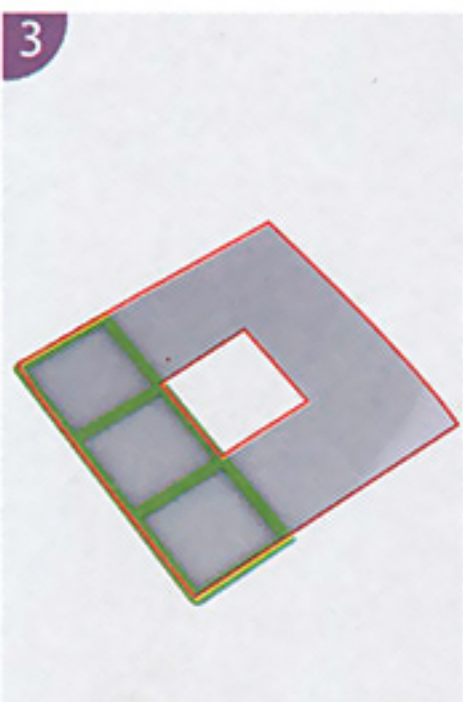

Paste as shown.
(Notice the direction of A4)

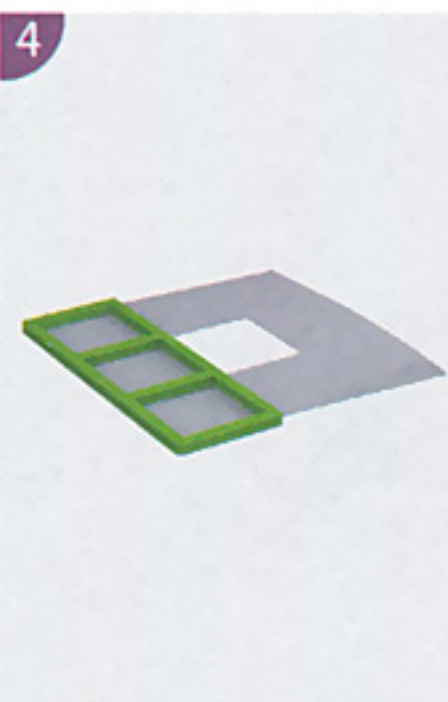

Paste as shown.

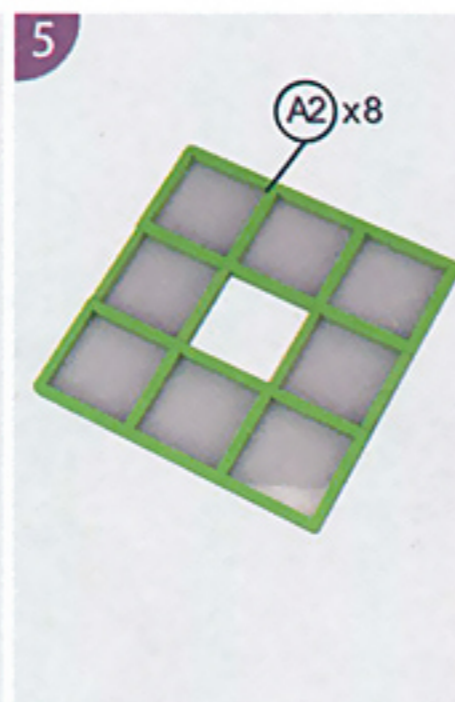

Paste as shown.

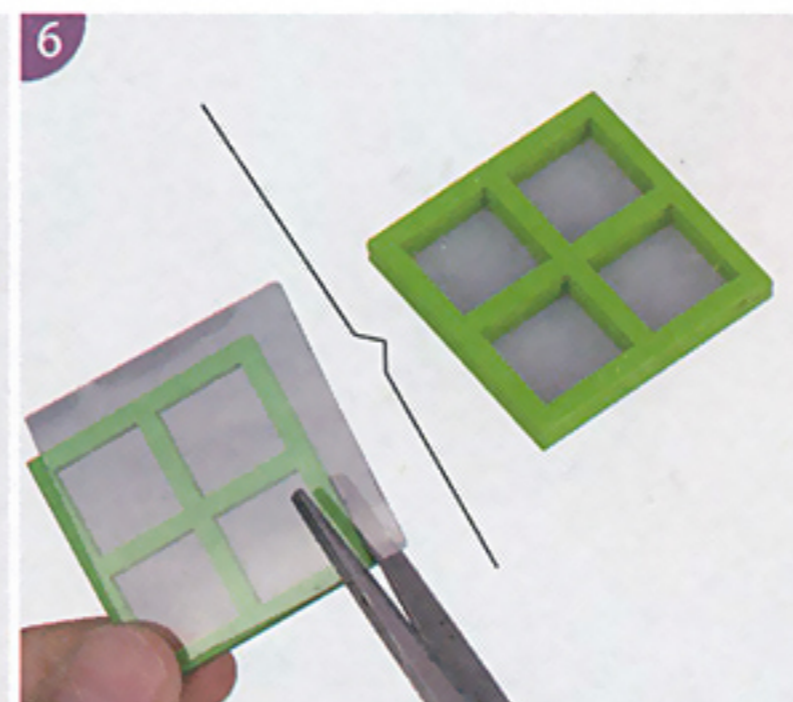

Cut extra parts as shown, and paste as shown. (Transparent sheet should not be exposed)

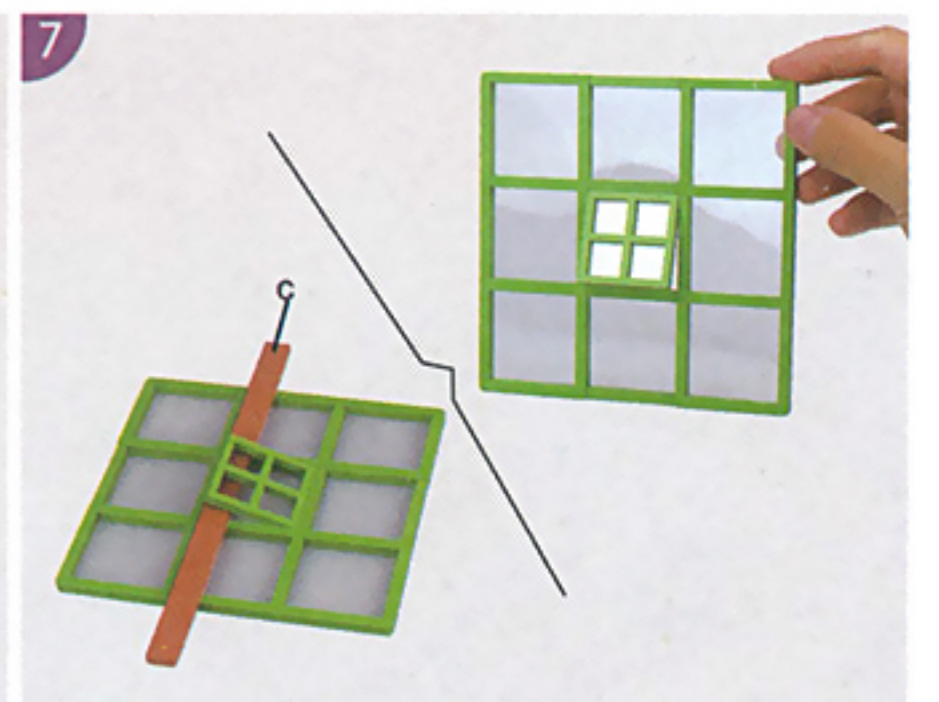

Paste and fix it with "C" and return "c" to bag.

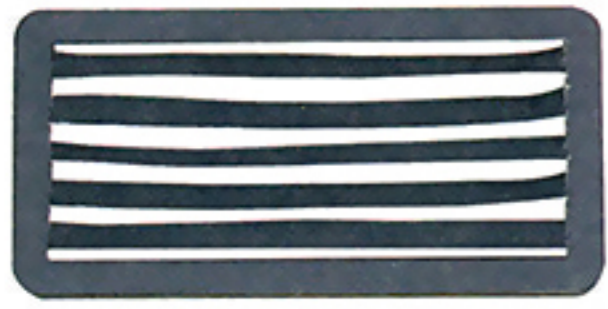

Exhaust Fan

List

- ① Wooden pieces
- ② Paper L7, L8

1pc

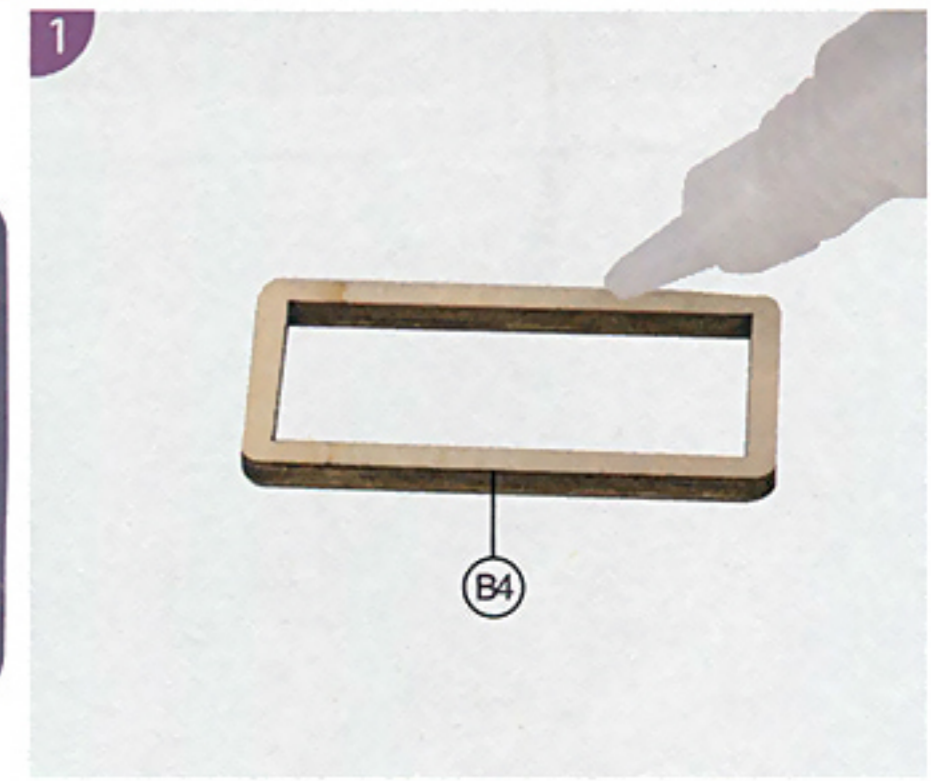
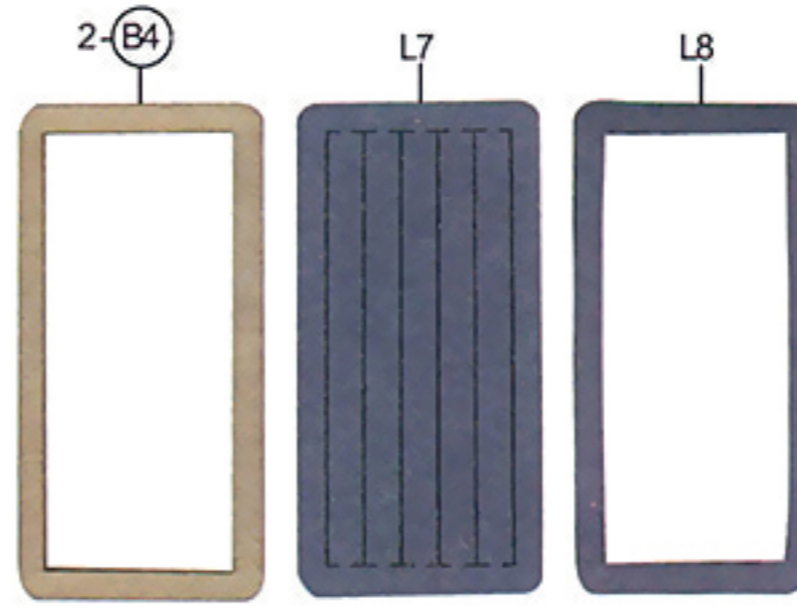

Glue as shown.

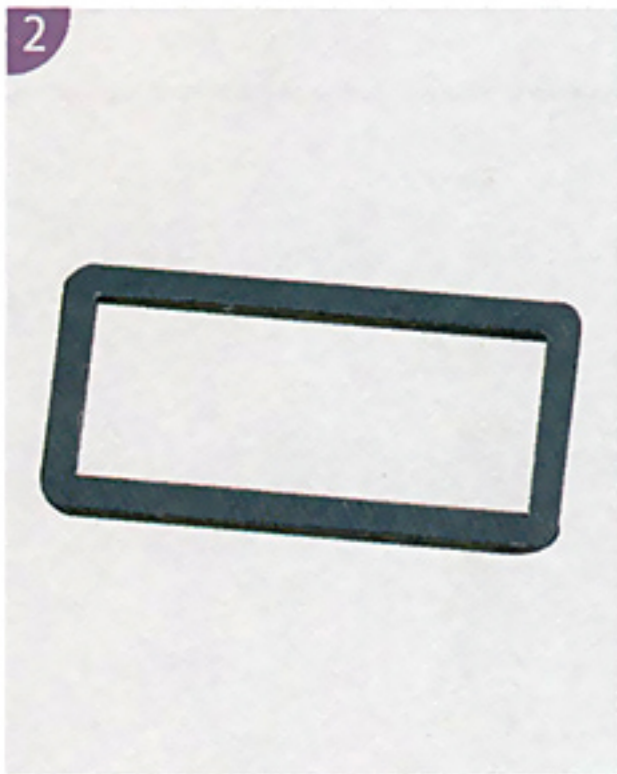

Paste L8 on (B4)



Cut L7 along the solid line.



Paste L7 on the other side of (B4).

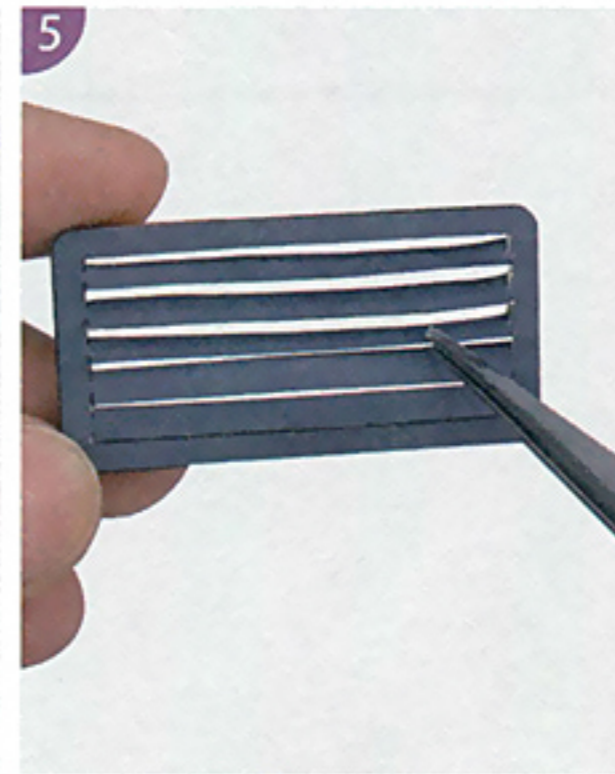

Adjust with tweezers carefully as shown.



Complete.



Frame

List

- ① Wooden pieces 8pcs
- ② Paper L5, K23

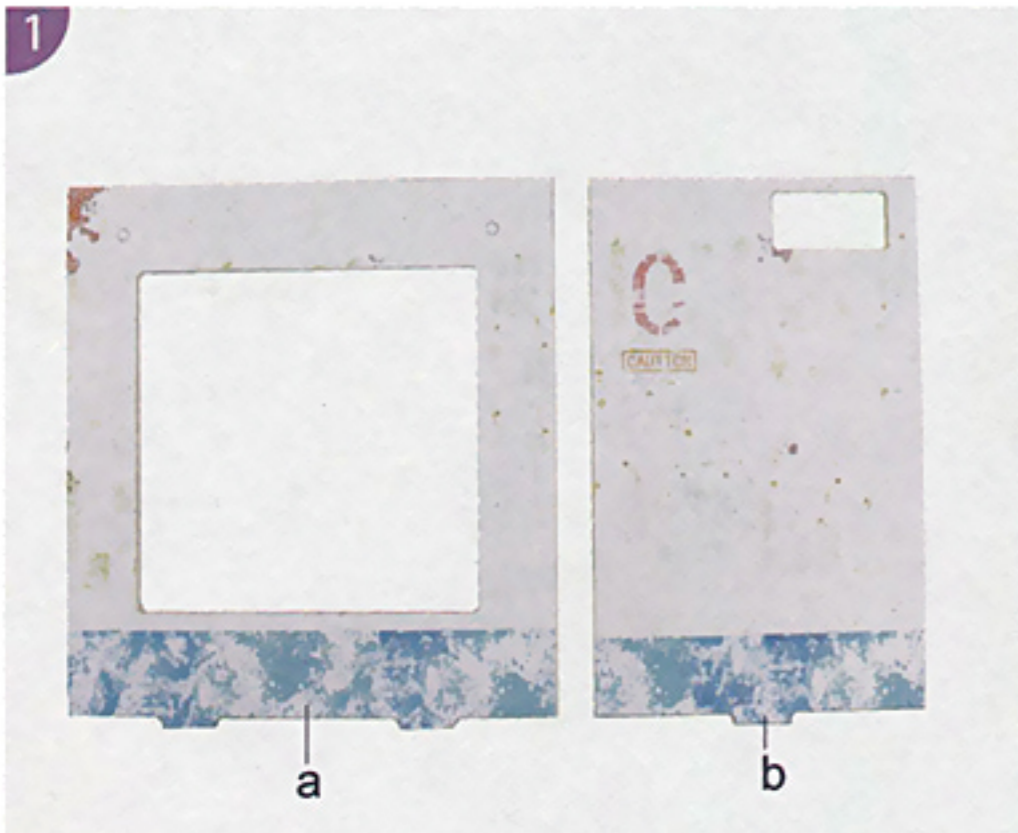
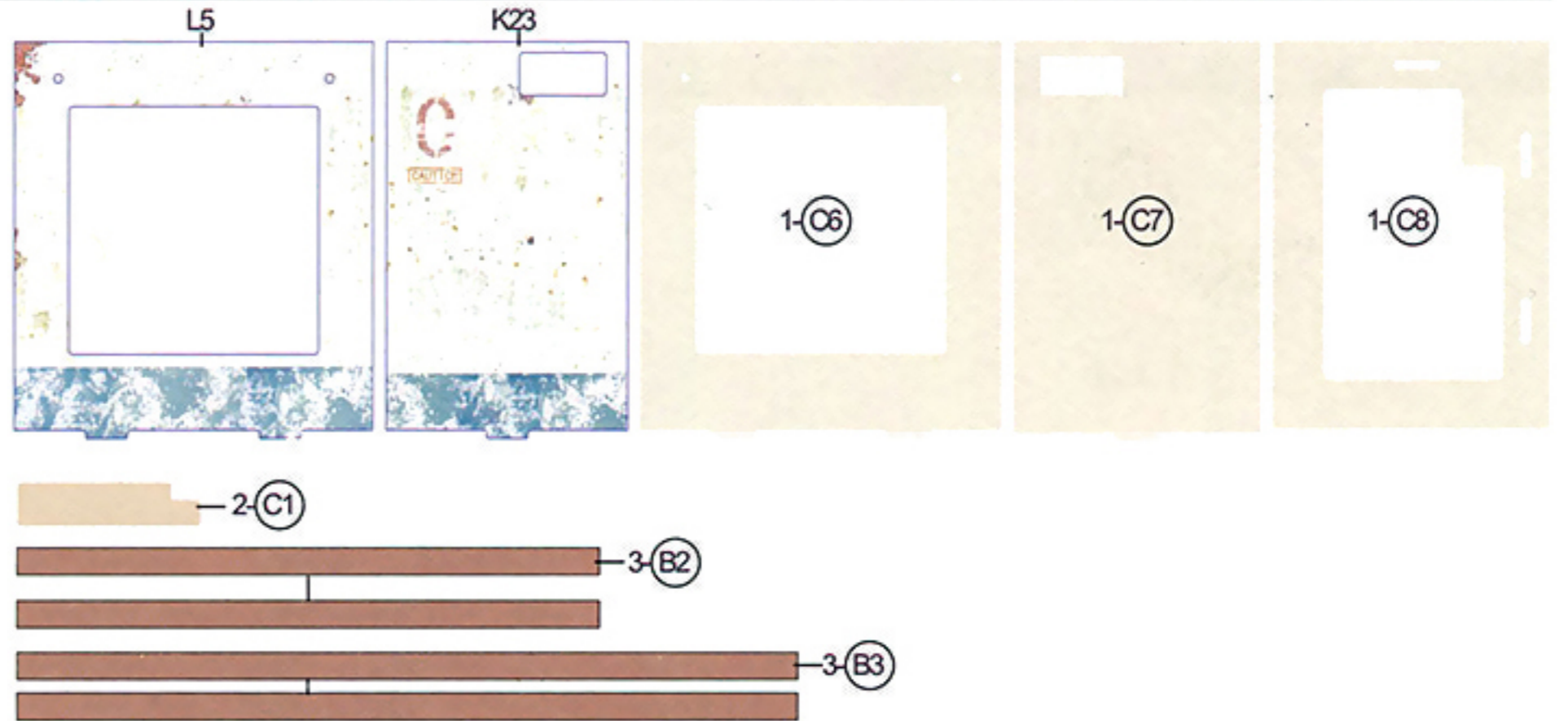

Paste L5 on (C6), K23 on (C7) (Paper should be pasted on the side without painting)

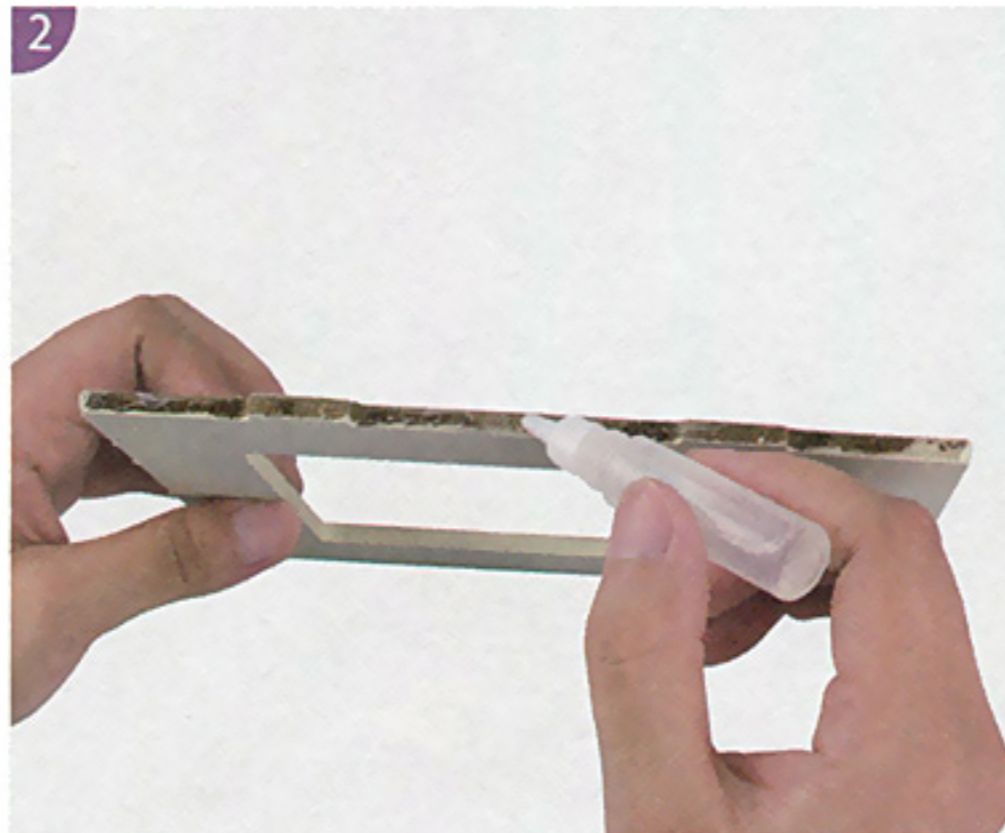

Glue at "a" as shown.

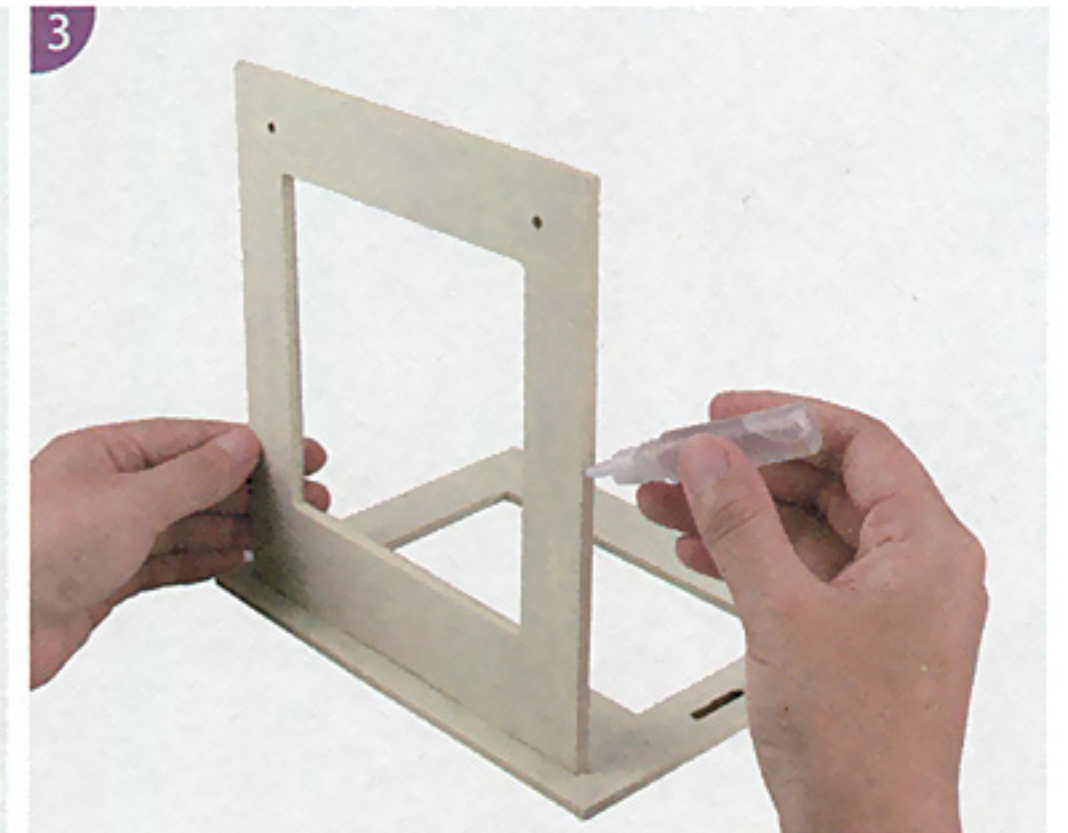

Paste "a" on C8 as shown

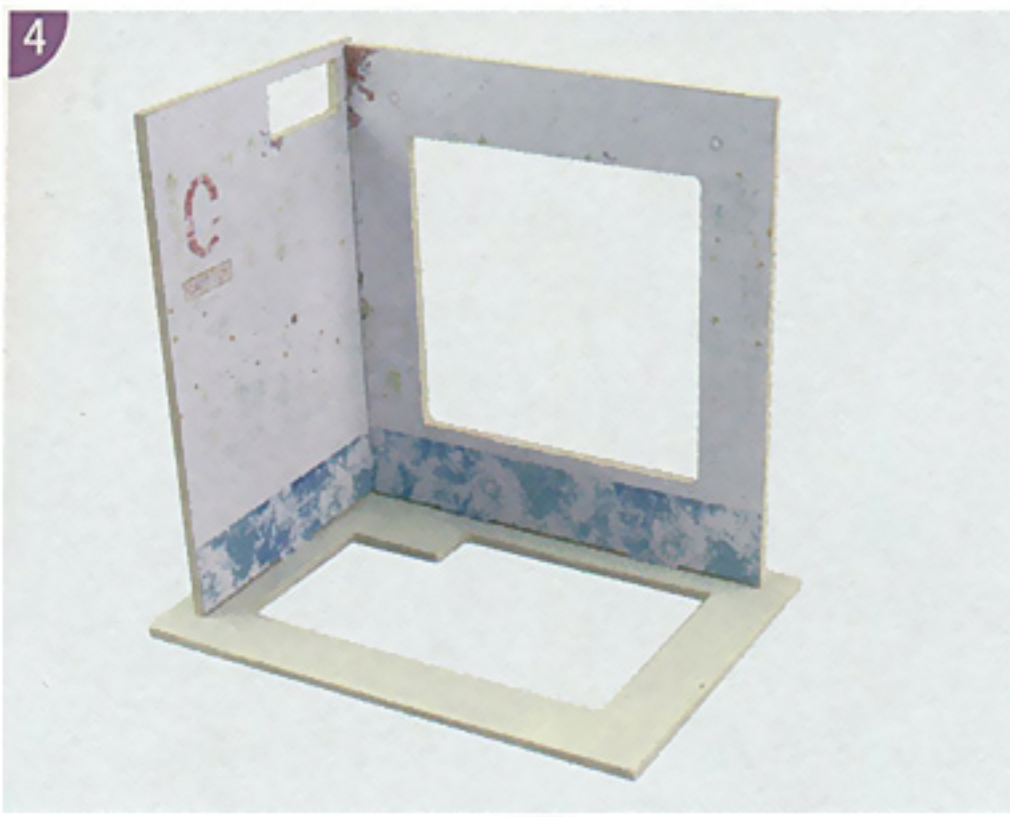

Paste "b" on (C8) as shown.

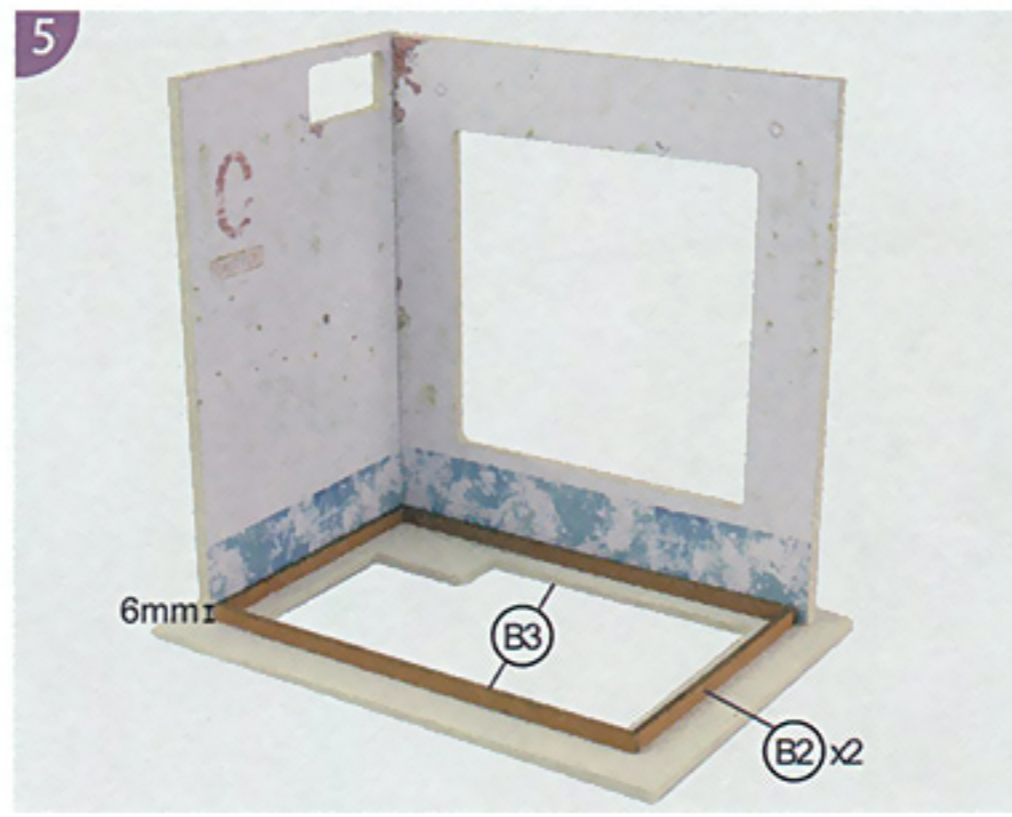

Paste as shown (notice the direction)

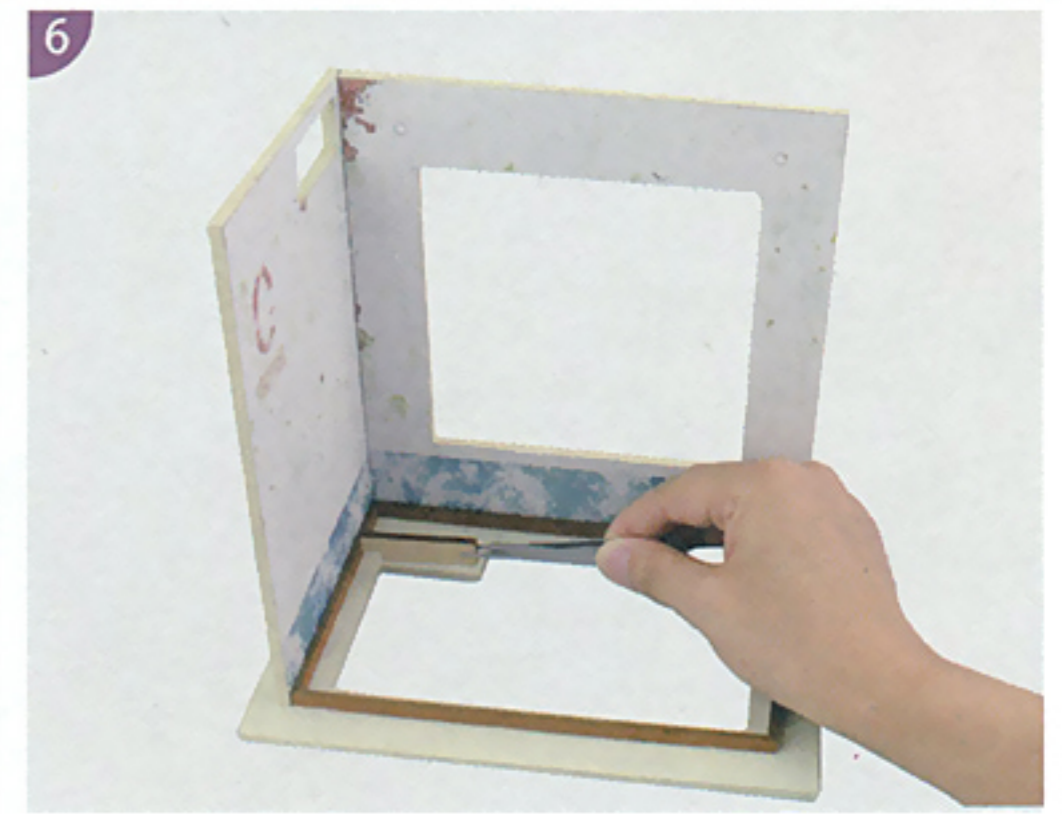

Paste as shown.

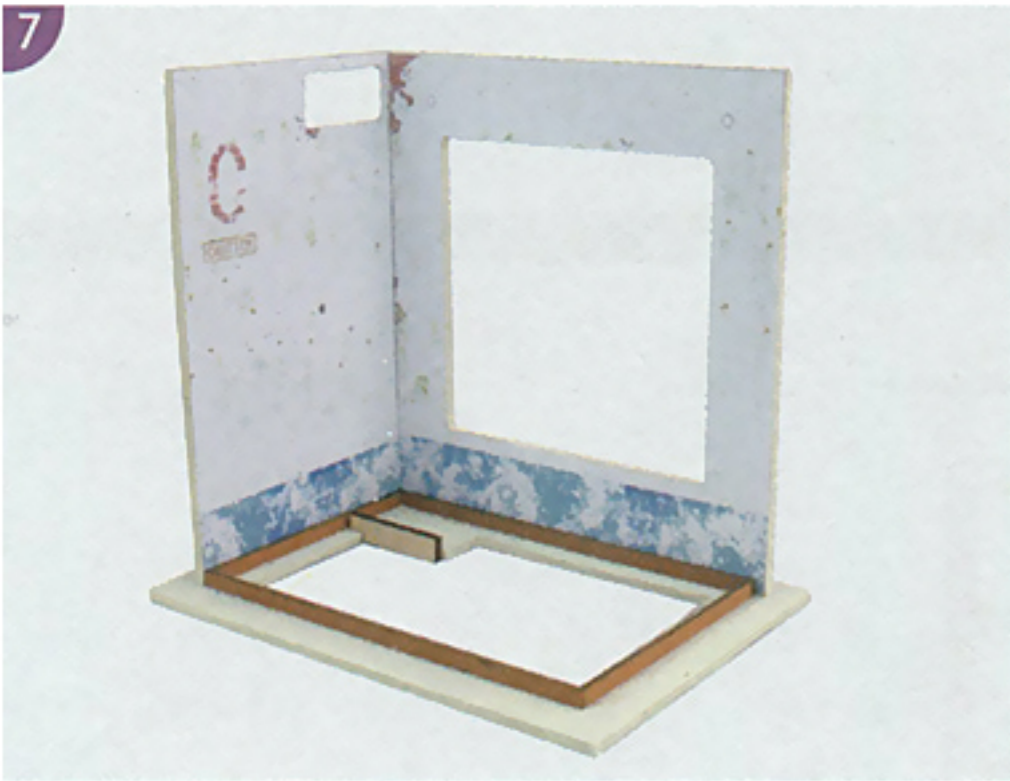

Complete.

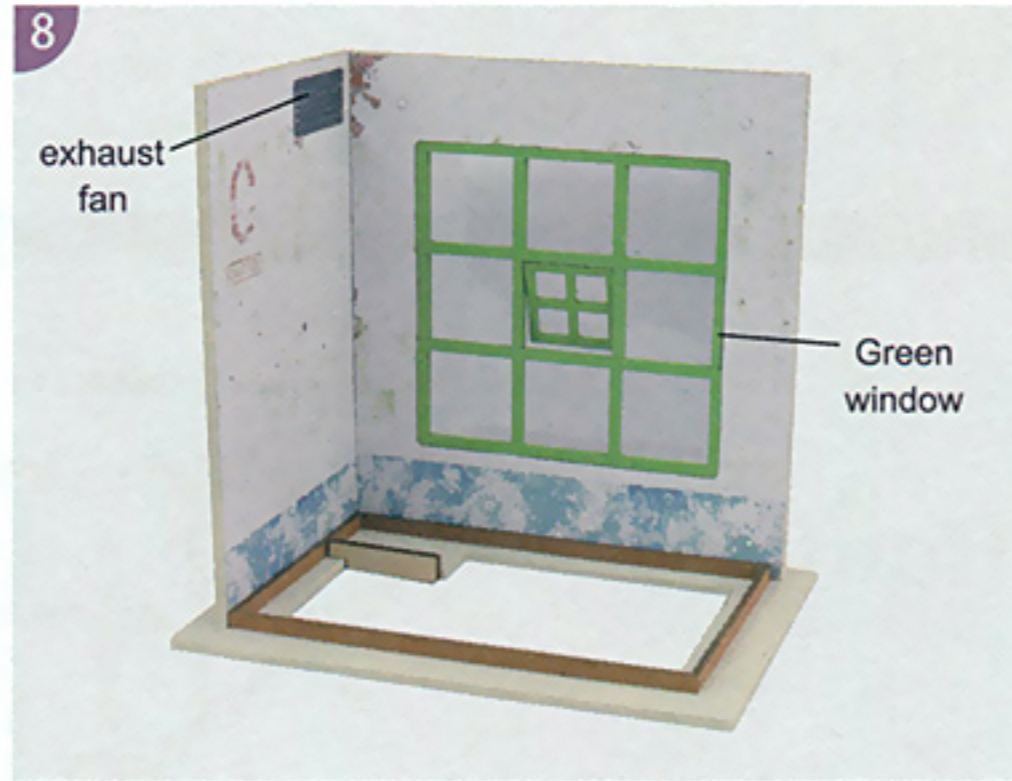

Glue on exhaust fan and little green window, paste as shown.

Curtain

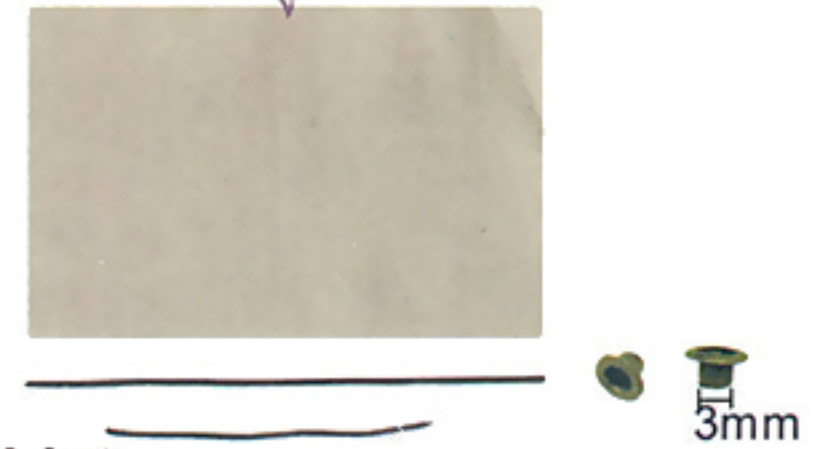

List

- Fabric 1pc (Bag No.4)
- Thin Brown wire 1pc (Bag No.4)
- Thick brown wire 1pc (Bag No.4)
- Airhole(diameter 3mm) 2pcs (Bag No.5)

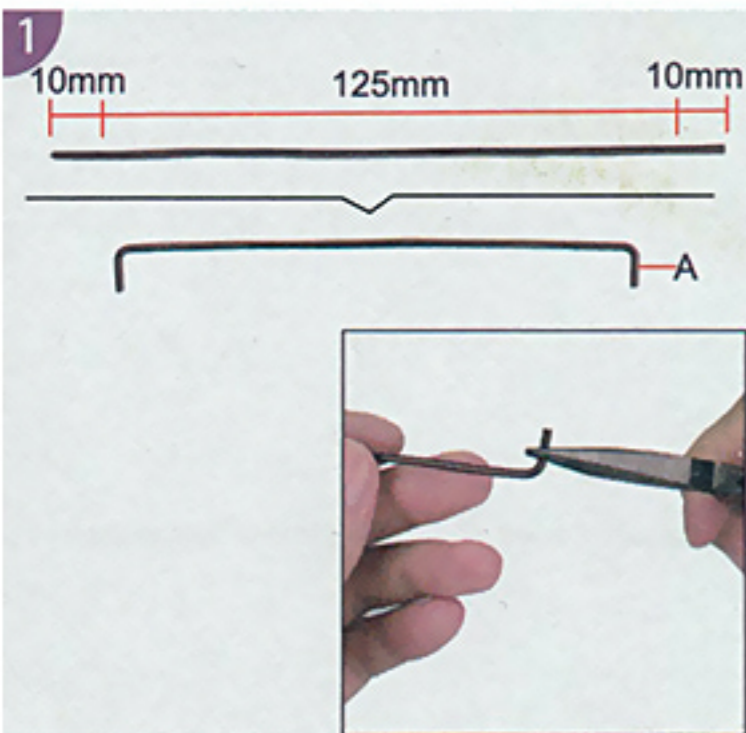

Mark at thick brown wire, bend as shown.

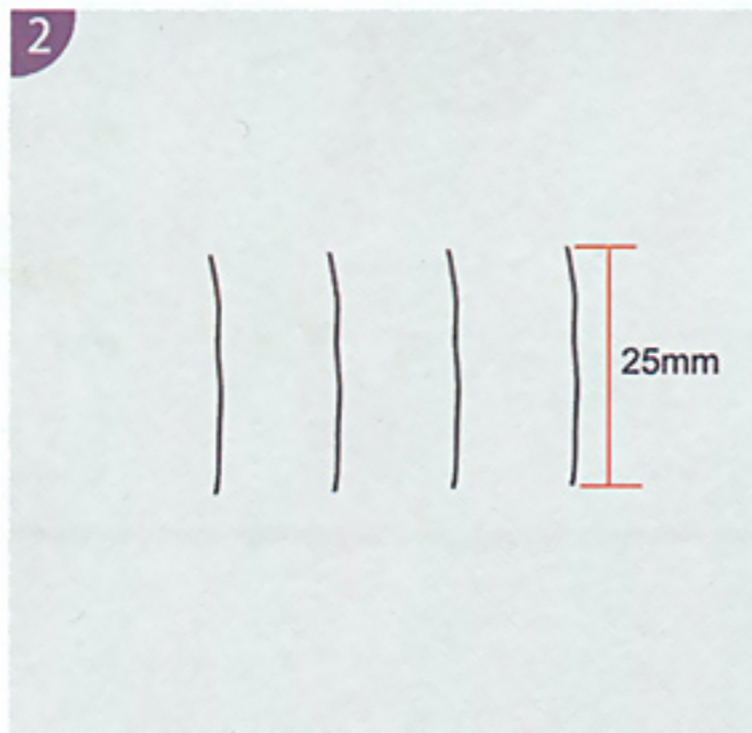

Cut into four thin brown wires as shown.

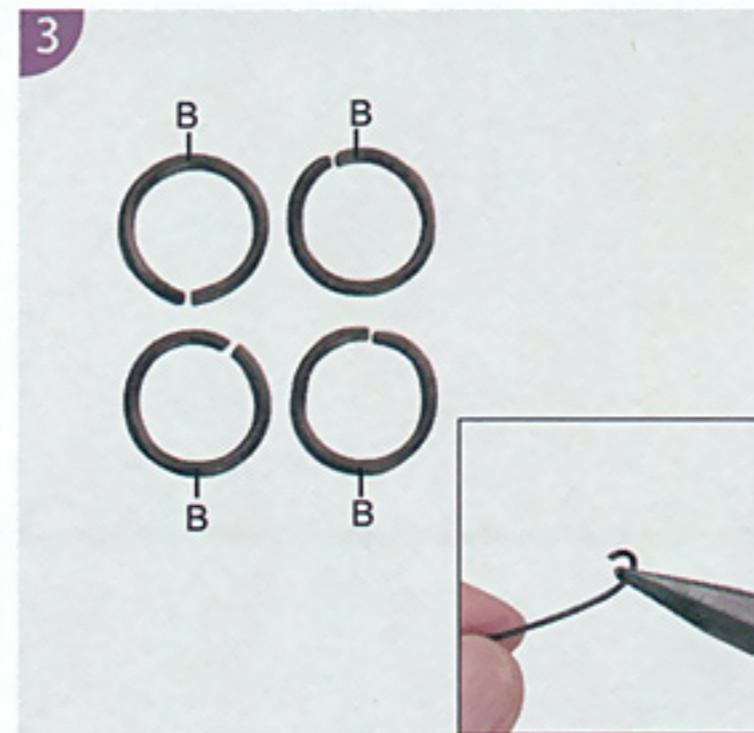

Bend as shown.

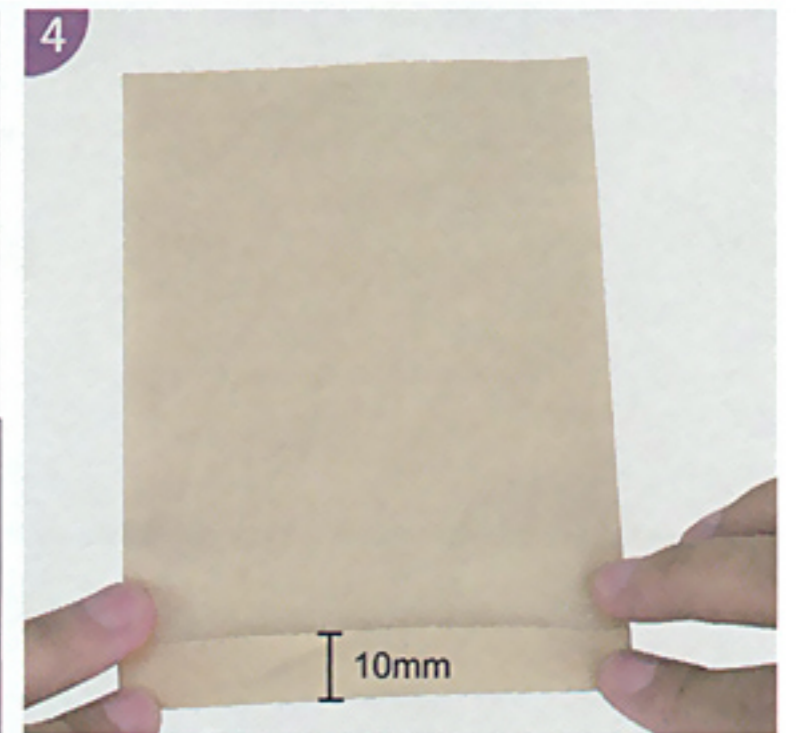

Fold fabric as shown.



Infold and paste two sides of fabric as shown.



Fold the cloth into 8 equal parts as shown.

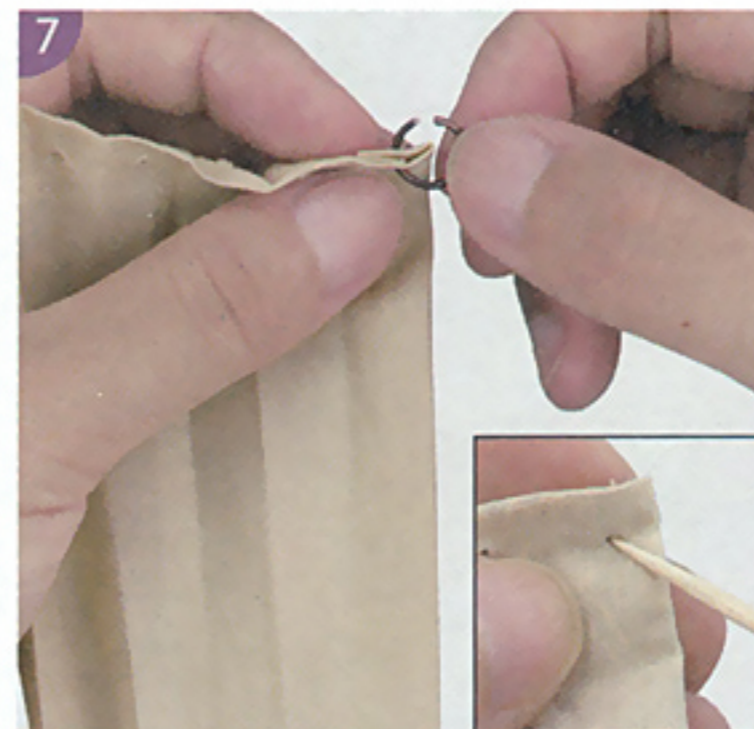

Pass B through fabric and close the opening(Use toothpick to make holes in advance)



Complete.



9 Paste air hole at the two circles of L5.



10 Pass A through fabric and glue at two ends of A as shown.



11 Pass the glued area through air hole and paper, and fix it on the hole of the wall.



Roof

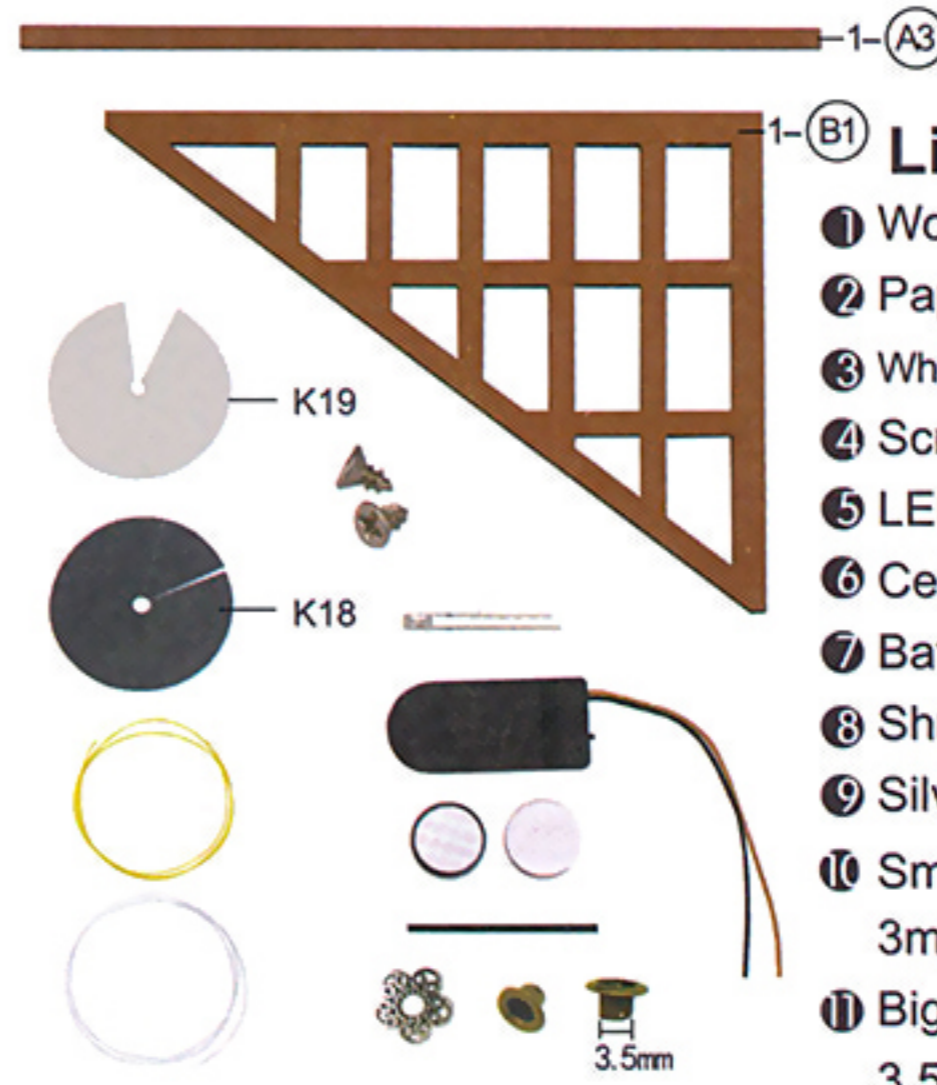

List

- | | |
|---------------------------------|-----------------|
| ① Wooden pieces | 2pcs |
| ② Paper K18, K19 | |
| ③ White wire and yellow wire | 1pc (Bag No.5) |
| ④ Screw | 2pcs (Bag No.5) |
| ⑤ LED lamp | 1pcs (Bag No.5) |
| ⑥ Cell box | 1pcs (Bag No.5) |
| ⑦ Battery | 1set (Bag No.5) |
| ⑧ Shrink tube | 1pc (Bag No.5) |
| ⑨ Silver receptacle | 1pc (Bag No.5) |
| ⑩ Small air hole (diameter 3mm) | 1pc (Bag No.5) |
| ⑪ Big air hole (diameter 3.5mm) | 1pc (Bag No.5) |

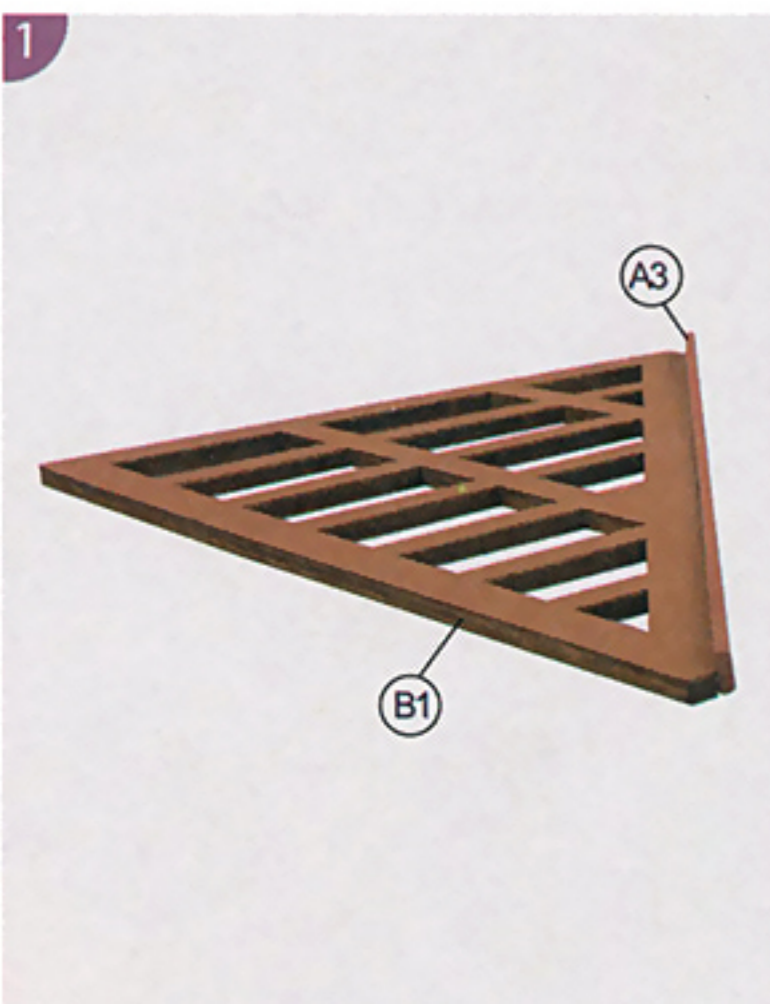

1 Paste as shown.

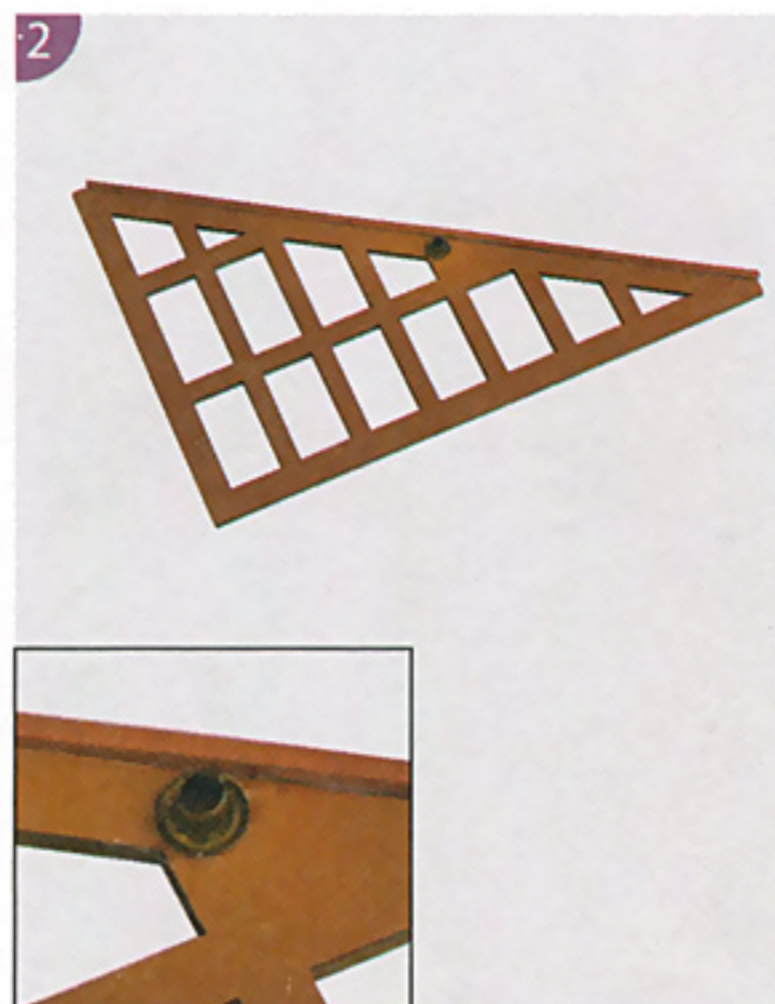

2 Paste air hole as shown.

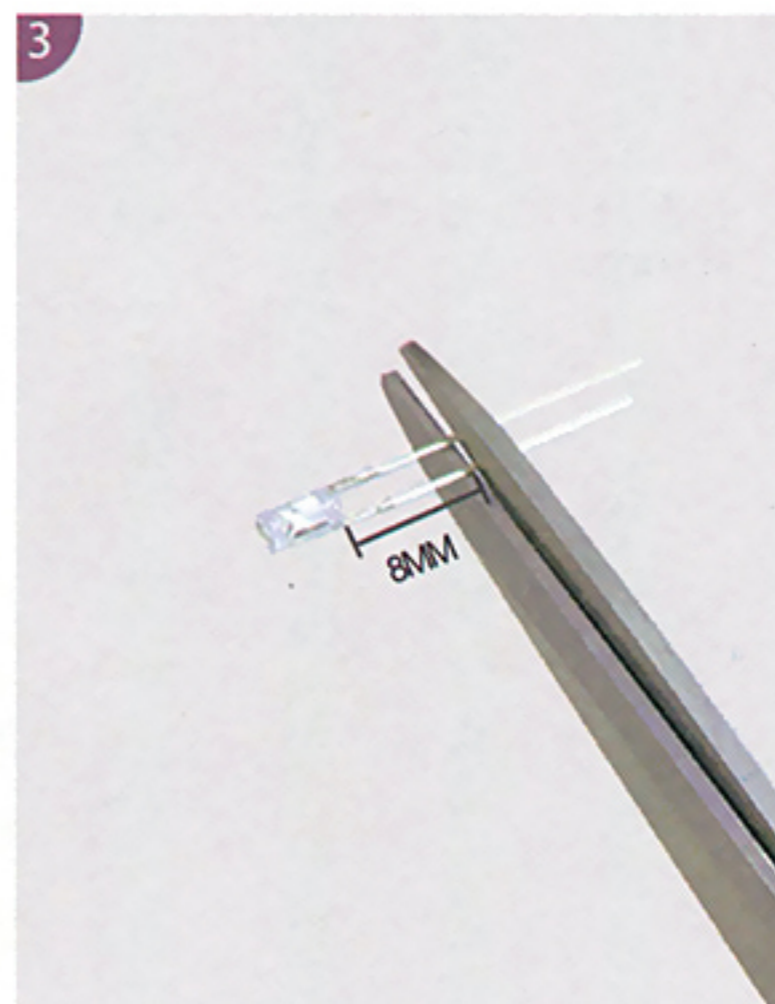

3 Cut as shown.

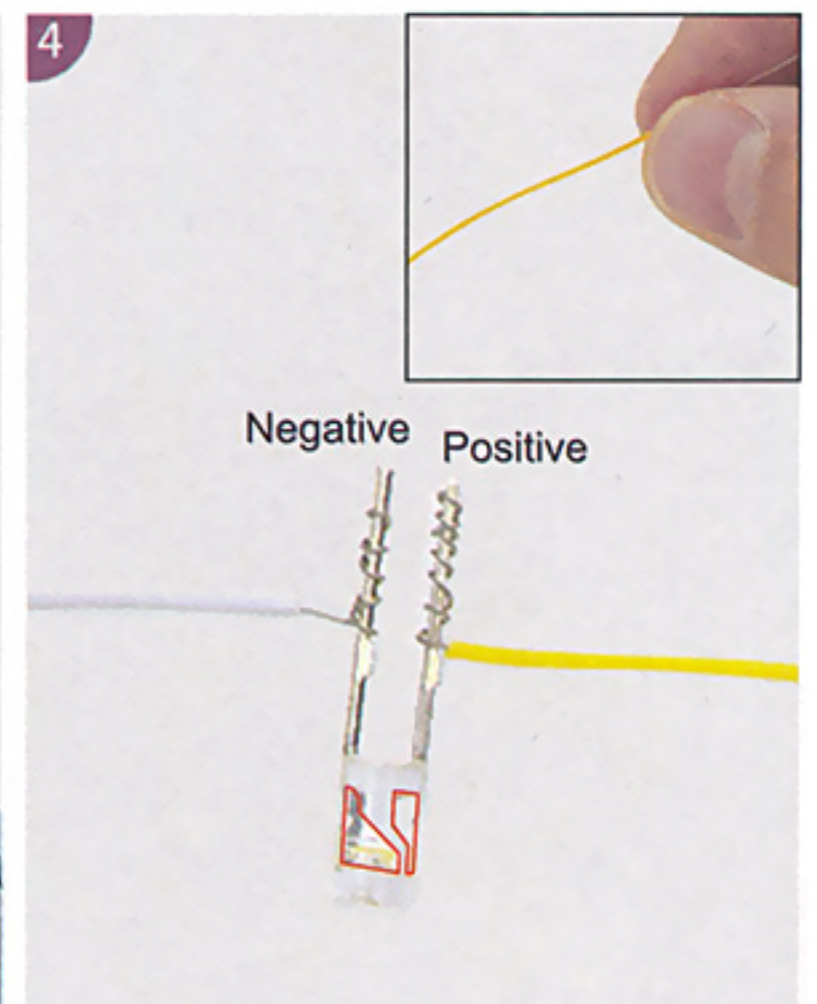

4 Peel off 12mm length rubber from white and yellow wire. Connect to the lamp as shown.



Test.

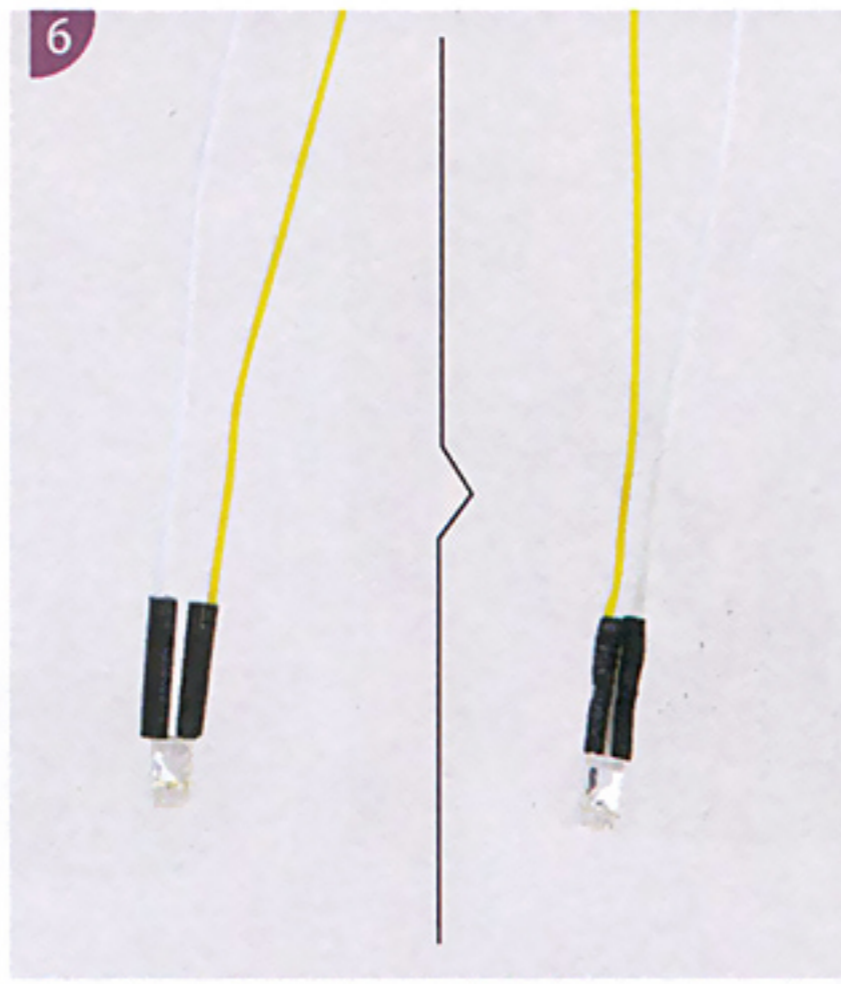

Cut the shrinkable tube into 10mm. 2pcs in total. Go through the tube with wires. Heat shrink the tube with flame of lighter.

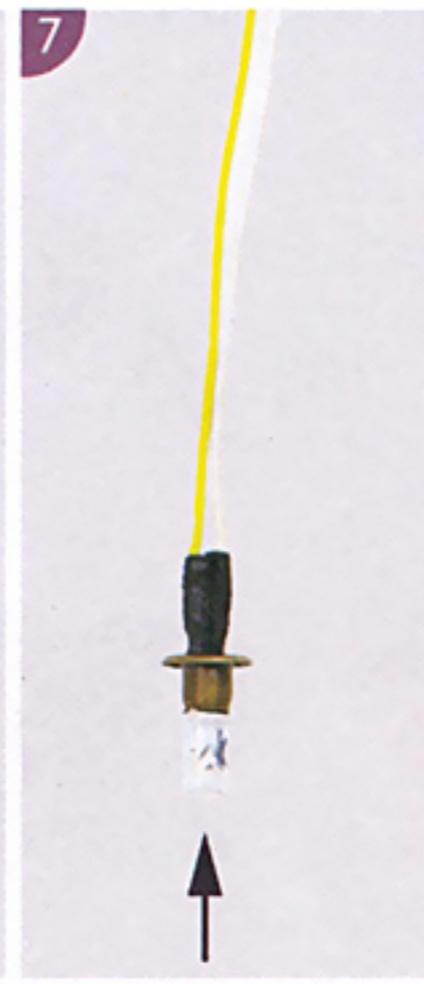

Install big air hole as shown.(Test)

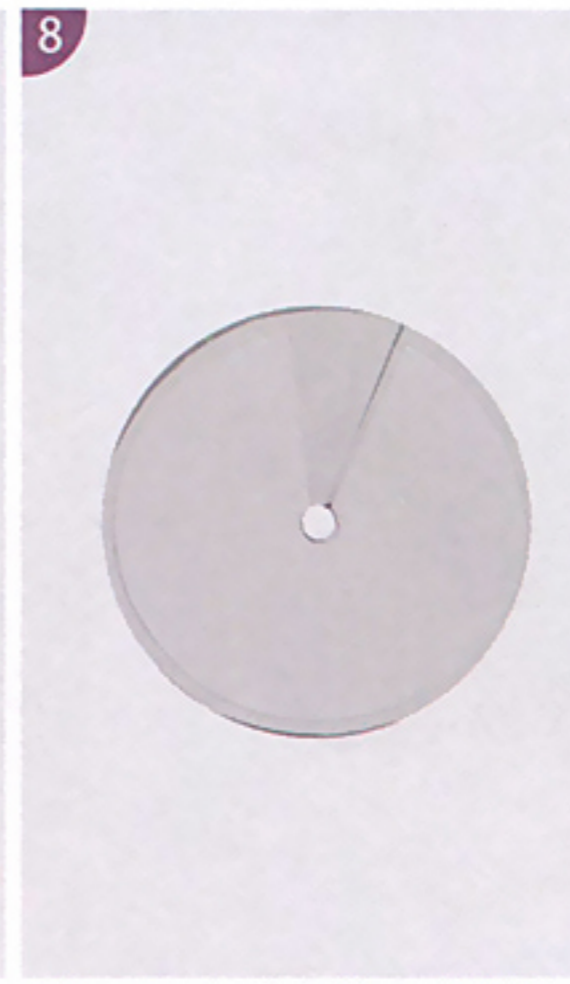

Paste back side of K19 and K18.

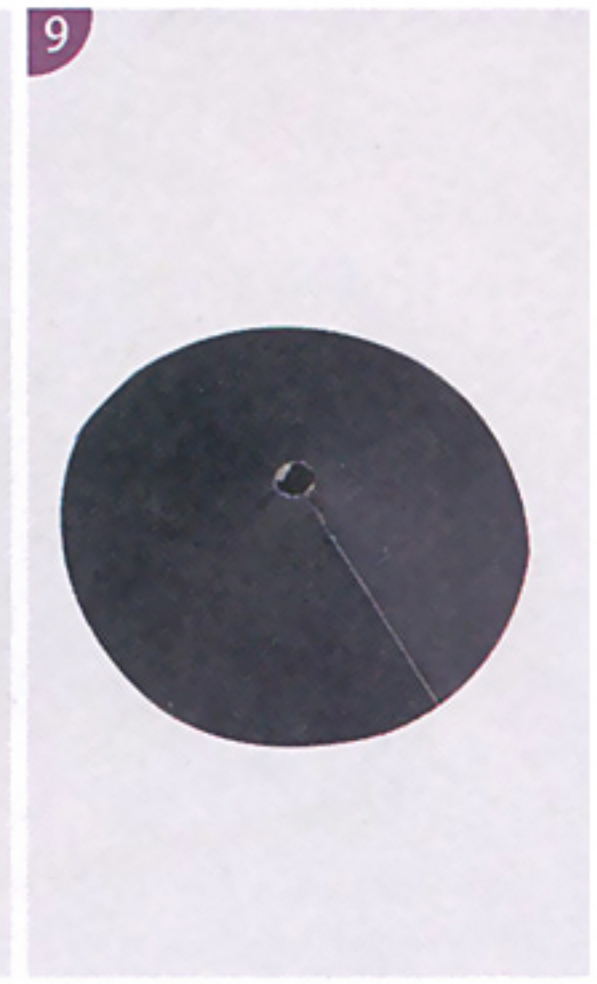

Paste as shown.

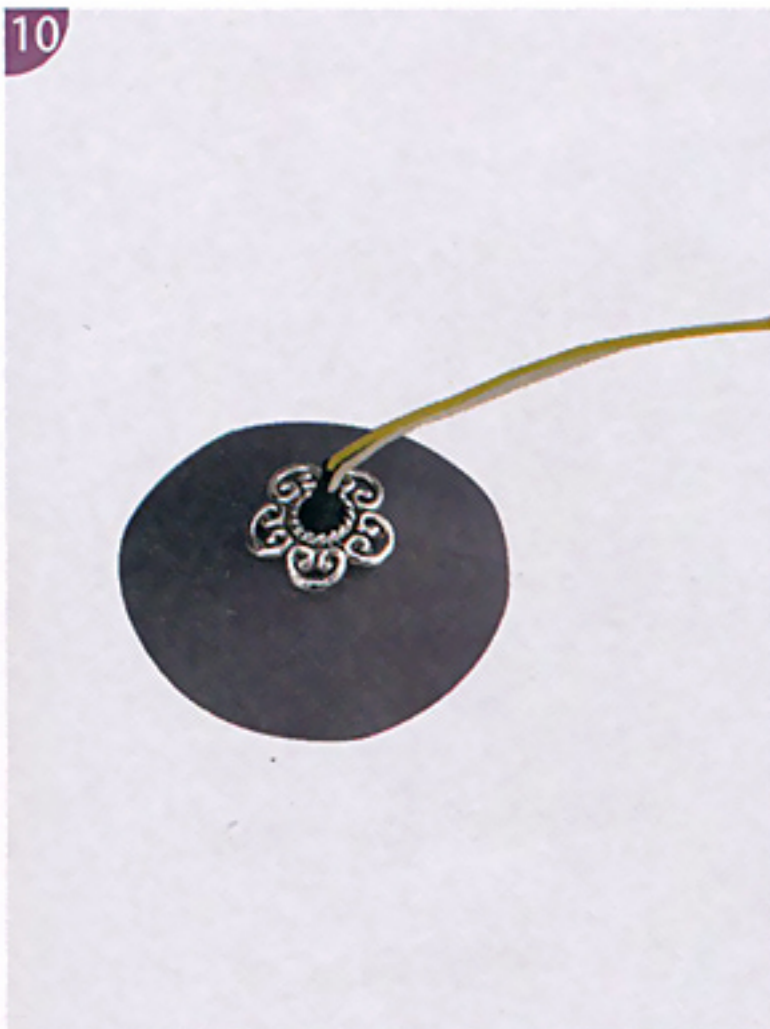

Pass string through lampshade and receptacle, paste as shown.

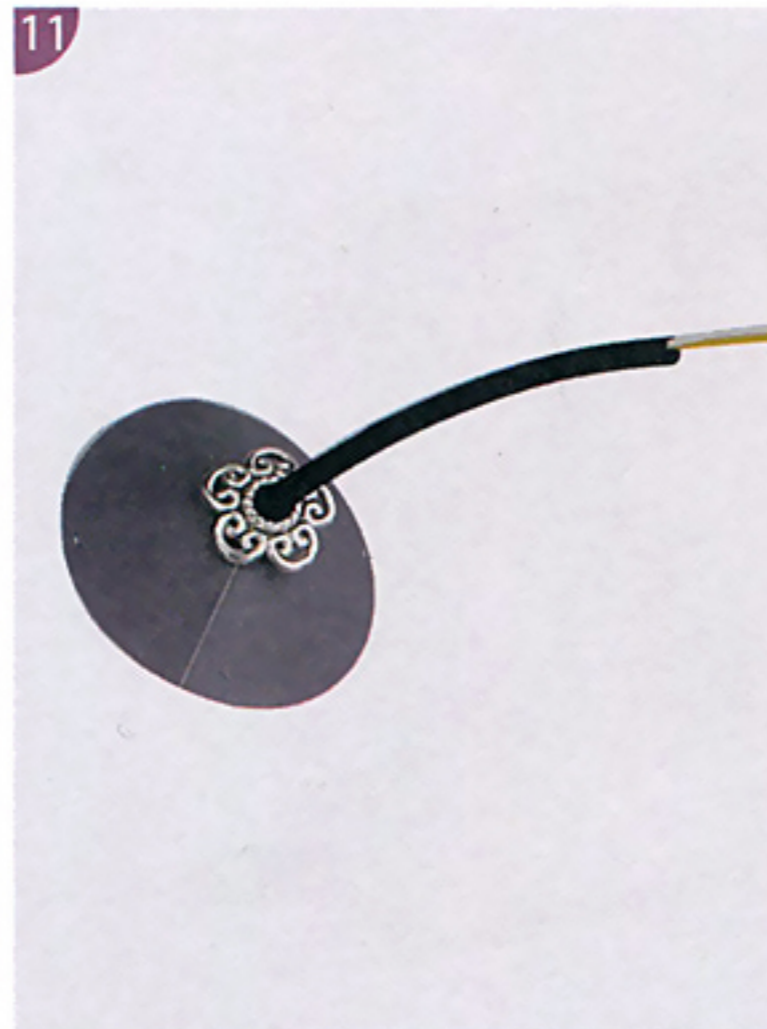

Cut off shrink tube(40mm), pass wire through the tube .

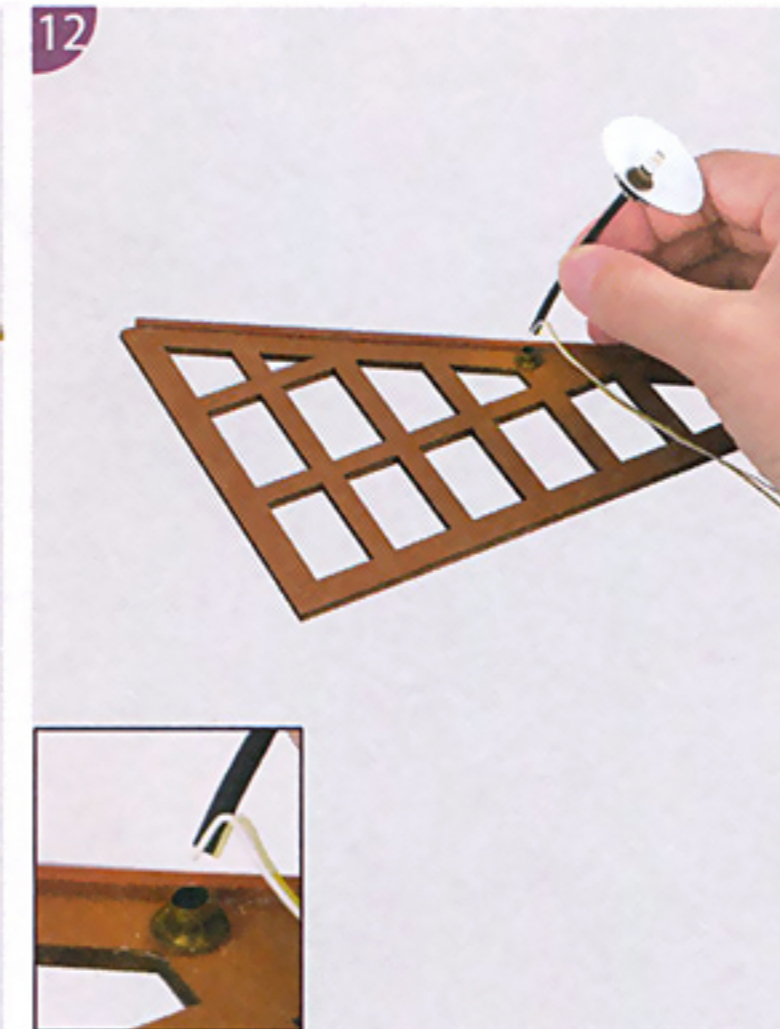

Install the lamp.(Notice the bending of string, and stay half hour to make it fix)

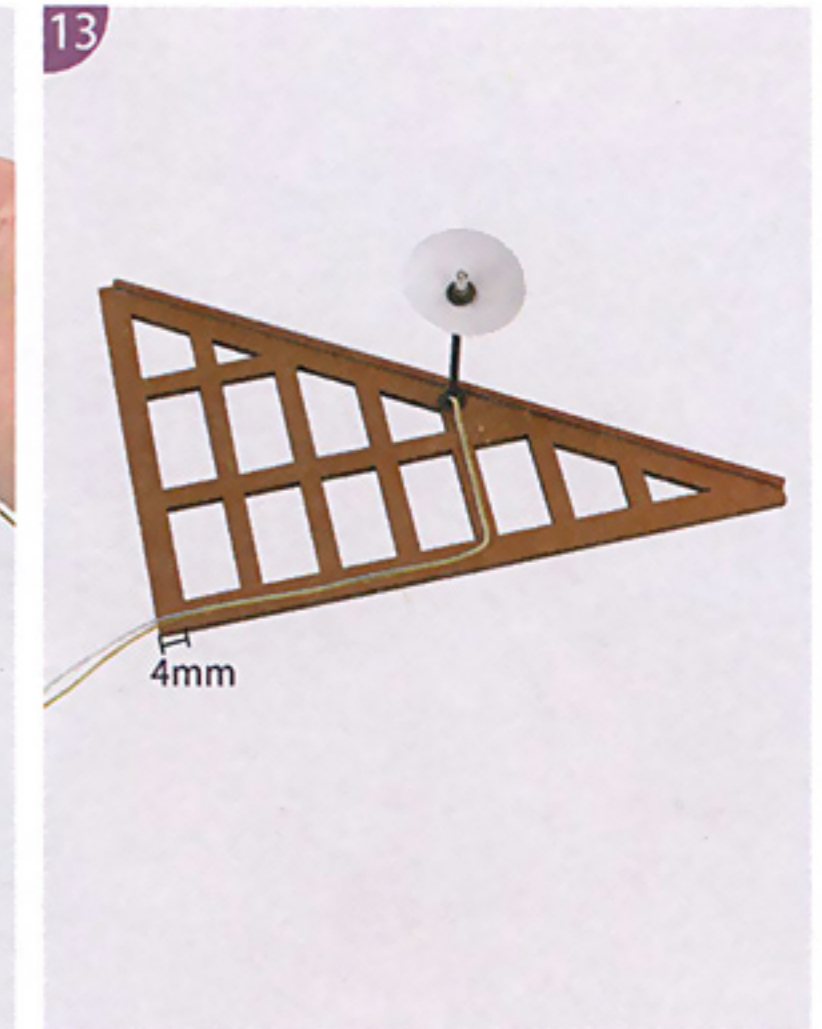

Keep 4mm of wires, and fix it as shown.(Test the lamp)

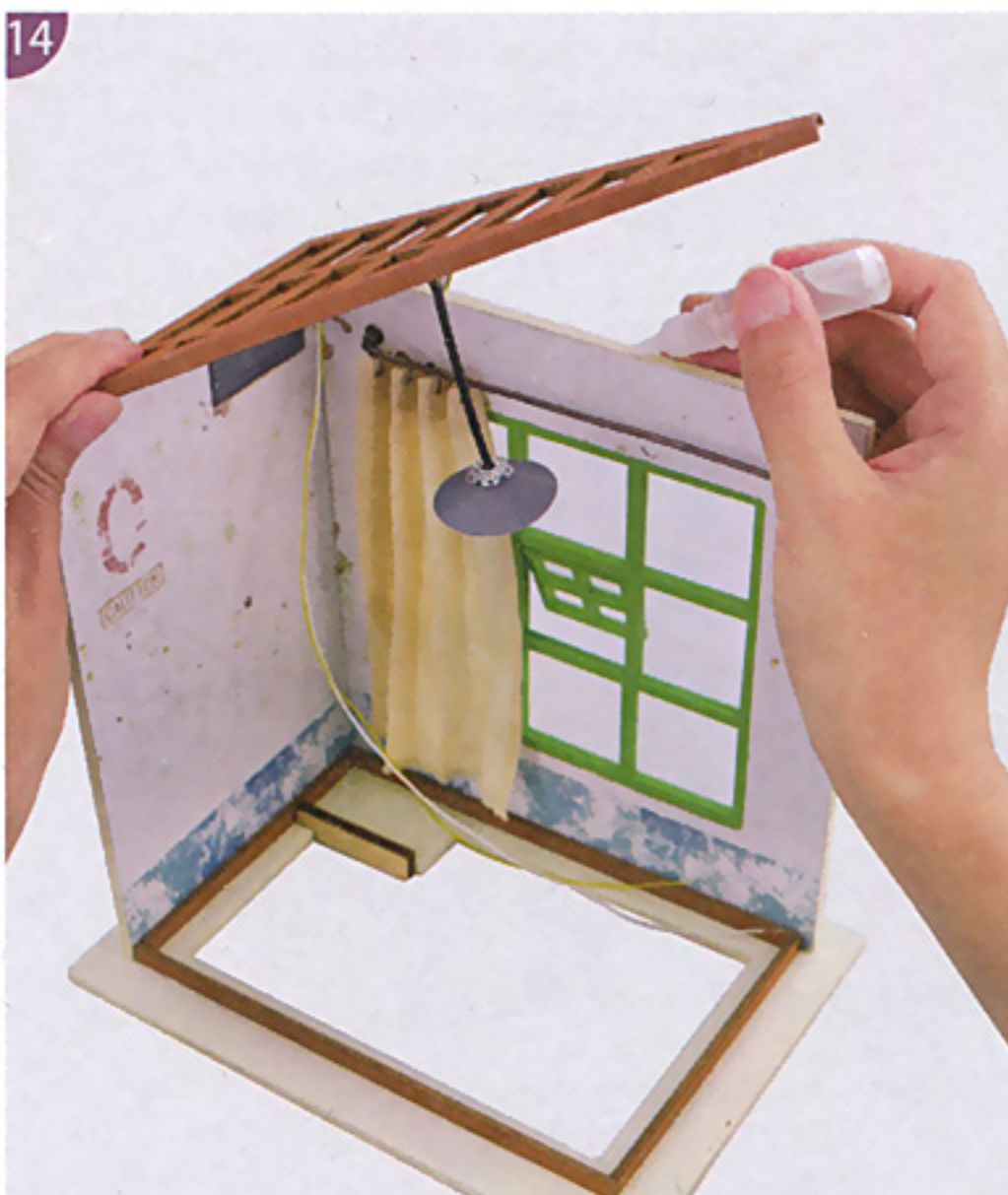

Fix the roof on the wall.

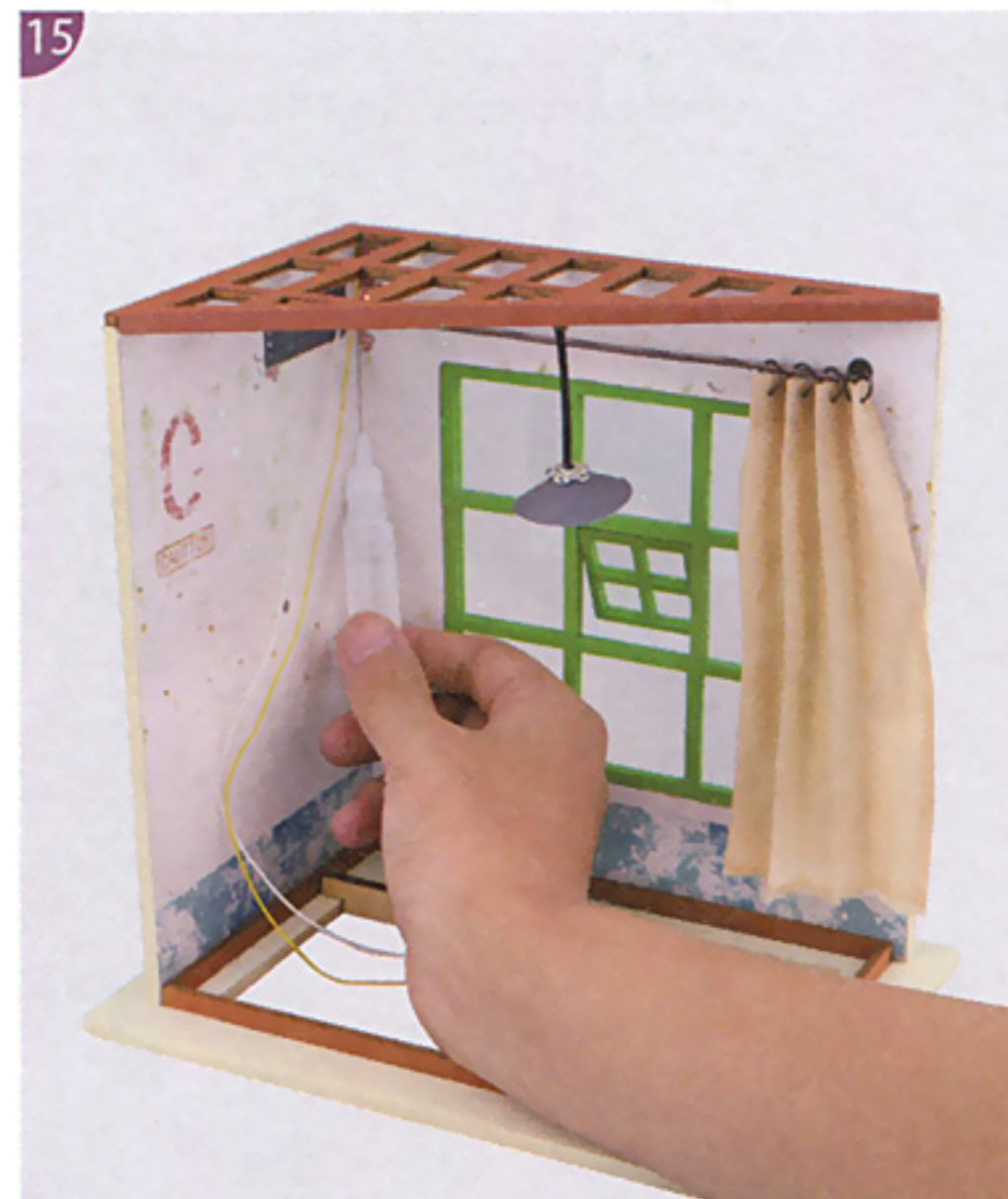

Tidy the wires and paste them along the corner.



Use tweezers to fix the wires.



Complete.

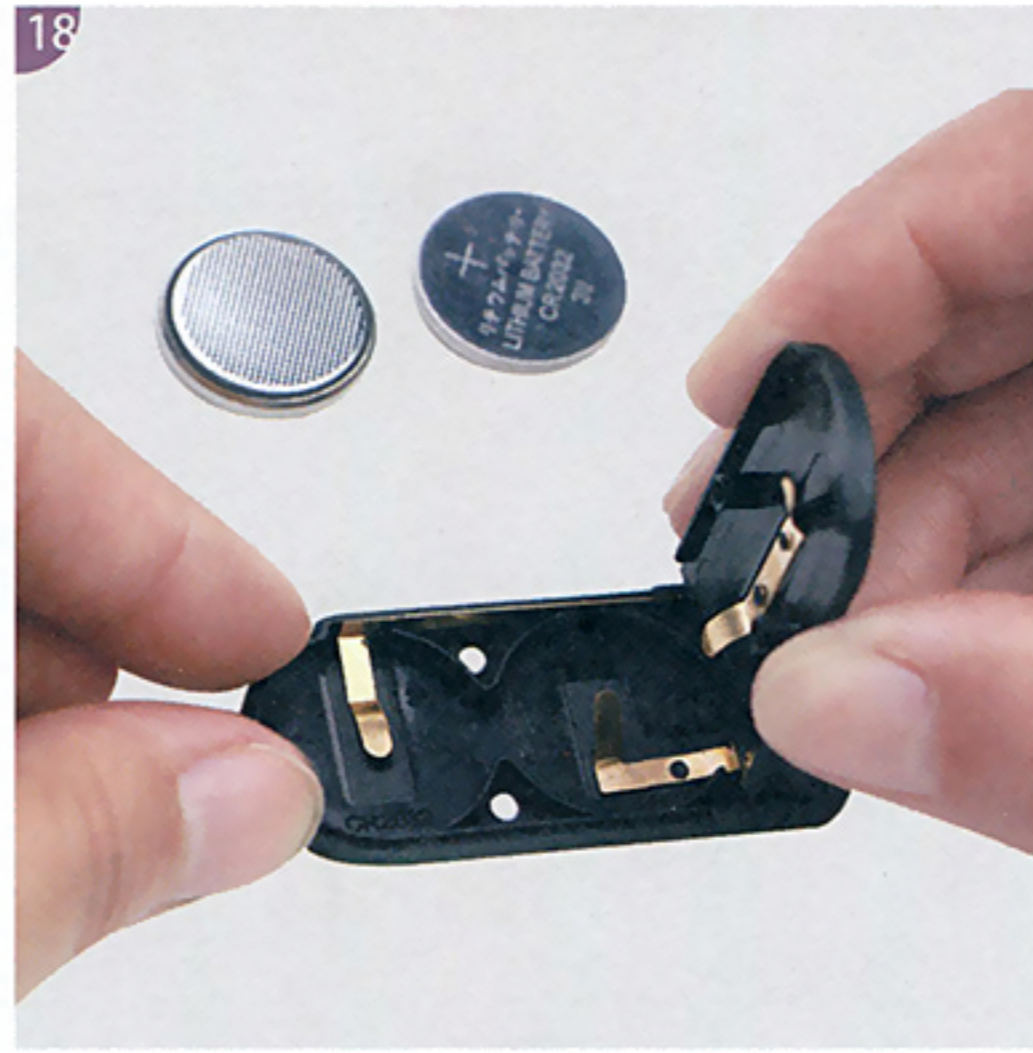

Install the battery into the cell box. (notice the positive and negative)

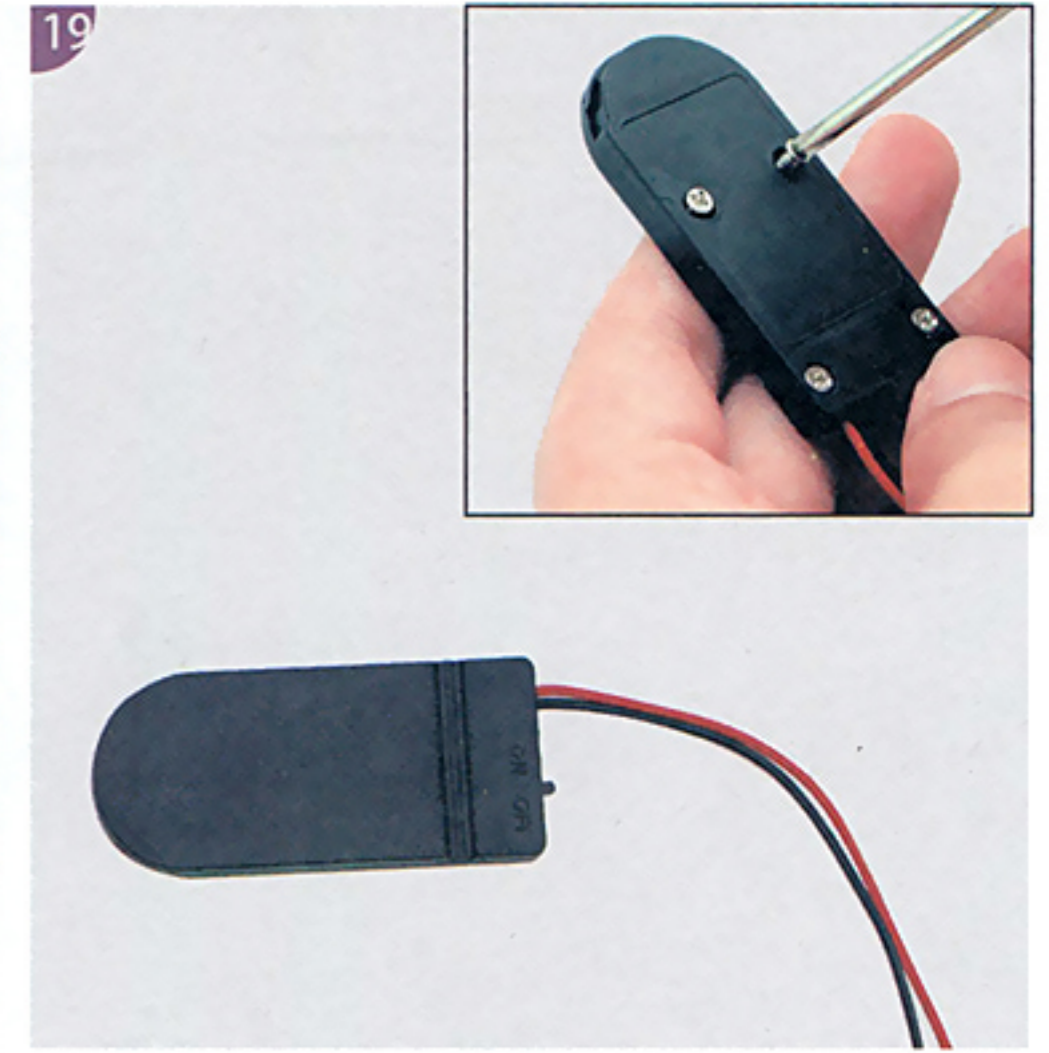

Use screwdriver to twist the screw.

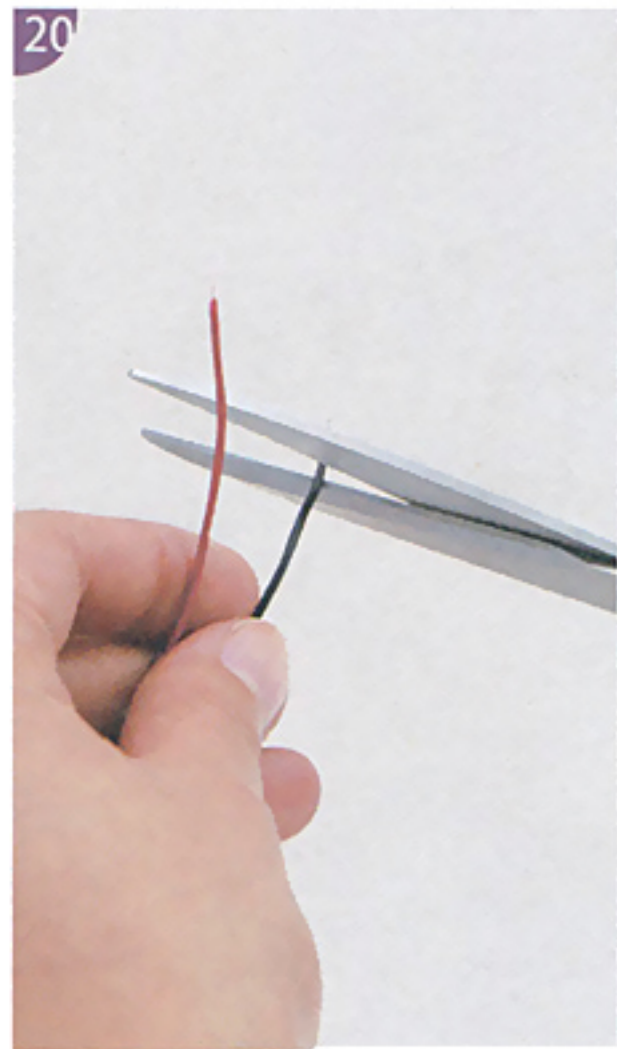

Peel off 12mm length rubber in the cell box as shown.

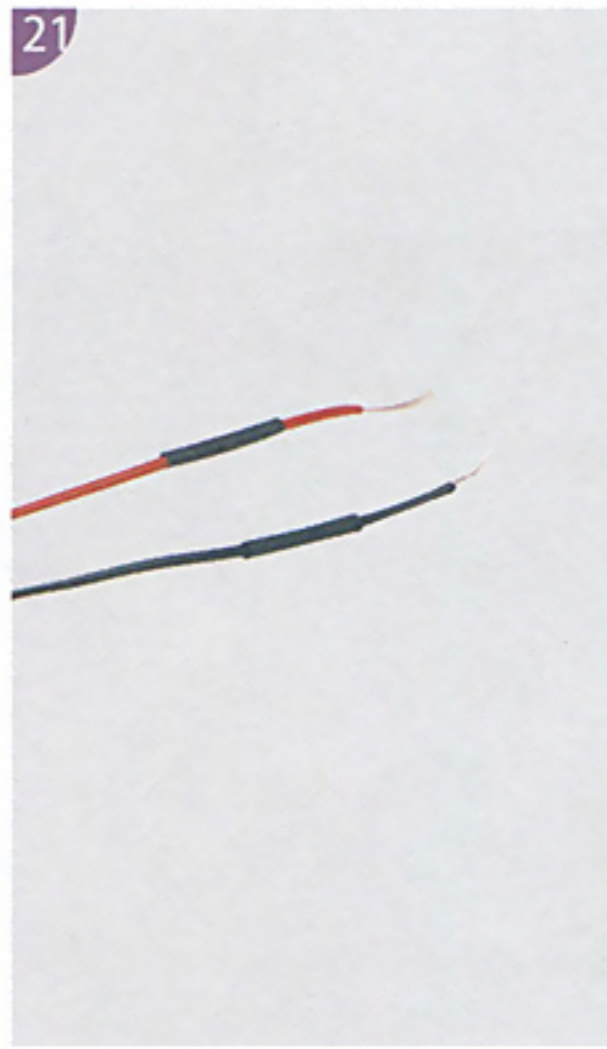

Cut two 20mm shrink tube and cover them on the wire as shown.

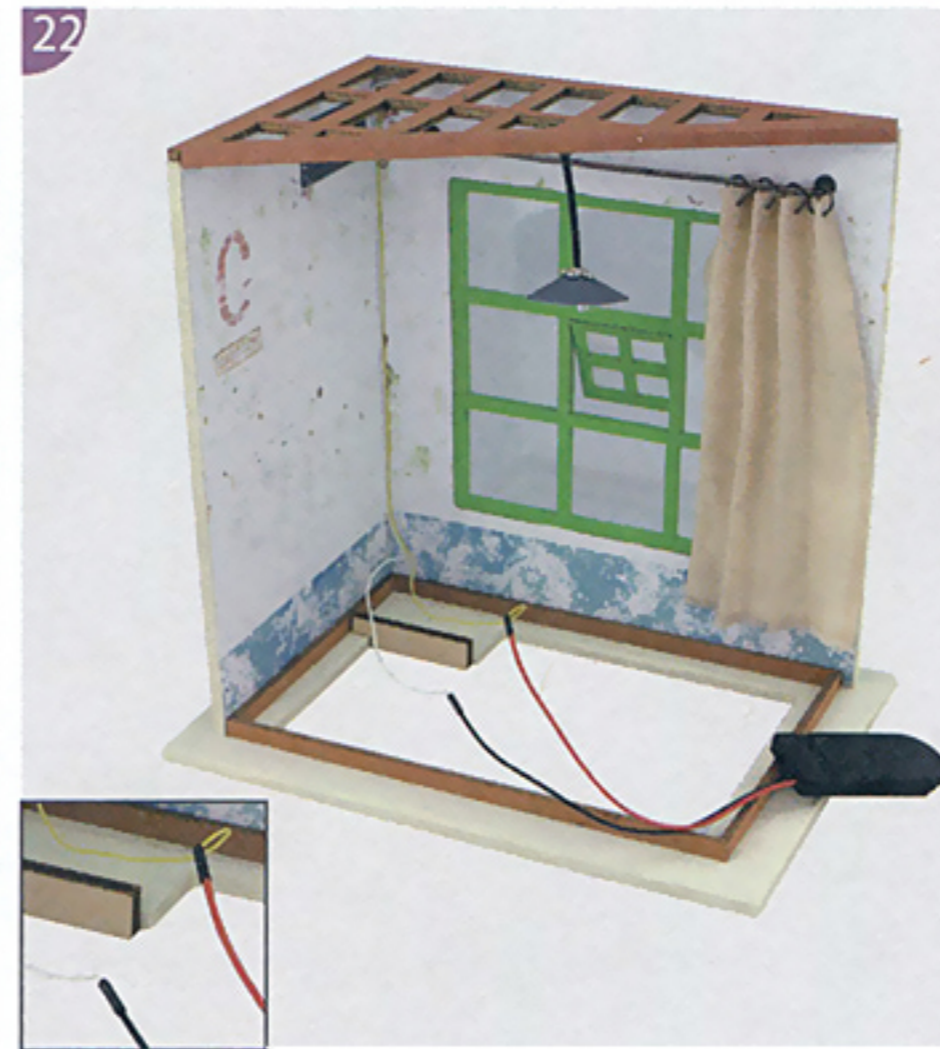

Connect the wire of lamp and battery box. Attention: Yellow connect with Red. White connect with black. Test the lamp.



Place the cell box as shown, switch downward. (Attention: Do not glue in case of change battery.)

Floor

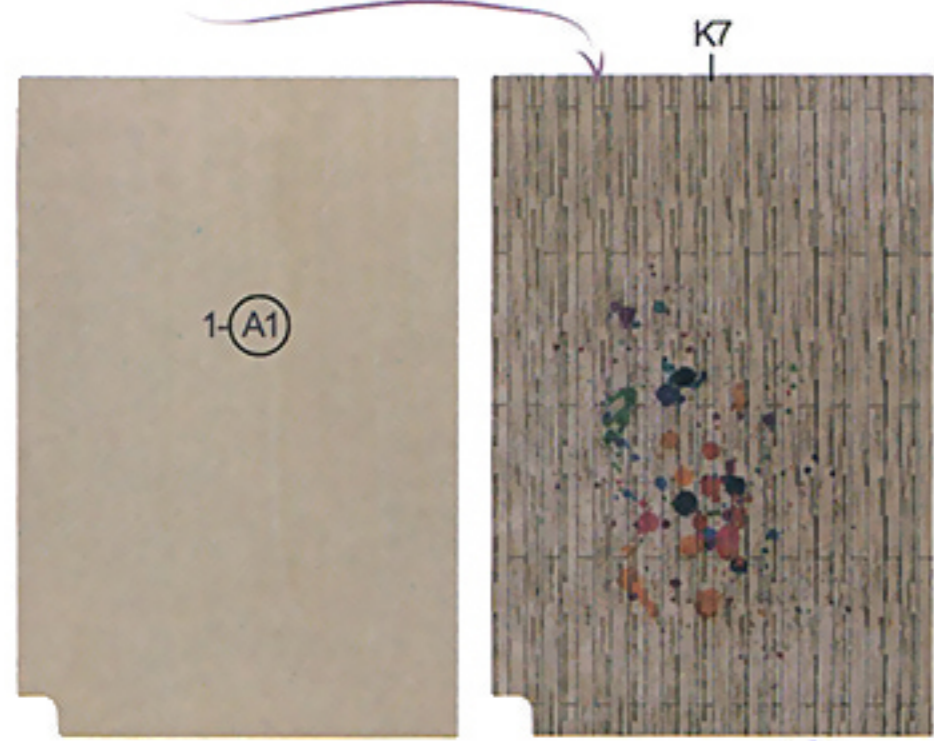

List

- Wooden pieces 3pcs
- Paper K7



Paste (A1) with K7 as shown.



Paste step1 as shown.



Complete.

Assemble Process



Assemble process

