

# SAM'S STUDY

DG102



# Brief Introduction

## Tips of glue (The picture is for reference only.)

1. White glue is used for small wooden pieces. (Around 3 minutes to dry.)
2. Silicone liquid glue is used for big wooden parts and other materials.
3. Use appropriate glue to keep the material clean.



## Tips of fabric

1. Cut the fabric according to the instruction.

E.g.

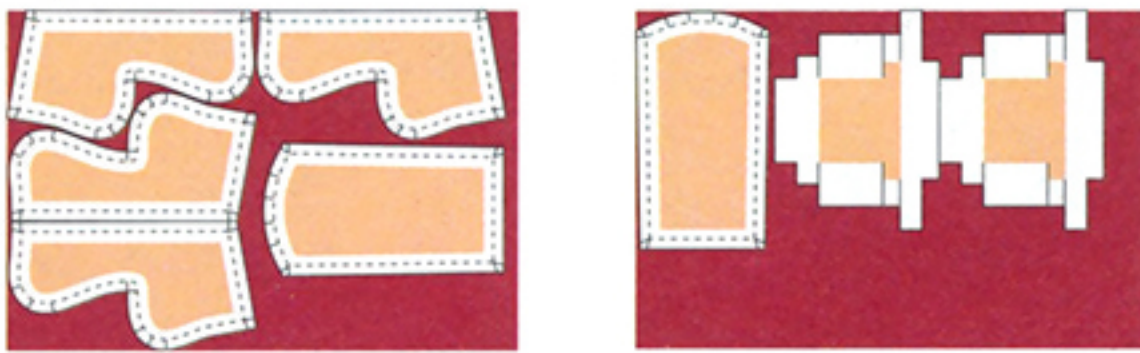

## Tips of LED

1. Pay attention to the positive & negative electrode of cell.  
Yellow wire: positive.  
White wire: negative.
2. In cell box:  
Red wire: positive.  
Black wire: negative.
3. Test the LED after combination.



## Warning

1. Children must use under the guidance of adults.
2. Put the remains back in the original bags after each step completed. (In case of missing).

## Tools included



## Tools excluded

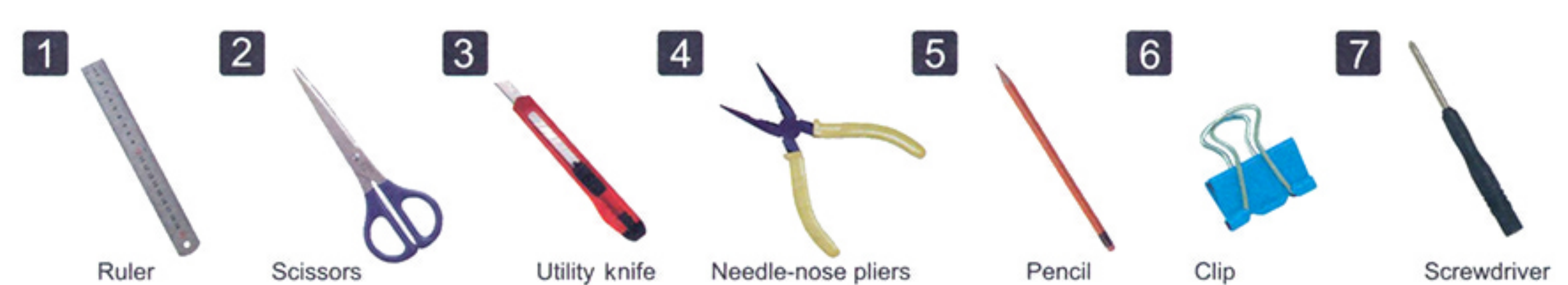

## Tips of painting

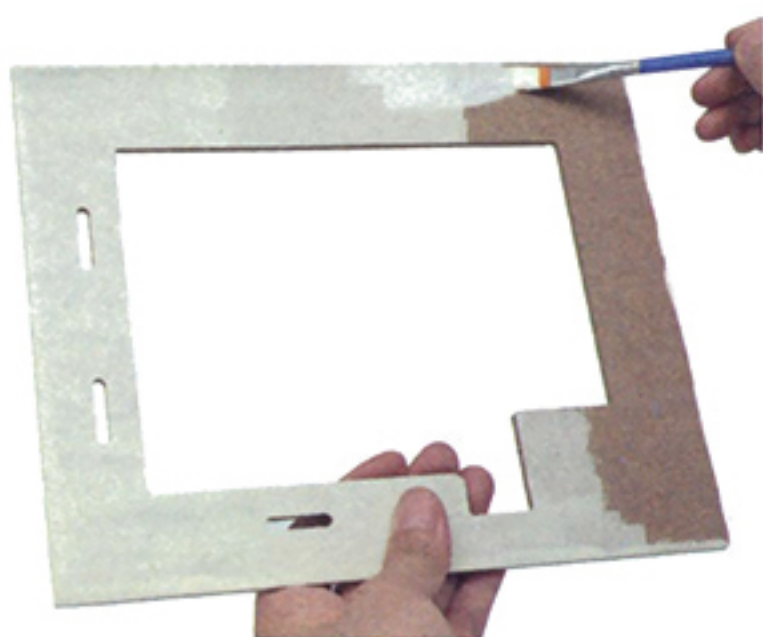

Paint before assembling. (Paint again after dried.)

## Tips of mark

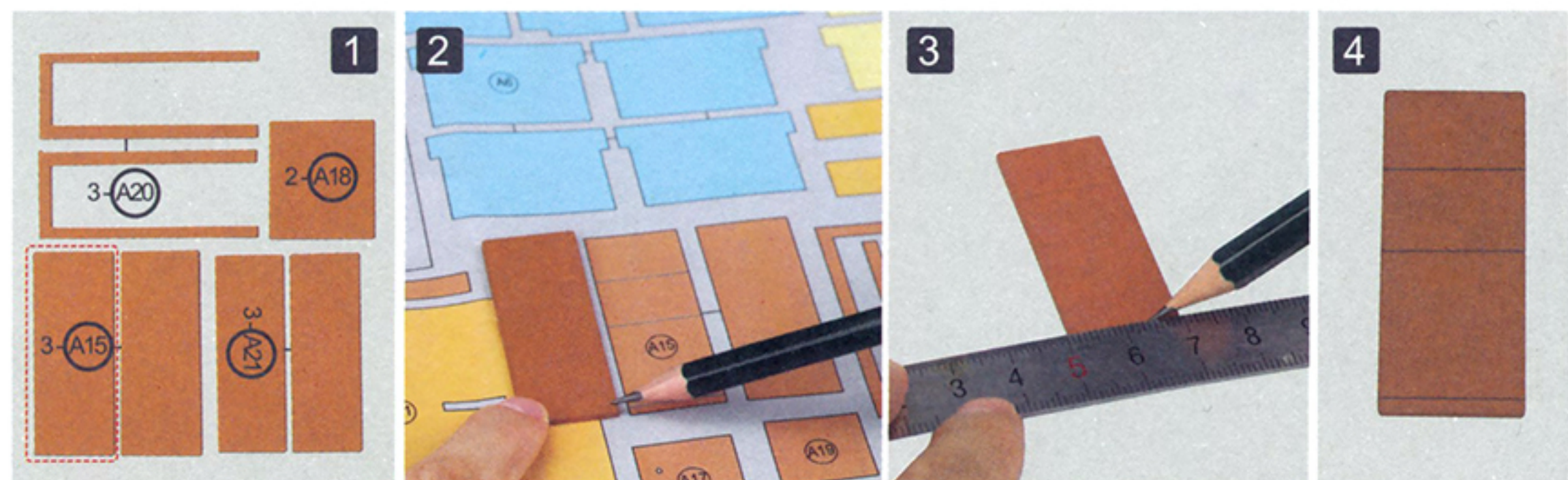

Find out the wooden pieces and correct paper (Matched numbers). Mark on the wooden pieces according paper.

**!** Part number explanation  
(e.g.) 2-(A23): (Bag No.)2- (Part No.) (A23). (Only Part No. is indicated in detailed steps)



## No.1 Cabinet

### List

- ① Wooden pieces 19 pcs
- ②  $\Phi 4$ mm golden receptacle 2 pcs (Bag No. 6)
- ③ Golden metal wire L 30mm (Bag No. 6)

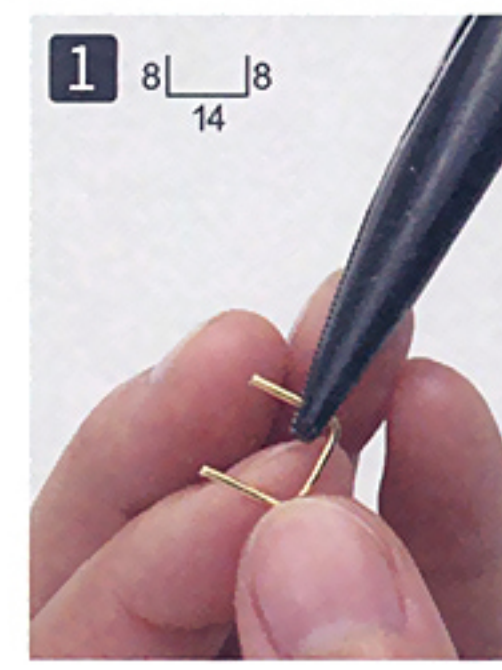
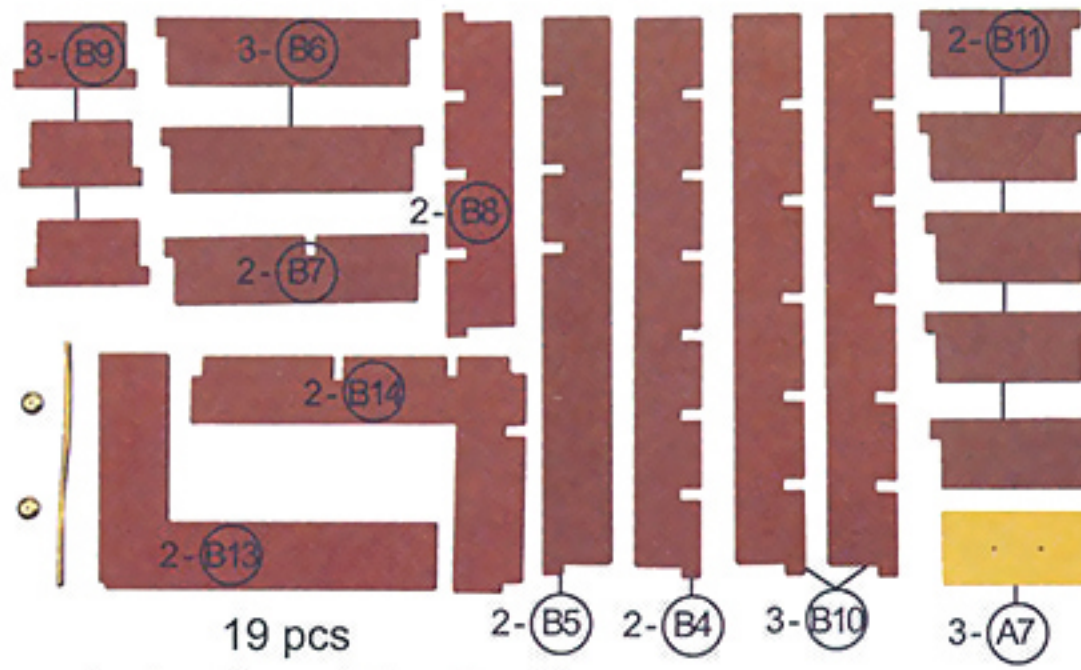

1 Bend the metal wire into U shape.

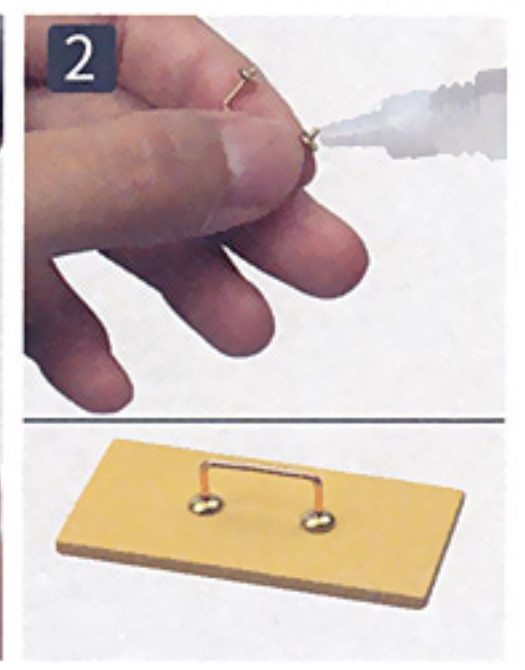

2 Put metal wire into receptacles. Glue the two ends and insert into the hole.

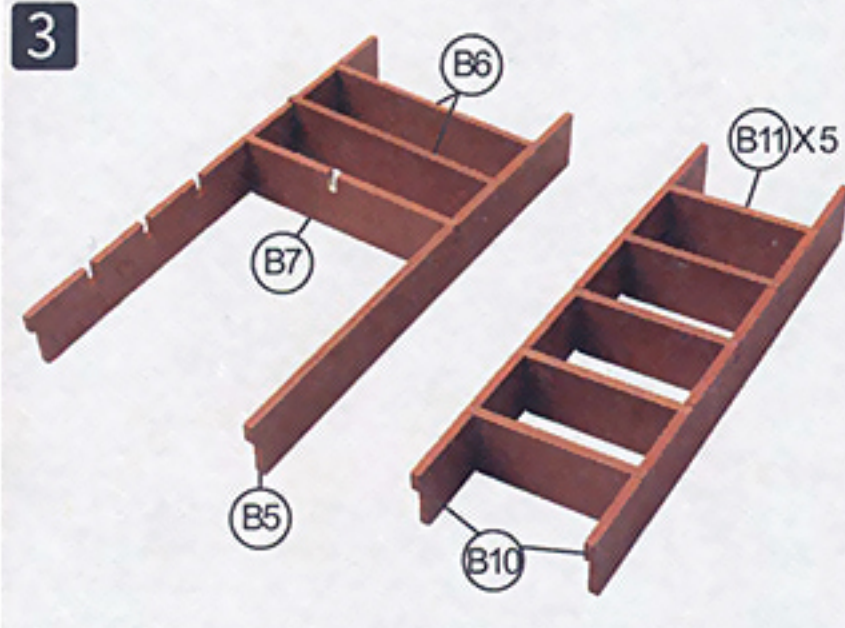

3 Assemble as shown. (Pay attention to the direction of B7)

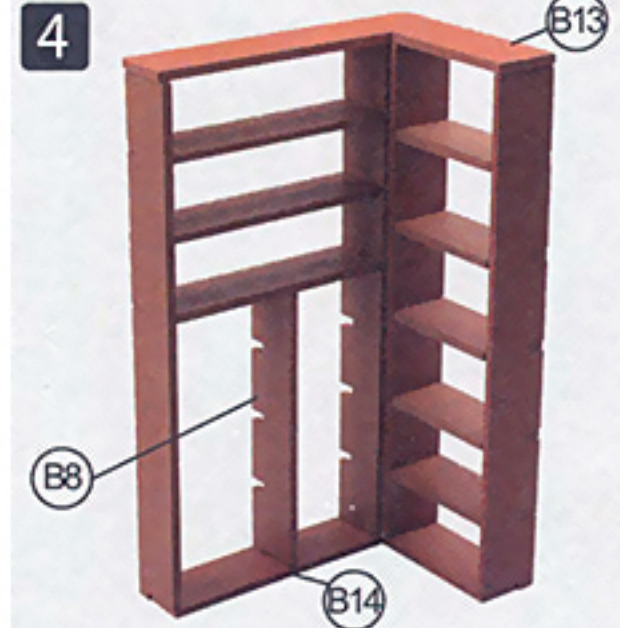

4 Paste as shown.

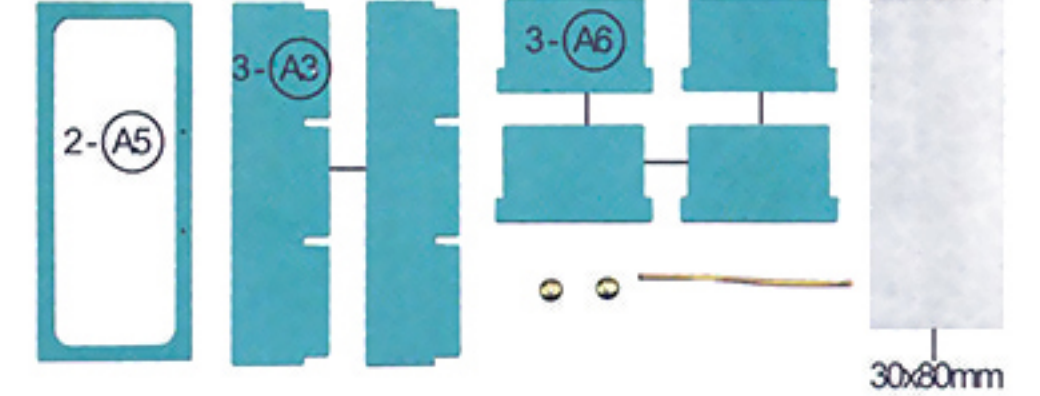

### List

- ① Wooden pieces 7 pcs
- ②  $\Phi 4$ mm golden receptacle 2 pcs (Bag No.6)
- ③ Golden metal wire L 40mm (Bag No.6)
- ④ Transparent paper 30\*80mm 1 pcs (Bag No.4)

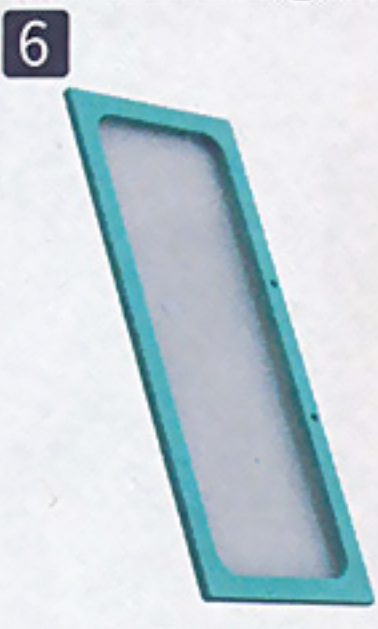

6 Paste as shown.

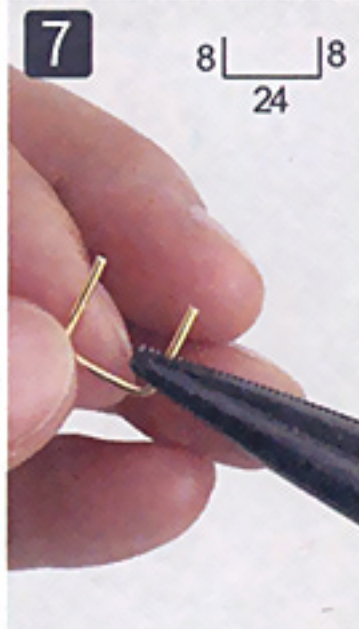

7 Bend the metal wire into U shape.



8 Put metal wire into receptacles. Glue the two ends and insert into the hole.

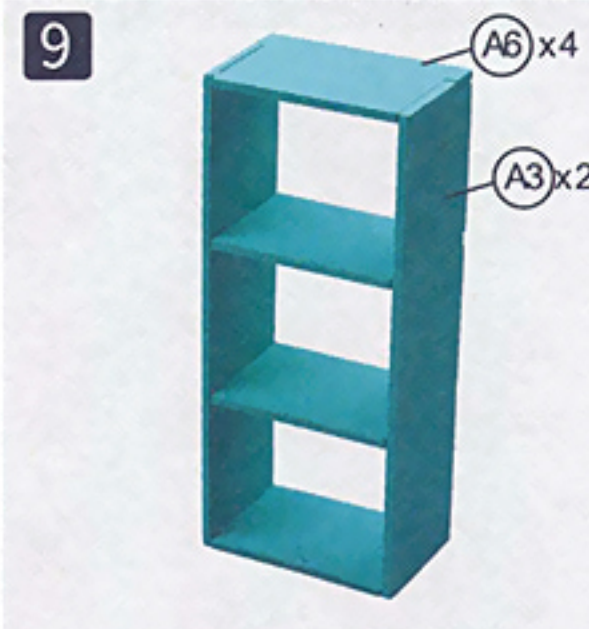

9 Paste as shown.



10 Paste the door in center alignment.



11 Fix step 10 into step 5 as shown.



## No.2 Cabinet

### List

- ① Wooden pieces 11 pcs
- ②  $\Phi 8$ mm golden receptacle 2 pcs (Bag No.6)
- ③ Golden metal wire L 26mm (Bag No.6)
- ④  $\Phi 4$ mm golden bead 2 pcs (Bag No.6)

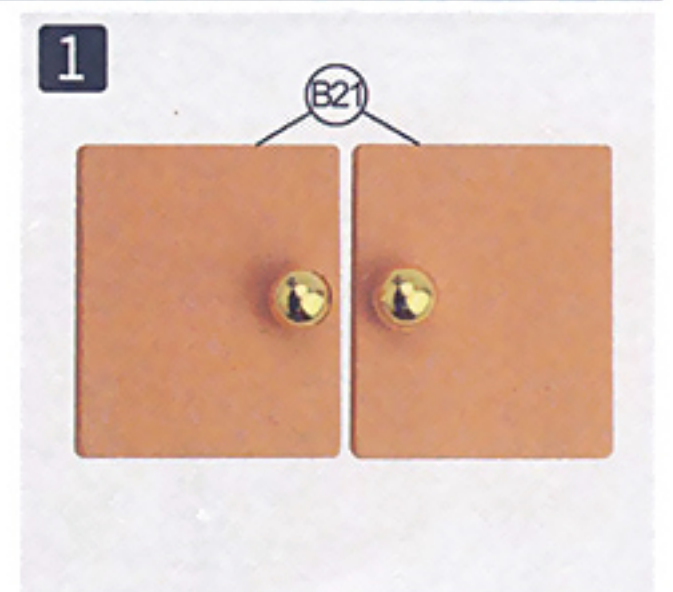
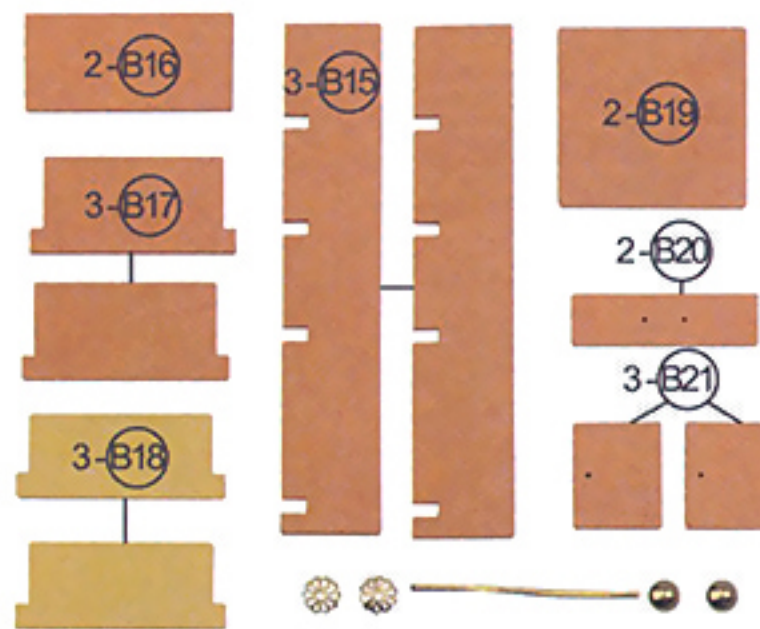

1 Paste the golden bead at the hole.

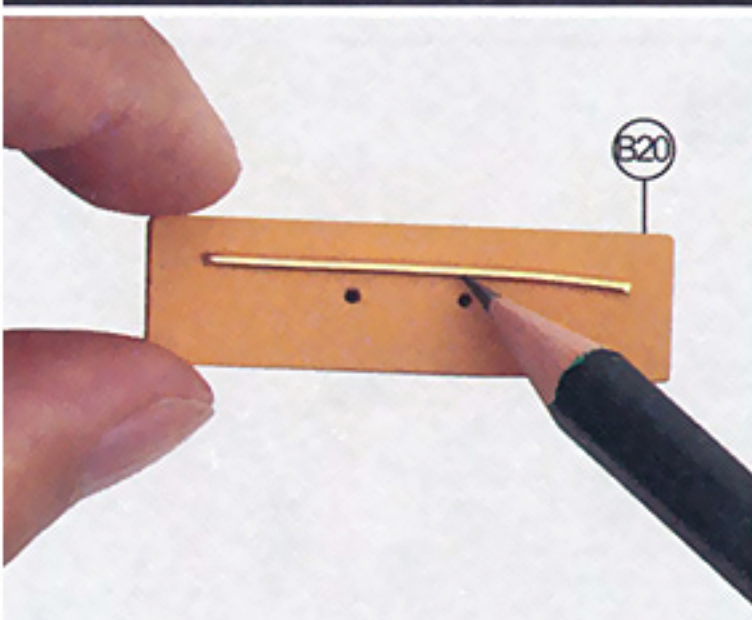

3 Mark the position of the holes on the wire.

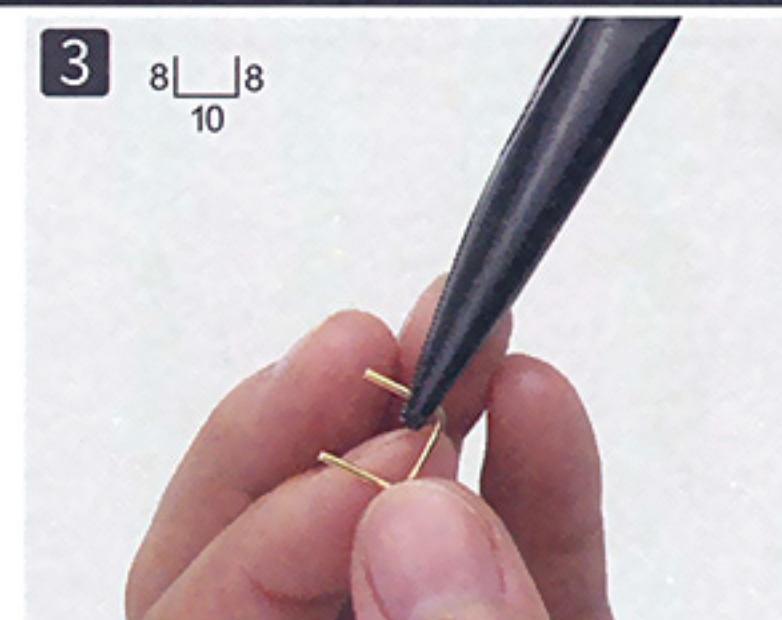

4 Bend the metal wire into U shape.

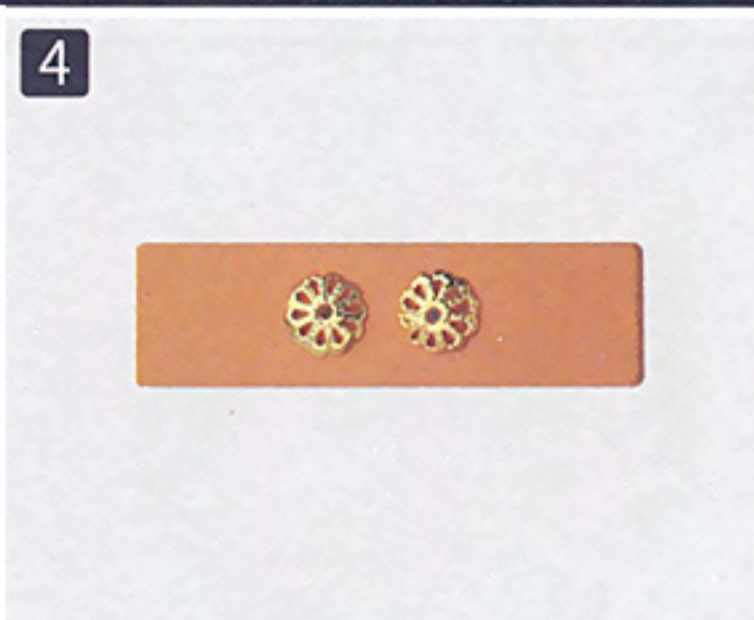

5 Paste the receptacle onto the holes of Part B20.



6 Assemble the step 3 as shown.



Paste as shown.



Completed.

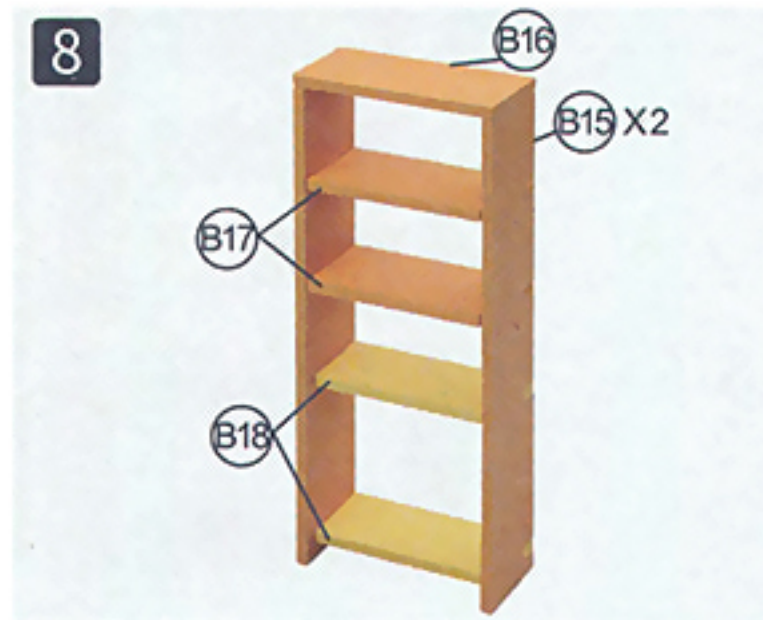

Paste as shown.



Paste as shown.



### No.3 Cabinet

#### List

- ① Wooden pieces 16 pcs
- ② Golden metal wire L 30mm (Bag No.6)
- ③ φ4mm golden bead 2 pcs (Bag No.6)

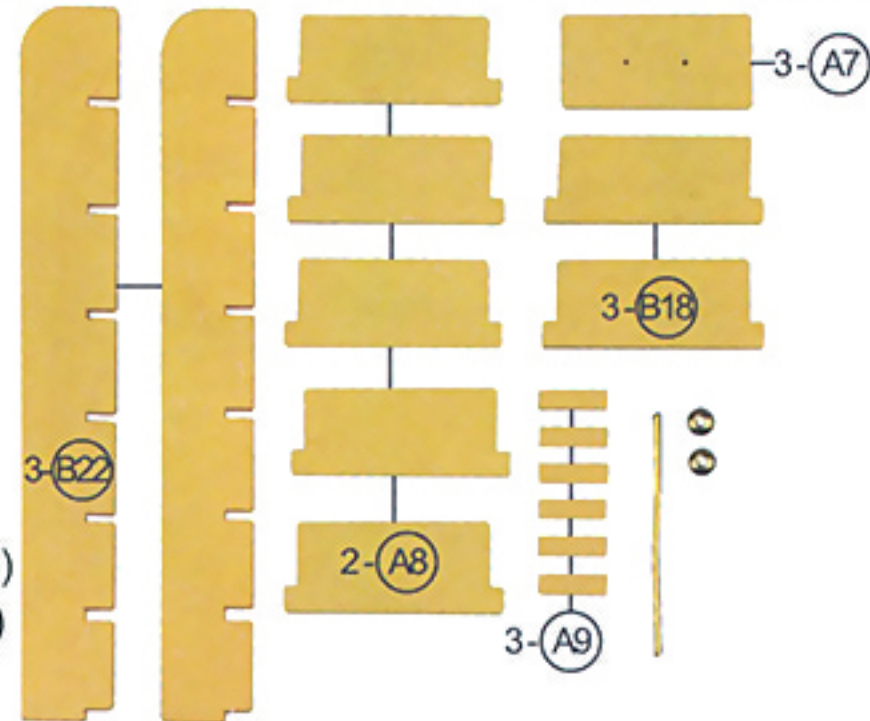

Paste as shown.



a is same with the step 1 & step 2 in Cabinet 1. Glue a with A9.



### No.4 Cabinet

#### List

- ① Wooden pieces 7 pcs

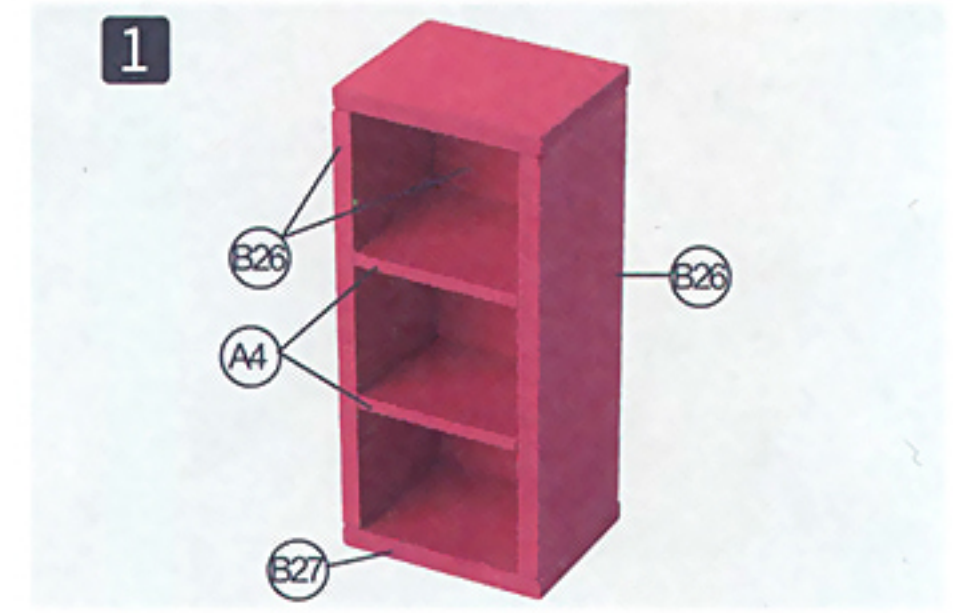
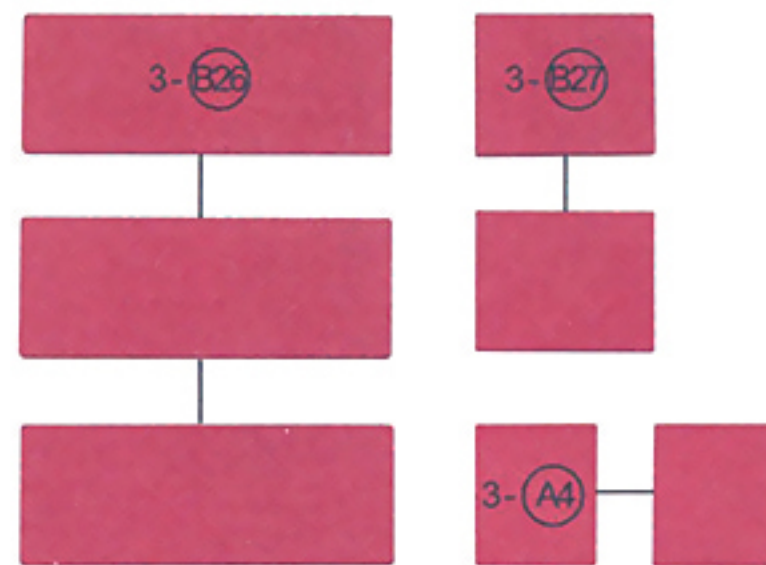

Paste as shown.



### No.5 Cabinet

#### List

- ① Wooden pieces 13 pcs

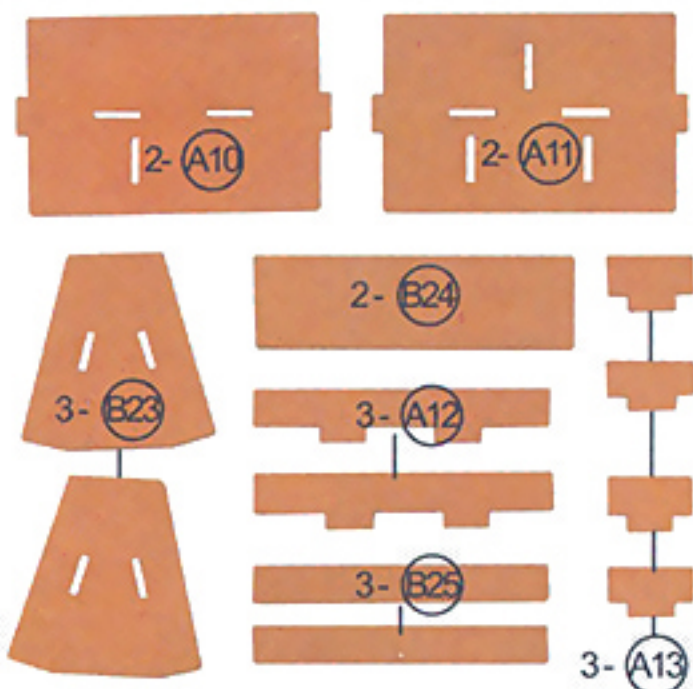

Paste as shown.



Reverse angle.

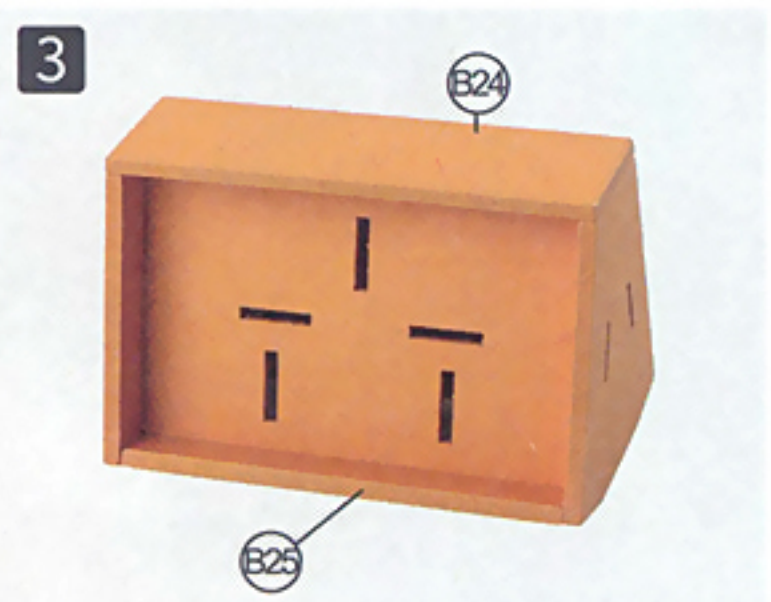

Paste as shown.

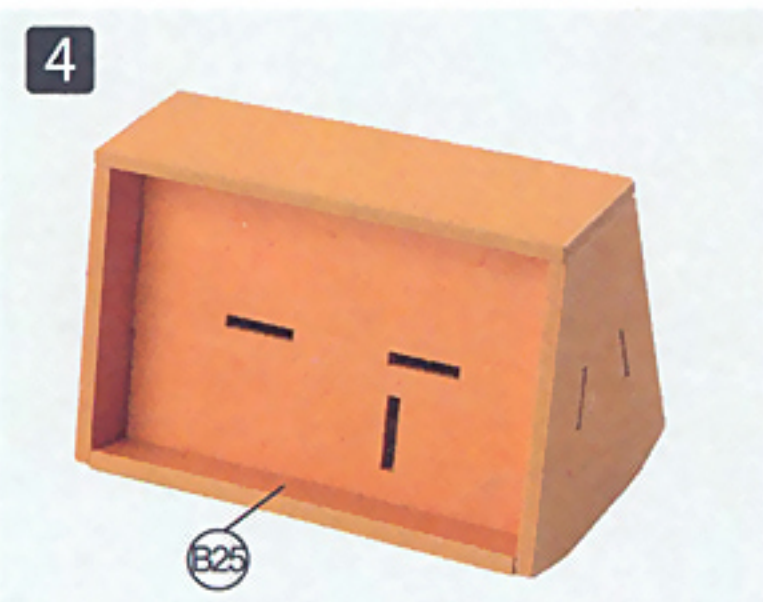

Reverse angle.

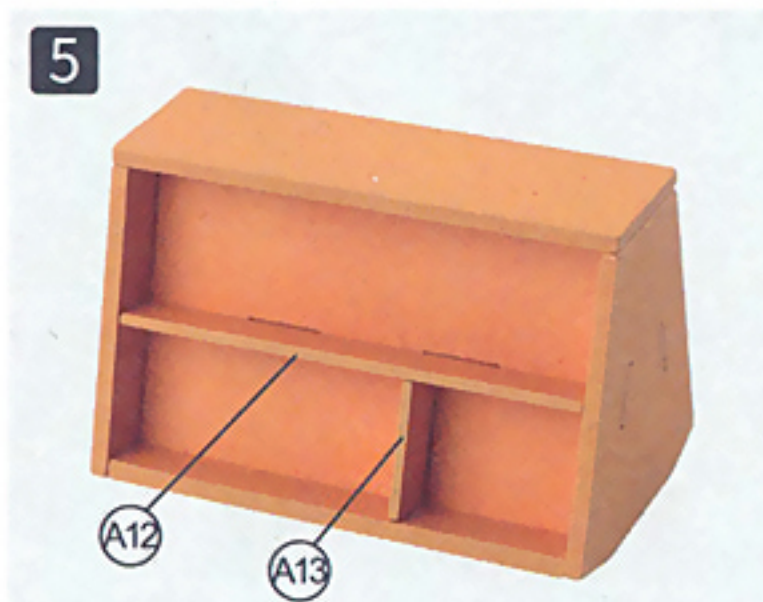

Paste as shown.

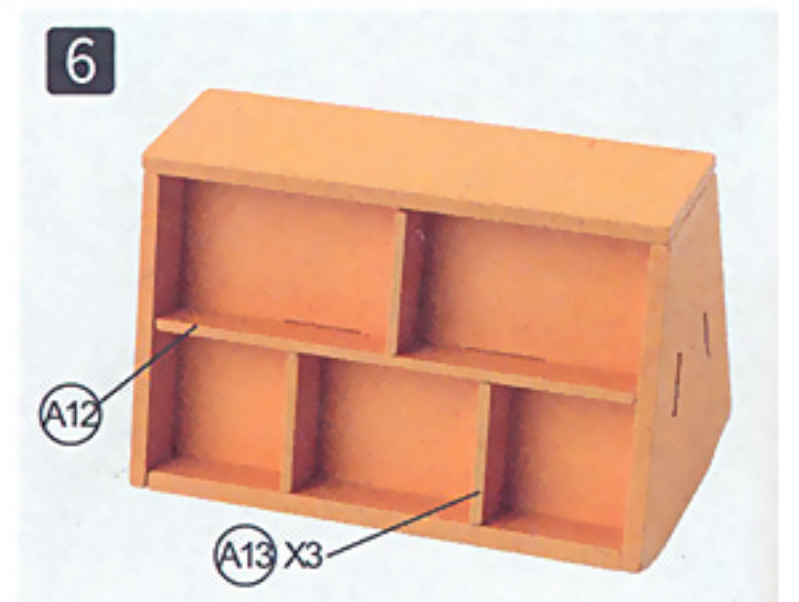

Complete.



# Ladder

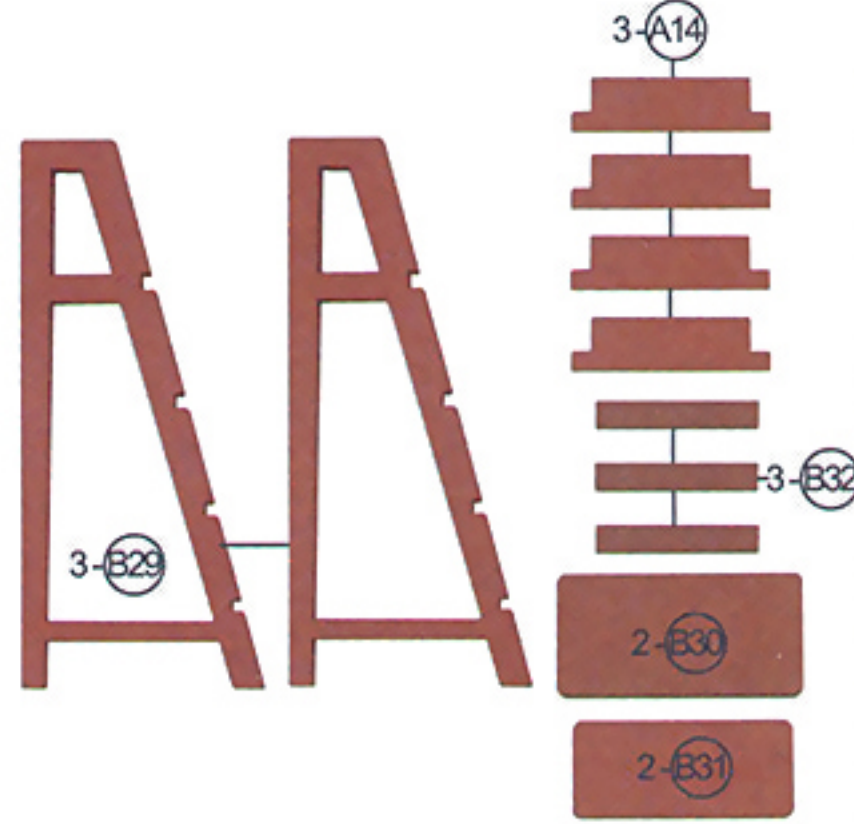

## List

- ① Wooden pieces 11 pcs

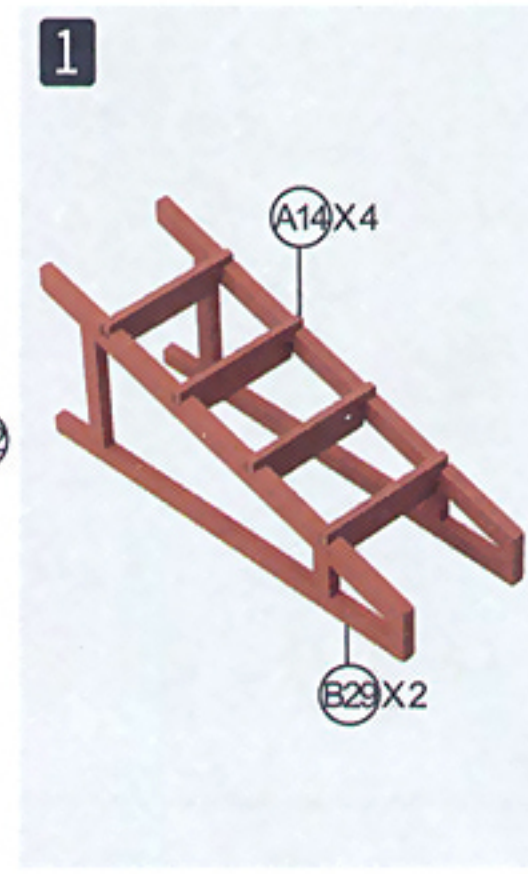

Paste as shown



Paste as shown



Complete.



# Small Cabinet

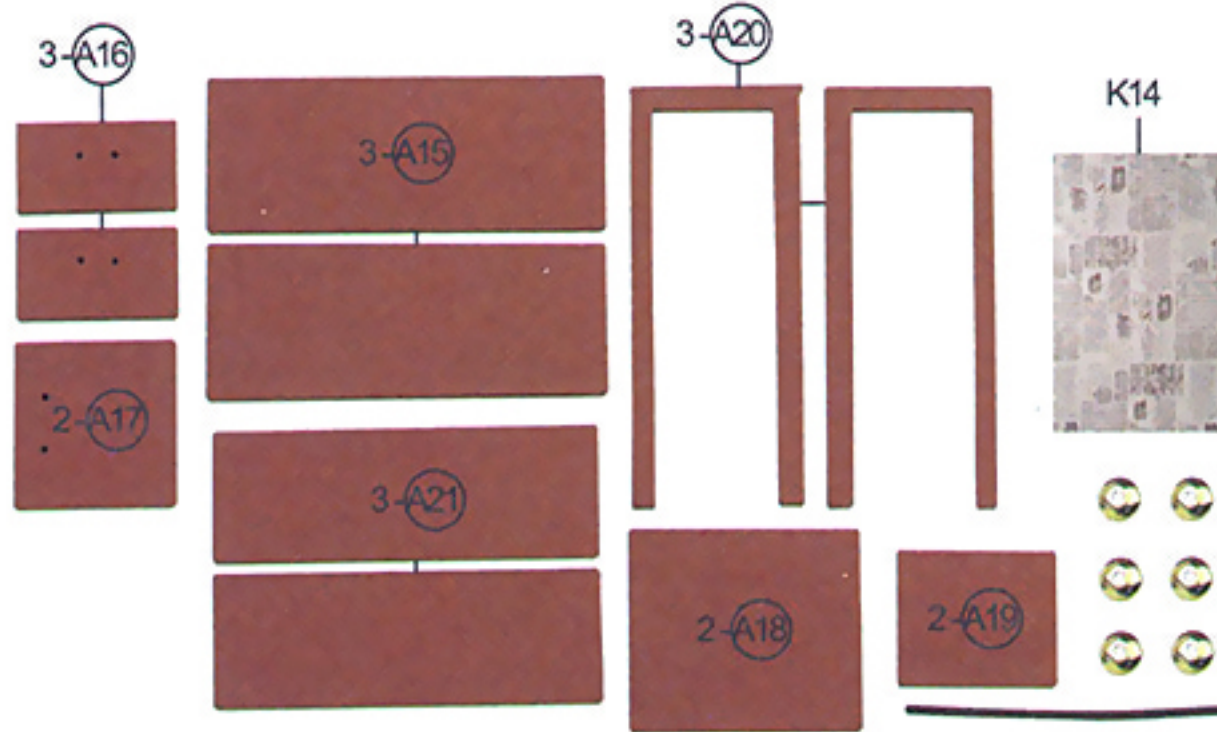

## List

- ① Wooden pieces 11 pcs
- ② Paper K14
- ③  $\varnothing 4\text{mm}$  golden receptacle 6 pcs (Bag No.6)
- ④ Brown metal wire L50mm (Bag No.6)

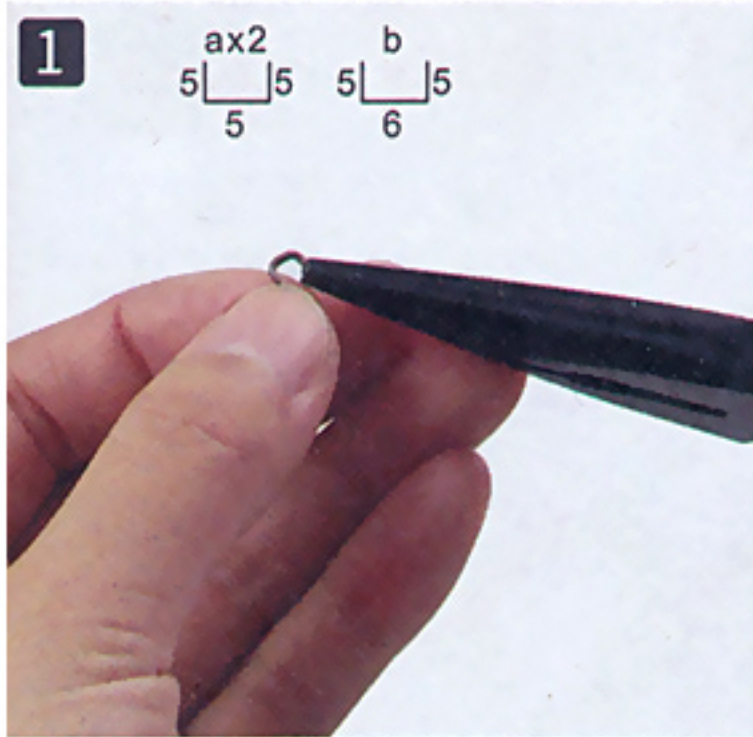

Bend the brown metal wire into U shape.

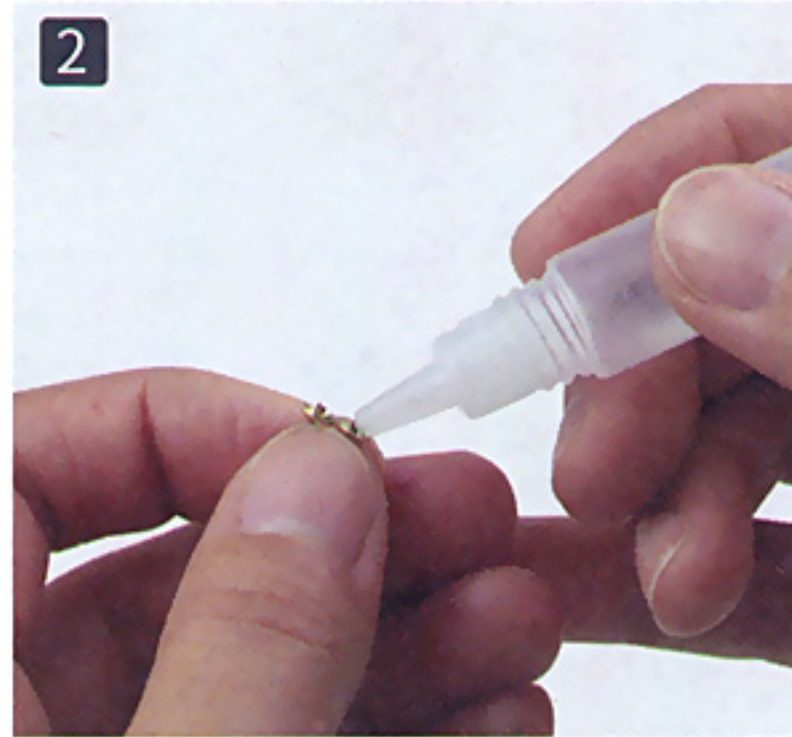

Put metal wire into receptacles. Glue the two ends.

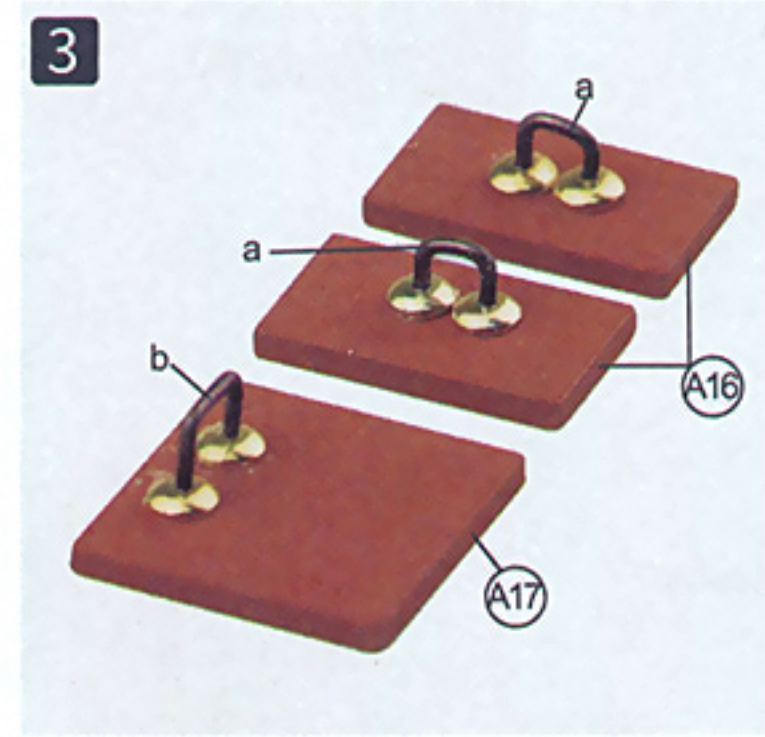

Insert into the holes.



Paste as shown.

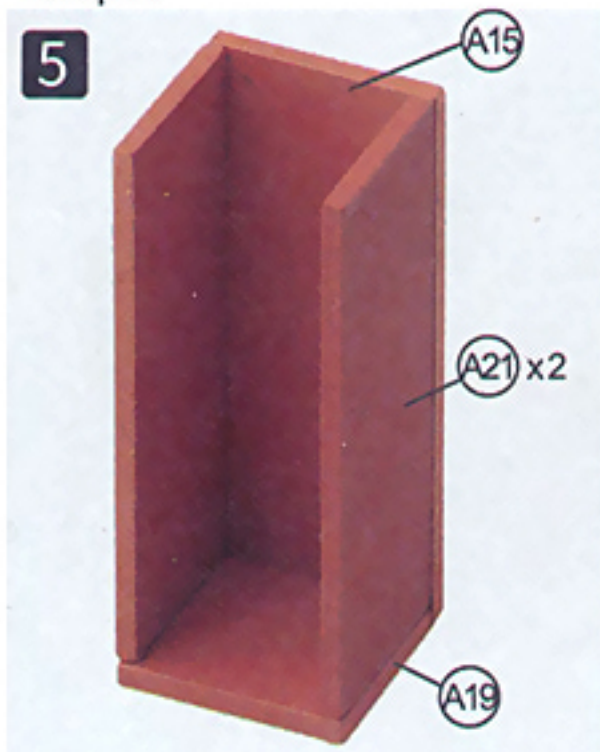

Paste as shown.



Paste as shown.



Paste as shown.



Paste as shown.



Paste as shown.



# Sofa

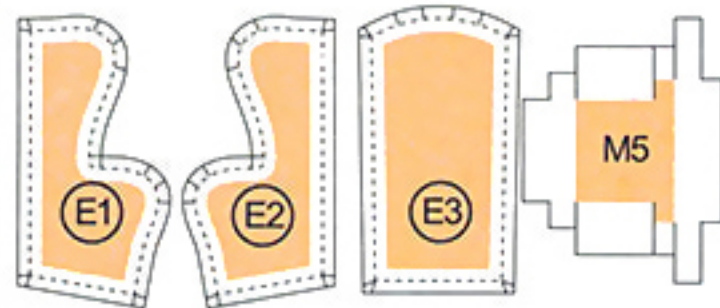
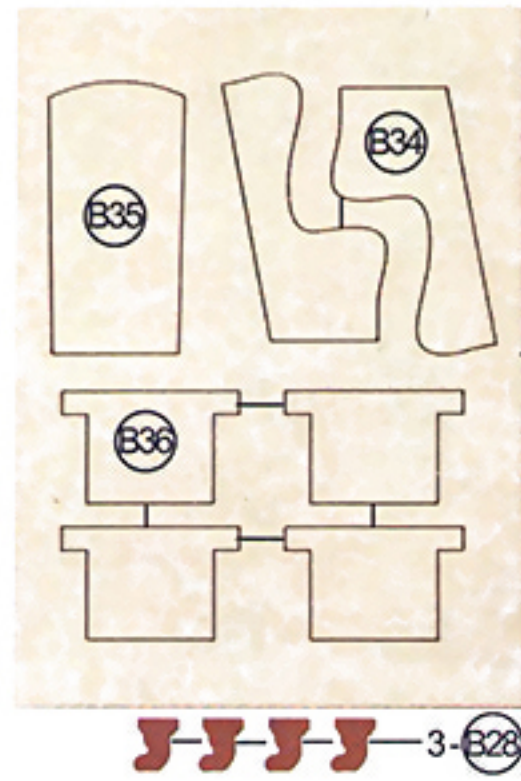

**!** Tips: Clean your hands before assembling

## List

- ① Wooden pieces 1pc (Bag No.1)
- ② Wooden pieces 4pcs
- ③ Paper E1, E2, E3
- ④ Paper M5
- ⑤ Fabric 100\*150mm 2 pcs (Bag No.4)

**1**

Mark along (E1).

**2**

Cut along the mark. Complete 2 pcs.

**3**

Cut as shown (no glue)

**4**

Cut a 10\*15mm fabric and paste as shown.

**5**

Glue the border of (E34). Paste the extra cloth onto the border.

**6**

e: Cut the white edge of E1. Turn over e as shown. Cut the fabric as shown.

**7**

Paste the extra cloth onto the border.

**8**

Paste step 5 and step 7 as shown.

**9**

Complete a2 in the same way. Use E2.

**10**

Mark along (E3).

**11**

Cut along the mark. Complete 2 pcs.

**12**

Paste and cut as shown.

**13**

Same as step 5.

**14**

Paste as shown.

**15**

Trim the extra cloth.

**16**

Paste as shown.

**17**

Mark along M5.

**18**

Cut along the mark. Complete 2 pcs.

**19**

Paste step 16 with step 18.

**20**

Paste along the arrows in step 19.

**21**

Paste along the arrows in step 20.

**22**

Paste along the arrows in step 21. Complete 2 pcs in the same way.

**23**

Paste the two parts as shown.

**24**

Paste a1, a2 with c. as shown.

**25**

Paste b as shown.

**26**

Paste (E38) as shown.

**27**

Complete.



### Mini round table

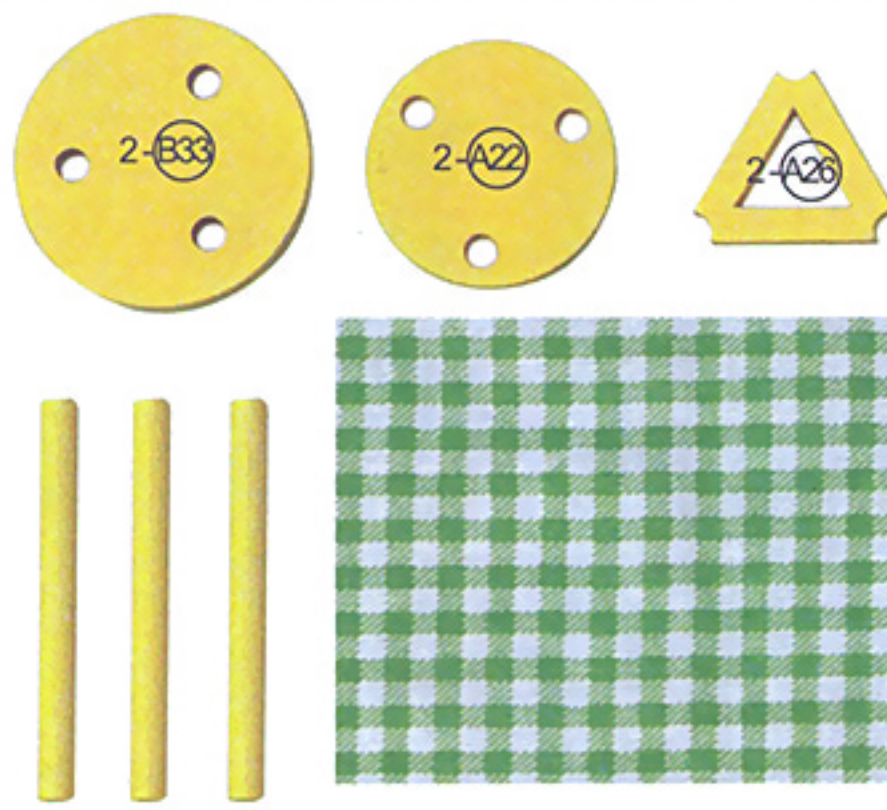

### List

- ① Wooden pieces 3pcs
- ②  $\varnothing 3\text{mm}$ , L33mm Cylinder 3pcs(Bag No.4)
- ③ Fabric 50\*50mm 1pcs(Bag No.4)

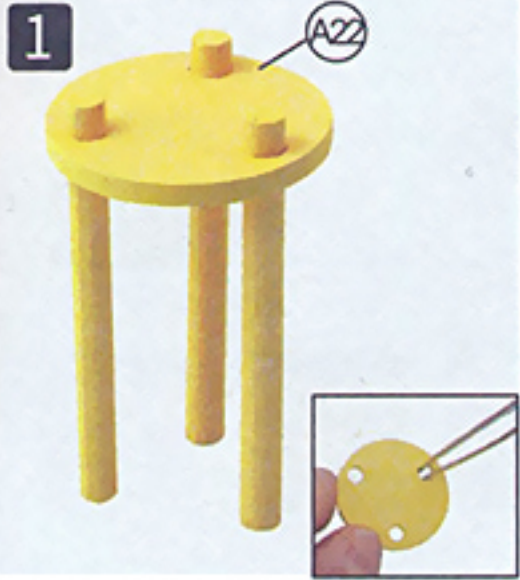
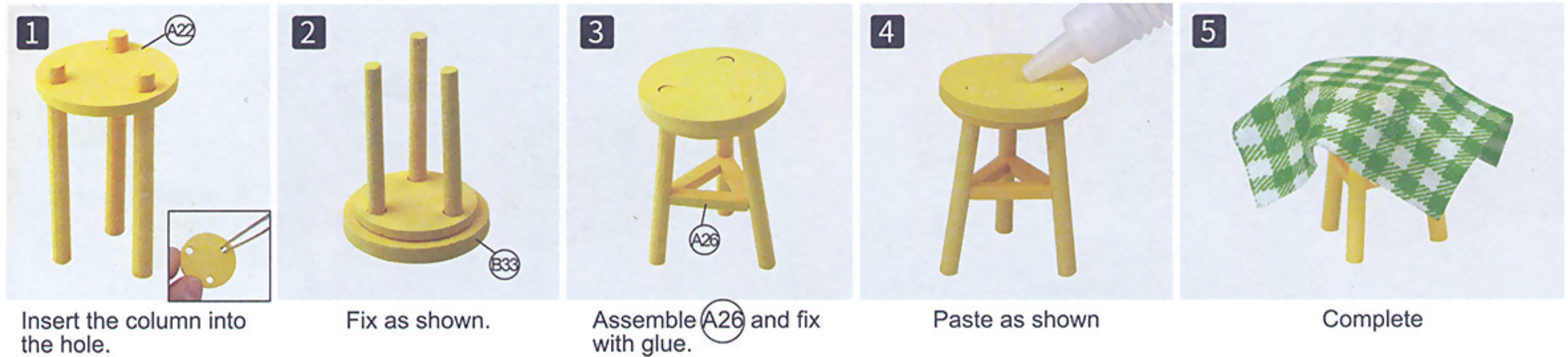

1 Insert the column into the hole.

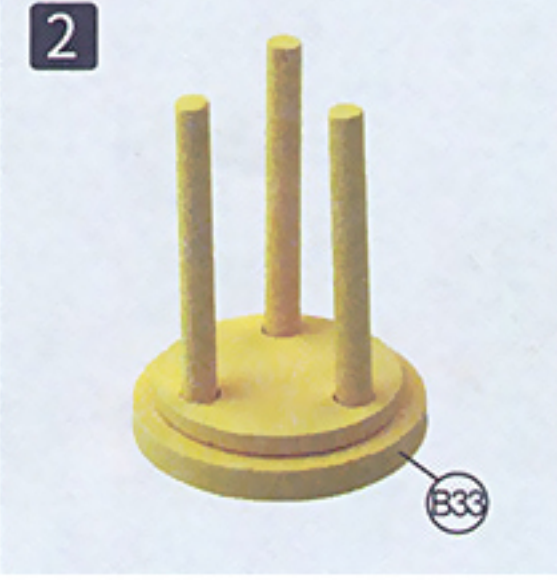

2 Fix as shown.



3 Assemble A26 and fix with glue.



4 Paste as shown



5 Complete



### Mini box

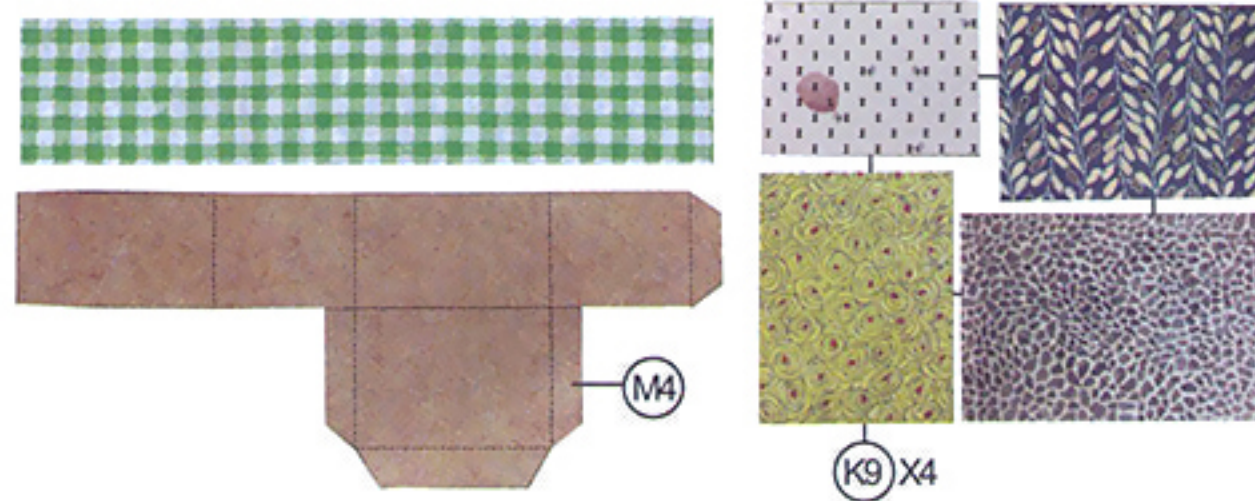

### List

- ① Fabric 30\*100mm 1pcs(Bag No.4)
- ② Paper M4, K9\*4

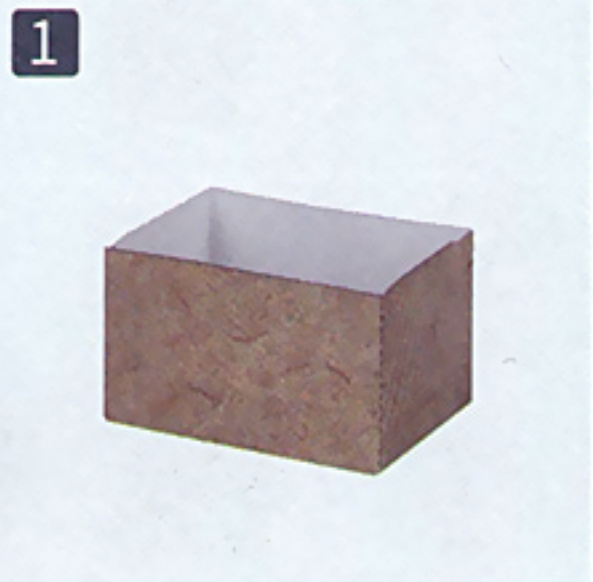
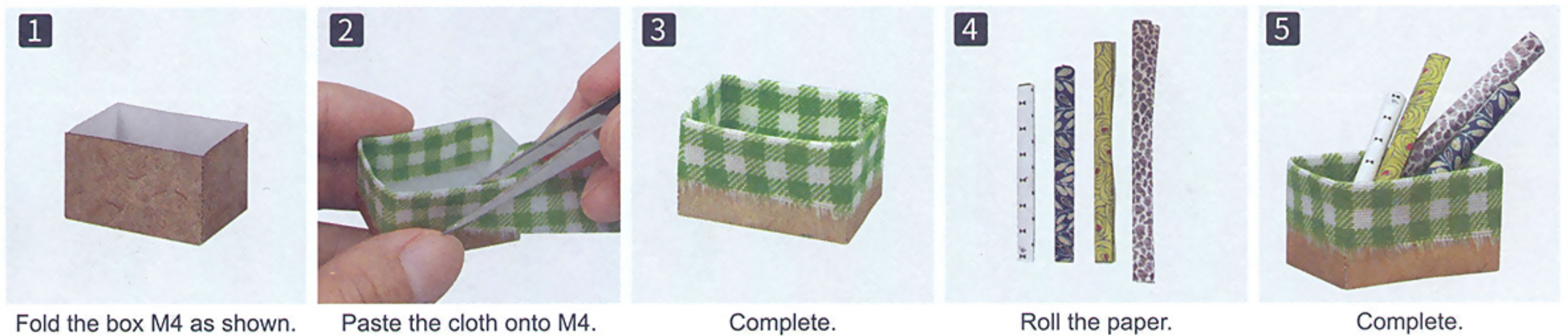

1 Fold the box M4 as shown.

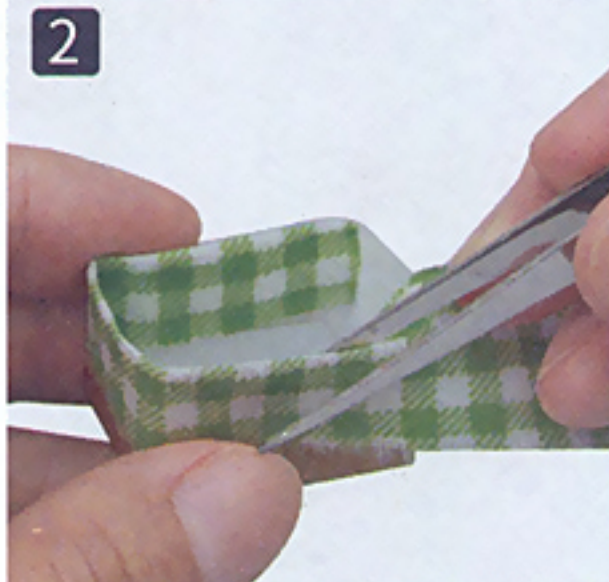

2 Paste the cloth onto M4.

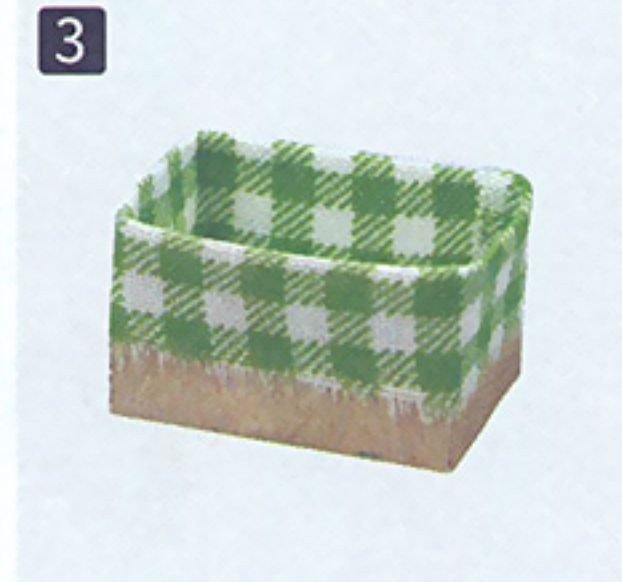

3 Complete.

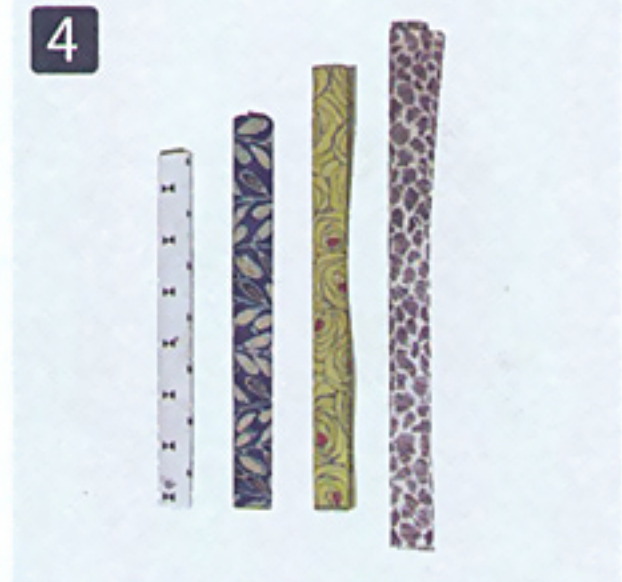

4 Roll the paper.



5 Complete.

### Mini fruit tray



### List

- ①  $\varnothing 5\text{mm}$  red bead 3pcs(Bag No.6)
- ② Silver bigger receptacle 1pcs(Bag No.6)
- ③ Silver smaller receptacle 1pcs(Bag No.6)

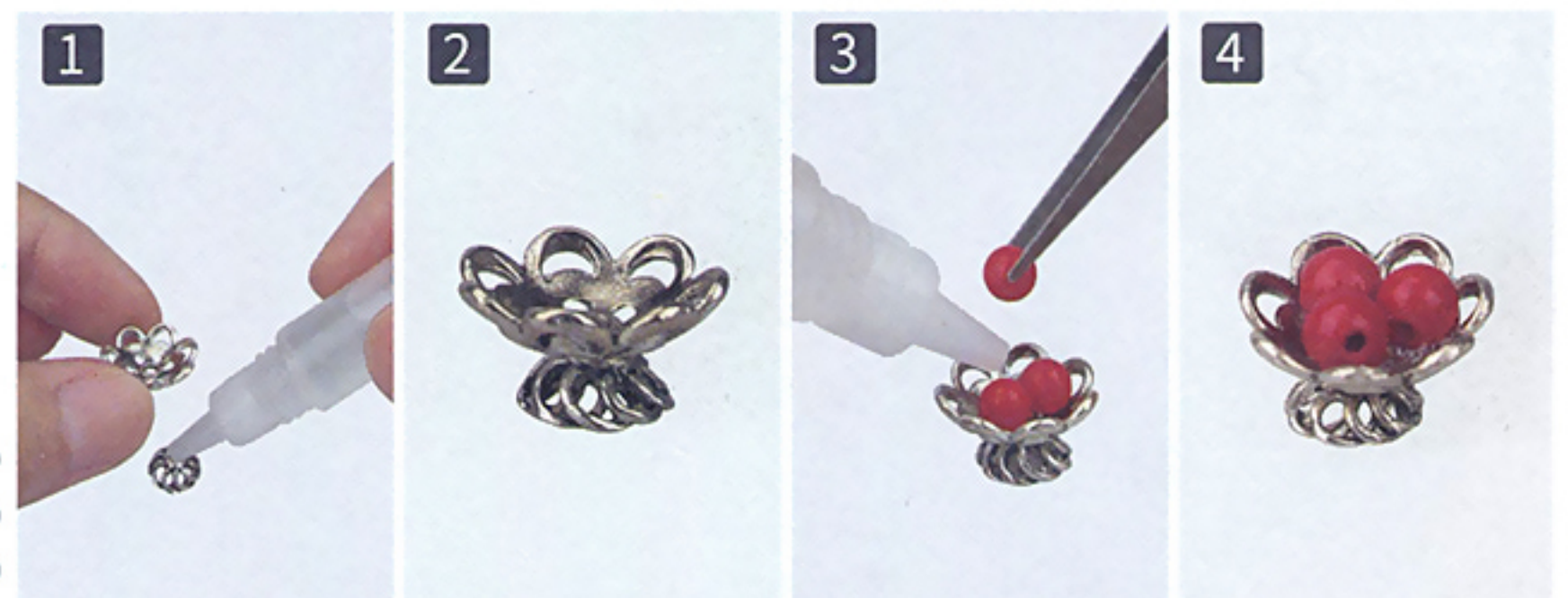

# Leather suitcase

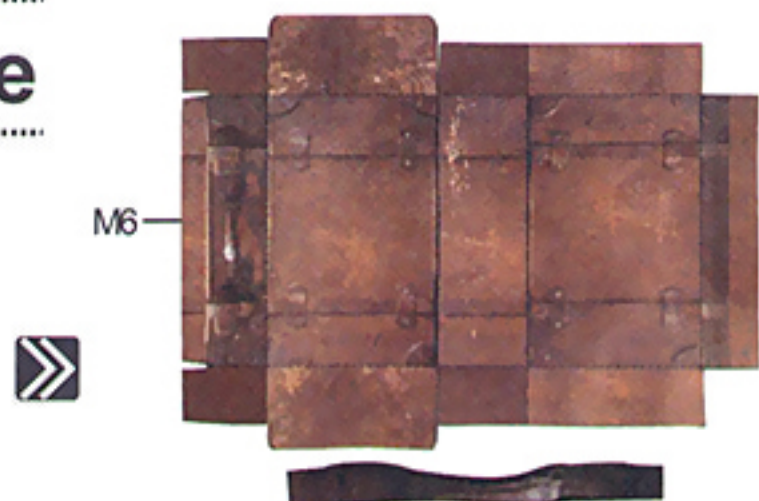

M6



List

- 1 Paper M6, K8\*6



K8 X6



# Paper box



List

- 1 Color paper 10pcs

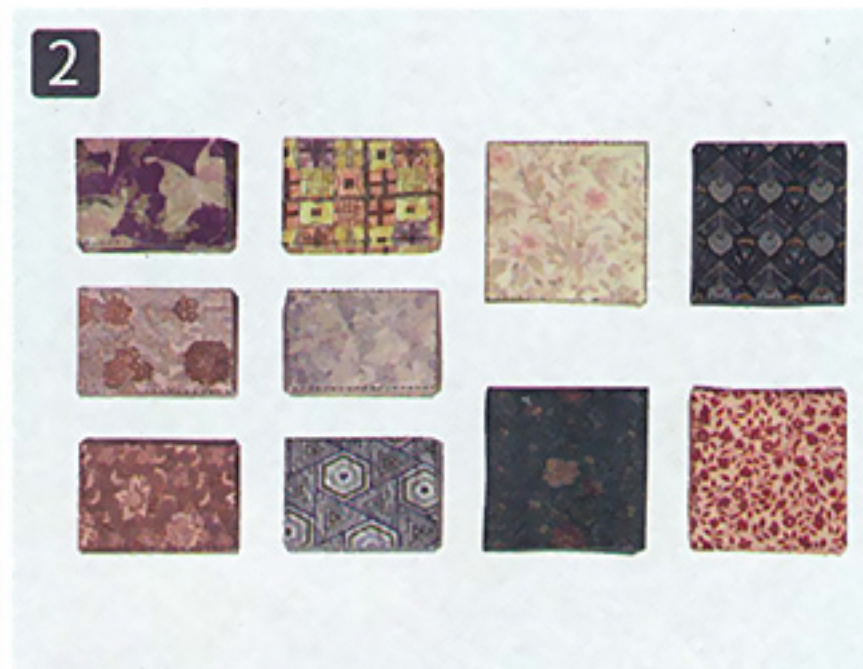

# Book 1



L3



N5

List

- 1 Paper L1-L10
- 2 Paper N1-N6



Fold as shown.



Fold L3 as shown.

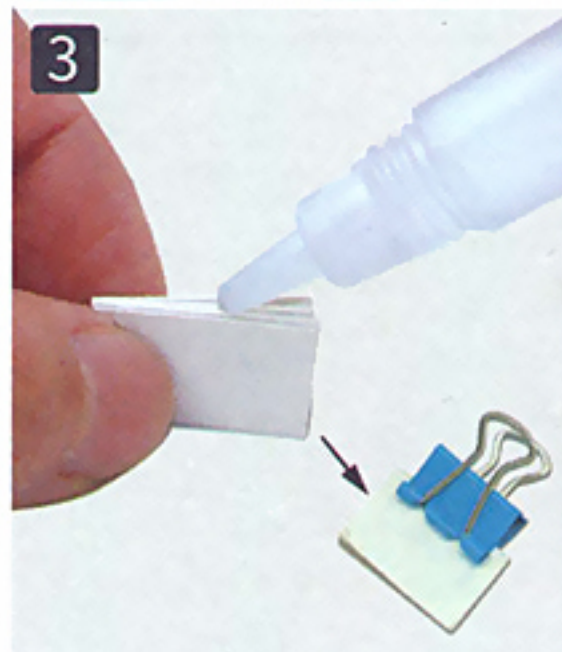

Glue the white spine and fix with clip.

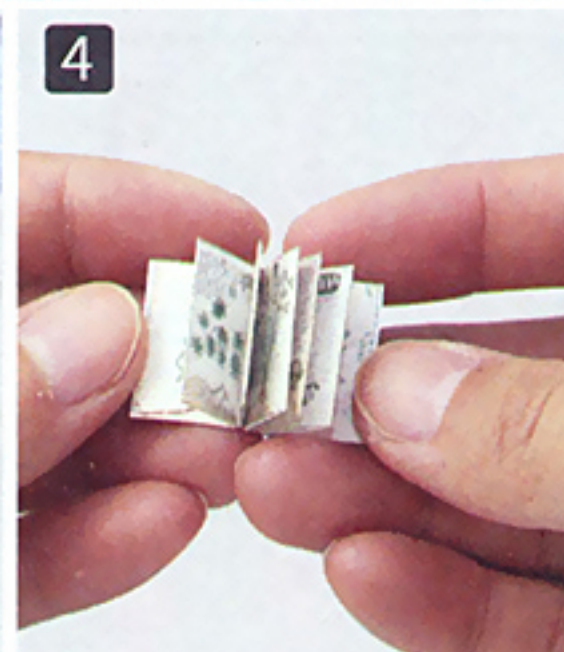

Combine book N5 with cover L3.



Complete 10 books in the same way.

# Book 2

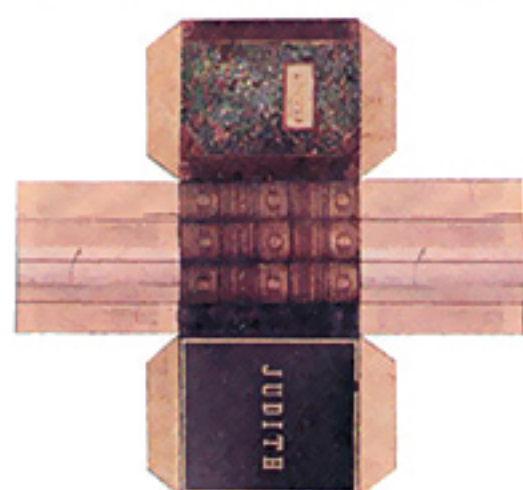

List

- 1 Paper 45pcs



Complete 45pcs books





## Book 3

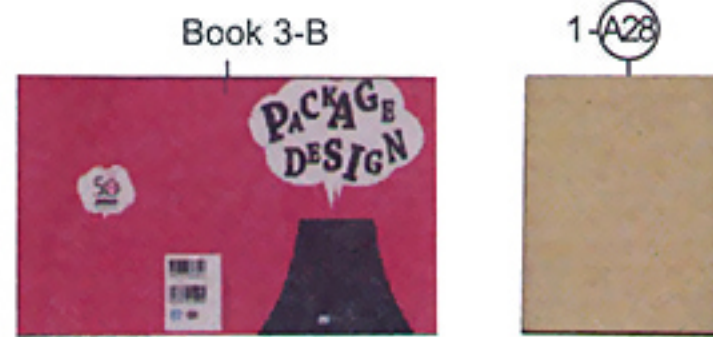

Match with the correct size.  
Complete 20pcs books.

### List

- ① 1-A28 ( bigger ) 10pcs
- ② 1-A28 ( smaller ) 10pcs
- ③ Book 3-A( smaller ) 10pcs
- ④ Book 3-B( bigger ) 10pcs



## Book 4

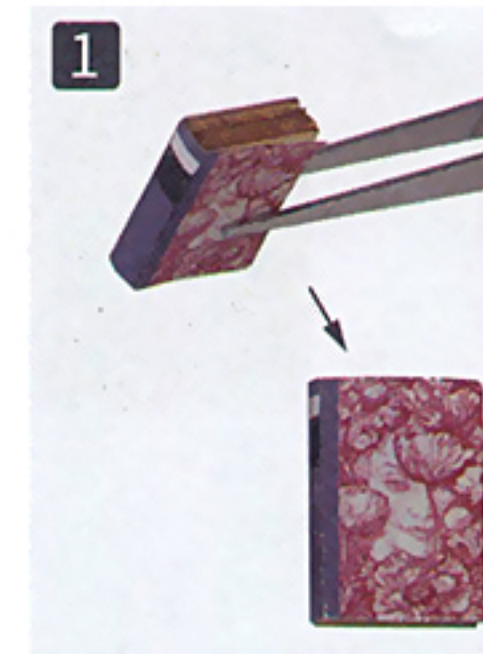
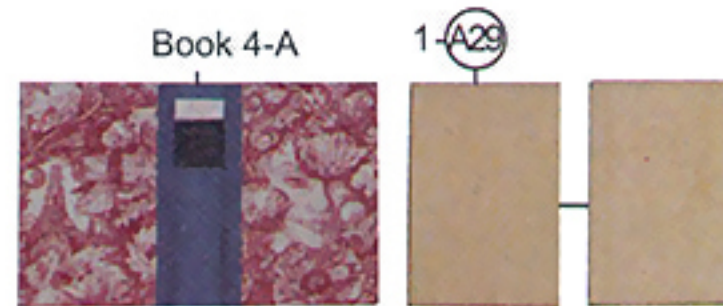

Match with the correct size.  
Complete 32pcs books.

### List

- ① 1-A28 ( bigger ) 24pcs
- ② 1-A29 ( smaller ) 40pcs
- ③ Book 4-A( smaller ) 20pcs
- ④ Book 4-B( bigger ) 12pcs



## Painting 1

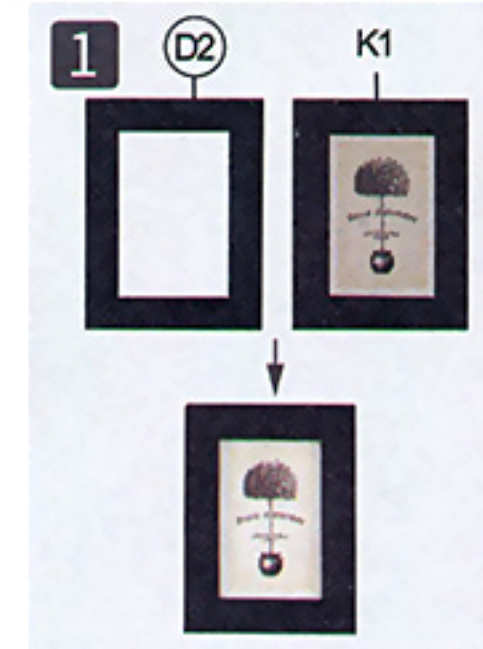
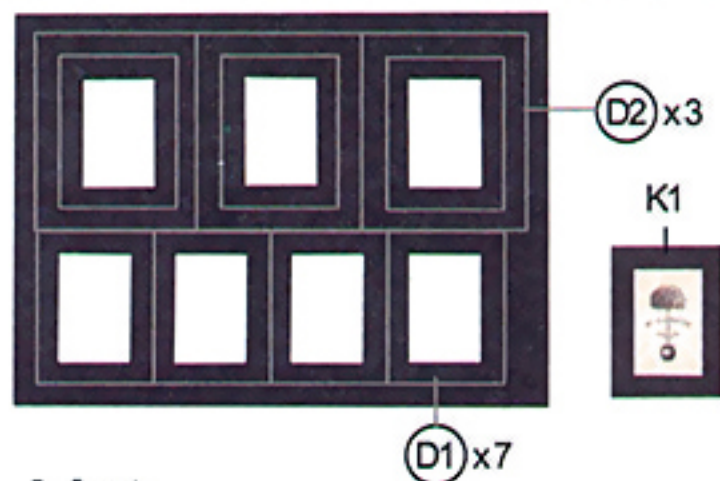

Complete the 10pcs paint.

### List

- ① Black card paper 1pcs (Bag No.6)
- ② Paper K1\*10



## Painting 2

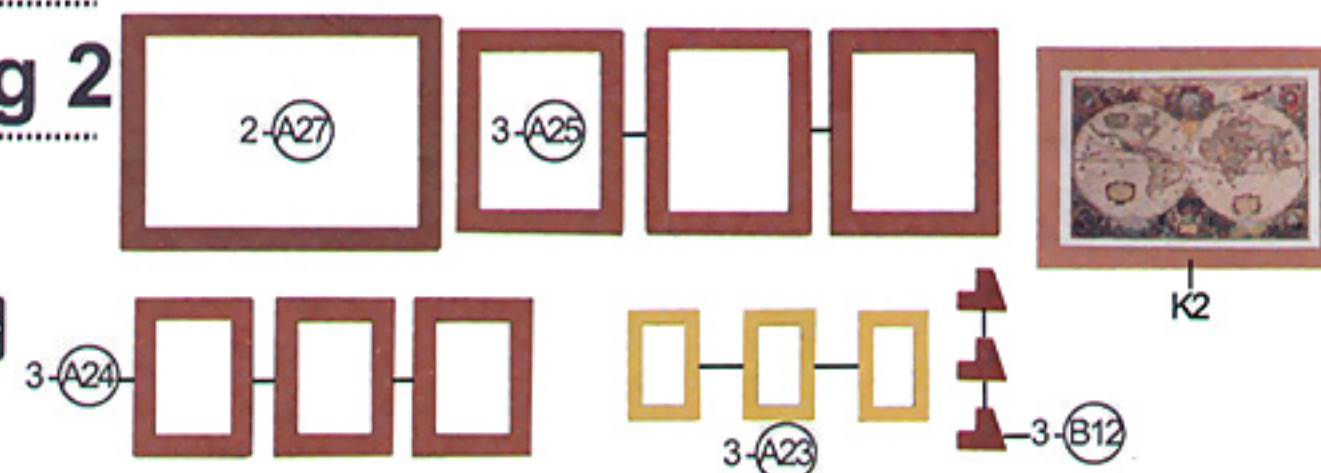

### List

- ① Wooden pieces 13pcs
- ② Paper K2\*7, K3\*3

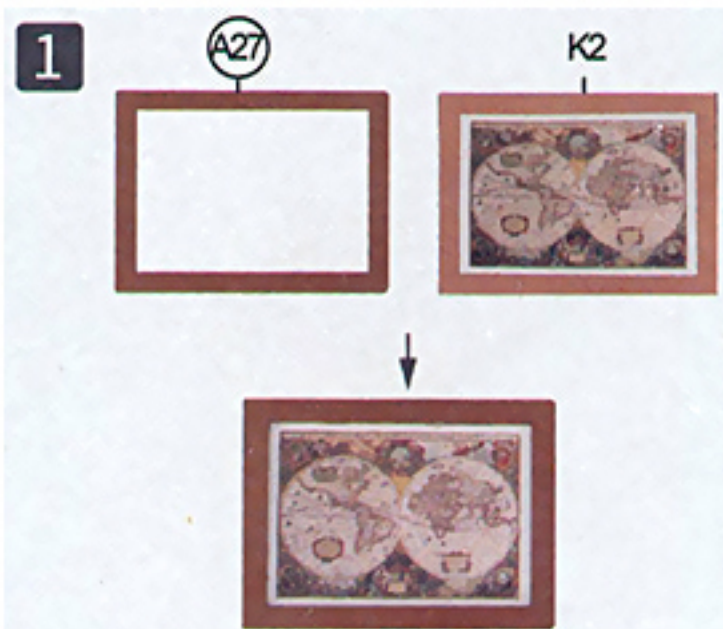

Complete 10pcs in total.

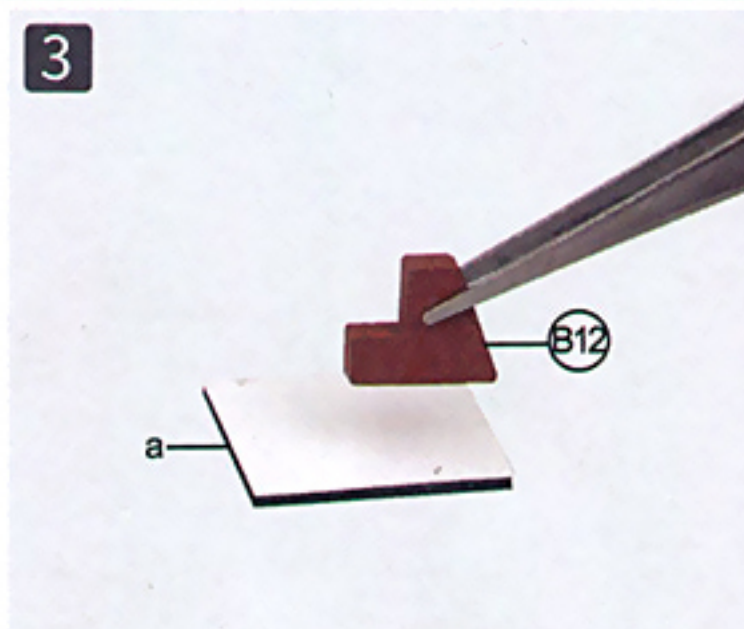

Paste a with B12 as shown.

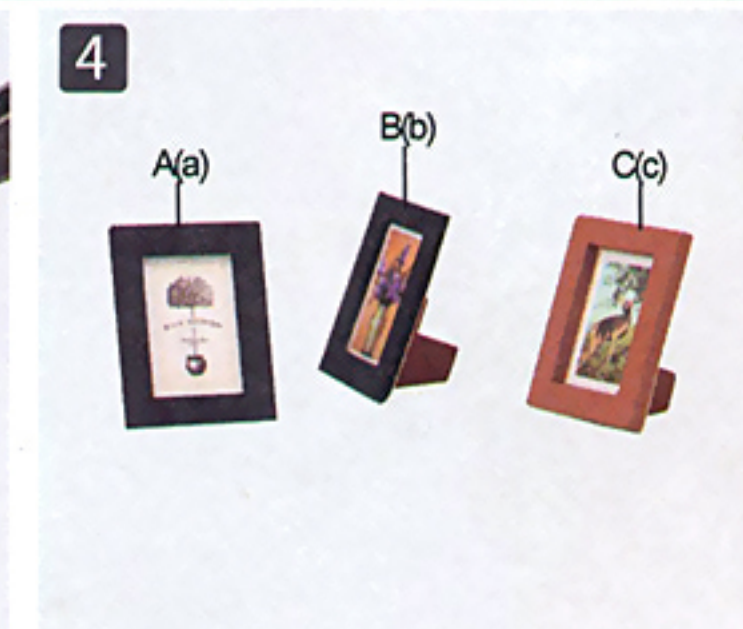

Complete 3pcs.



### Painting 3



#### List

- ① 1-A28 2pcs
- ② Paper K13\*2

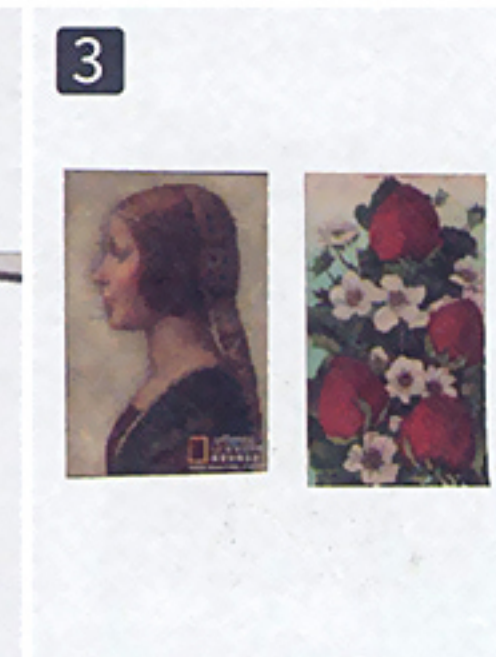
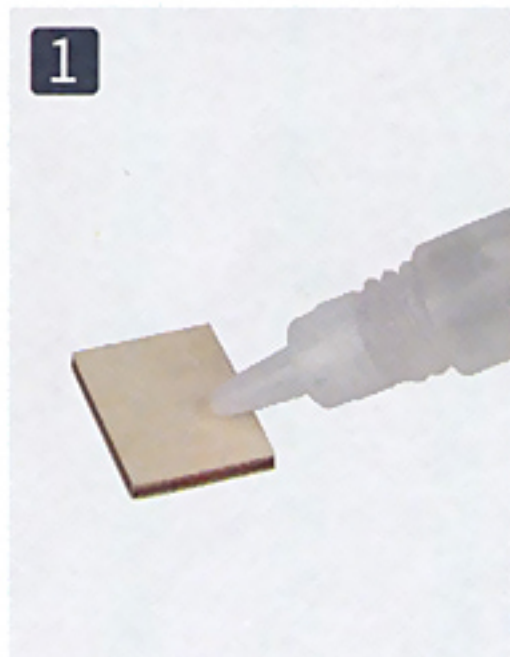

Complete 2pcs in total.

### Plant 1



#### List

- ① Flowerpot 1pcs (Bag No.6)
- ② Yellow stamen 3pcs (Bag No.4)
- ③ Green paper 1pcs (Bag No.4)

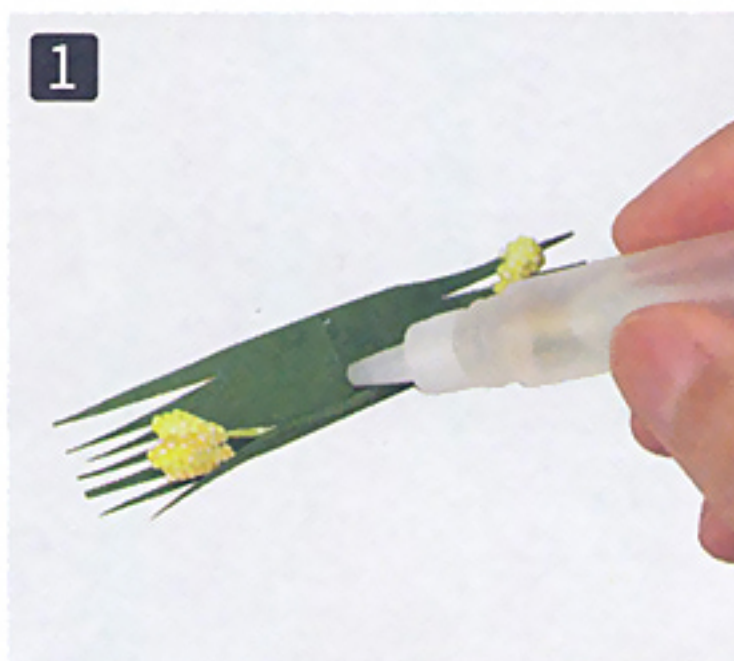

Cut the green paper (20\*75mm) into the shape as shown.

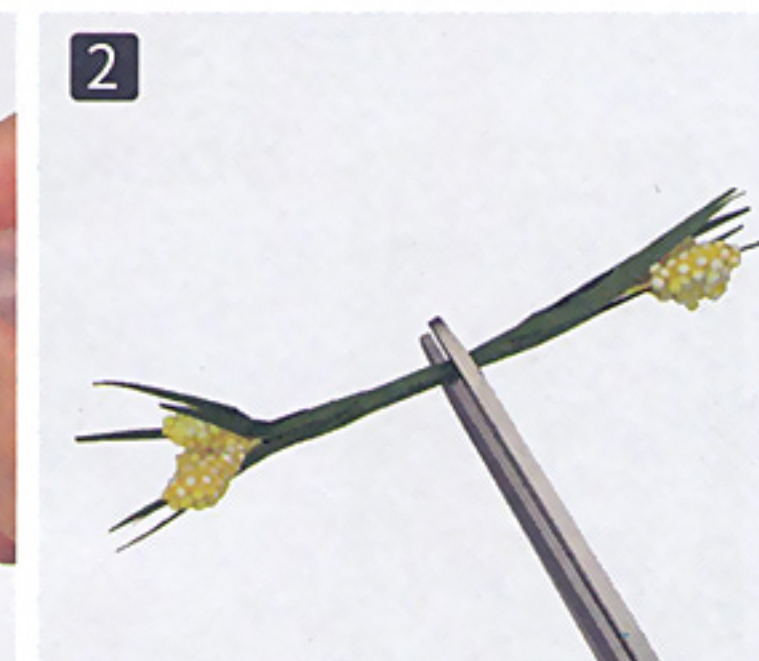

Cut off from the middle.

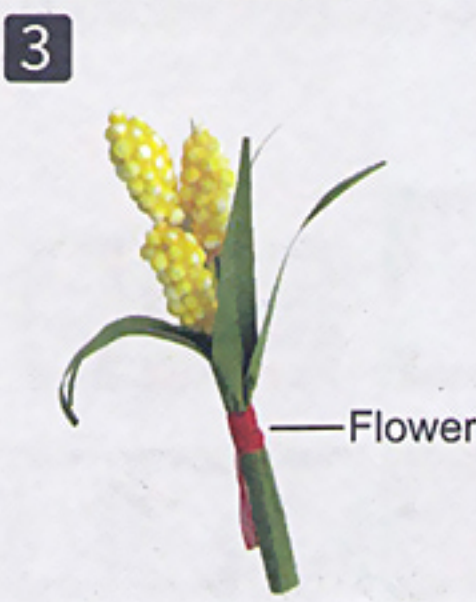

Pull out one string from the red cloth and tie the flower.

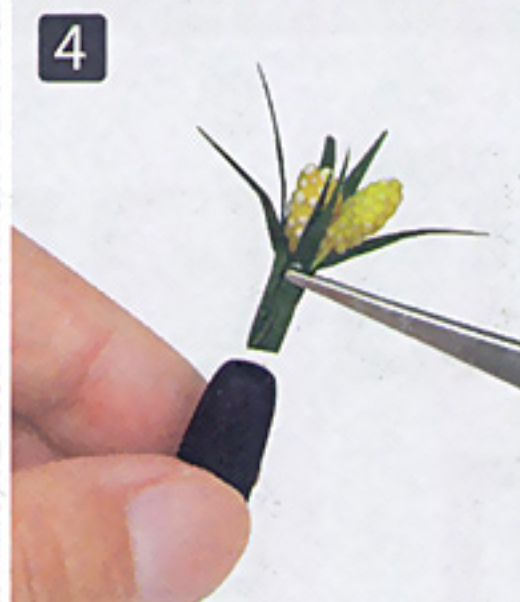

Insert into the pot.



Complete

### Plant 2



#### List

- ① Green/Orange/Yellow 1pcs (Bag No.4)
- ② Yellow stamen 4pcs (Bag No.4)
- ③ Coppery Flowerpot 1pcs (Bag No.6)

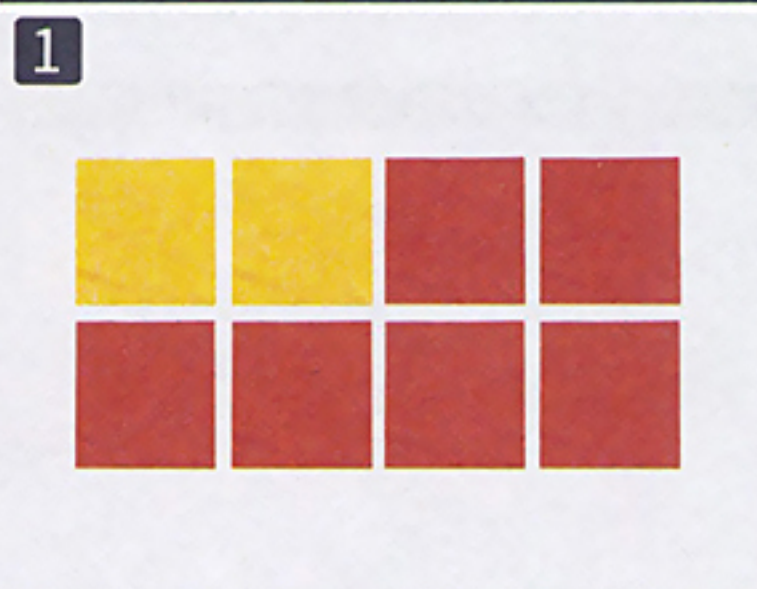

Cut as shown(size 10\*10mm). 8pcs in total.

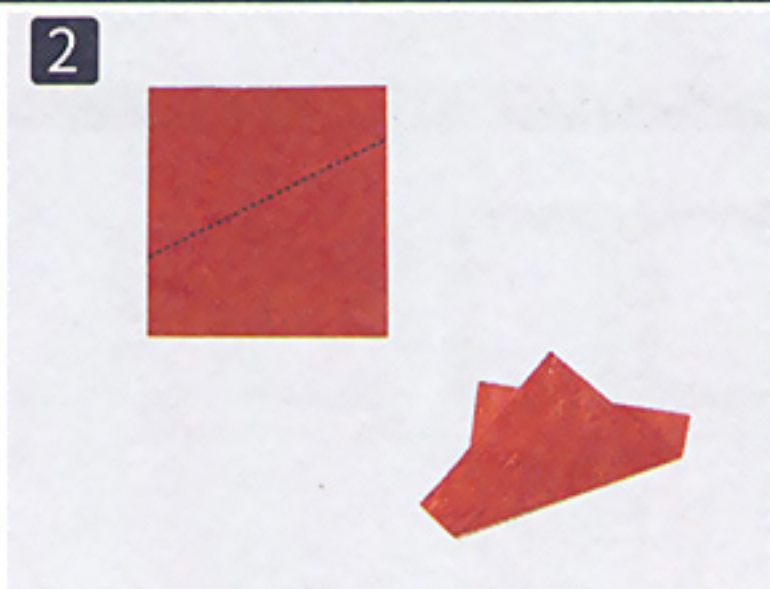

Fold as shown

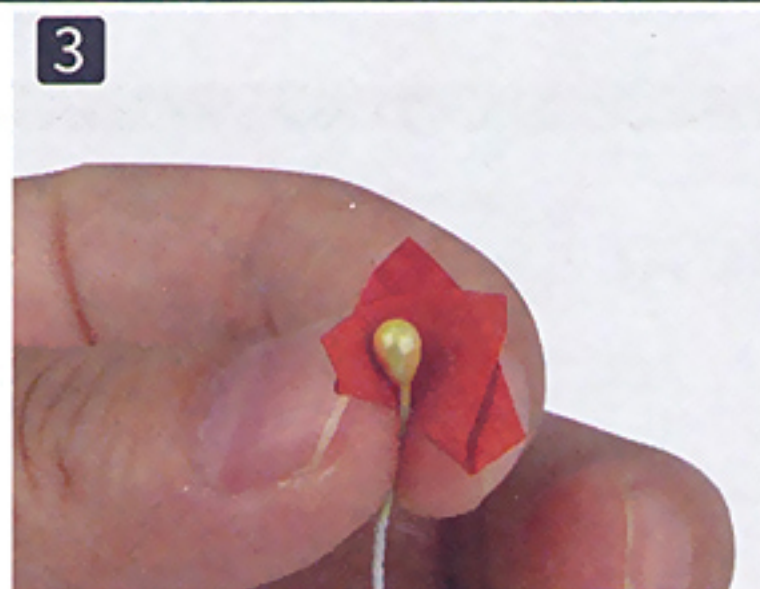

Wrap and glue.



Complete 8pcs in total.

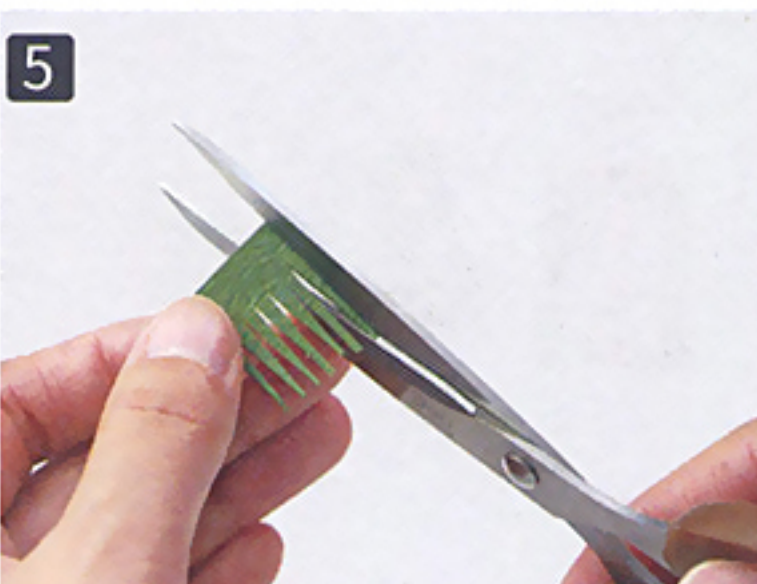

Cut the green paper(size 30\*30mm) as shown.

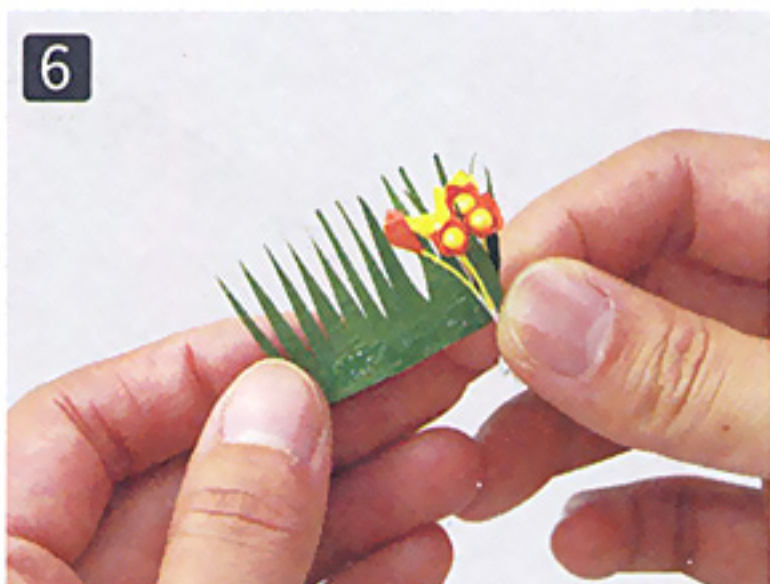

Paste as shown.



Complete.

# Furniture (Do your own house. Below is for your reference.)

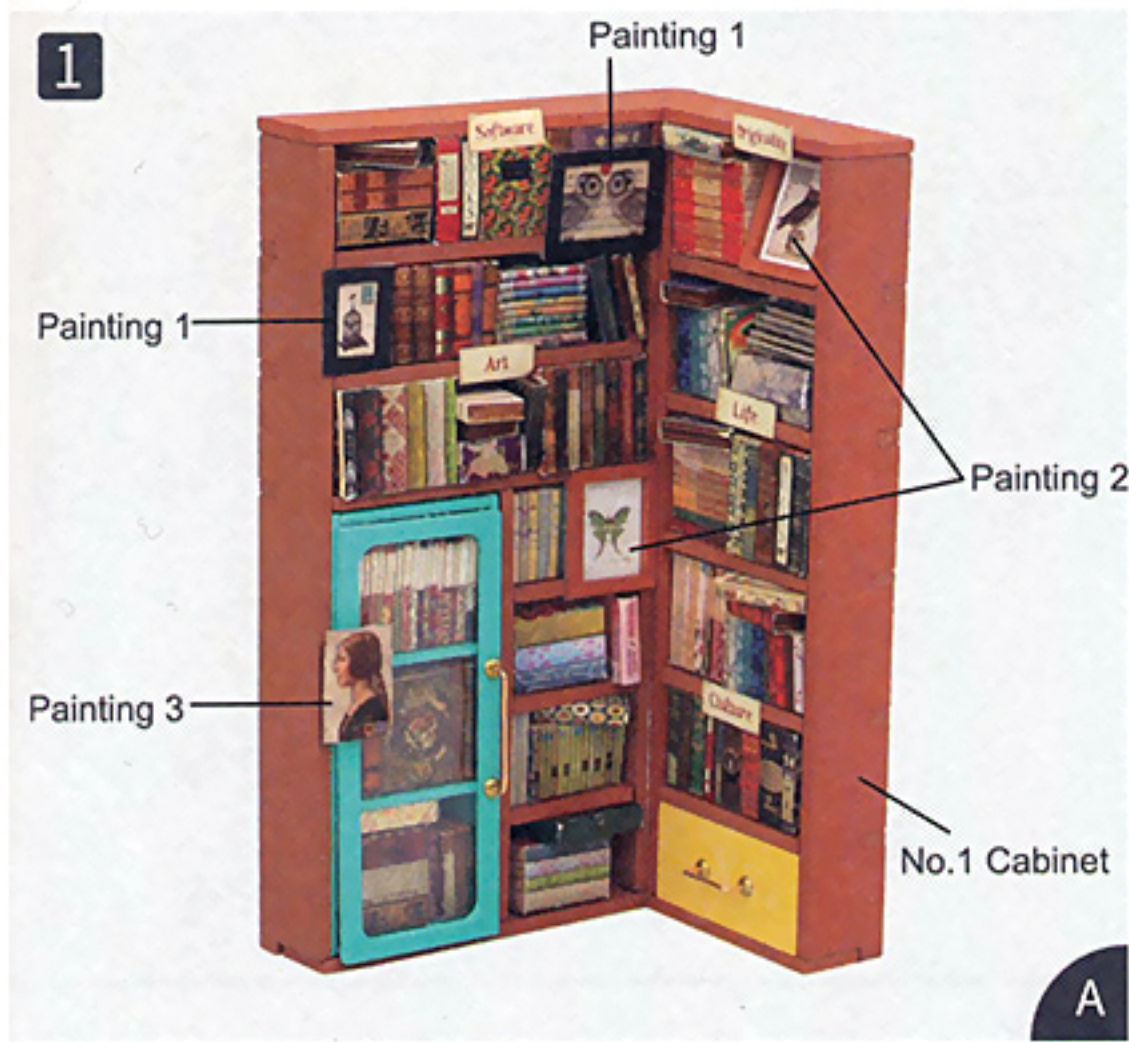

- ① Paper box X4 ② Book 1X2 ③ Book 2X21  
④ Book 3X3 ⑤ Book 4X12 ⑥ K10X5

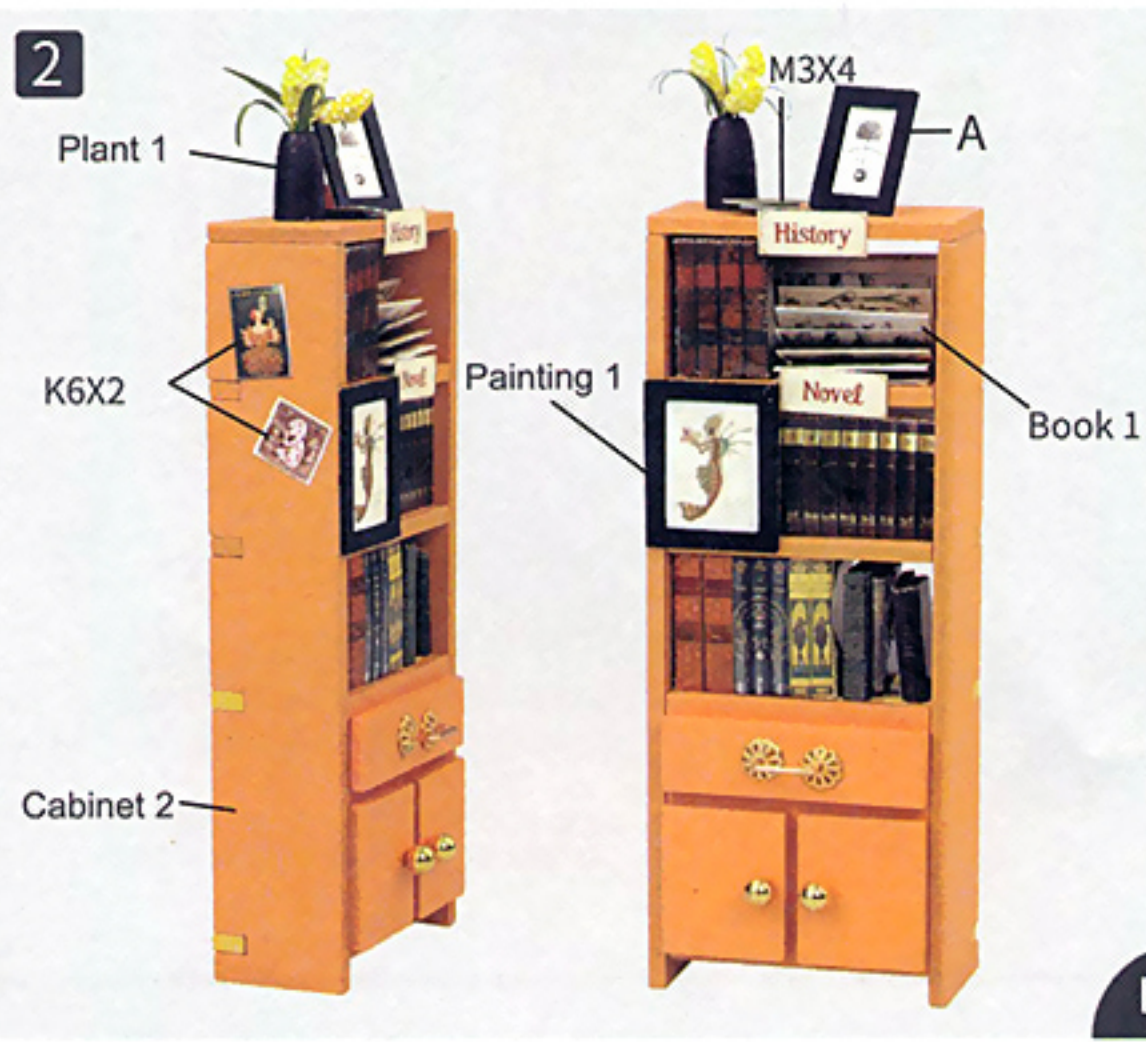

- ① Book 2X3 ② Book 3X1 ③ Book 4X2 ④ K10X2

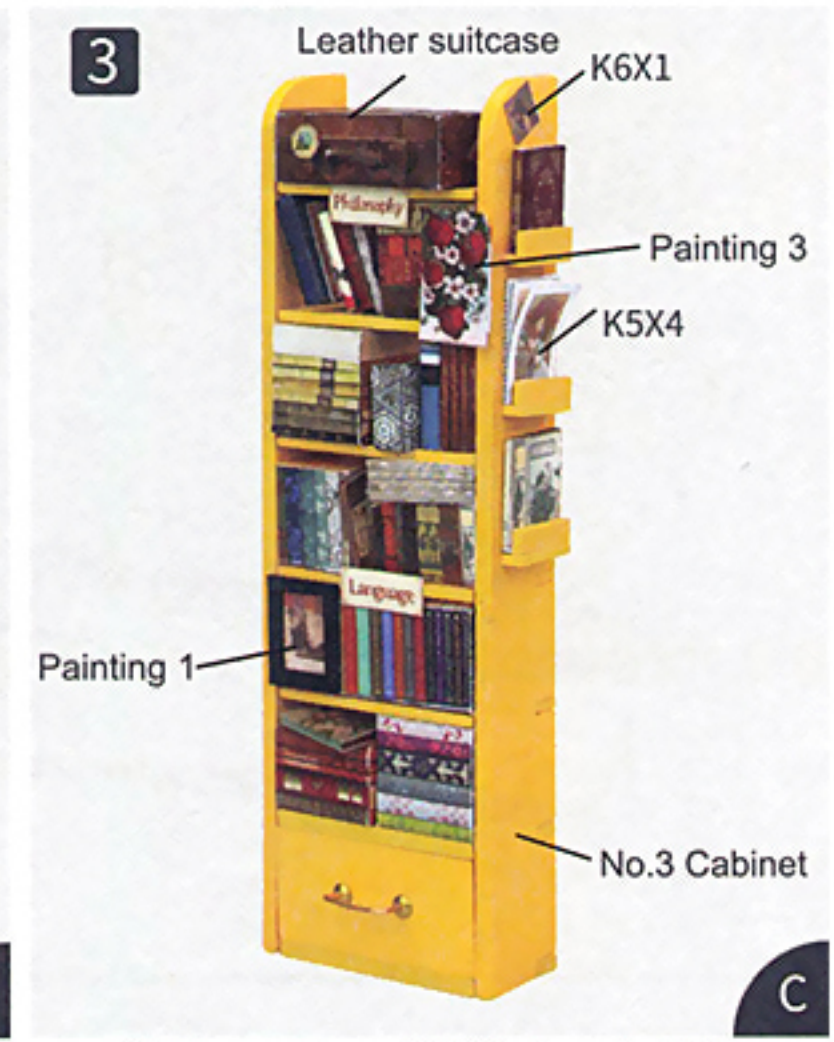

- ① Paper box X1 ② Book 1X1  
③ Book 2X8 ④ Book 3X7  
⑤ Book 4X3 ⑥ K10X2



- ① Book 1X1 ② Book 2X3  
③ Book 4X1

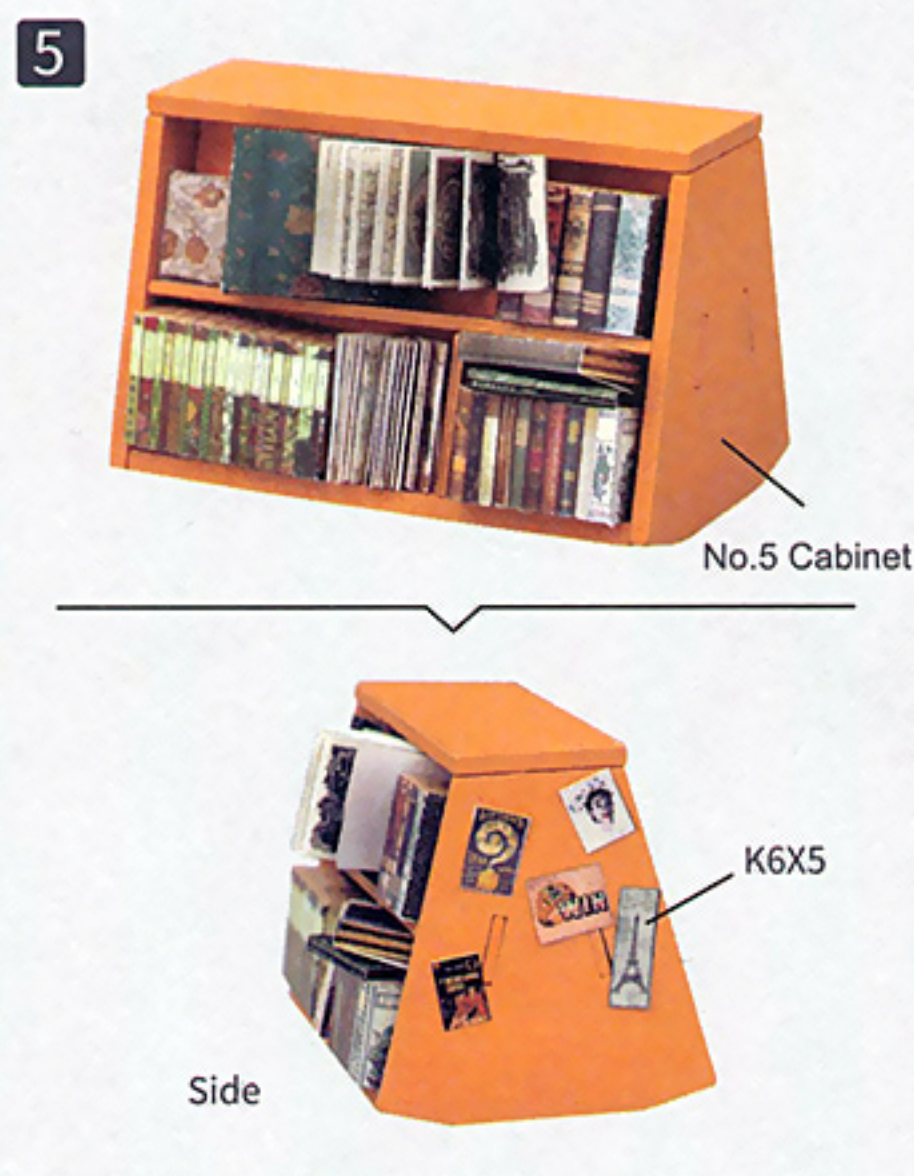

- ① Paper box X2 ② Book 1X2 ③ Book 2X3  
④ Book 3X1 ⑤ Book 4X1



- ① Paper box X2 ② Book 1X1 ③ Book 2X7  
④ Book 3X5 ⑤ Book 4X5



- ① Book 3X1 ② Book 4X2



- ① Book 3X2



- ① Book 1X1 ② Book 4X2



- ① Paper box X1  
② Book 4X4

# Frame

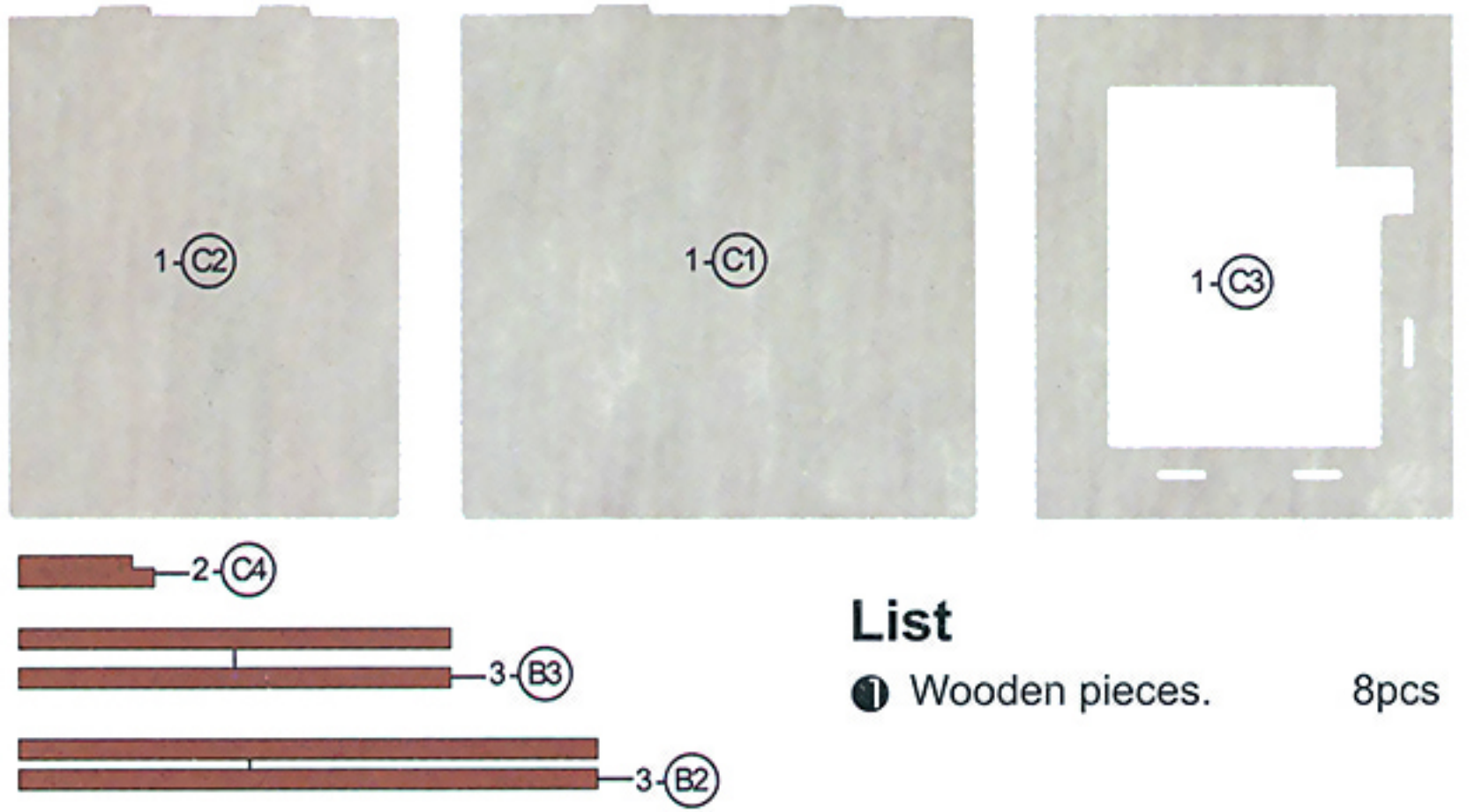
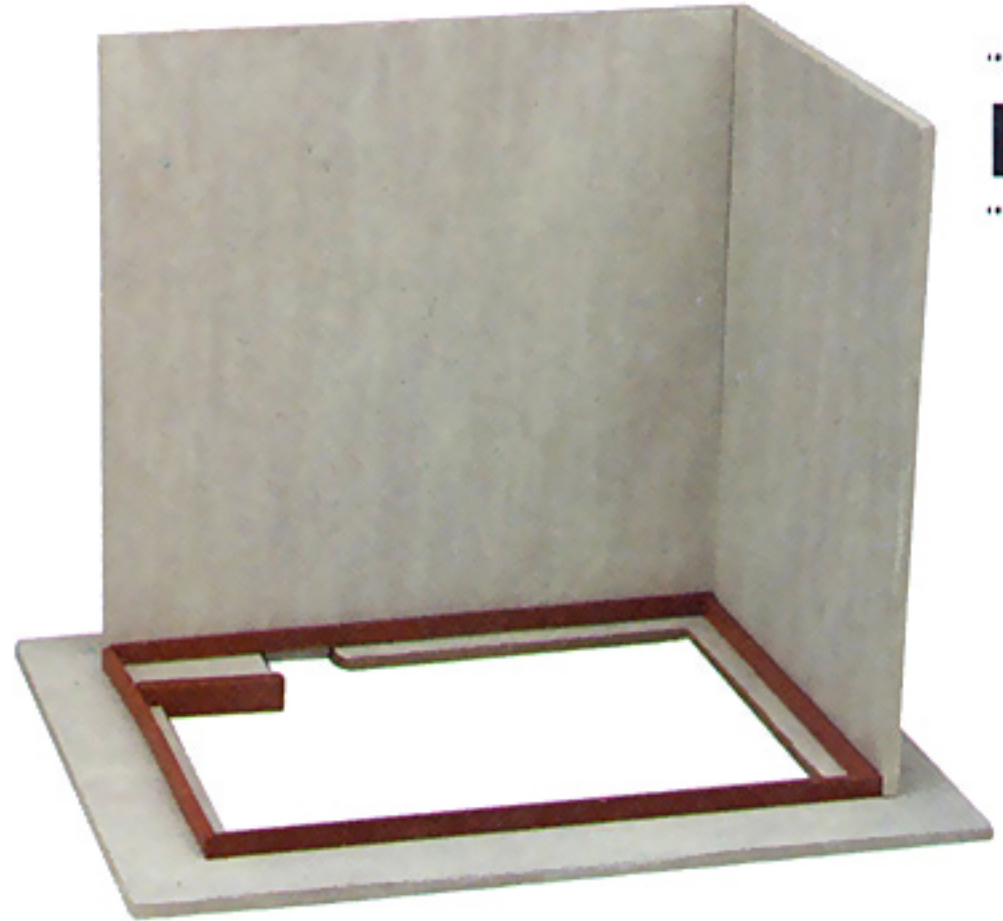

**List**  
 ① Wooden pieces. 8pcs

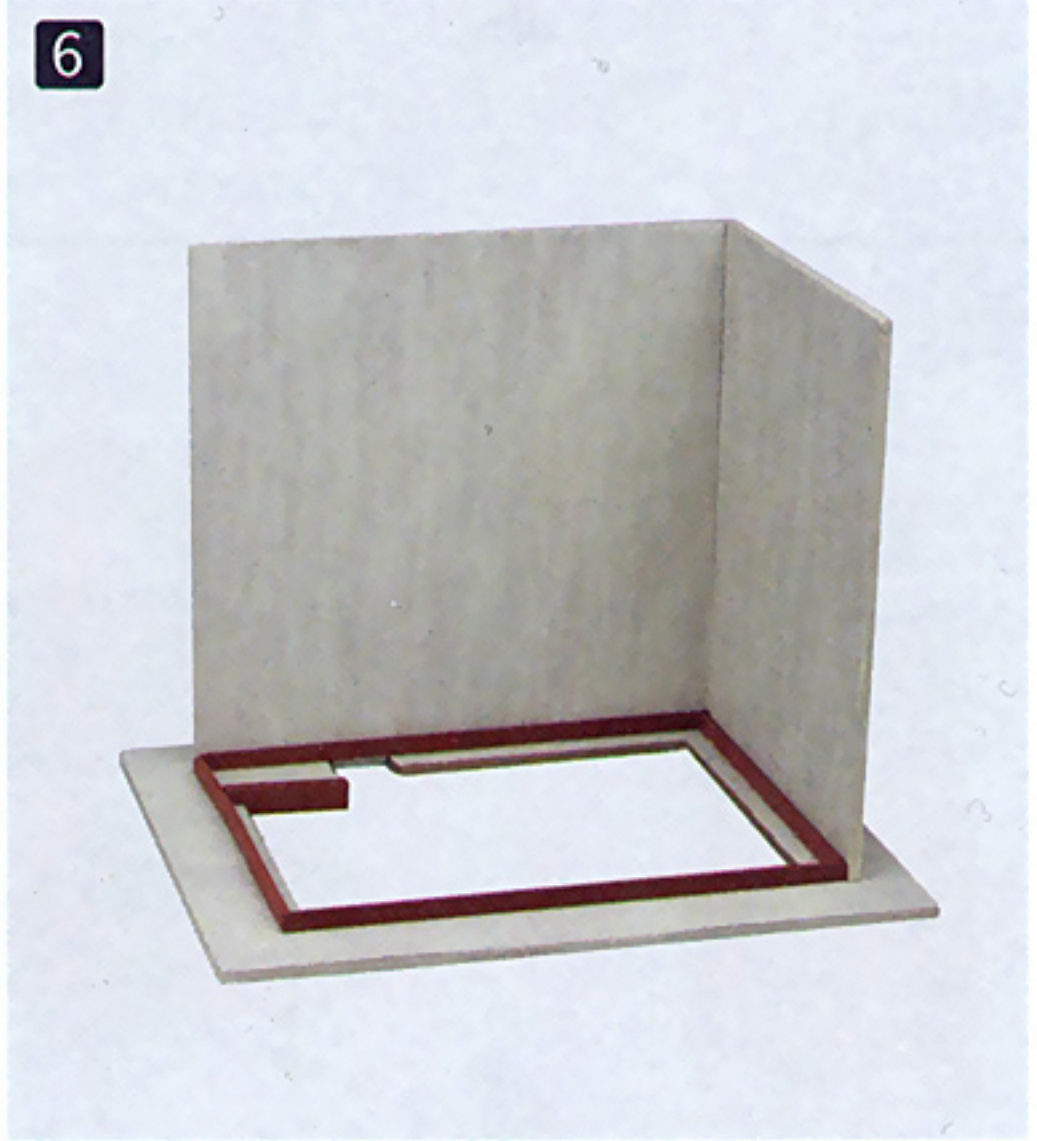
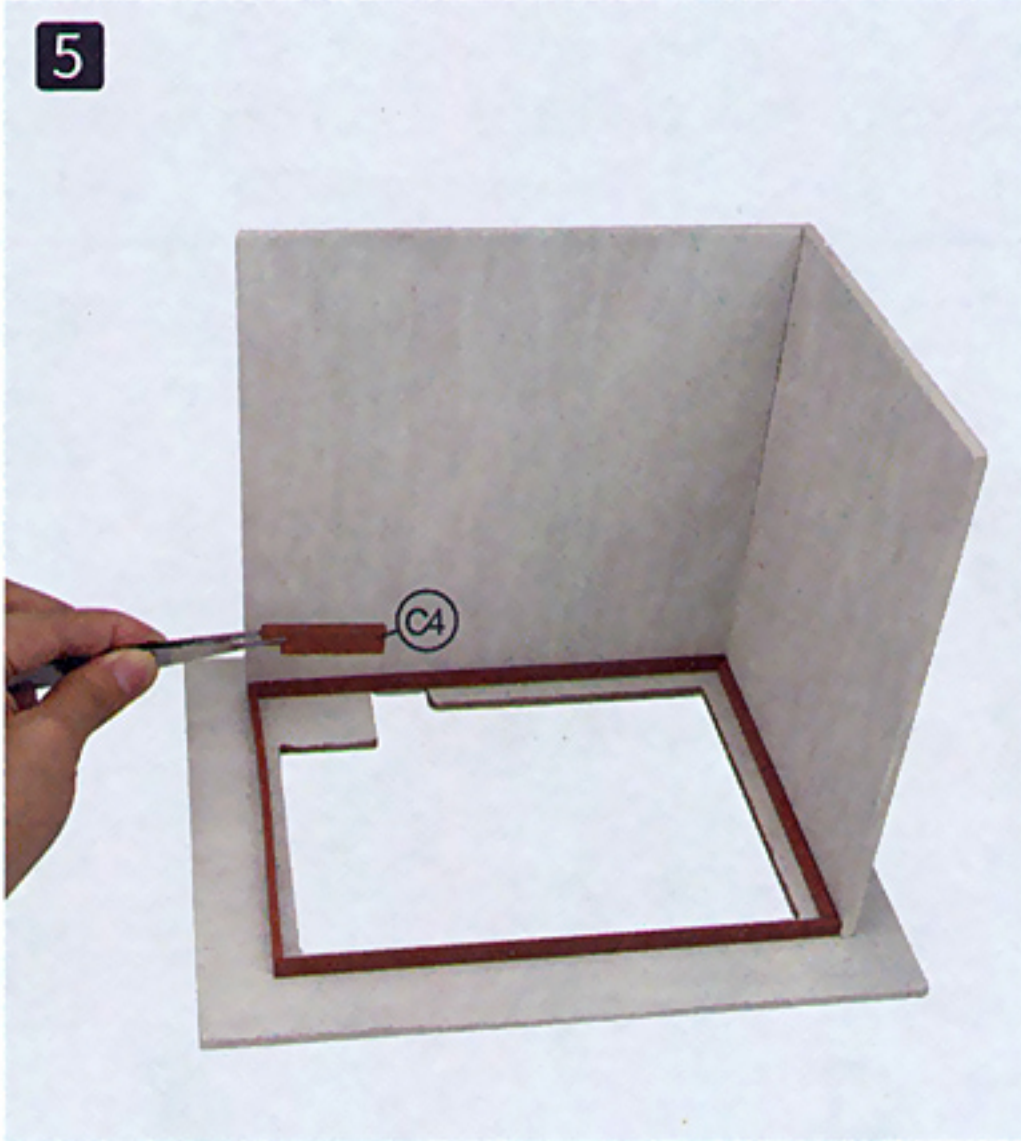
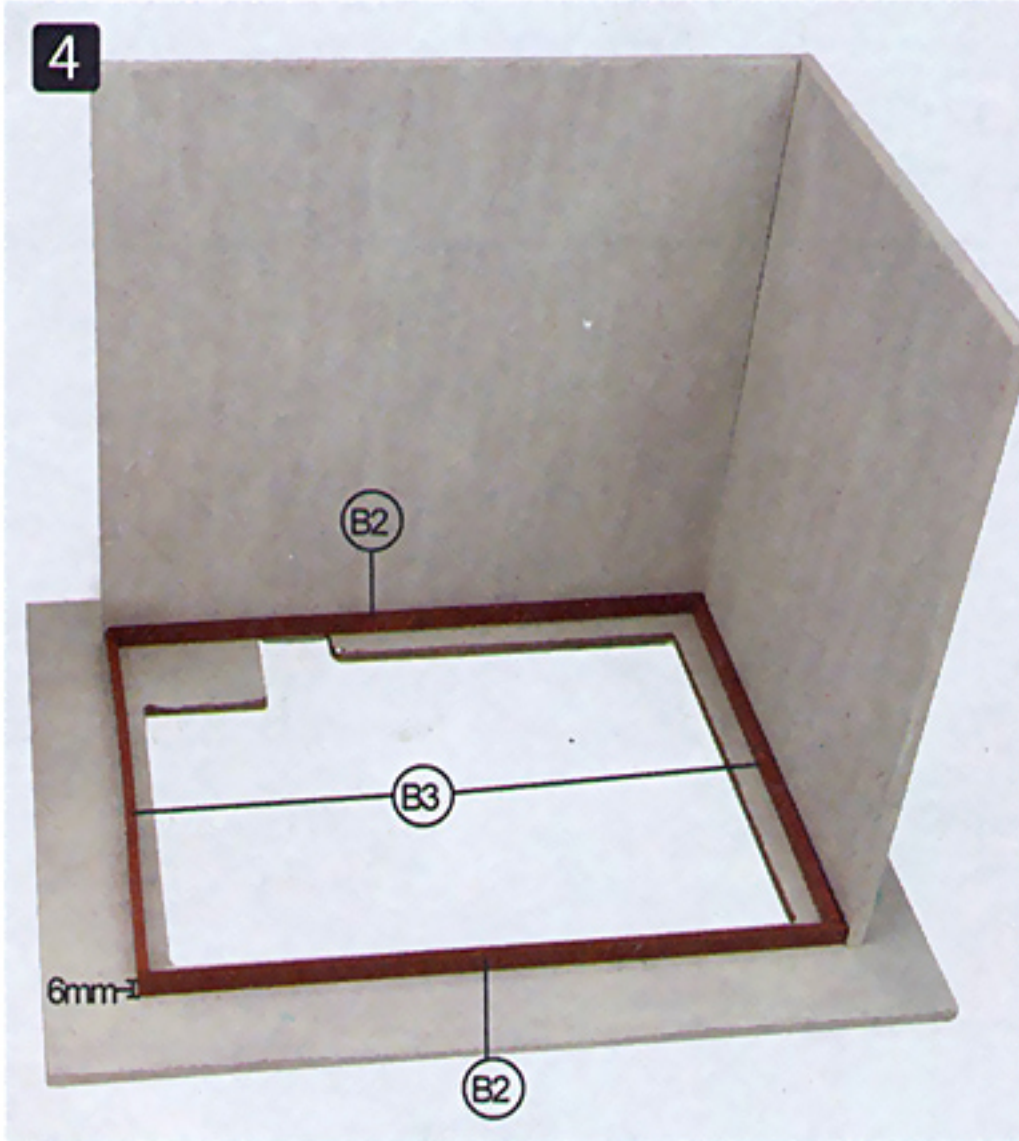
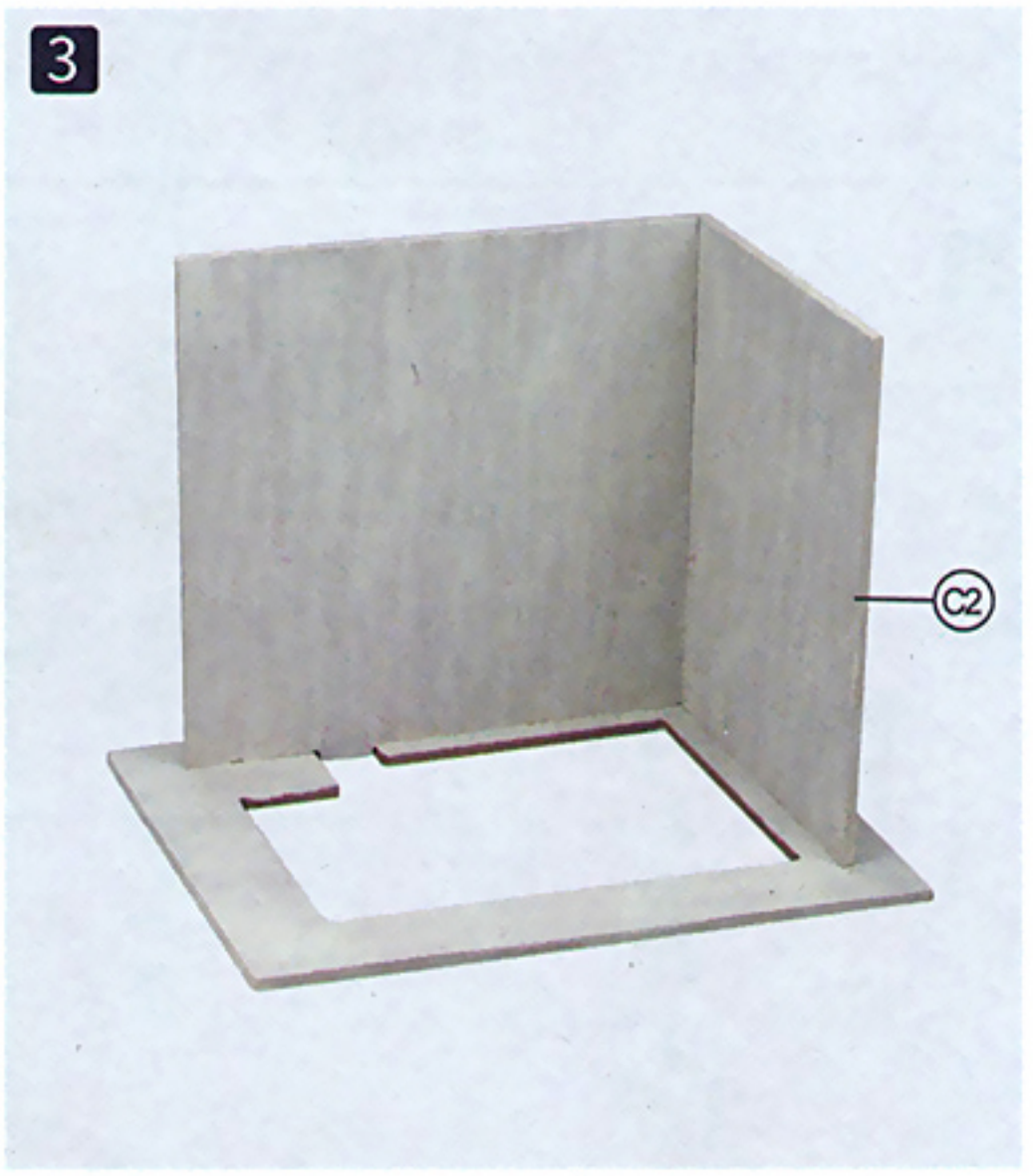
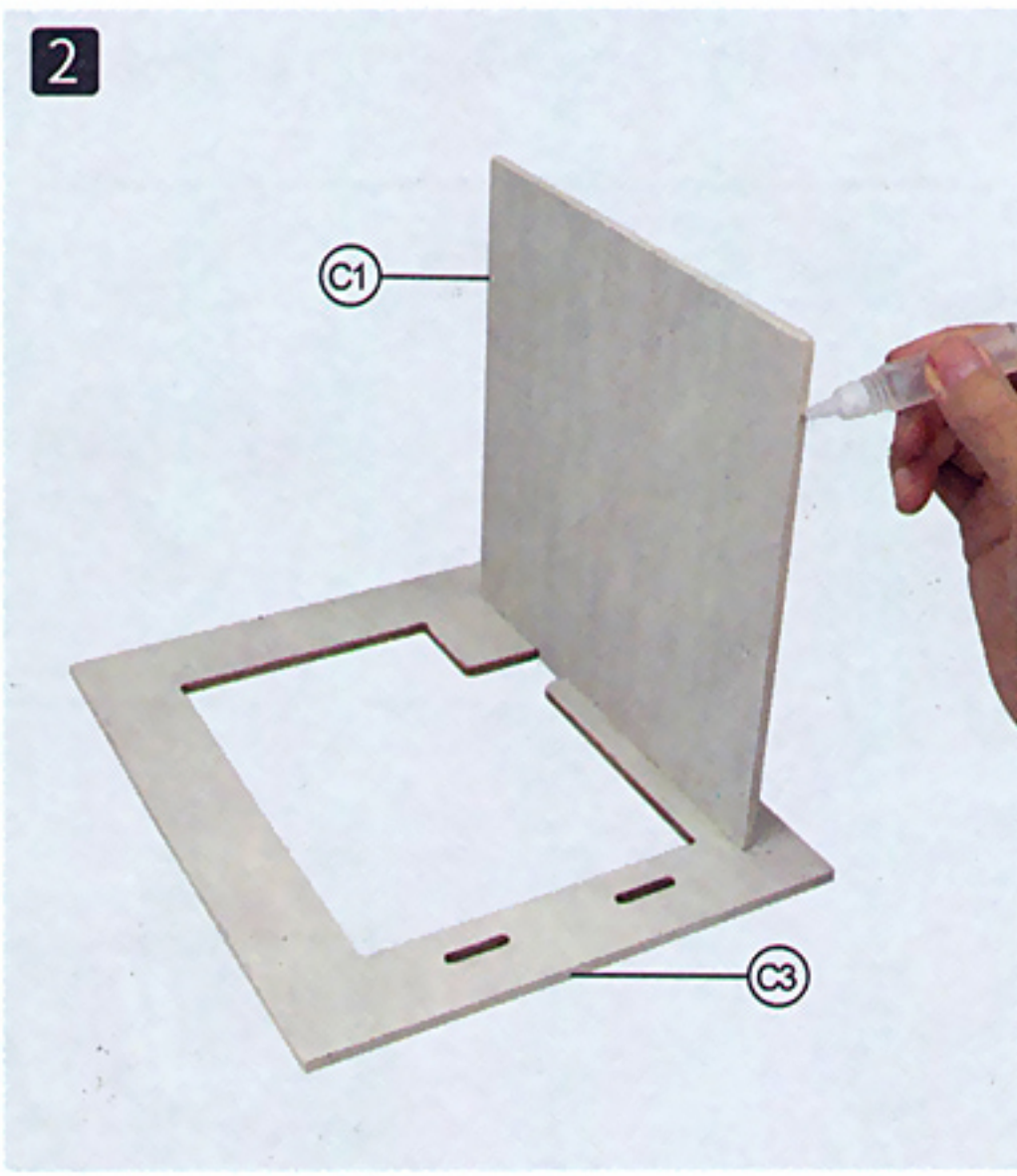
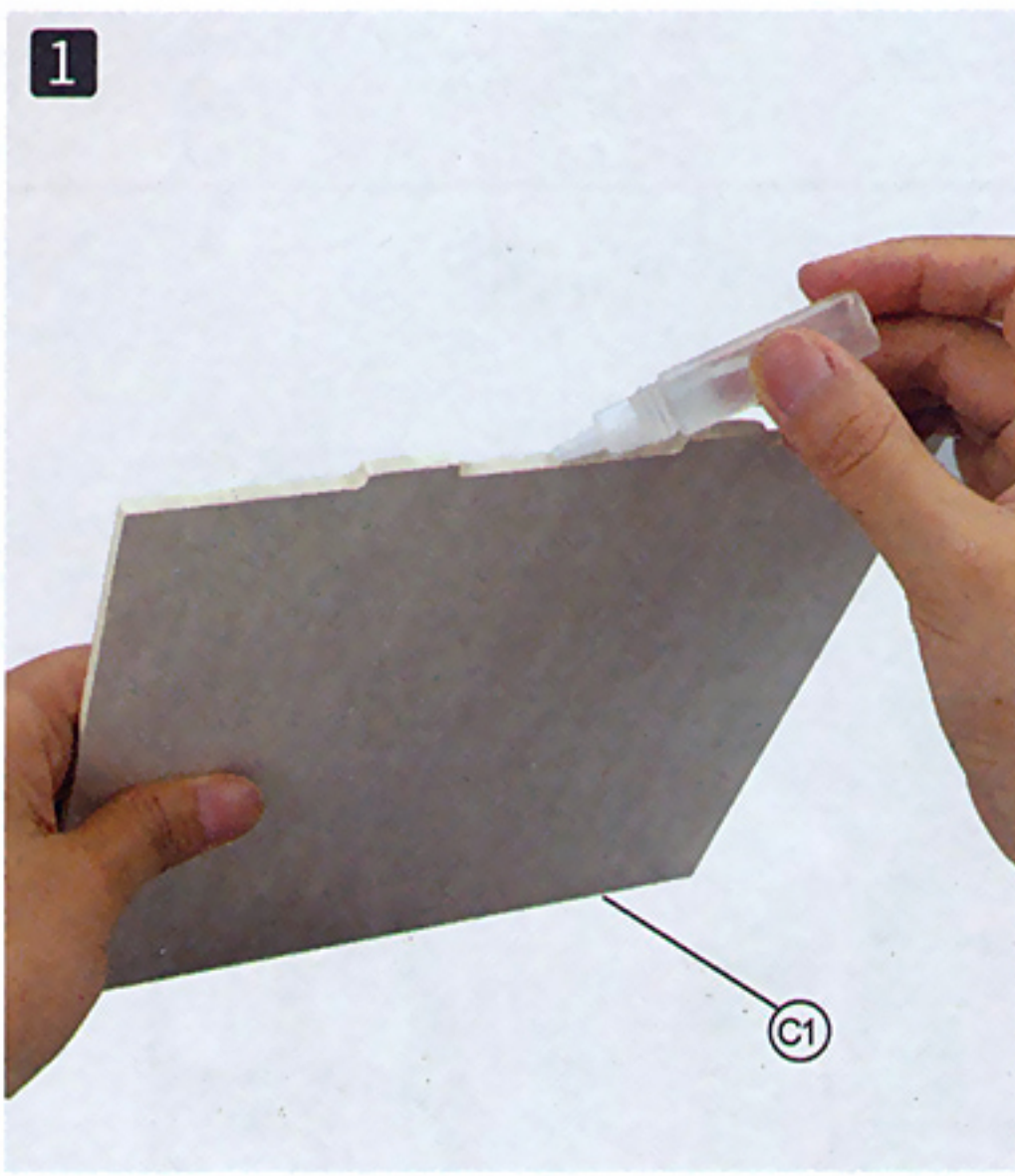

2-A2



# Roof

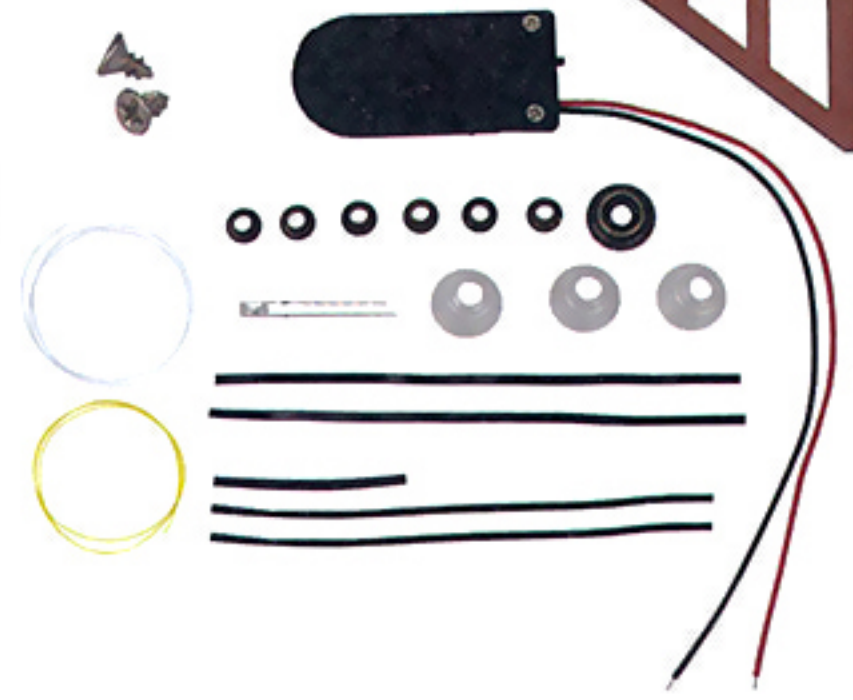

## List

- ① Wooden pieces. 2pcs
- ② Screw 2pcs (Bag No.5)
- ③ Battery box 1pcs (Bag No.5)
- ④ Air hole 6pcs (Bag No.5)
- ⑤ Metal buckle 1pcs (Bag No.5)
- ⑥ LED lamp 4pcs (Bag No.5)
- ⑦ White electric wire 2pcs (Bag No.5)
- ⑧ Yellow electric wire 2pcs (Bag No.5)
- ⑨ Lampshade 3pcs (Bag No.5)
- ⑩ Black metal wire 2pcs (Bag No.4)
- ⑪ Thick Shrinkable tube 1pcs (Bag No.4)
- ⑫ Thin Shrinkable tube 2pcs (Bag No.4)

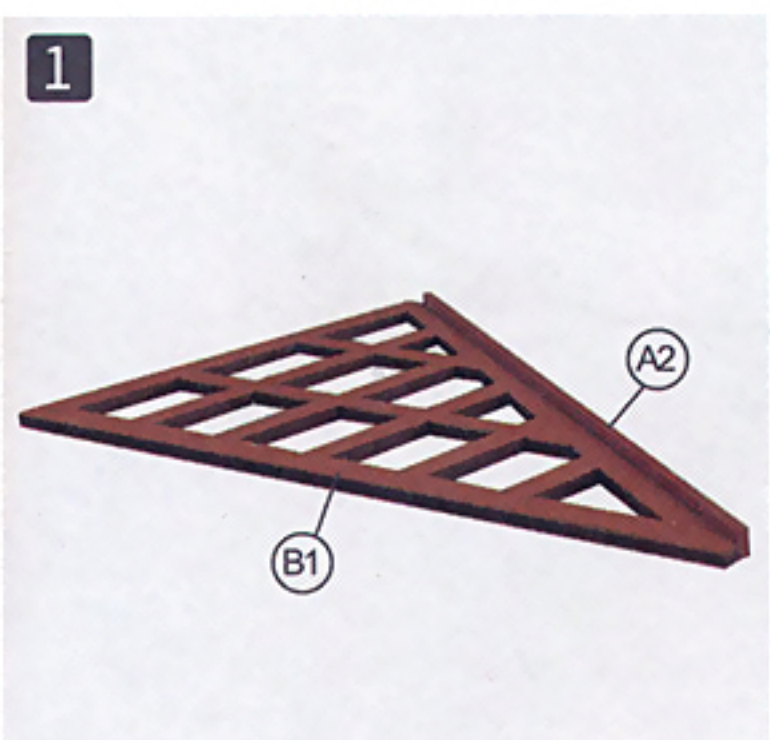

Paste as shown.

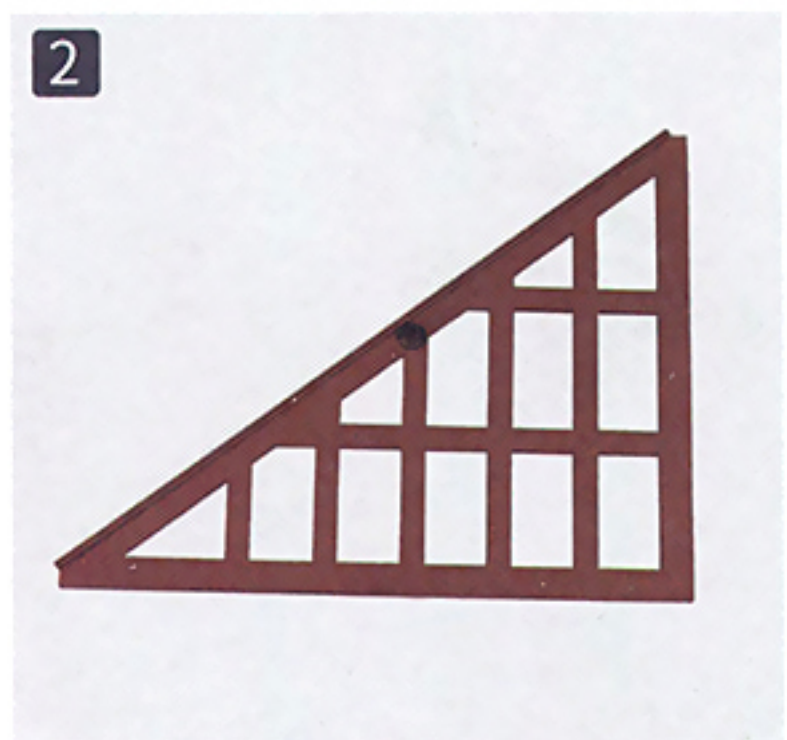

Paste the air hole as shown.

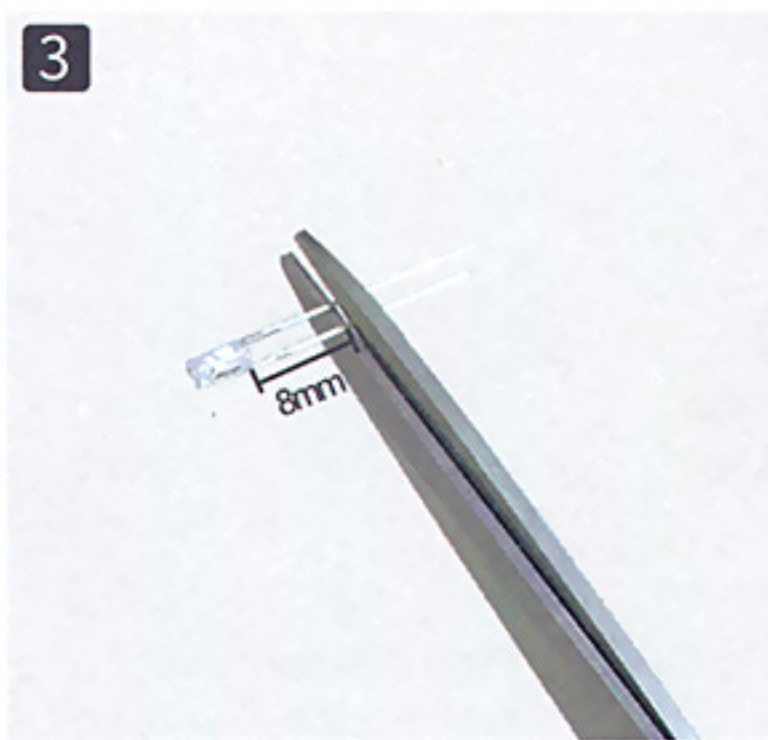

Cut the Led lamp as shown.

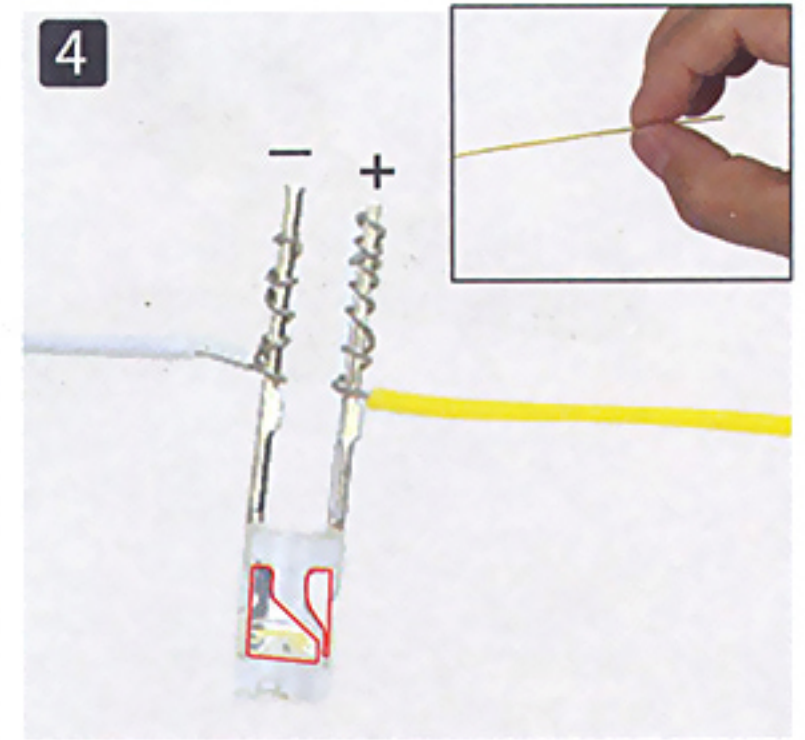

Peel off 12mm length rubber from white and yellow wire. Connect to the lamp as shown. (+:Positive -:Negative)



Test.

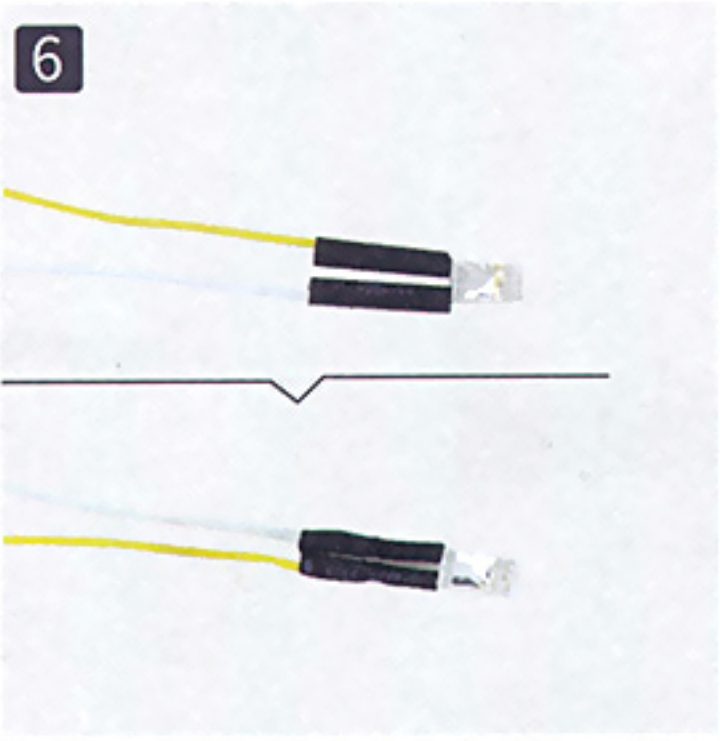

Cut the shrinkable tube into 10mm. 2pcs in total. Go through the tube with wires. Heat shrink the tube with flame of lighter.

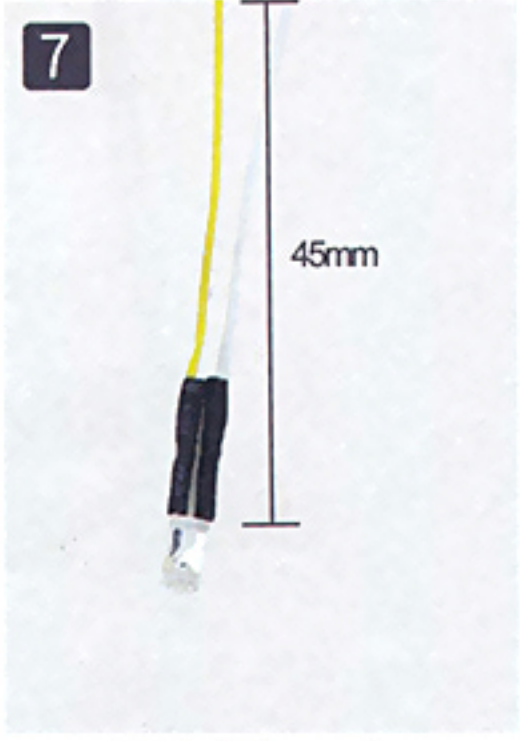

Cut off the wire into 45mm.



Bend as shown.



Go through the hole according to the arrow.

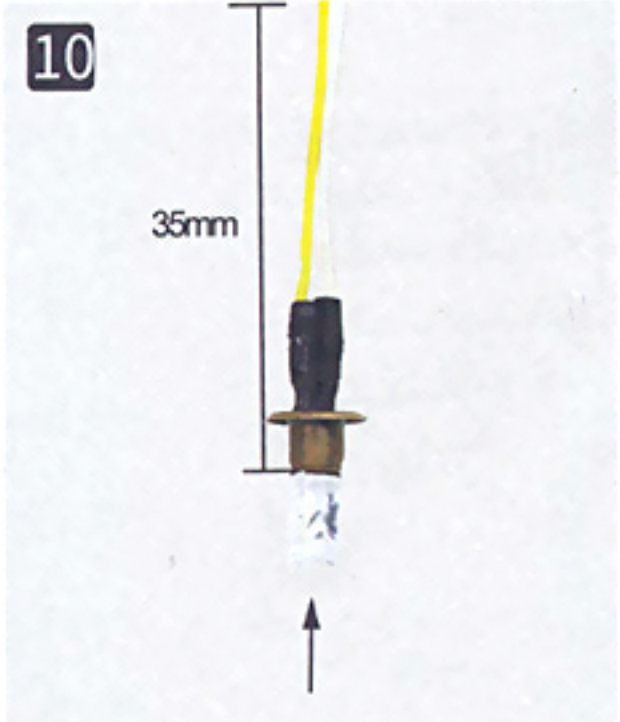

Do it in the same way as step 3~6. Cut off into 35mm.

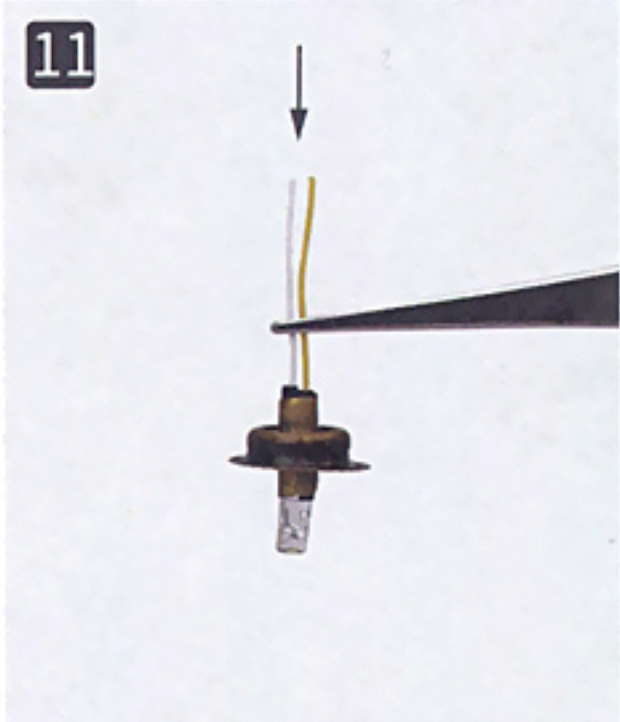

Go through the hole and metal rope buckle

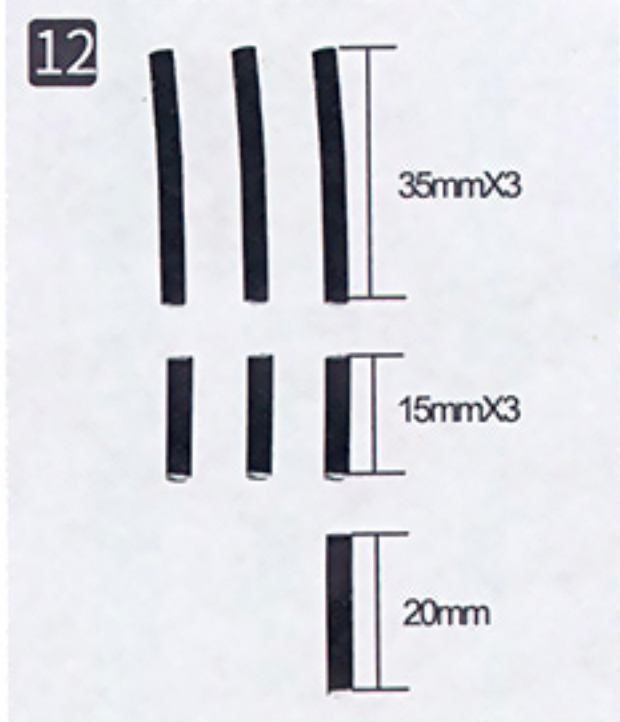

Cut as shown.



Bend as shown



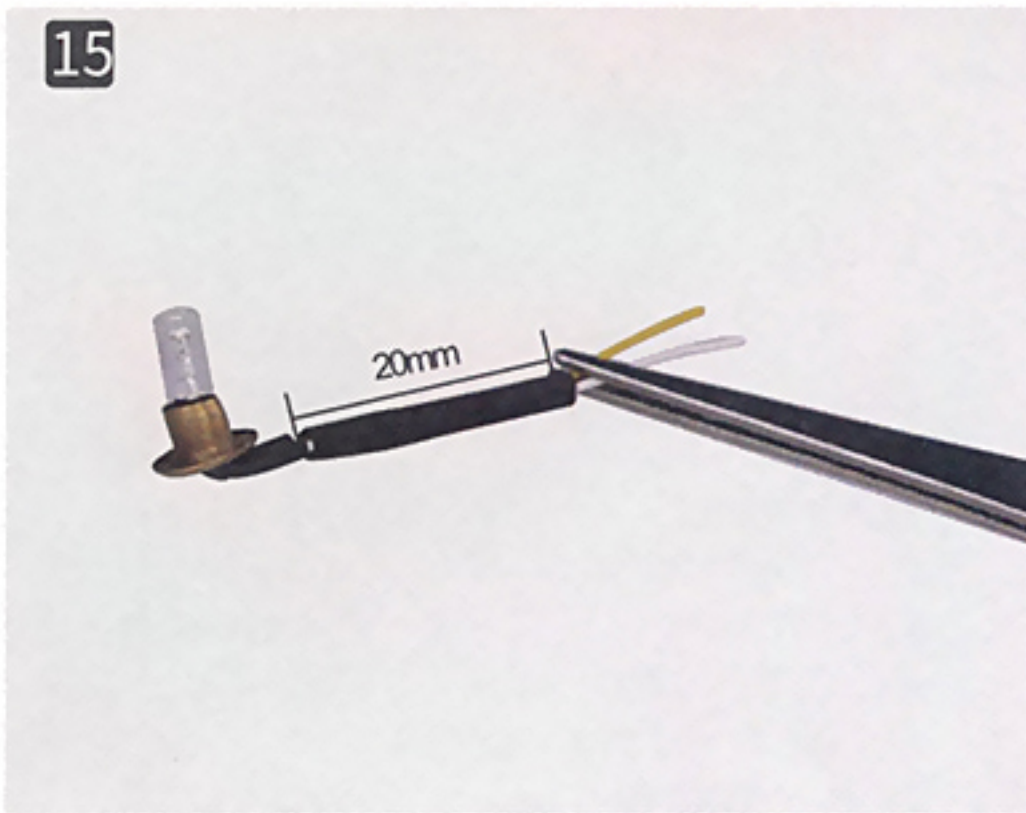

Go through the thin tube and heat shrink with flame.

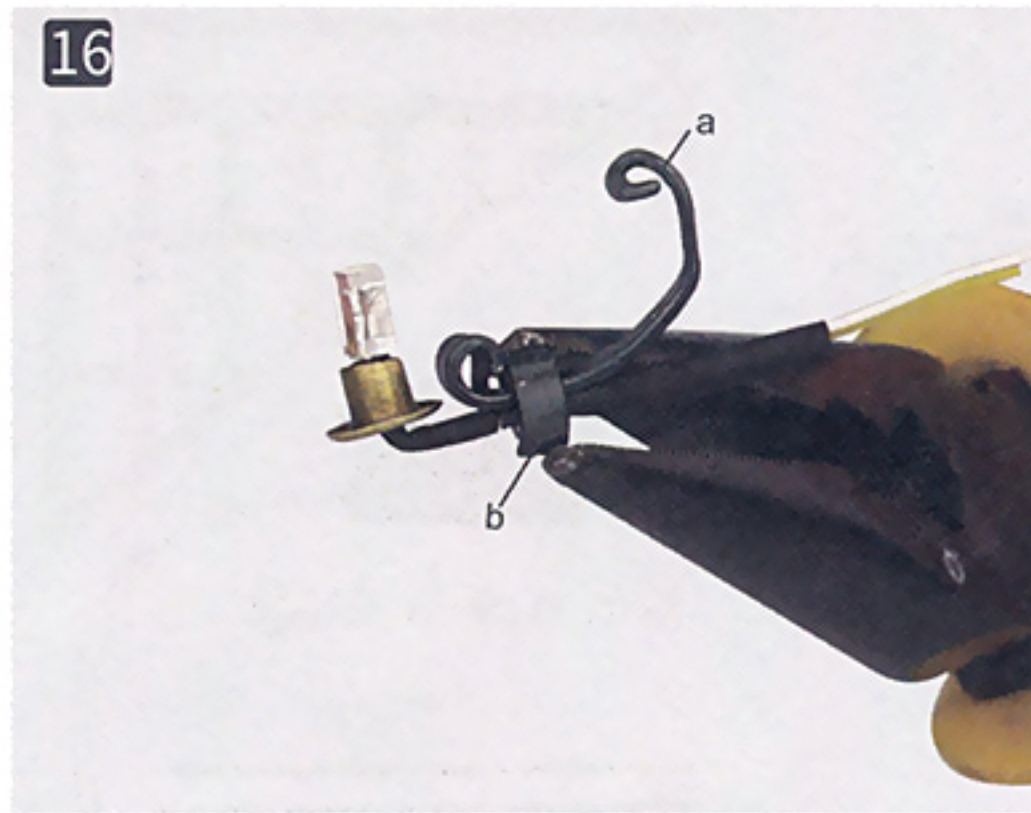

Paste as shown.

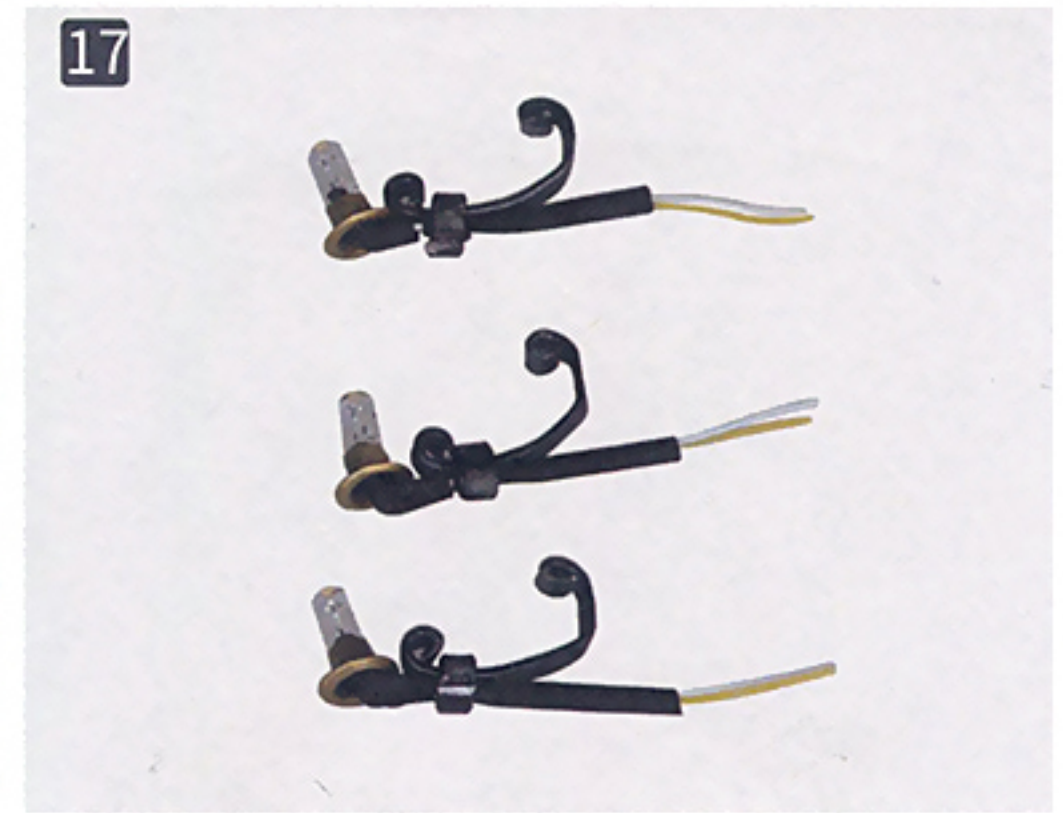

Complete 3pcs in total.



Combine step 17 with step 11. Twine the same color wire together.(Test the lamp)

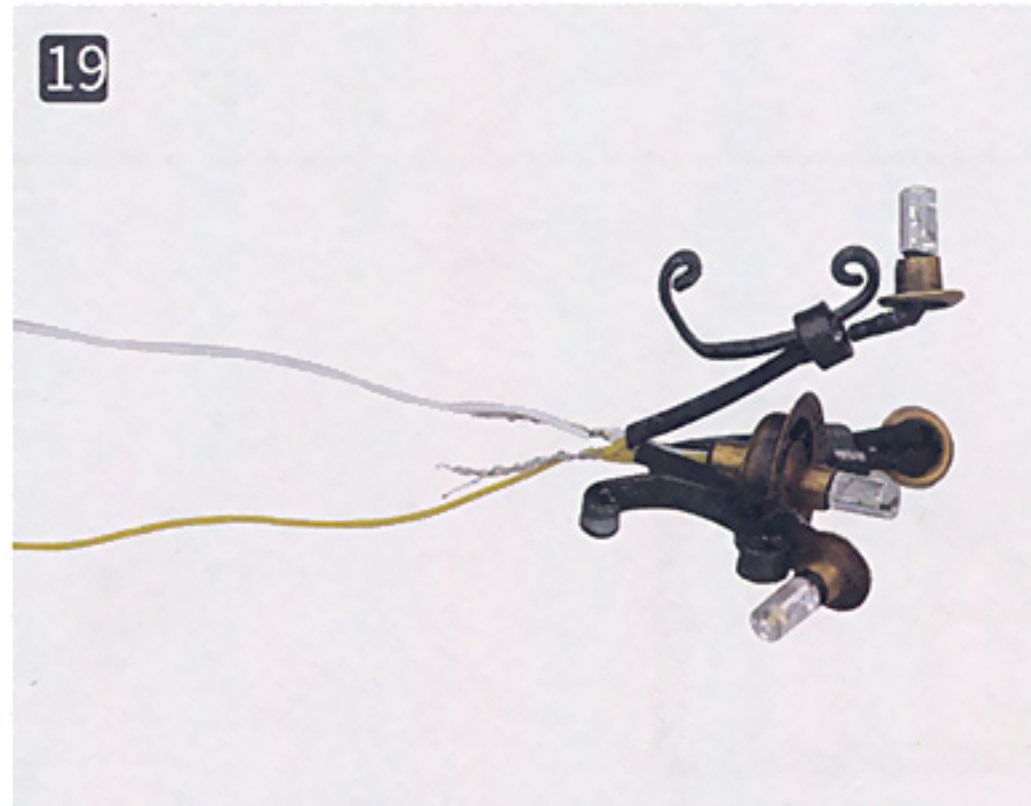

Peel off the rubber of another yellow wire and white wire. Twine the same color wire together.(Test the lamp)

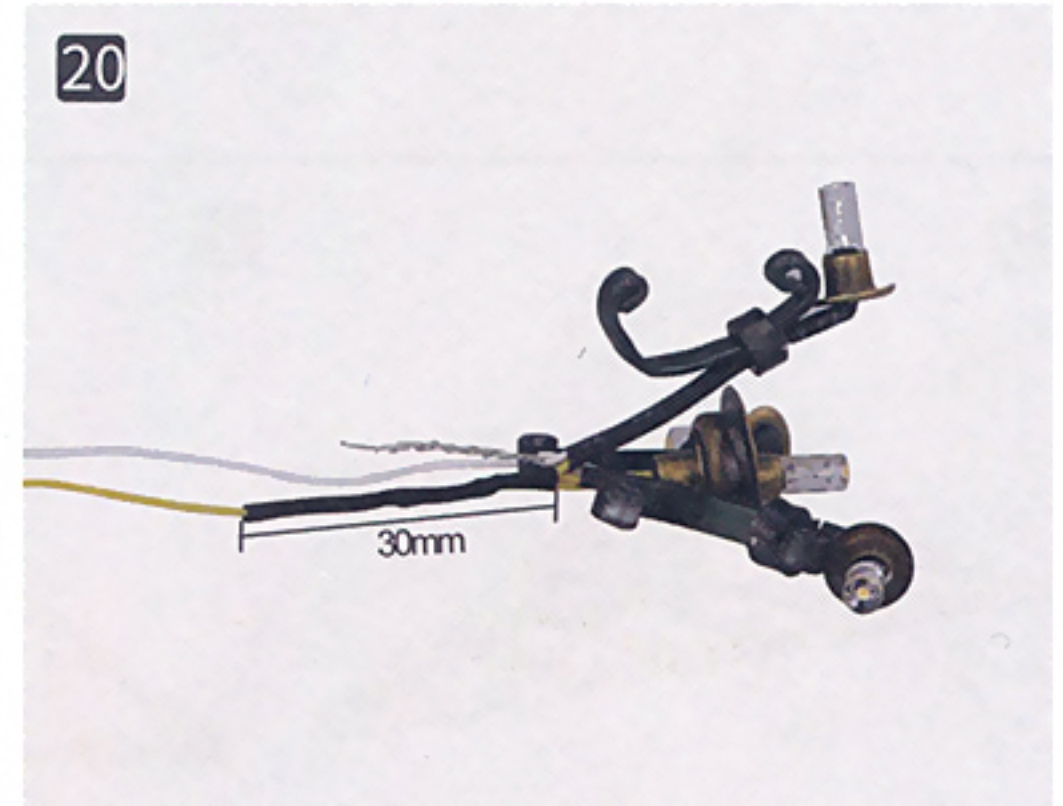

Go through the thin tube(30mm) and heat shrink with flame.(Ensure the yellow wire is covered well )

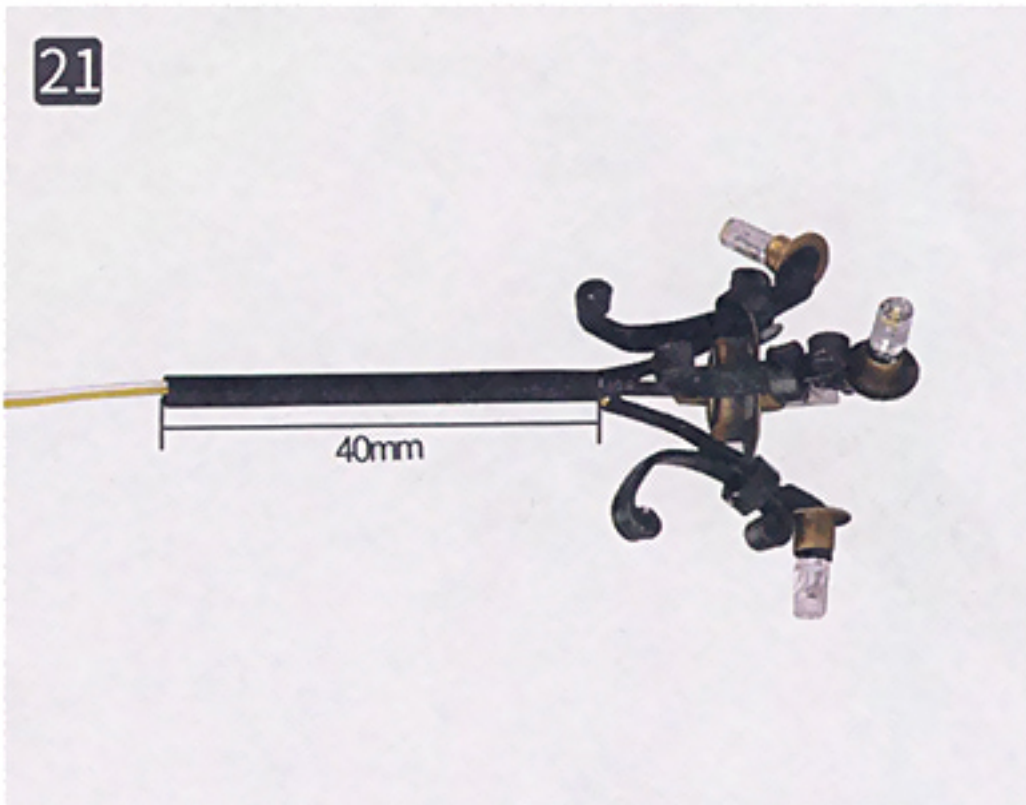

Go through the thick shrinkable tube (40mm)



Clamp c and a.

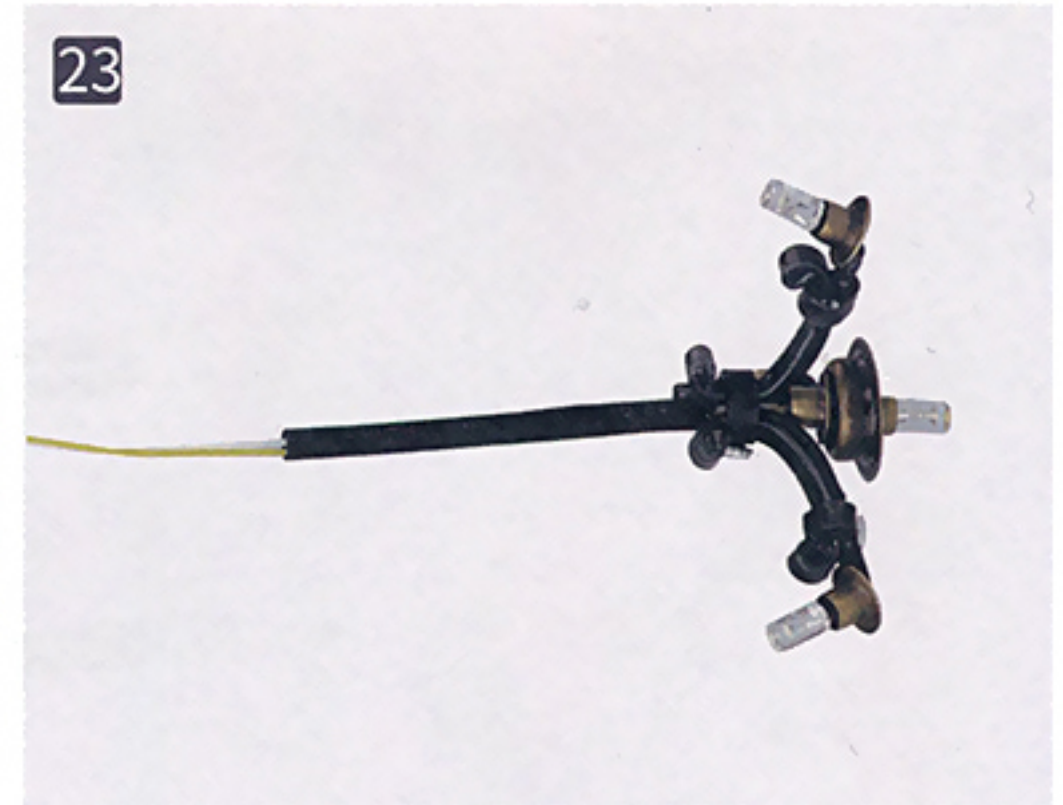

Adjust to suitable position.

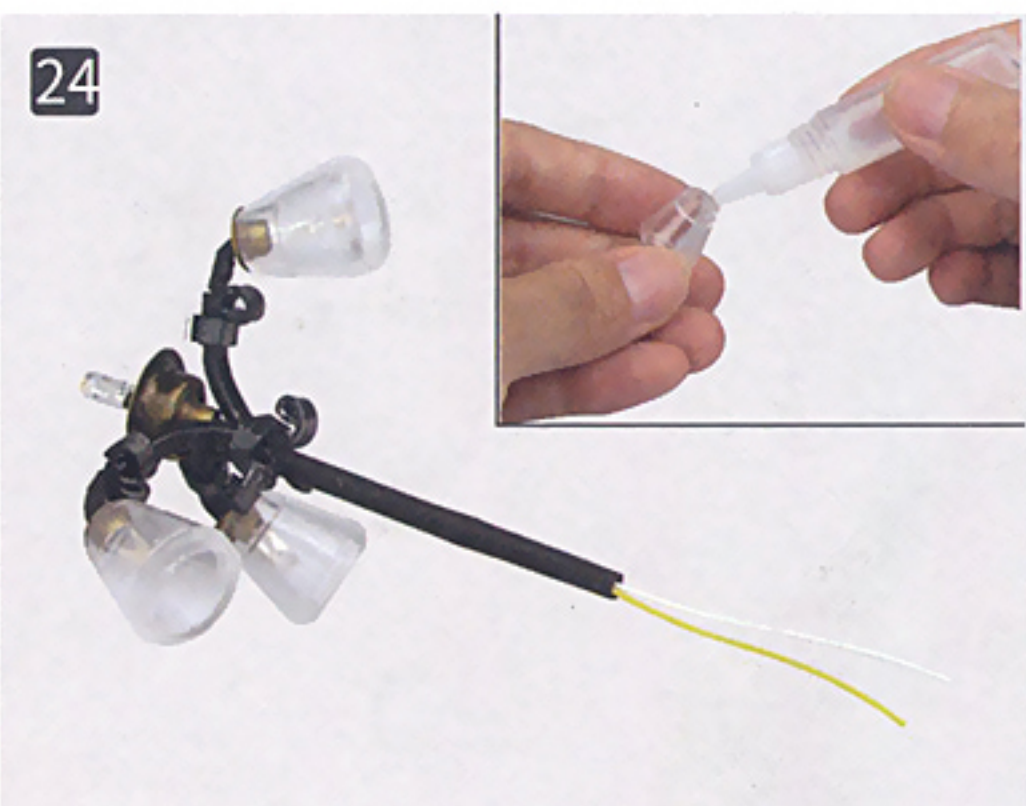

Glue the lampshade and fix as shown.

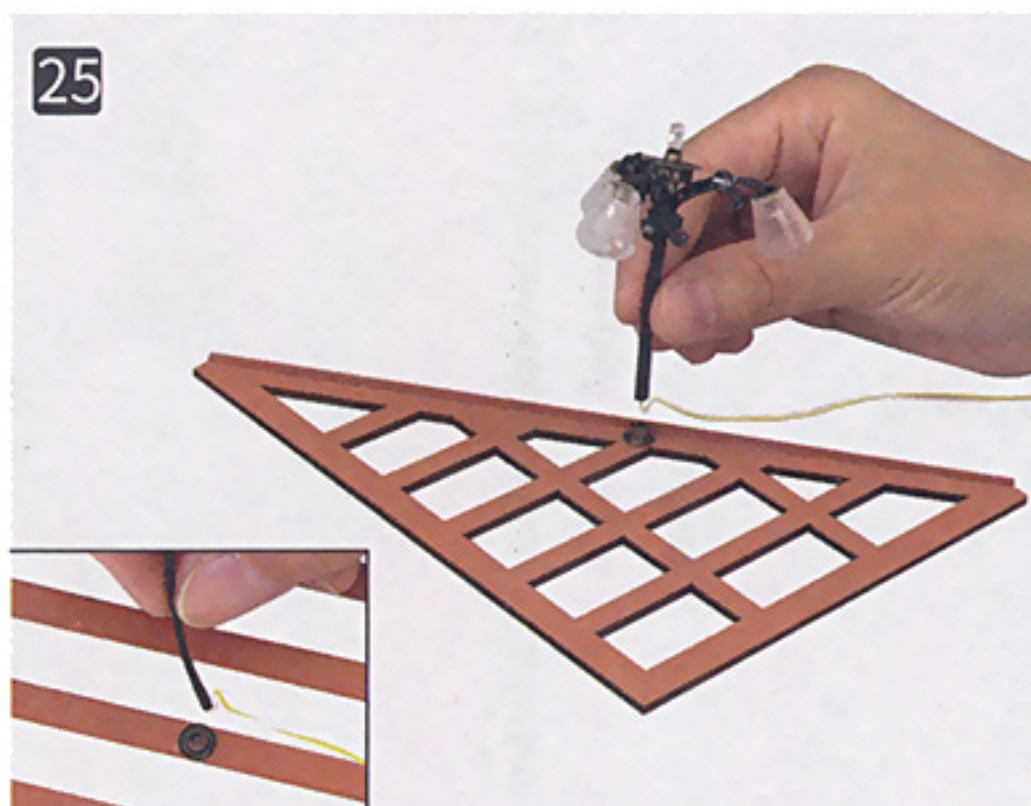

Install the light. ( Notice the wire)

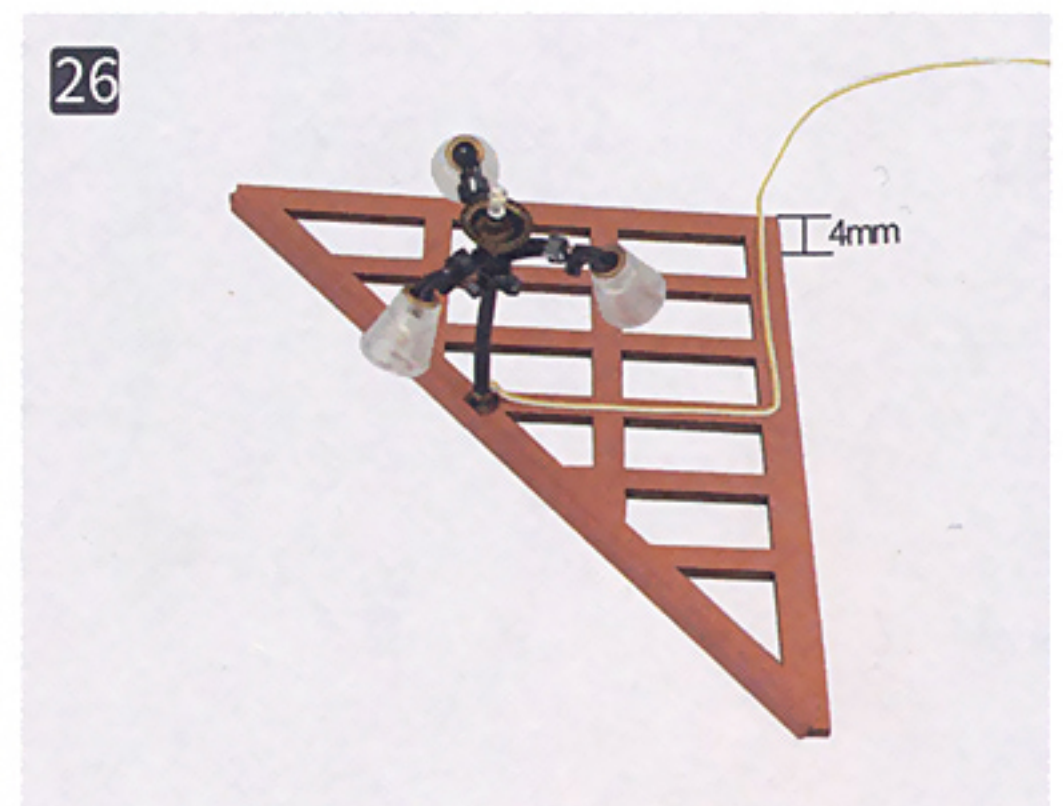

Fix the wire with glue.

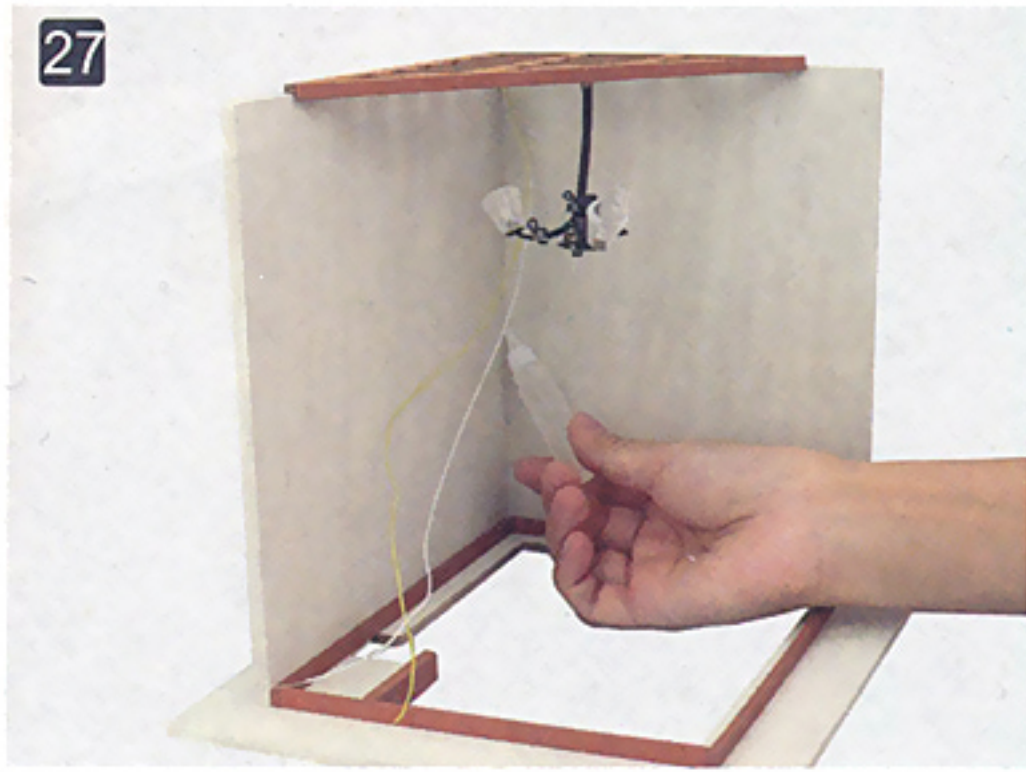

27 Fix the wire into the corner with glue. Do not glue (B1) on wall.

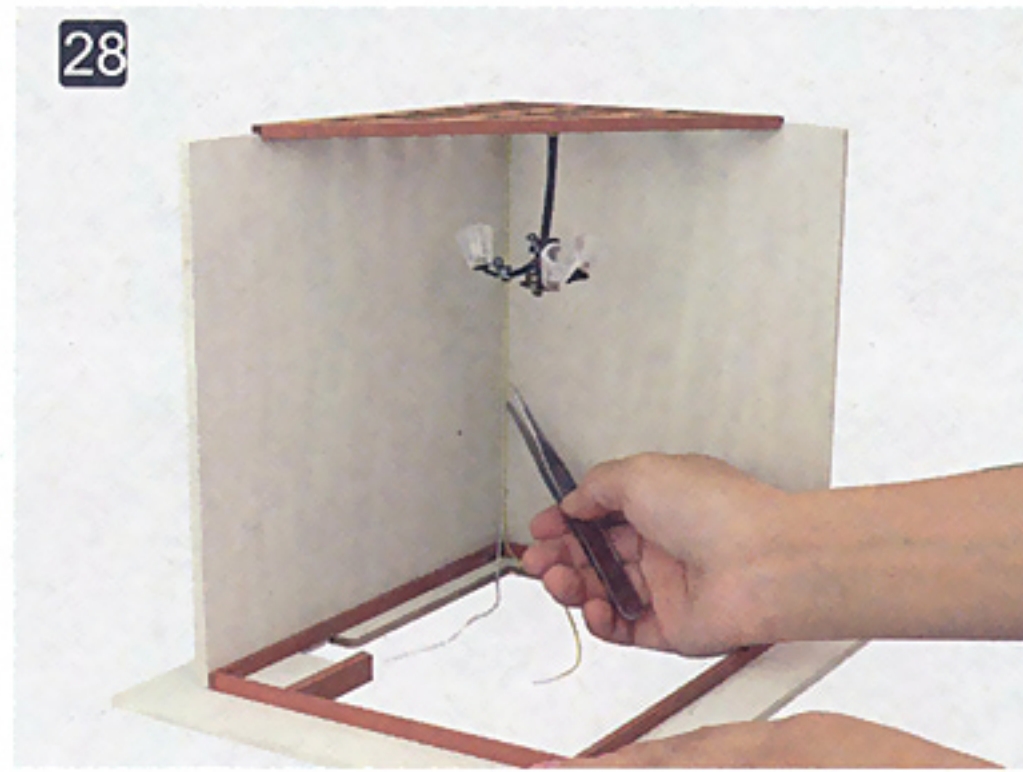

28 Press the wire with tweezers.

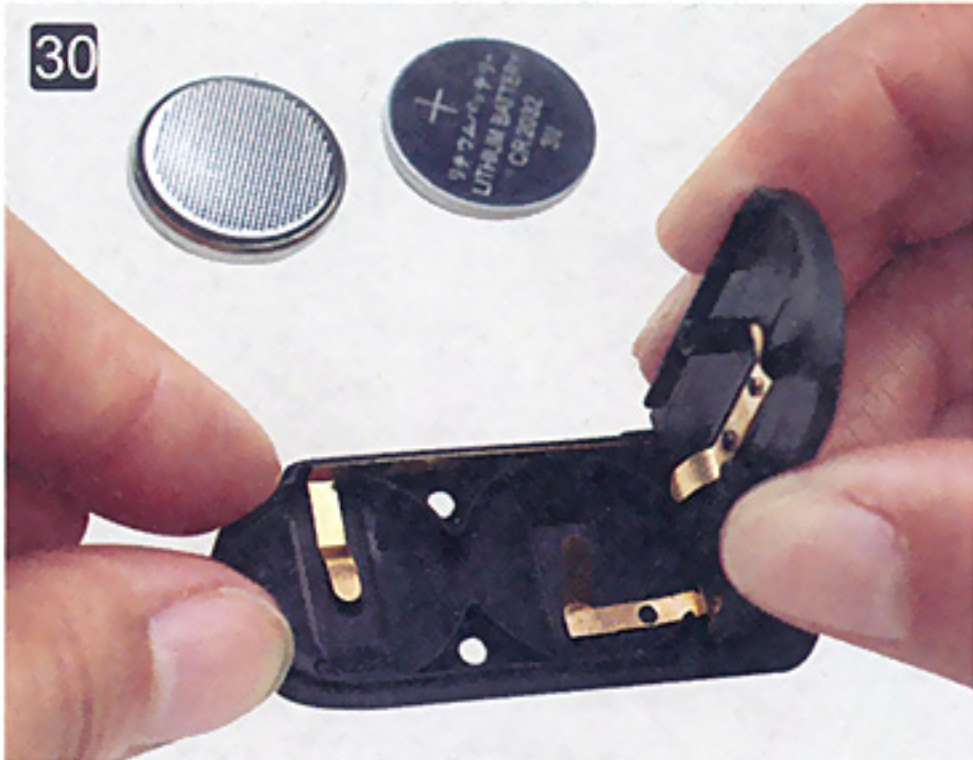
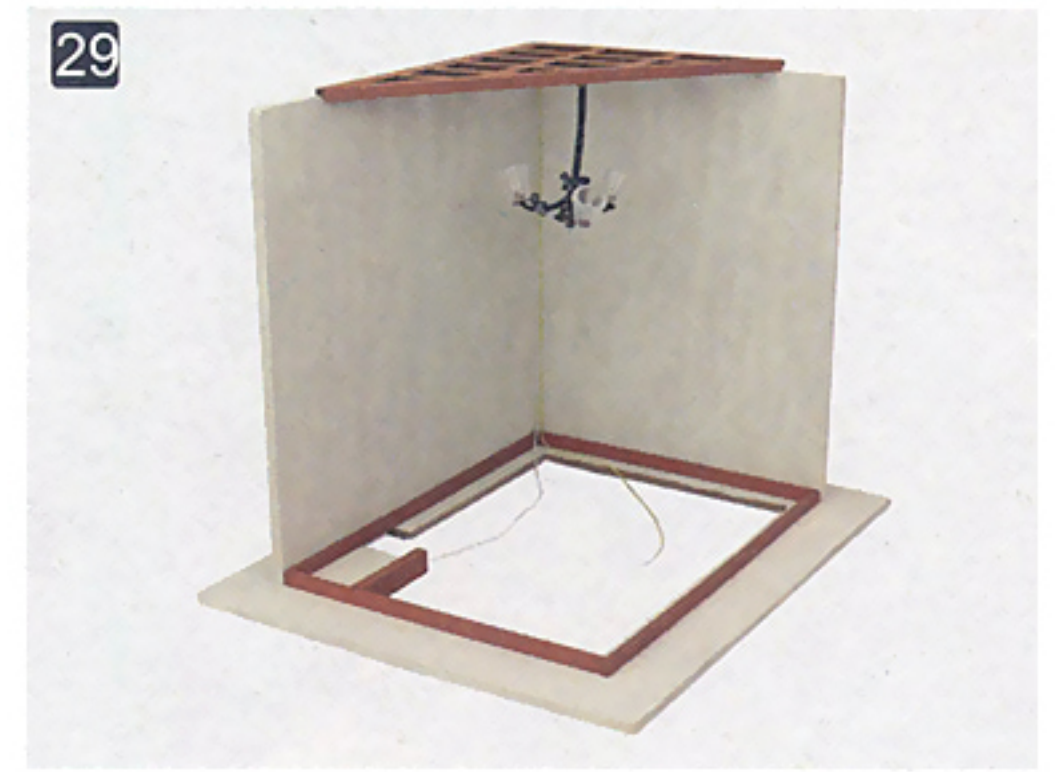

30 Put battery in the box. (Pay attention to the Positive & Negative)

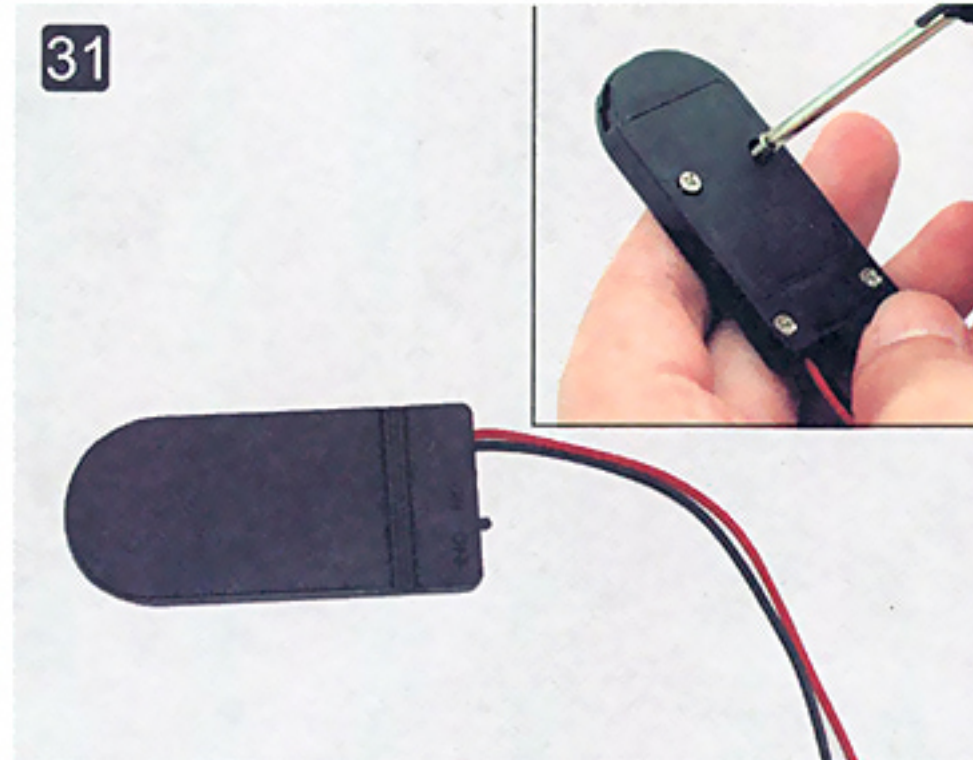

31 Install the screw.

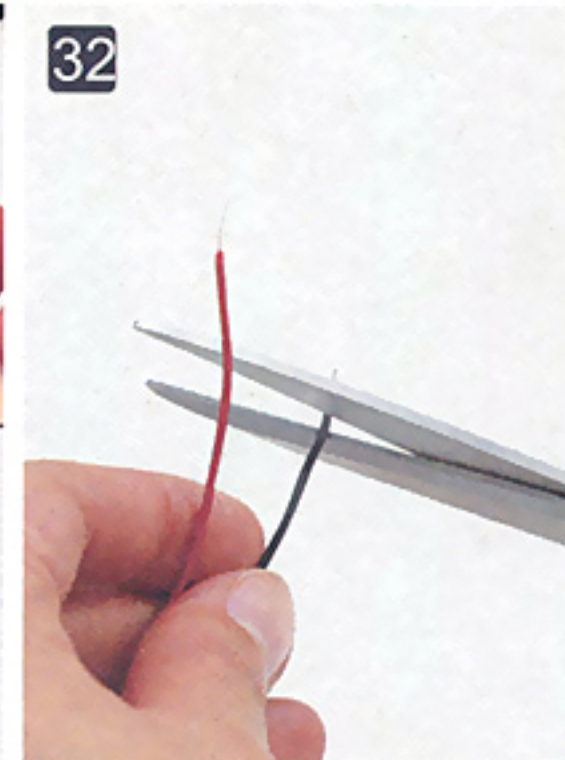

32 Peel off the rubber (12mm)



33 Cut off 2pcs shrinkable tube (20mm) and cover the wire.

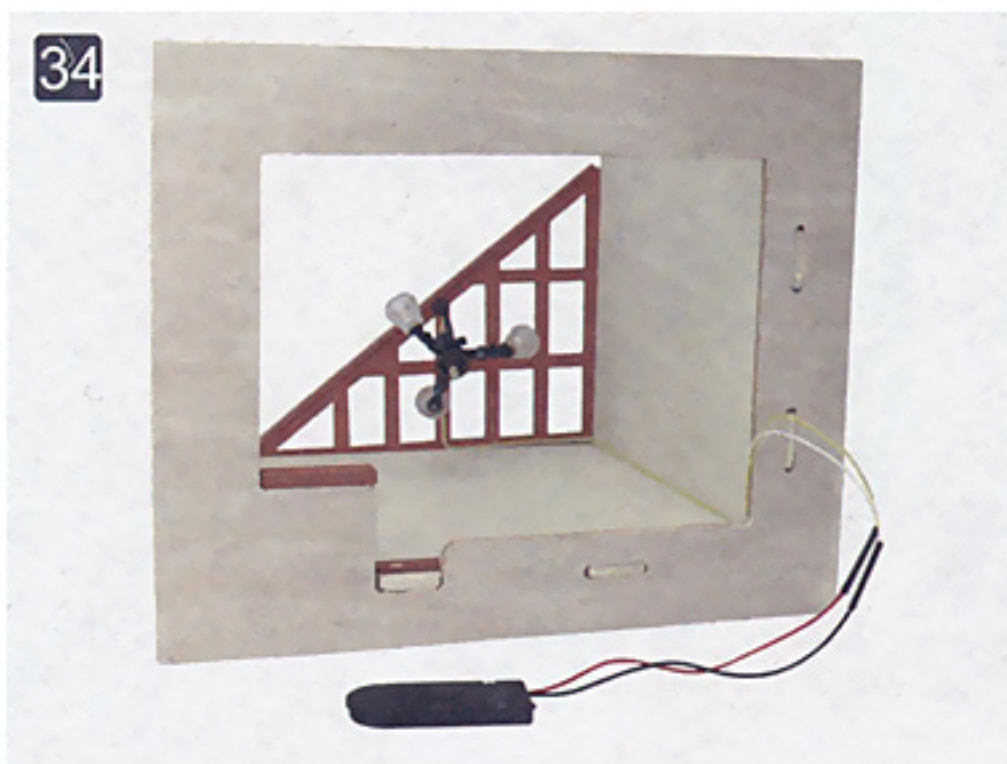

34 Connect the wire of lamp and battery box. Attention: Yellow connect with Red. White connect with black.

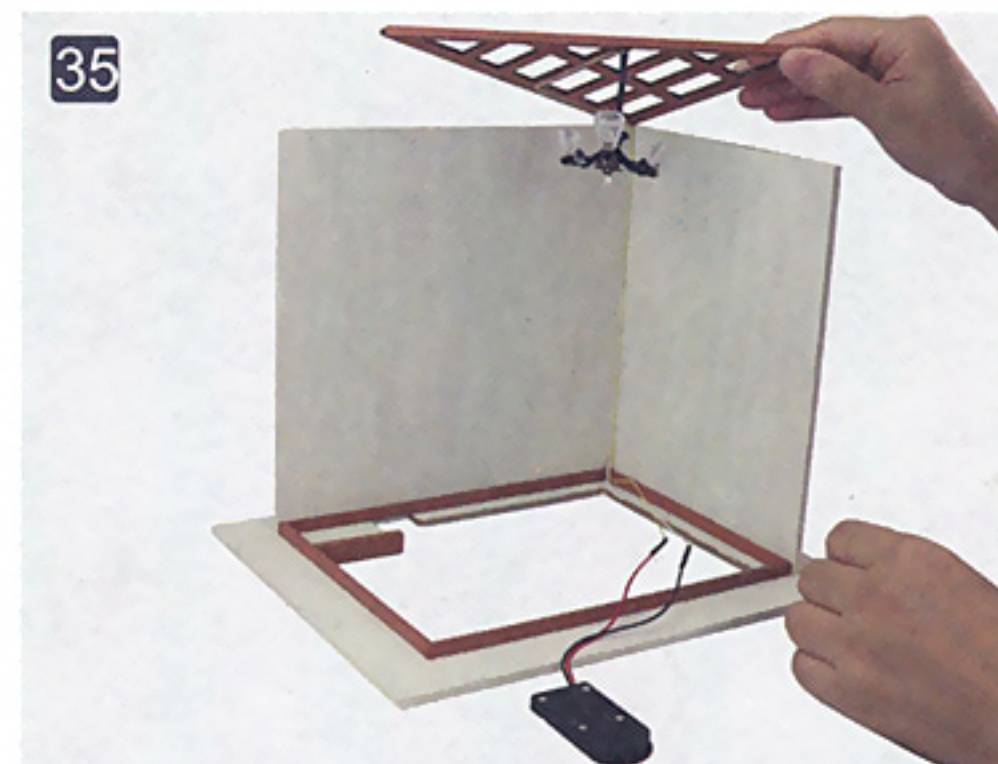

35 Cover with the roof. No need to glue.



36 Put the battery in the correct position. Switch downward. Attention: Do not glue in case of change battery.

## Floor

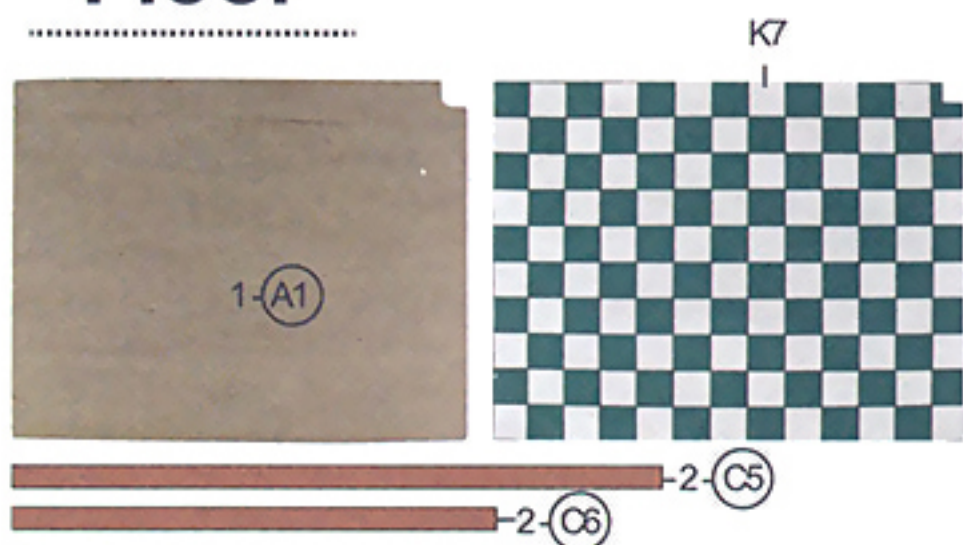

### List

- 1 Wooden pieces. 3pcs
- 2 Paper K7

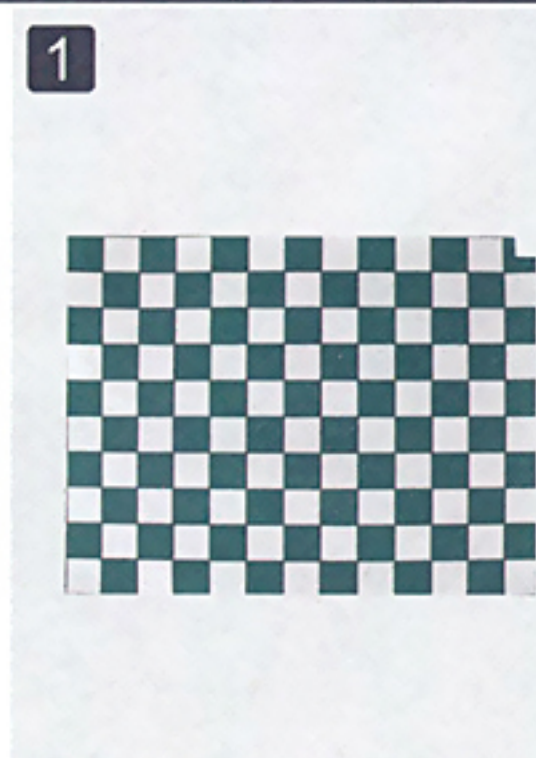

1 Paste K7 onto (A1)

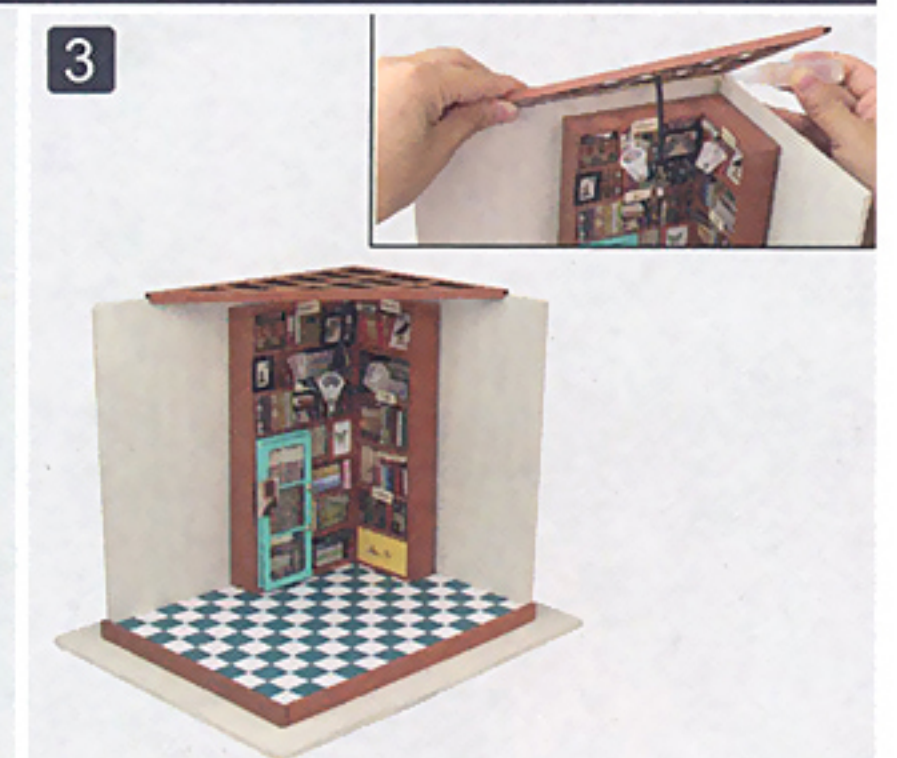
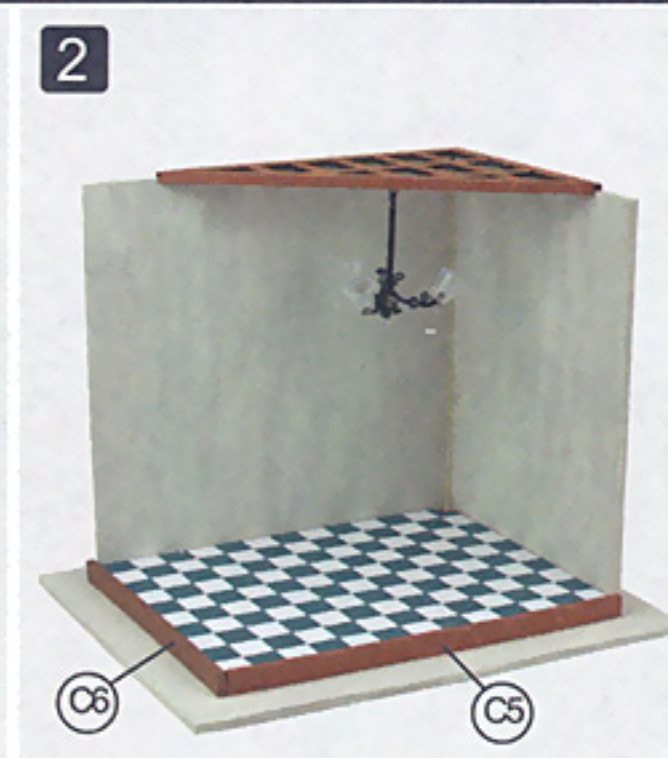

3 Move the furniture into house. Paste it on the wall. Fix the roof with glue.

# Assemble process

