

IMPORTANT! KEEP THIS USER'S MANUAL IN A SAFE PLACE FOR FUTURE REFERENCE!

INSTRUCTION MANUAL FOR USE OF CAR SEAT "JETT"

**CAR SEAT
JETT**

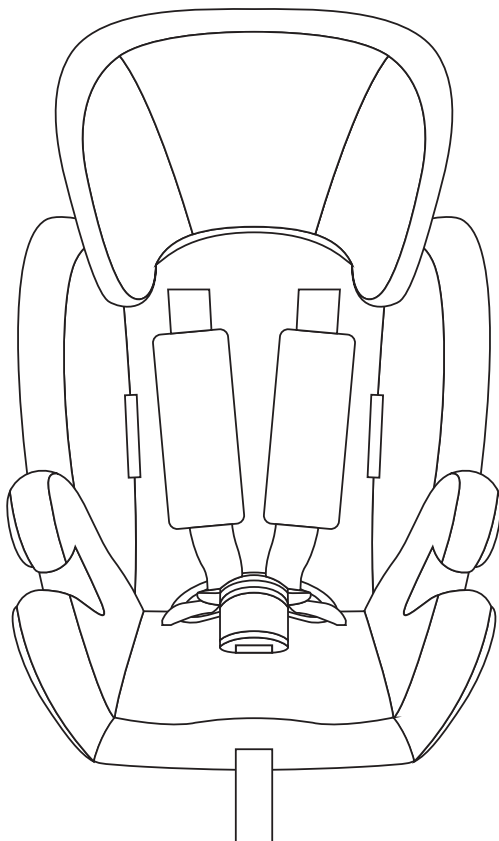

This child restraint under brand **chipolino** is manufactured in compliance with the requirements of Regulation 44 of the United Nations Economic Commission for Europe concerning the safe transportation of children, the provisions of the product safety directive 2001/95/EU of the European Parliament and The Council and Directive 91/671/EEC "Compulsory use of seat belts and child restraints systems for child occupants of power driven vehicles" of the European Parliament and The Council, as well as the normative acts of the national legislation.

NOTICE

GROUP I (9-18 kg), GROUP II (15-25kg) и GROUP III (22-36kg)

1. This is a "UNIVERSAL" CHILD RESTRAINT SYSTEM. It is approved (No E13 44R-045147) according to Regulation No 44, 04 series of amendments, for general use in vehicles and it will fit most, but not all car seats.
2. A correct fit is likely if the vehicle manufacturer has declared in the vehicle handbook that the vehicle is capable of accepting a "Universal" child restraint for this age of groups.
3. This child restraint has been classified as "Universal" under more stringent conditions than those which applied to earlier designs, which do not carry this notice.
4. If in doubt, consult either the child restraint manufacturer or the retailer.



NO SYSTEM CAN PROVIDE ABSOLUTE PROTECTION OF INJURY IN CASE OF A CRASH OR ROAD ACCIDENT! DRIVE WITH ATTENTION, ESPECIALLY WHEN THERE IS A CHILD IN THE VEHICLE!

IN ORDER TO ENSURE THE SAFETY OF YOUR CHILD, FOLLOW EXACTLY THE INSTRUCTIONS AND SAFETY RECOMMENDATIONS IN THIS MANUAL

MISUSE OF THE CAR SEAT WILL CONTRIBUTE TO REDUCING ITS SECURITY AND SAFETY FEATURES! FAILURE OF THE GUIDELINES OF THIS INSTRUCTION INCREASES THE RISK OF SERIOUS INJURY OR DEATH!

PLACE OF THE CAR SEAT IN THE VEHICLE

THE CHILD RESTRAINT IS ONLY SUITABLE FOR USE IN VEHICLES, EQUIPPED WITH **APPROVED LAP/3-POINT/STATIC/WITH RETRACTOR SAFETY BELTS** IN COMPLIANCE WITH ECE R16.

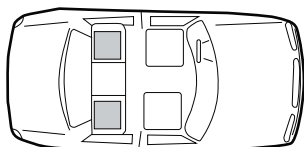
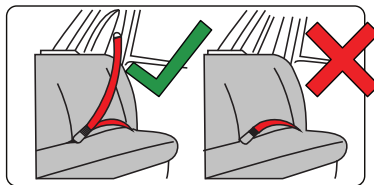

- Always install the child restraint system in "FORWARD FACING" position and never install or use it in "REARWARD" position!
- Place the car seat only on forward facing seats, and not on rearward or side facing!
- Do not install the car seat on front passenger seat !

- **CAUTION!** NEVER LEAVE THE CHILD UNATTENDED!
- **CAUTION!** THE CAR SEAT MUST BE INSTALLED ONLY ACCORDING TO THE DESCRIBED INSTRUCTIONS IN THIS MANUAL. IT IS DANGEROUS TO USE ANCHOR POINTS OTHER THAN THE ONES GIVEN IN THIS MANUAL!
- **CAUTION!** THE CAR SEAT SAFETY HARNESS (FOR GROUP I) AND VEHICLE BELTS (FOR GROUPS II AND III) MUST BE PROPERLY ADJUSTED ACCORDING TO CHILD'S HEIGHT, NOT TWISTED AND SNUG WELL AGAINST CHILD'S BODY.

- **CAUTION! THIS CHILD RESTRAINT SHOULD NOT BE MODIFIED OR ADAPTED WITH NEW FITTINGS, WITHOUT PREVIOUS AUTHORIZATION BY THE NOTIFICATION AUTHORITY.**
- **CAUTION! KEEP AWAY FROM FIRE!**
- Installation in the vehicle and securing the child in the car seat to be done only by adult!
- The hard parts and the parts of the child restraint made of plastic should be located and installed so that when the vehicle is in normal use, they can not be trapped by a sliding seat or in a door of the vehicle.
- The vehicle 3-point belt must be well tightened and fastened, not pinched in the door, twisted on the seat or other part of the vehicle, or to rub against sharp edges or parts.
- Do not allow the safety belts of the car seat and the vehicle to be twisted, frayed or torn, latches and locks (buckles) must be always in good order and firmly fixed.
- If you find uncertainty or defect in the construction, latches, straps or locking mechanisms of the car seat, discontinue usage until removal of the damaged parts and replacement with new ones.
- After a violent impact the car seat and belts may be damaged. Therefore, it is recommended to replace the car seat with a new one.
- Never use a second hand child restraint. It may have suffered structural damage, which may make the child restraint extremely dangerous.
- Do not use this car seat without its seat cover and do not replace it with a new one, unless supplied by the manufacturer. The fabric parts are integral part of the restraint system and its safety features!
- Always make sure that you are not carrying any unsecured objects, especially on the back shelf, which, in case of an accident, may injure the car's occupants.
- Do not put additional pads except the ones supplied from the manufacturer! Placing additional pads may obscure the safety of your child.
- Do not use spare parts and other components not supplied by the manufacturer. The manufacturer does not take responsibility for the safety in the case that are used spare parts other than original.
- It is recommended to cover the car seat if the vehicle is parked under strong sun shine – extreme sun exposure will make the plastic to deteriorate and the fabric to fade. Please, check that the child restraint has not become too hot before placing your child in the car seat.
- The car seat does not replace the child's cot or bed. When a child needs a sleep, you have to place him in a suitable baby stroller, baby crib or bed.
- Do not attach objects with long cords or strings on the car seat in order to avoid danger of suffocation!
- Never place a child seat on beds, couches or similar soft surfaces!
- Do not allow children to play with the product!
- Do not remove stickers and warnings – they contain important information!
- The packaging of the product must be kept out of the reach of children at the time of and after unpacking in order to avoid the risk of strangulation!

PRODUCT FEATURES

- Child restraint restraint while traveling in a vehicle designed for children weighing from 9 to 36 kg, groups I (9-18kg), II (15-25 kg) and III (22-36 kg);
- The child restraint is installed on the vehicle seat in position „FORWARD FACING“;
- 5 - point safety belt of the car seat;
- The backrest can be adjusted at height;
- Separating the backrest from the seat.

MAIN PARTS DIAGRAM

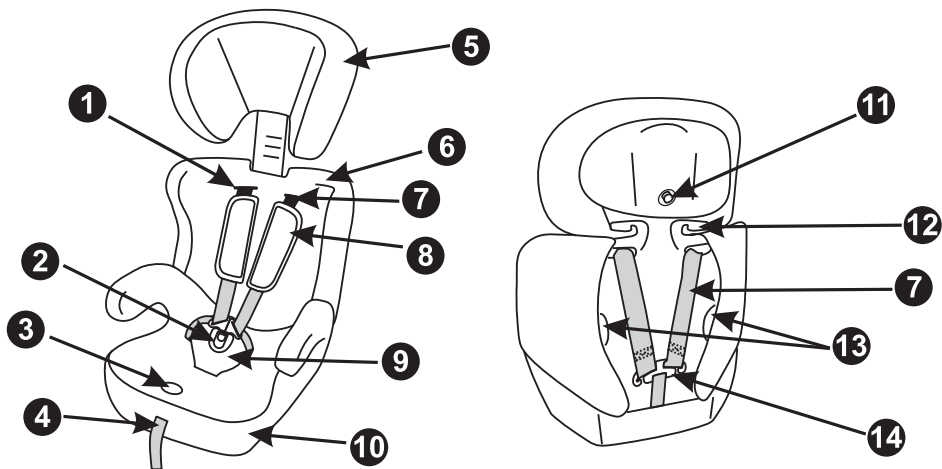

1 Shoulder strap slots

8 Soft pads of the shoulder straps

2 Buckle

9 Soft pad for the buckle

3 Button for adjusting the length of the strap

10 Seat cushion

4 Harness adjuster strap

11 Height adjuster

5 Headrest

12 Belt guide

6 Backrest

13 Adult belt route slots (for group I)

7 Shoulder straps

14 Harness connector

INSTRUCTION FOR USE

IMPORTANT!

- Follow exactly the instructions and safety recommendations in this manual.
- Check the security of the fixing after each operation!
- ALWAYS CHECK THE SECURITY OF FIXING OF THE SAFETY BELTS!

SECURING OF CHILDREN IN THE VEHICLE GROUP I (9-18 kg)

1 – ADJUSTING THE HEIGHT OF SHOULDER STRAPS

IMPORTANT! The shoulder straps should be at the level of the child's shoulders.

2 – INSTALLATION OF THE CAR SEAT ON THE VEHICLE SEAT

3 – LOOSENING AND TIGHTENING OF THE HARNESS
4 – FIXING OF THE SHOULDER STRAPS TO THE BUCKLE

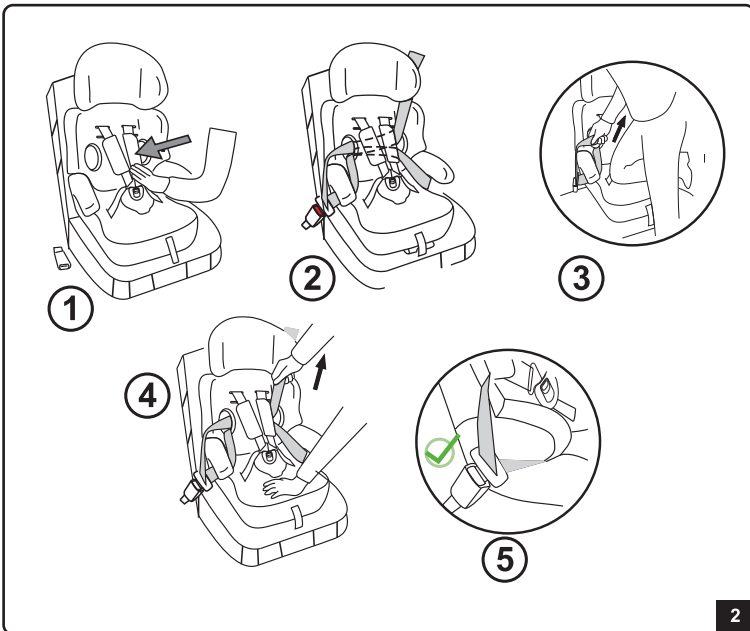
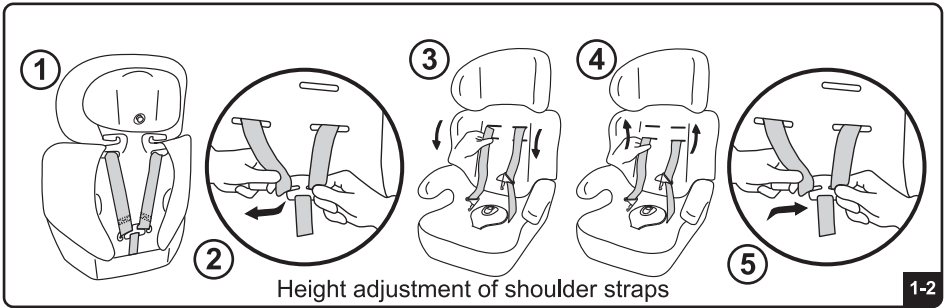
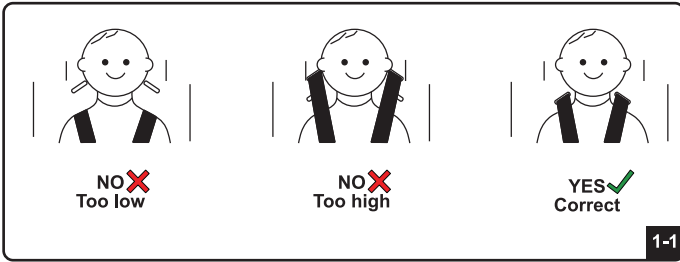

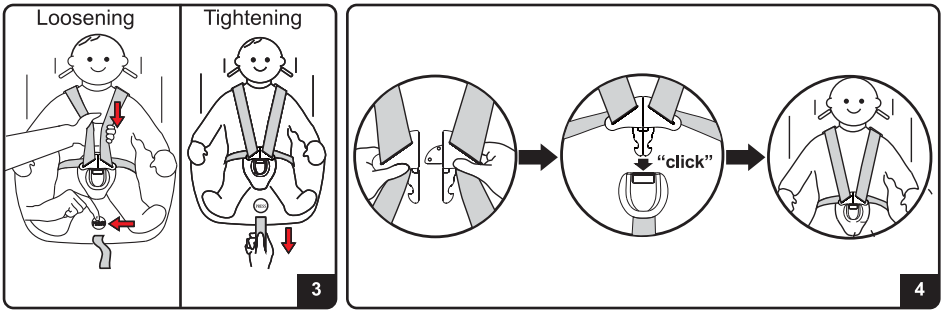

SECURING OF CHILDREN IN THE VEHICLE GROUP II (15-25kg)

CAUTION! Children weighing from 15 to 25 kg (group II) secure with 3- point adult safety belt of the vehicle seat.

IMPORTANT! When you are using the car seat for children weighing from 15 to 25 kg (group II), you have to remove the 5-point safety belts of the child restraint.

- 5 – REMOVAL OF THE SAFETY HARNESS OF THE CAR SEAT
- 6 – ADJUSTING THE HEIGHT OF THE HEADREST
- 7 – SECURING THE CHILD IN THE CAR SEAT

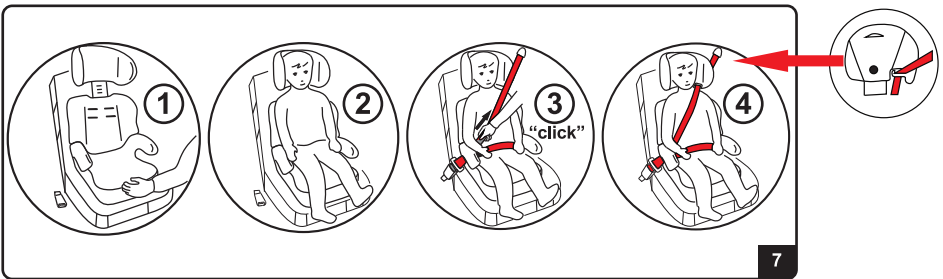
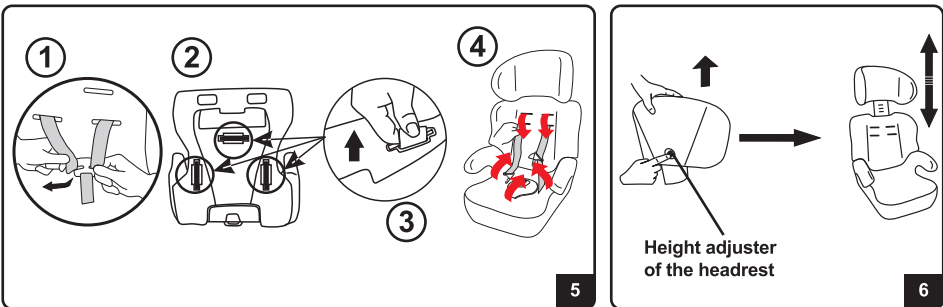

SECURING OF CHILDREN IN THE VEHICLE GROUP III (22-36kg)

CAUTION! Children weighing from 22 to 36 kg (group III), remove the backrest of the car seat.

- 8 – REMOVAL OF THE BACKREST OF THE CAR SEAT
- 9 – SECURING THE CHILD IN THE CAR SEAT

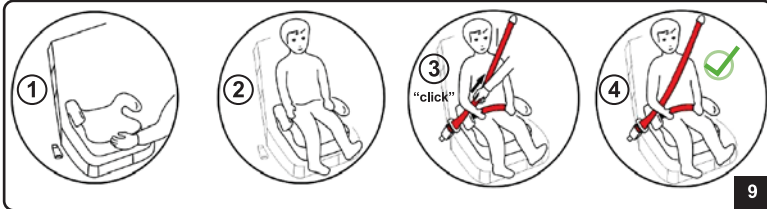
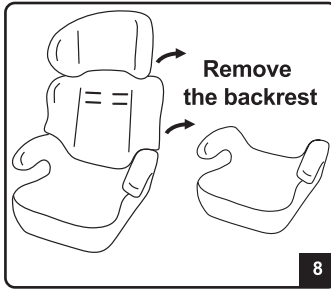

REMOVAL AND PLACING OF THE FABRIC COVER

- Remove the belts as described in fig. 5;
- Push back the backrest until it is in horizontal position;
- Remove the backrest;
- Loosen and remove the fabric cover from the backrest.

To place the fabric cover again, follow the above described steps in reverse order.

CLEANING AND MAINTENANCE INSTRUCTIONS

- Clean the plastic or metal parts with damp soft cotton cloth or sponge and mild soap.
- Harnesses must be cleaned with damp cloth and mild soap!
- Upholstery and soft pads may be hand washed at 30 C using mild detergent!
- Do not bleach! Do not tumble dry! Do not machine wash! Do not iron!
- Do not use abrasive, bleach or other aggressive detergents.
- Always after cleaning, leave the car seat fully dry and after that use it or store it.
- Do not wet or remove the stickers. They contain important information!
- Always store your car seat indoors – on dry and clean place. Do not expose to direct environment influence - sun, rain, moisture and high temperature intervals.
- Please, contact your authorized dealer for problems connected with the use or repair.

Fabric:

Outer: 100% polyester

Filling: 100% polyester





1 Goliakonarsko shosse, Plovdiv, BULGARIA
www.chipolino.com