

**ATTENTION! KEEP IT IN A SAFE PLACE FOR FUTURE REFERENCE.**

## **INSTRUCTION MANUAL FOR USE OF INFANT CAR SEAT "UP & DOWN"**

**CAR SEAT  
UP&DOWN**

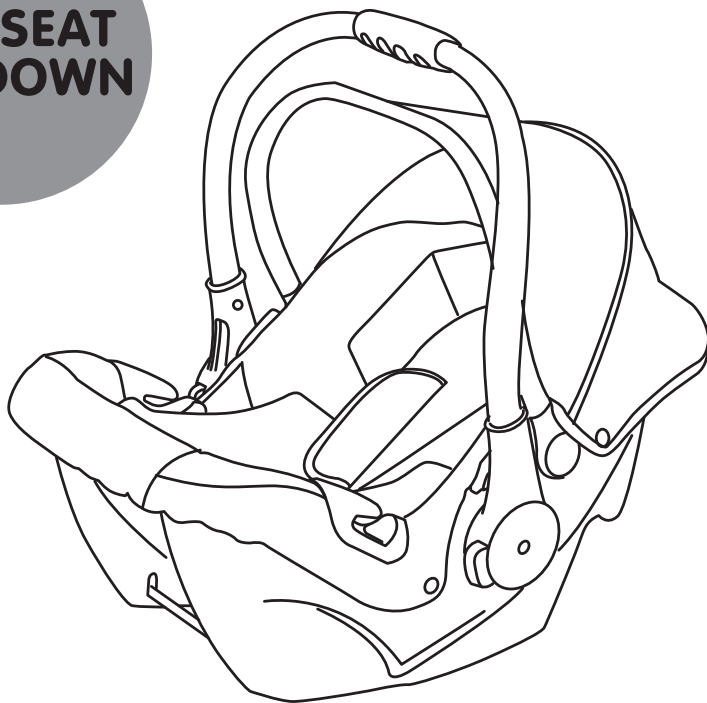

This child restraint **chipolino** is manufactured in compliance with the requirements of Regulation 44 of the United Nations Economic Commission for Europe concerning the safe transportation of children (ECE R44/04), the provisions of the Product Safety Directive 2001/95/EU and Directive 91/671/EEC "Compulsory use of seatbelts and child restraints systems for child occupants of power driven vehicles" of the European Parliament and The Council as well as regulations of national law.

## NOTICE

### For group 0+ (0-13kg)

1. This is a "UNIVERSAL" CHILD RESTRAINT SYSTEM. It is approved (No: E4-44R-044471) to Regulation No 44, 04 series of amendments, for general use in vehicles and it will fit most, but not all, car seats.
2. A correct fit is likely if the vehicle manufacturer has declared in the vehicle handbook that the vehicle is capable of accepting a "Universal" child restraint for this age group.
3. This child restraint has been classified as "Universal" under more stringent conditions than those which applied to earlier designs which do not carry this notice.
4. If in doubt, consult either the child restraint manufacturer or the retailer.



**NO SYSTEM CAN PROVIDE ABSOLUTE PROTECTION OF INJURY IN THE CASE OF A CRASH OR ROAD ACCIDENT. DRIVE WITH ATTENTION, WHEN THERE IS A CHILD IN YOUR VEHICLE!**

**YOUR CHILD WILL BE UNDER MAXIMUM PROTECTION OF THIS SYSTEM, IF YOU FOLLOW THESE INSTRUCTIONS AND RECOMMENDATIONS THOROUGHLY!**

### POSITION OF THE CAR SEAT IN THE VEHICLE

This restraint system is suitable for use in combination with three-point belts of the car (lap and diagonal) approved to Regulation ECE R16!

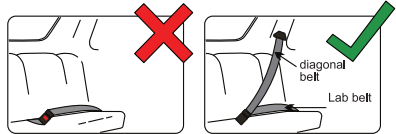

This car seat must be rear-facing at all times. Never install it in forward facing mode!  
Never put the car seat on passenger seat equipped with airbag! This could lead to serious injury or death!



Do not place the car seat on passenger seats facing sideways or rearward!

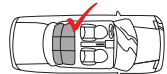

- NEVER LEAVE THE CHILD IN THE CAR SEAT UNATTENDED!
- DO NOT INSTALL THE CAR SEAT IN A WAY DIFFERENT FROM THE ONE SHOWN IN THE INSTRUCTION. IT IS DANGEROUS TO USE BEARING CONTACT POINTS OTHER THAN THOSE DESCRIBED IN THIS MANUAL!
- IT IS VERY IMPORTANT THAT THE LAP BELT IS LAYING LOW AND THE CHILD'S HIPS ARE SNUG!
- IT IS DANGEROUS TO MAKE CHANGES, ADDITIONS OR MODIFICATIONS ON THE CONSTRUCTION! THESE ACTIONS ALSO REQUIRE APPROVAL BY A NOTIFIED BODY! If a problem occurs during the operation of the car seat, contact the supplier or an authorized service center for advice or repair.

- **MISUSE OF THE CAR SEAT WILL CONTRIBUTE TO REDUCE ITS SAFETY AND SECURITY FEATURES!** Failure to comply with the directions of this instruction not only fail to ensure the safety of the car seat and the child in the vehicle, but may increase the risk of serious injury or death!
- **KEEP AWAY FROM FIRE!**
- Use this car seat for newborn babies and children up to 13 kg.
- This car seat must be installed and handled only by adult!
- Hard parts and the parts of the restraint system, made of plastic, must be located and installed so that when the vehicle is in normal operation, they cannot be trapped by a sliding seat or in door vehicle.
- You should always be convinced that three-point belt for adults, which attach the child seat to the vehicle seat, is well stretched, is not pinched by the door, wrapped on the seat or any other part of the vehicle. It should not rub against sharp edges or parts.
- The belts of the car seat should not be twisted, properly fastened and adjusted to the child's body.
- The belts - of the car seat and the vehicle - should not be twisted, frayed or torn, latches and locks (buckles) must be in order. Make sure that they are firmly fixed.
- If you find uncertainty or failure in the structure, latches, straps or locking mechanisms, discontinue usage until removal of the damaged parts and replacement with new ones.
- If the car seat has been subject to destructive loads during violent impact or accident, replace it with new.
- Never use a second-hand car seat or second-hand spare parts! The car seat may have been in a violent impact or car crash.
- Do not use this car seat without its seat cover and do not replace it with a new one, unless supplied by the manufacturer.
- Do not use the car seat if the child's head is above the upper edge of the car seat!
- Any luggage or other items that are liable to cause injury in case of sudden stop, collision or accident when travelling must be removed or securely fastened to a safe distance from the car seat and child.
- Do not place additional pads in the car seat than those provided by the manufacturer!
- Do not use spare parts and other components not supplied by the manufacturer! The manufacturer takes no responsibility for safety in case spare parts are used other than the original.
- Do not expose this car seat on a direct sunlight to avoid injuries of the child, deformation of the car seat and especially of the plastic parts.
- Car seat does not replace a carrycot or a bed. Should your child need to sleep, then he should be placed in a suitable cot or bed.
- Strings can cause strangulation! Do not place additional strings to the product to avoid injuries or strangulation!
- Do not place the car seat on soft surface like beds or sofas! The car seat may tip over and injure or suffocate your child!
- Do not allow children play with this product!
- The packaging of the product must be kept out of the reach of children to avoid the risk of strangulation!

## MAIN FEATURES:

- Suitable for babies aged 0+ months and weighting up to 13 kg.
- Adjustable carry handle
- 3 – point Y –shaped safety harness

**ATTENTION!** The car seat should be mounted on the frame of baby stroller only using the adaptors provided by the manufacturer for the specific model stroller. Compatibility between stroller and car seat must be confirmed by the stroller's manufacturer.

## PARTS DIAGRAM

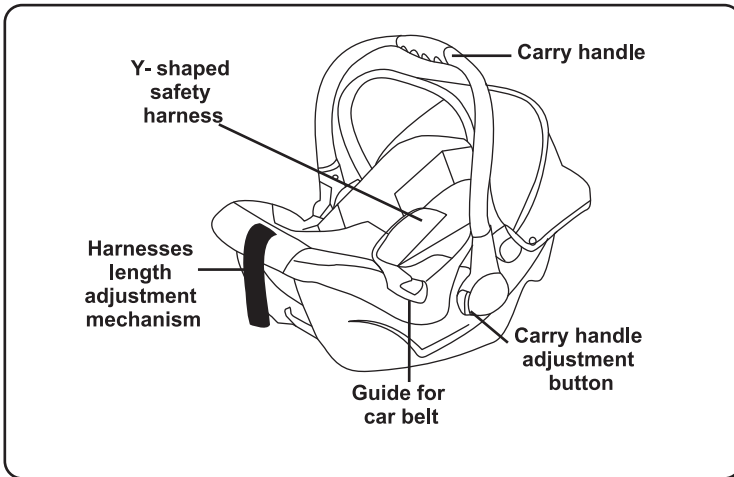

**CAUTION!** Always check the stable fixing of the safety belts!

### 1 – Carry handle adjustment

**Note:** Button jumps out after each position is fixed properly and you hear a "click" (1c).

### 2 –Safety harness height adjustment

**CAUTION!** Shoulder straps should be at the level of your child's shoulders or slightly below this level (2a).

To change the harness strap position, undo the harness strap from the steelsplitter plate on the back of the car seat and re-thread them through the desired slots (2b and 2c).

### 3- Secure the child in the car seat

Press the button located on the crotch strap, pull with the other hand simultaneously both belts towards you to loosen them (3a).

Unlock and open the belts (3b).

Place the child in the car seat (3c).

Join the shoulder belts and lock them into the buckle (3d and 3c).

**Note:** Do not remove the cushion if you are going to use the car seat for a newborn baby or baby less than 7 months of age!

### 4- Safety harness length adjustment

**Tighten the harnesses** – Pull the adjustment belt (4a).

**Loosen the harnesses** – Press the button located on the crotch strap, pull with the other hand simultaneously both belts towards you (4b).

**Note:** Pull the harness, not its pad.

### 5- Installation of the car seat into the vehicle

Fix the car seat into the seat using the shoulder and lap belts of the car (5a – 5e).

**CAUTION!** Set the car seat in suitable recline position. Too upright position might cause breath problems and/or serious injuries in case of sudden car speed's changes.

**WARNING!** Vehicle shoulder belt must not be placed through car seat's slots!

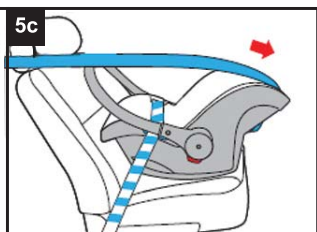
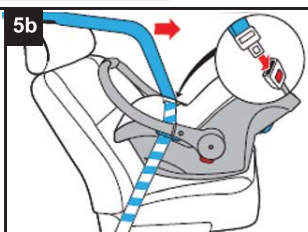
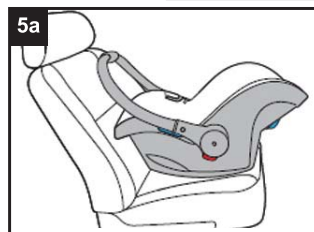
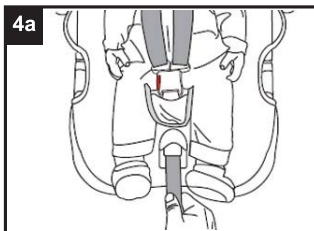
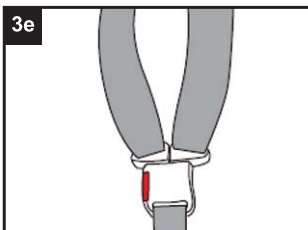
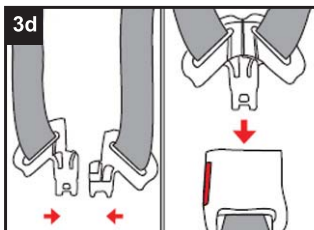
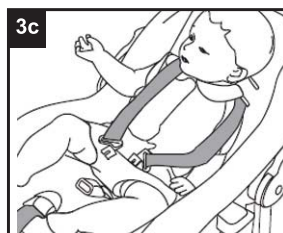
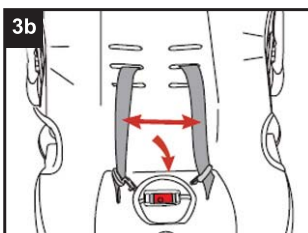
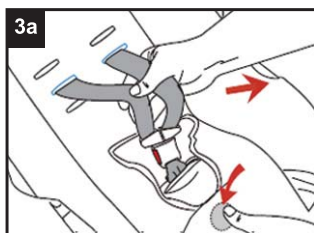
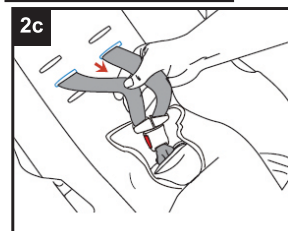
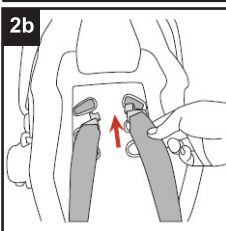
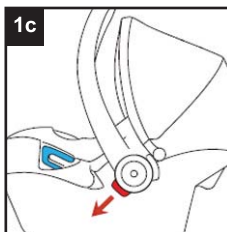
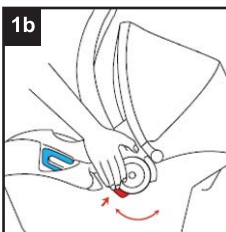
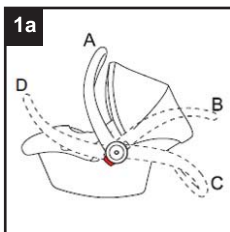

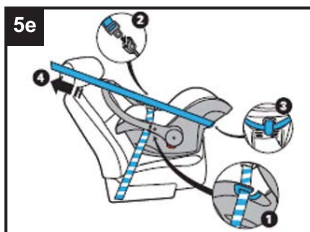

## CLEANING AND MAINTENANCE INSTRUCTIONS

- Clean the fabrics, plastic parts and metal parts with damp cotton cloth or sponge and mild soap.
- Do not wash and do not bleach! Do not spin! Do not tumble dry! Do not iron!
- Do not use abrasive, bleach or other aggressive detergents.
- Always after cleaning leave the car seat fully dry and after that use it or store it. It may appear mold to your car seat if you keep it moist.
- Harnesses must be cleaned with damp cloth and mild soap!
- Do not wet or remove the stickers. They contain important information!
- Always store your car seat indoors – on dry and clean place. Do not expose to direct environment influence - sun, rain, moisture and high temperature intervals.
- Please, contact your authorized dealer for problems connected with the use or repair of this car seat.

### Fabric:

**Outer:** 100% Polyester

**Filling:** 100% polyester



**Used materials:** plastics, textile, metal.



# CHIPOLINO



БЪЛГАРИЯ, гр. Пловдив 4027, ул. Голямонарско шосе 1; тел.: 032 600 855; www.chipolino.com  
BULGARIA, Plovdiv 4027, 1 Goliamonarsko shosse Str.; tel.: + 359 32 600 855; www.chipolino.com

## CONFORMITY DECLARATION

I, Maxim Mitkov – General Manager of Chipolino Ltd with its place of business at: 1 Golyamonarsko Shosse Str., s. Tzaratzovo, Maritza Municipality, Plovdiv, Bulgaria, as being recognized as the manufacturer according to the Consumer Protection Law, hereby

### DECLARE

**The product CAR SEAT, model UP & DOWN with its item № STKUPD1xxxx**, for which this declaration is about, has been manufactured in accordance with the requirements of Regulation 44 of the United Nations Economic Commission for Europe regarding the safety of restraining devices for child occupants of power-driven vehicles (Child restraint system) and the requirements of The General Product Safety Directive 2001/95/EC of the European Parliament and the Council and the regulations of national law, including Consumer Protection Law.

The seat is approved with **№ E4-44R-044471** by **RDW** – The Netherlands, classified in weight group 0+ and suitable for newborn babies and children weighing up to 13kg.

I am declaring this on the grounds of certificate **№ E4-44R-044471 /07.11.2014**, issued by **RDW** – The Netherlands, after completed tests according to the requirements of Directive 2001/95/EC and Regulation 44 of the United Nations Economic Commission for Europe, the results of these tests are in test report № 14-00845-CX-SHA-00/23.09.2014.

**The product CAR SEAT model UP & DOWN** for which this declaration is about, is safe for the consumers and does not possess any risk for the health of consumers during its use in accordance with the manufacturer's instruction manuals, which are an integral part of the product.

01.12.2017  
Plovdiv

**MAXIM MITKOV,**  
General Manager of Chipolino Ltd.





---

1 Goliakonarsko shosse, Plovdiv, BULGARIA  
[www.chipolino.com](http://www.chipolino.com)