

IMPORTANT! KEEP THIS MANUAL FOR FUTURE REFERENCE

INSTRUCTION MANUAL FOR DIGITAL AUDIO BABY MONITOR “NANO”

NANO

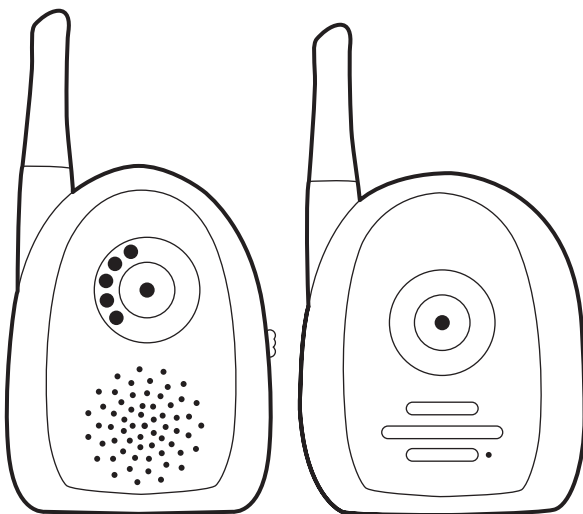

This **chipolino** product is manufactured in accordance with the requirements of Directives of the European Parliament and Council 2014/53/EU relating to the making available on the market of radio equipment, Directive 2011/65/EU on the restriction of the use of certain hazardous substances in electrical and electronic equipment (RoHS), Directive 2009/125/EC, establishing a framework for the setting of ecodesign requirements for energy-related products, Regulation (EC) No 1907/2006 concerning the Registration, Evaluation, Authorisation and Restriction of Chemicals (REACH) and 2001/95/EU on General Product Safety as well as in accordance with National Legislation. The conformity of this certified with test reports, mentioned in the declaration of compliance of this products, which can be found at www.chipolino.com.

TO GUARANTEE THE SAFE USE OF THIS PRODUCT, FOLLOW THE WARNINGS, GUIDELINES AND RECOMMENDATIONS IN THIS MANUAL!

ATTENTION! WARNINGS!

- **CAUTION!** THIS PRODUCT IS INTENDED TO AID YOU AND CANNOT SUBSTITUTE A REAL AND RESPONSIBLE ADULT SUPERVISION!
- **CAUTION!** USE THE PRODUCT ONLY FOR ITS PURPOSE!
- **CAUTION!** ONLY AN ADULT SHOULD USE THE PRODUCT!
- **CAUTION!** THIS DEVICE IS NOT A TOY AND MUST BE KEPT OUT OF CHILDREN'S REACH!
Do not let children play with parts of the monitor!
- **CAUTION!** NEVER PLACE THE BABY UNIT IN THE BABY'S BED OR PLAYPEN! Place the transmitter no less than 2 m away!
- **CAUTION!** THE ADAPTERS, PARENT AND BABY UNITS MUST ALWAYS BE OUT OF THE REACH OF THE BABY TO AVOID RISK OF INJURY OR SUFFOCATION!
- **CAUTION!** BEFORE USE, INSPECT THE GOOD WORKING ORDER OF ALL PARTS OF THE PRODUCT. Do not use the product if you find some parts are missing or damaged.
- **CAUTION!** NEVER USE THE BABY MONITOR IN WET ENVIRONMENT, CLOSE TO OR IMMERSED IN WATER!
- **CAUTION!** KEEP AWAY FROM FIRE. To avoid overheating keep the transmitter, receiver and adaptors away from heat sources or other devices, which release heat.
- **CAUTION!** Do not leave the adapters in a place where children may step on them. An impact on the adapter when plugged in the electricity may cause damage and serious risk of injury!
- Do not use spare parts or other components, which are not supplied by the manufacturer! The producer does not assume responsibility in case spare parts have been used which are different from the approved type or recommended by the producer.
- Do not make changes or modifications on the product! Do not modify the electric circuit and do not add other electrical parts! If necessary, contact the retailer or an authorized service center for advice and repair.
- Before plugging the adaptors in, check if the voltage marked on the adaptor is the same as the voltage of the local electricity network. If not, you will damage the product!
- Do not use damaged adaptors.
- Do not remove the labels and warnings on the product! They are important for everyone who uses the product!
- Keep the nylon package away from children to avoid suffocation!

WARNINGS FOR USING BATTERIES

- Always secure the batteries compartment with the cover after you installed the batteries.
- Do not allow children near the batteries or play with them!
- Install batteries only of the recommended size and voltage.
- Do not use batteries with different type.
- Do not mix new and used batteries.
- Follow the polarity at batteries compartment.
- Remove the damaged or depleted batteries.
- Remove the batteries when you are not going to use the product for a long period of time.
- Remove the batteries from the product while you are using the adaptors.
- Do not throw the batteries in open fire. Do not disassemble the batteries.
- **CAUTION!** When you stop using the product, do not throw it in the household waste but hand it over to an official waste collecting point. The waste from damaged electrical and video devices, batteries, adaptors, must be disposed separately. Throwing them out in containers for household waste is forbidden.



PRODUCT FEATURES

Operating frequency	2.40-2.4835GHz
Suitable ambient temperature	From 0°C up to +40° C
Transmission power	<20dBm
Range (open space)	Up to 300 m
Adapter, 2 pcs	Input: 100-240VAC, 50-60Hz, 0.25A Output: DC5,0V 1000mA
Battery, type „AAA” alkaline (not included)	6x1.5V
Position of transmitter to the baby	1,5-2 m
Belt clips – for both units	YES
Both units can be wall installed	YES

INSTRUCTIONS FOR USE

CAUTION! TO BE USED ONLY BY AN ADULT!

PARENT UNIT (RECEIVER)

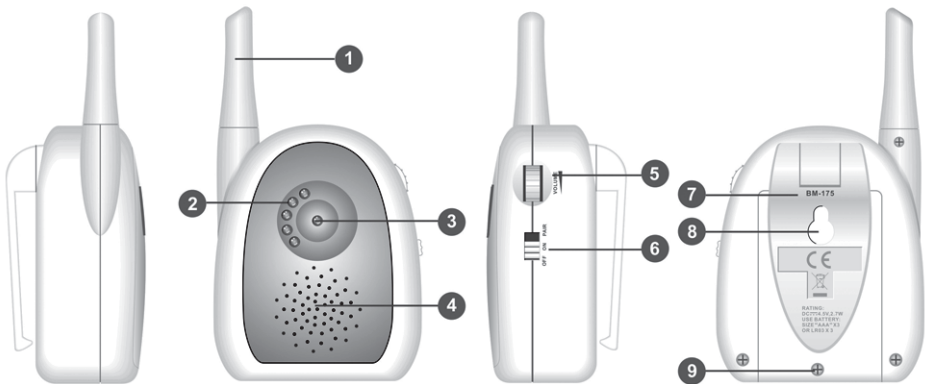

- 1 Antenna
- 2 Sound indicators
- 3 Power indicator and low batteries indicator
- 4 Speaker
- 5 Rotary volume control

- 6 Switch ON/OFF/PAIRING
- 7 Belt clip
- 8 Wall installation opening
- 9 Battery compartment

BABY UNIT (TRANSMITTER)

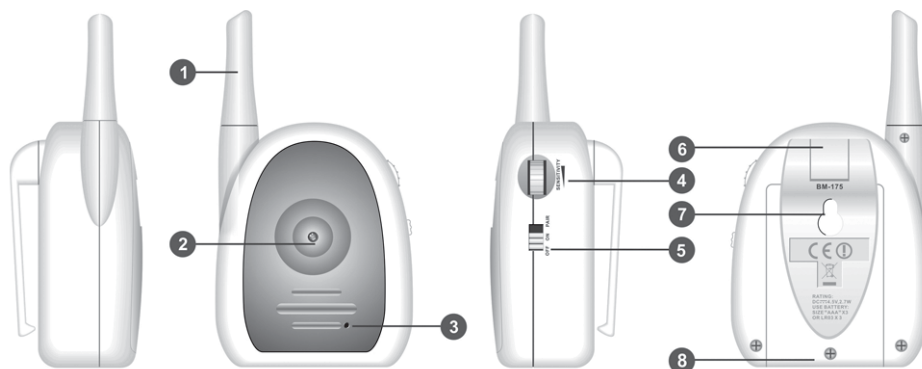

- 1 Antenna
- 2 Power indicator and low batteries indicator
- 3 Microphone
- 4 Rotary volume control

- 5 Switch ON/OFF/PAIRING
- 6 Belt clip
- 7 Wall installation opening
- 8 Battery compartment

PREPARATION FOR USE

1. Use when devices are plugged in (using the adapters)

Insert the adapter cable in the unit and plug it in an electricity outlet.

2. Placing the batteries

- Remove the battery compartment cover.
- Place 3 pcs in each unit plain alkaline batteries, type „AAA” 1.5 V.
- Secure the batteries with the cover.

3. Placing the baby monitor

- Place the baby unit on stable, horizontal and even surface, or
- Install the baby unit on the wall.

ADVICE FOR BETTER PERFORMANCE AND WIDER RANGE:

- For better operation and during longer period of usage, we recommend you to use adaptors, not batteries to supply both units.
- If between the two devices there are many walls or ceilings or you use wireless phone, wireless video, Wi-Fi net, micro oven or Bluetooth devices on frequency 2.4 GHz, the transmitter or receiver may get interference. To solve the problem, try to place the parent unit closer to the baby unit or turn off other wireless devices.

FUNCTIONS

ON/OFF

- Position ON: device is switched on and the power indicator is green;
- Position OFF: device is switched off.

DEVICES PAIRING

Position the switch in position PAIR on both units. The light power indicators on both units will start flashing slowly until you hear a sound, which signalizes that the pairing is finished successfully. Slide the switch in position ON.

VOLUME CONTROL

The volume on both units is controlled by scrolling the rotary button.

NOTE: The sound indicator light on parent unit changes according to the sound received from the transmitter. The receiver registers the sound from the transmitter unit when it reaches 60dB.

LOW BATTERY INDICATOR

- When batteries are going down, the low battery indicator will start flashing.
- The devices will shut down when the charge left in batteries is less than 3V.

OUT OF RANGE ALARM (ONLY PARENT UNIT)

The parent unit will alarm and simultaneously the five LED lights will be enlightened.

TROUBLE SHOOTING

PROBLEM	SOLUTION
No power	<ul style="list-style-type: none">• Unit is turned off.• Check if the batteries are installed properly.• The Unit may be in low battery status, change new batteries
Message not transmitted.	<ul style="list-style-type: none">• Volume level of Baby unit is too low, Rotate the knob switch to higher level.• Units are out of range or lost connection. Ensure the distance between the units within communication range. Note: Communication range varies depending on surrounding conditions such as physical obstructions, interference.• Ensure both units have already scanned the corresponding code and pair them again.
No sound signal	<ul style="list-style-type: none">• Volume level on Parents unit is set too low. Adjust it to higher volume.• Volume level on Baby unit is too low, the Rotate the knob switch to higher level.• Units are out of range. Ensure the distance between the units within communication range.• Ensure both units toggle switch on the same position, all on ON position or all on PAIR position
Received Conversation or sound from neighbors	<ul style="list-style-type: none">• Signal interference due to other nursery monitor on the same ID Code or cordless phone used. Try to pair them again.
Hearing static or rustle from Parent unit	<ul style="list-style-type: none">• The both units are positioned too close to each other. Keep away two units at about 1m.• The volume is set too high. Lower the volume at the Parent unit.• Reposition or replace batteries.

**Power LED rapidly flashes
green light and can not
receive or transmit**

- The power is too low. Replace the batteries.

CARE AND MAINTENANCE

- Do not step on the power supply cable and keep it from twisting especially around the connectors, socket and the point where the cable comes out of the unit.
- Keep the units for the parent and baby and the adapters so that they will have sufficient ventilation. Do not cover them with clothes, towels, covers, etc.
- Always unplug the units from the sockets during thunder storm or if you will not use them for a long time.
- Do not immerse the parent or baby units in water, do not wash them under running water.
- Clean the parts of the baby monitor and adapters with a dry towel after you have turned the units off and unplugged the adaptors from the electricity network.
- Store in a dry and cool place.
- In case of problems connected with the normal use of this product, please consult authorized service shop.

Used materials: plastic, metal.



1 Goliakonarsko shosse, Plovdiv, BULGARIA
www.chipolino.com