

Pumping Engine

ACADEMY

HOBBY MODEL KITS

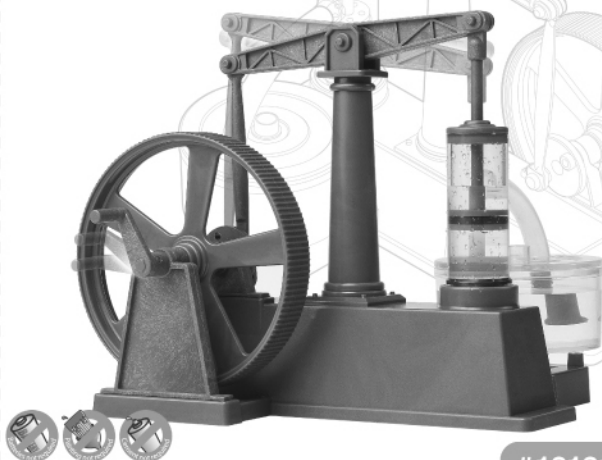

#18131

Parts Locating Diagram

A

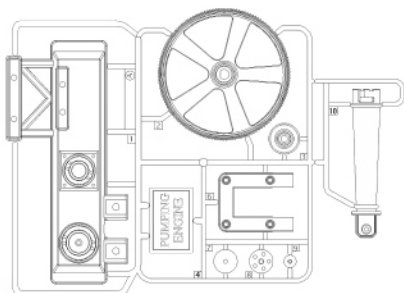

B

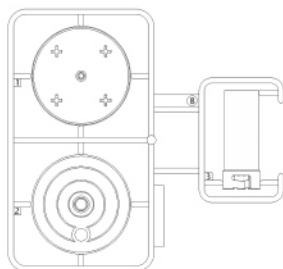

● Spare parts: C7X1, C8X1, C9X1, C10X1

C

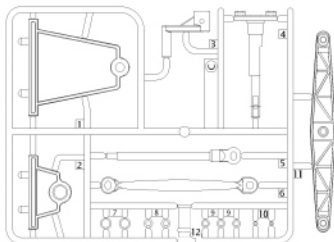

O-Ring



X2



Thin Tube



Thick Tube

1

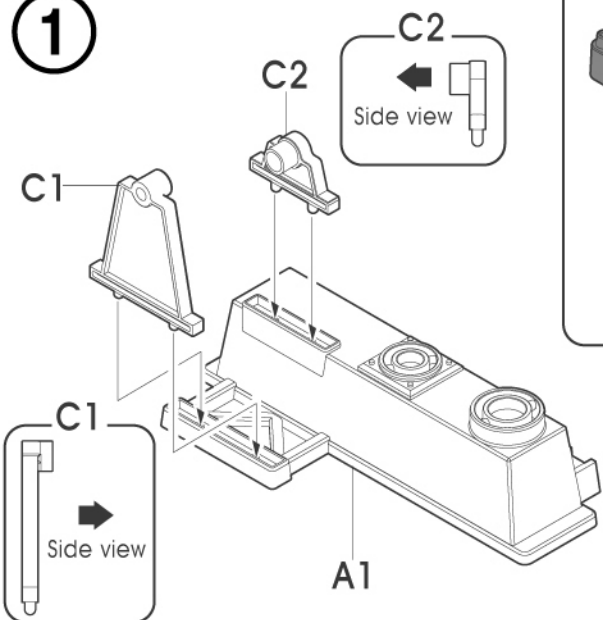

2

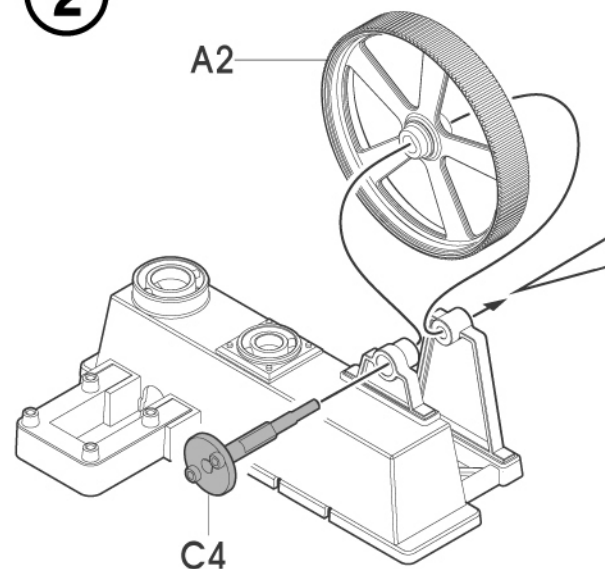

3

※Strictly follow the assembly order as shown by the numbers.

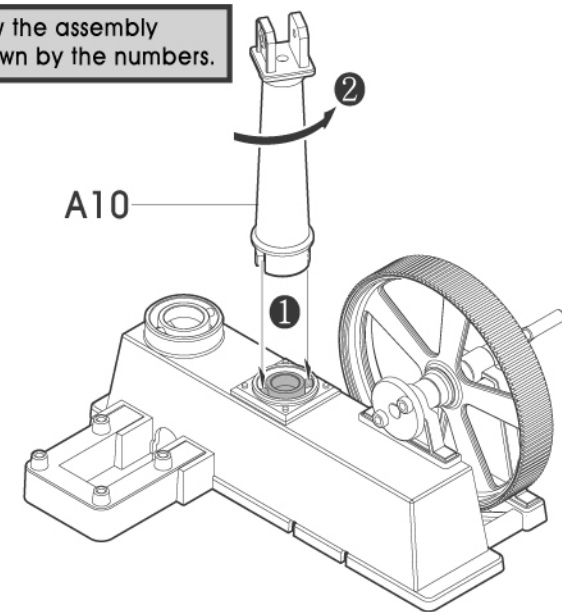
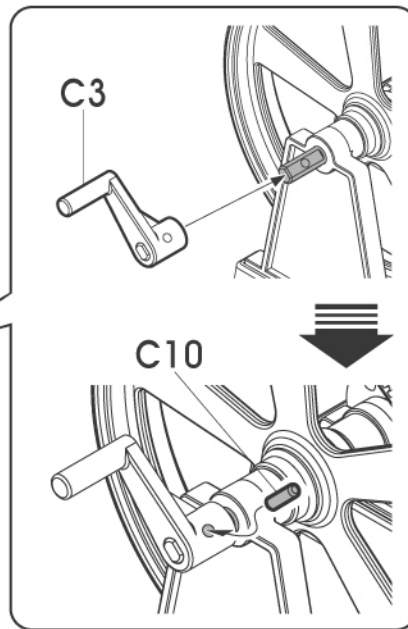

4

※Strictly follow the assembly order as shown by the numbers.

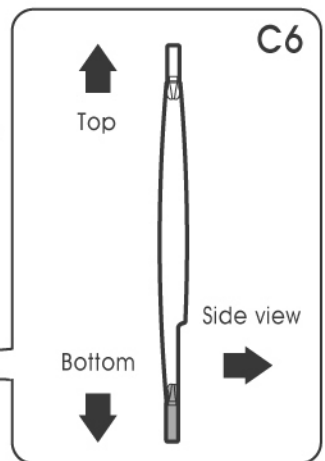
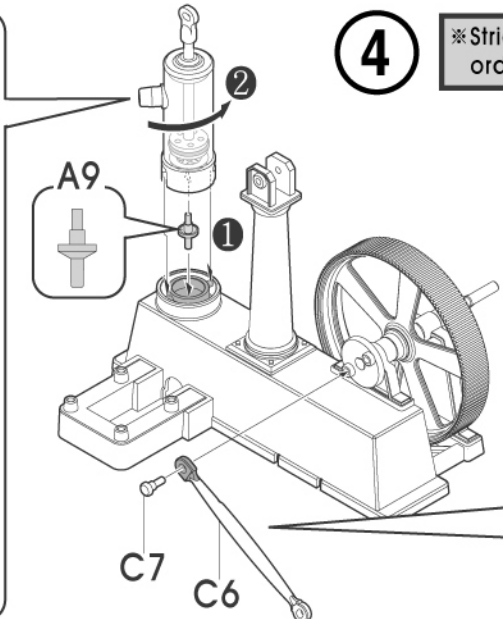
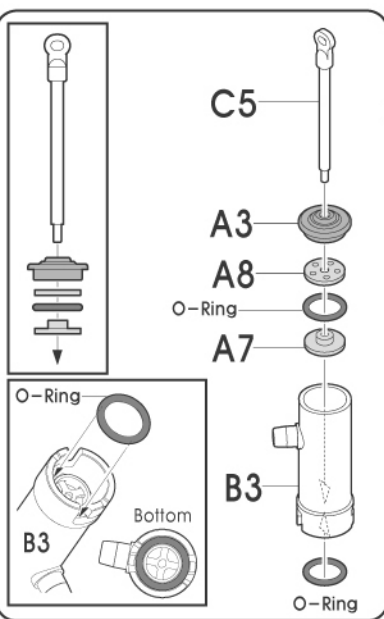

5

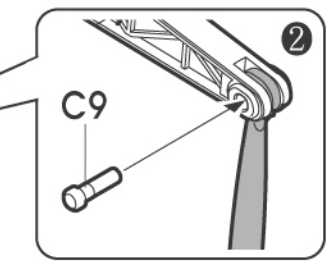
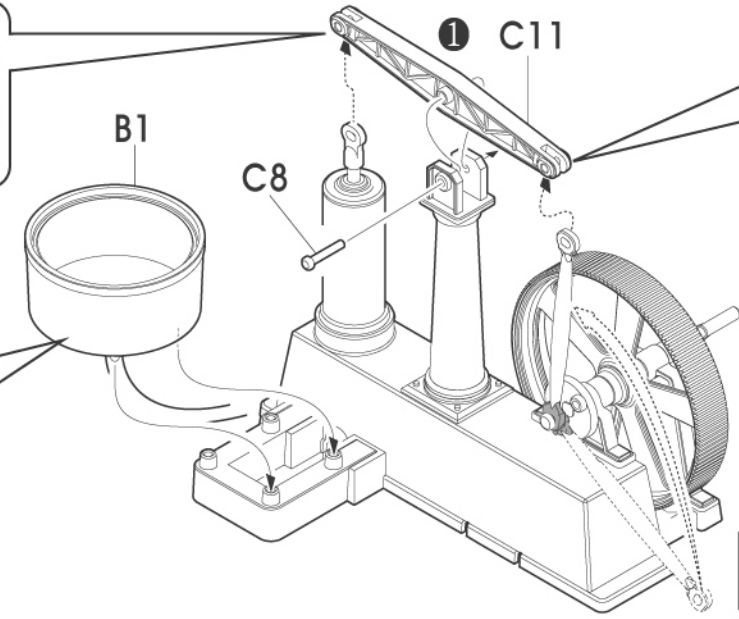
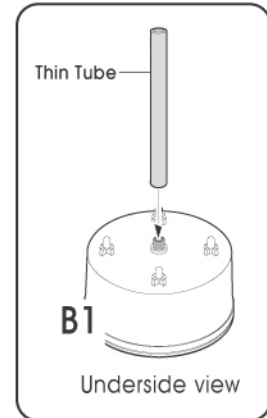
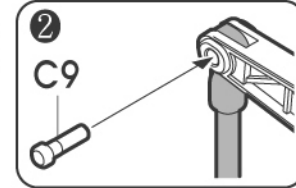

※Strictly follow the assembly order as shown by the numbers.

6

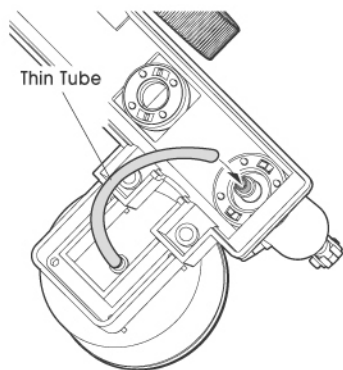

※ Fill half a cup of water.

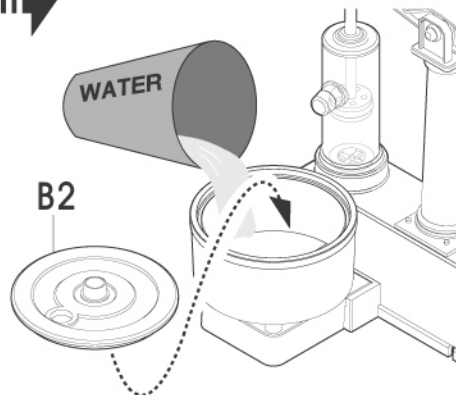

※ Strictly follow assembly as shown in diagram.

7

※ Careful not to be curved with tube.

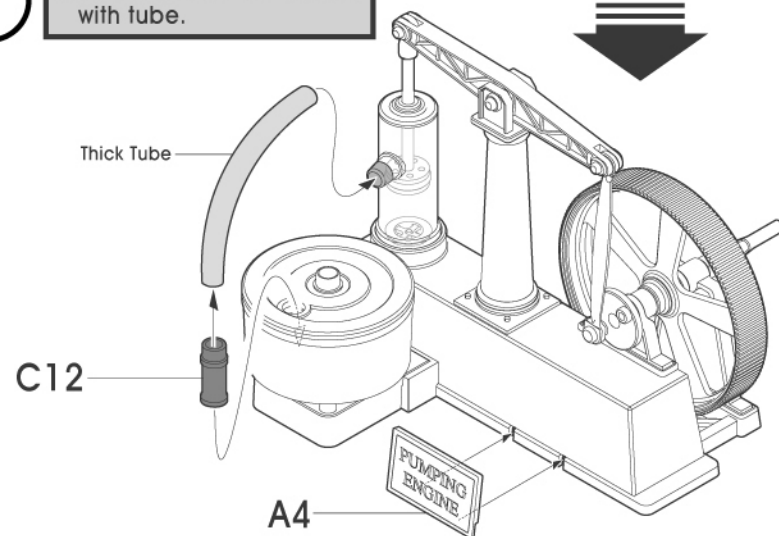

■ Finished Model

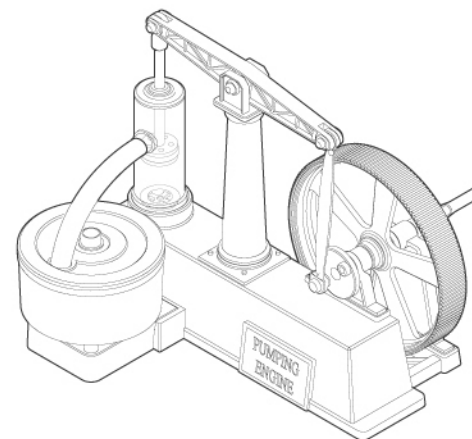

■ How to Operate

※ Follow these 3 step to demonstrate the operating principle.

