

# Da Vinci Machines Series

## Da Vinci

### Mechanical Drum

- Mechanical Drum designed by Leonardo da Vinci
- Changing the positions of the cams will change the rhythm and beat of the drum
- Assemble two ways - As a Cart or as a Stand

ACADEMY

HOBBY MODEL KITS



Leonardo da Vinci  
(1452~1519)

## Parts Locating Diagram

### ● Leonardo da Vinci Mechanical Drum

The cart was equipped with a mechanical mechanism that caused the two side drums to beat whenever the cart was pulled or pushed.

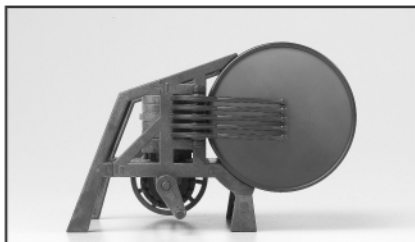
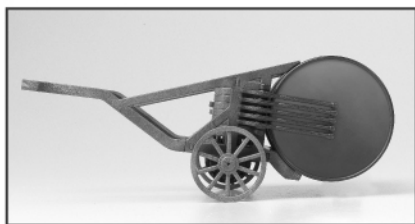

A

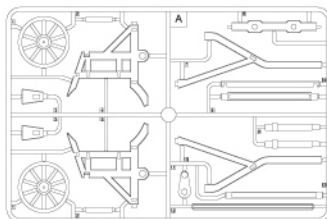

B

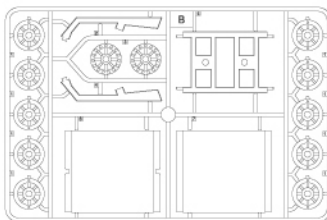

C

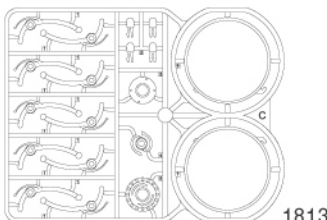

1

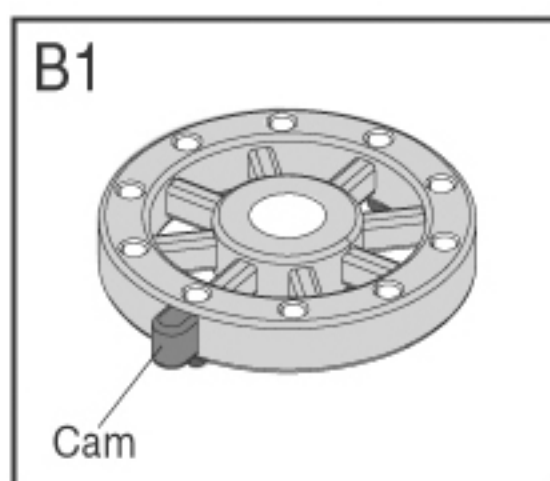
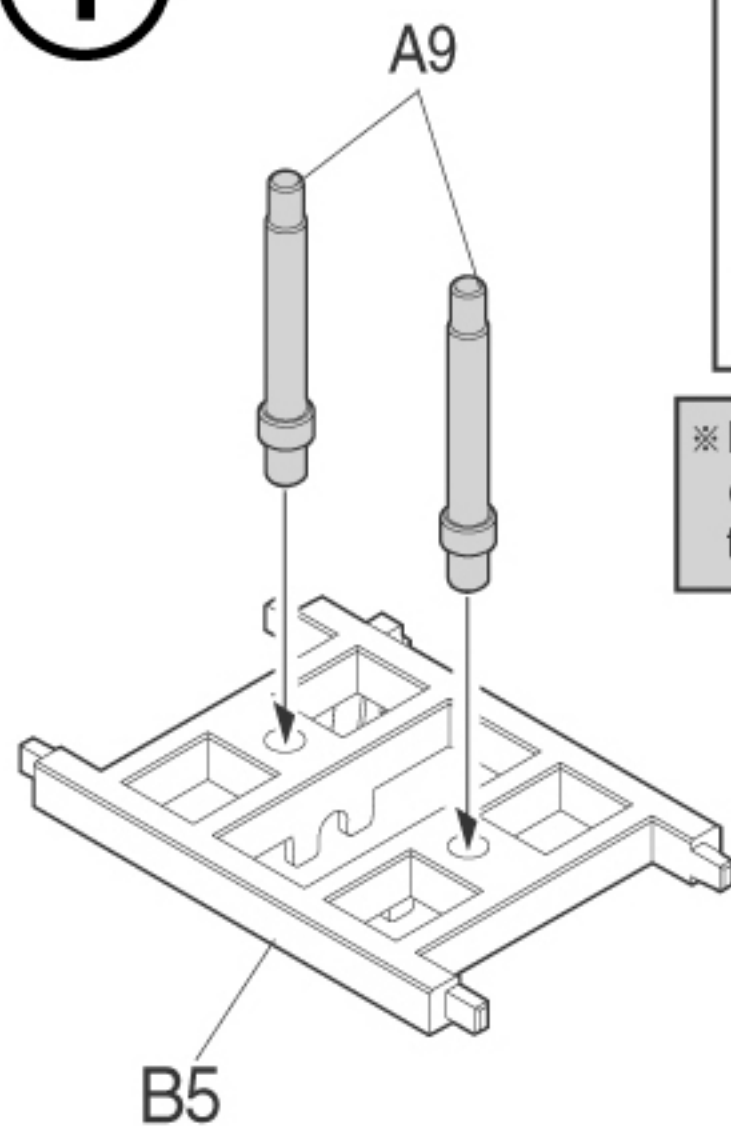

※ Randomly position the cams of part B1 for the da vinci drum to operate properly.

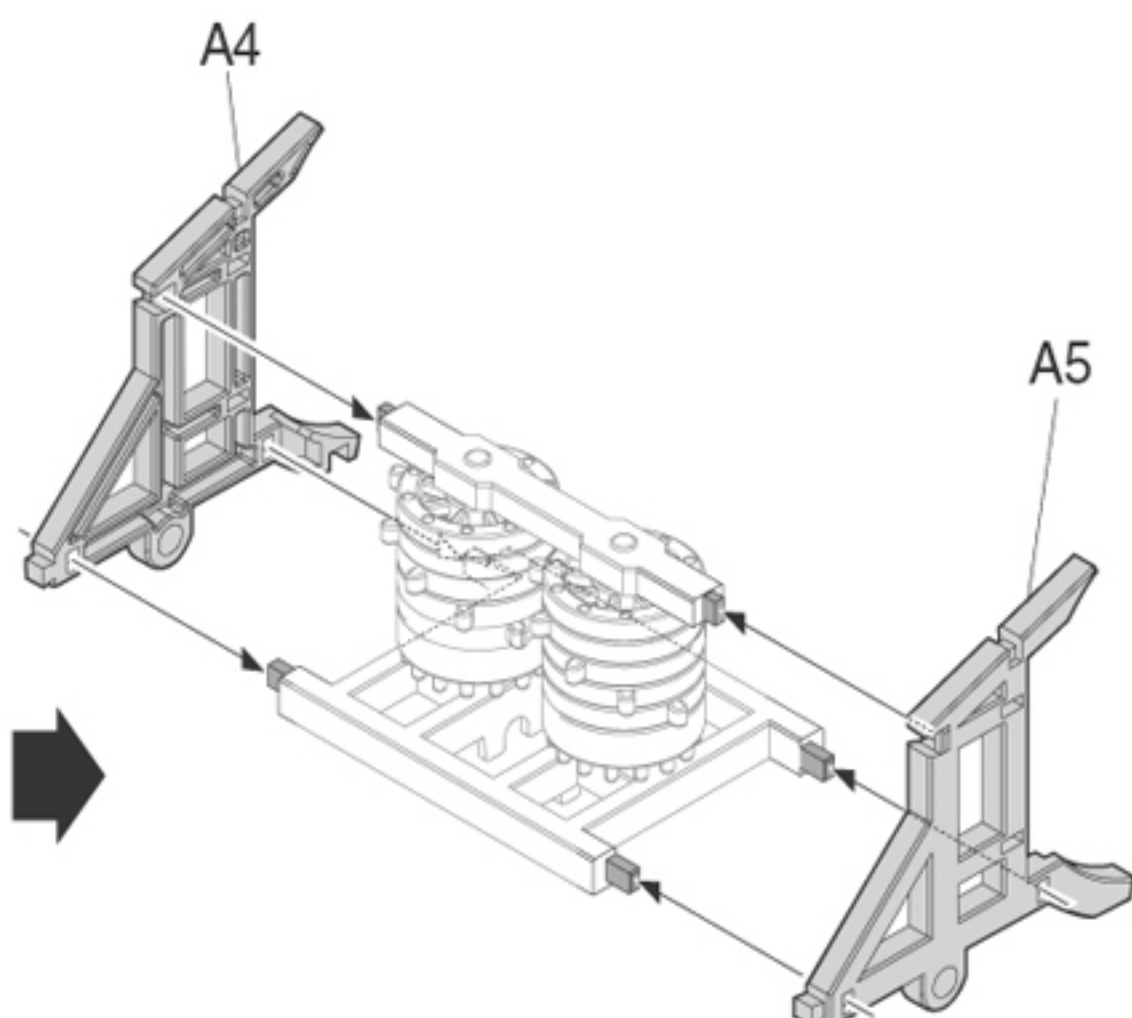
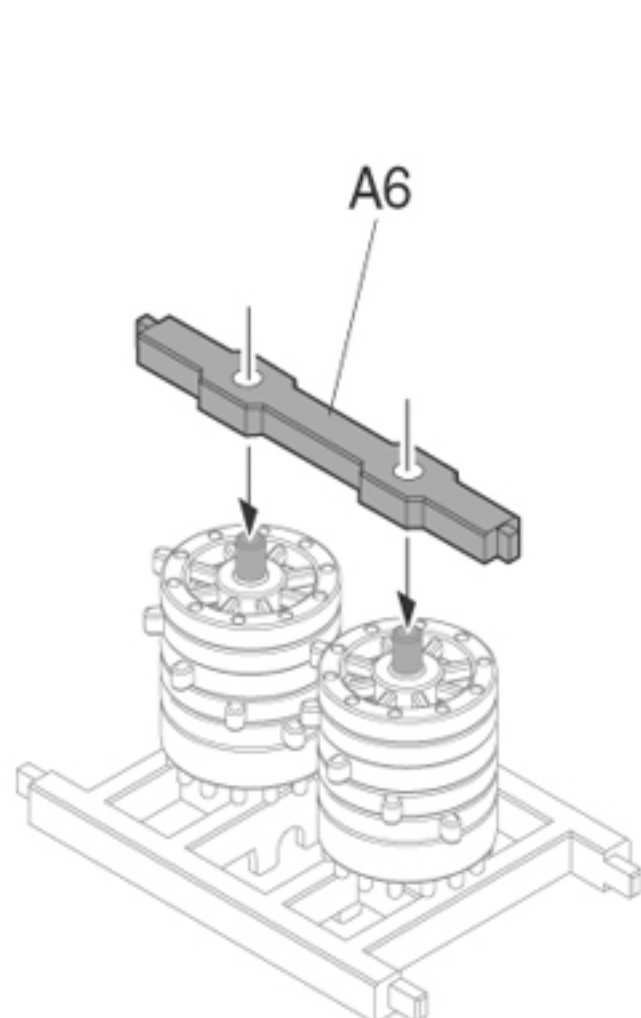
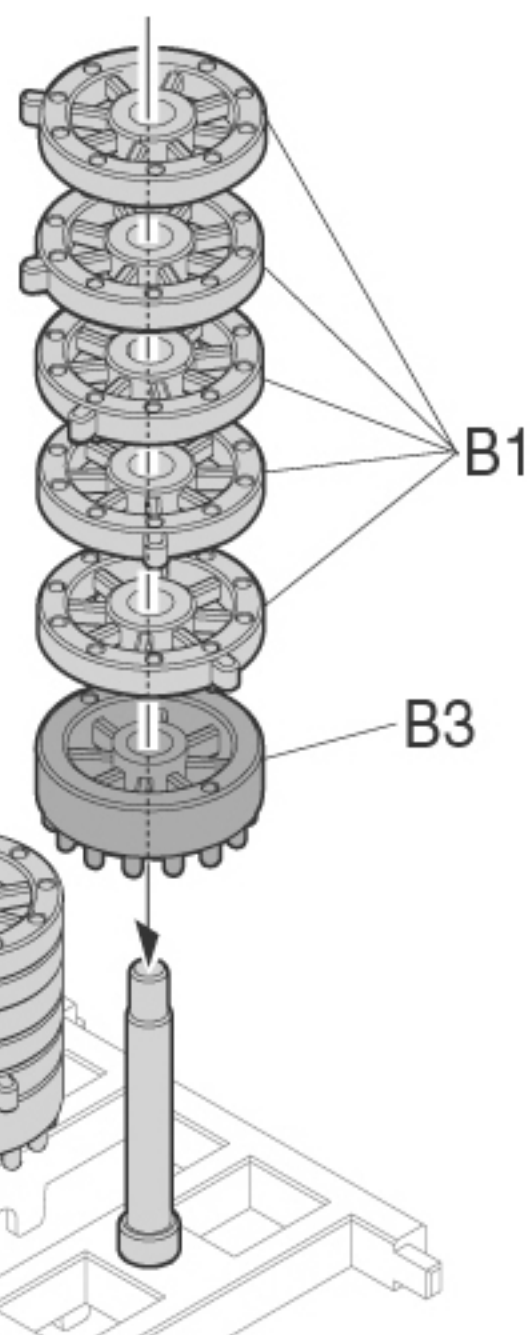

2

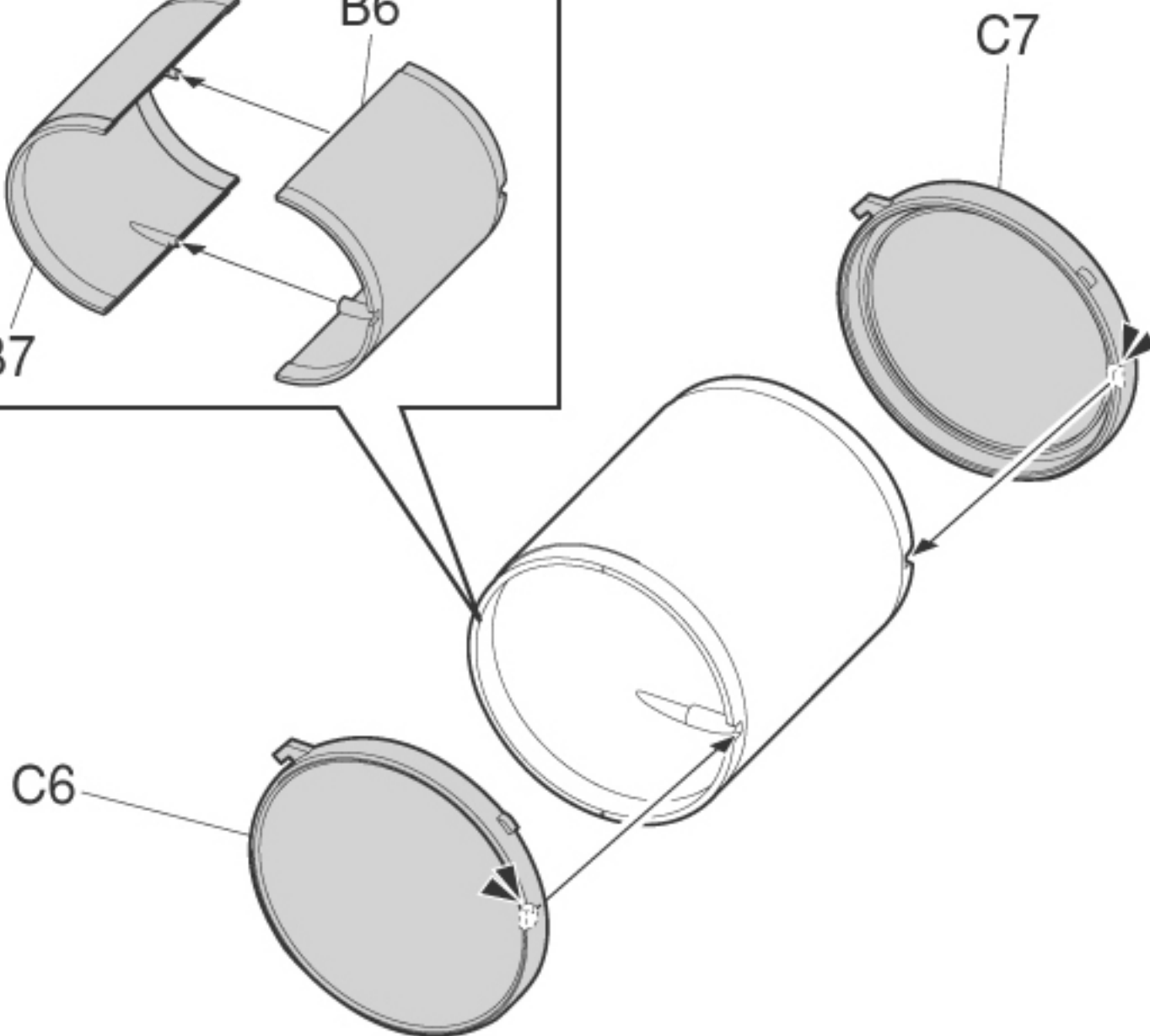
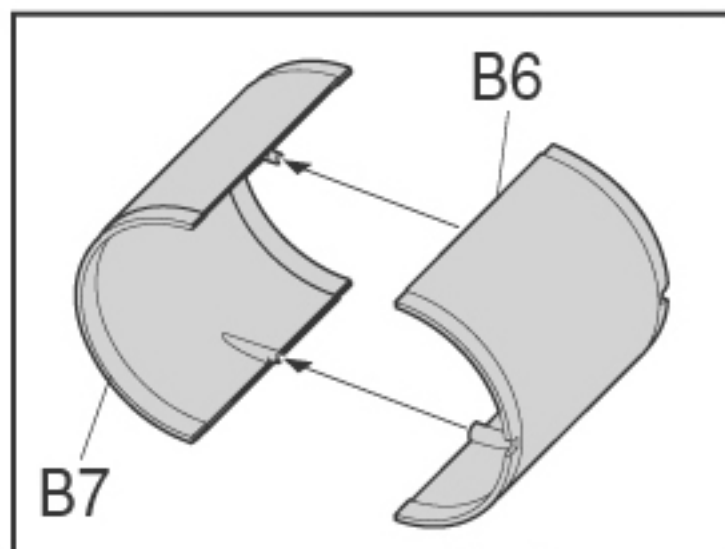

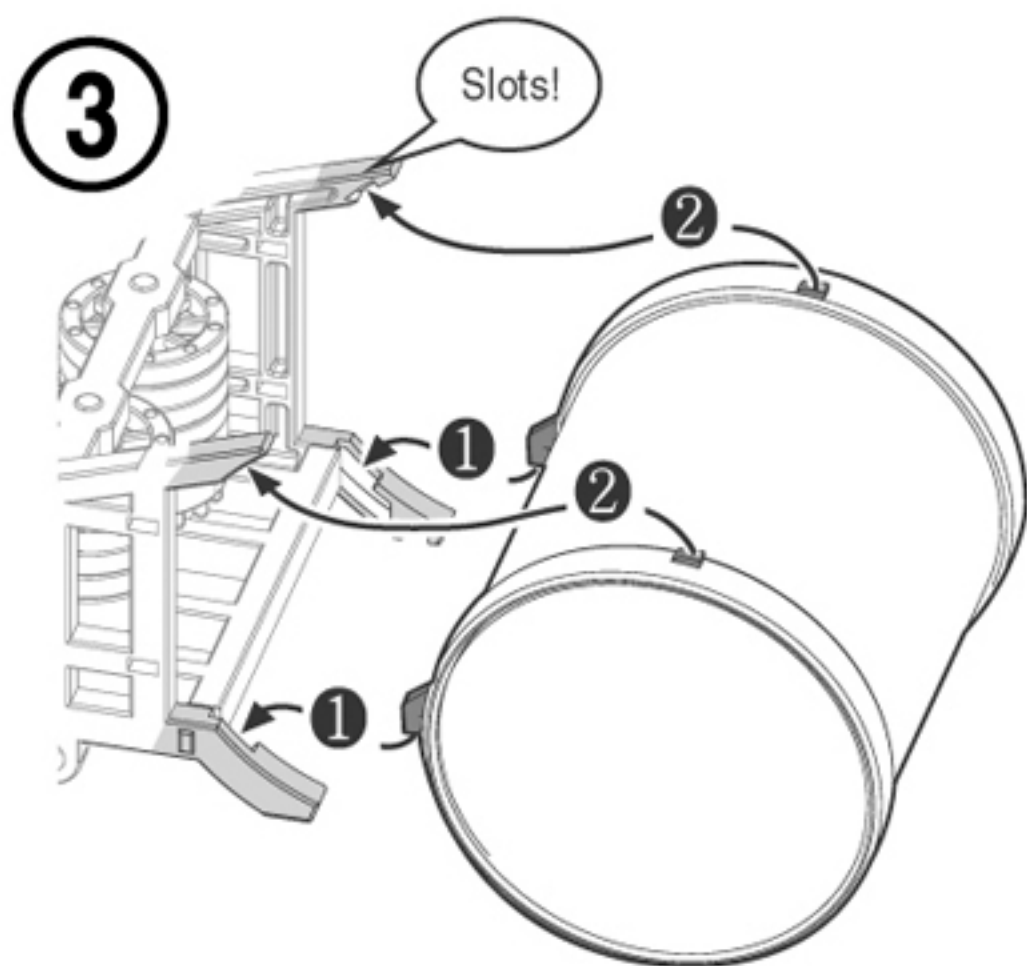

※ Strictly follow the assembly order - line up tabs and slots and carefully snap drum into place.

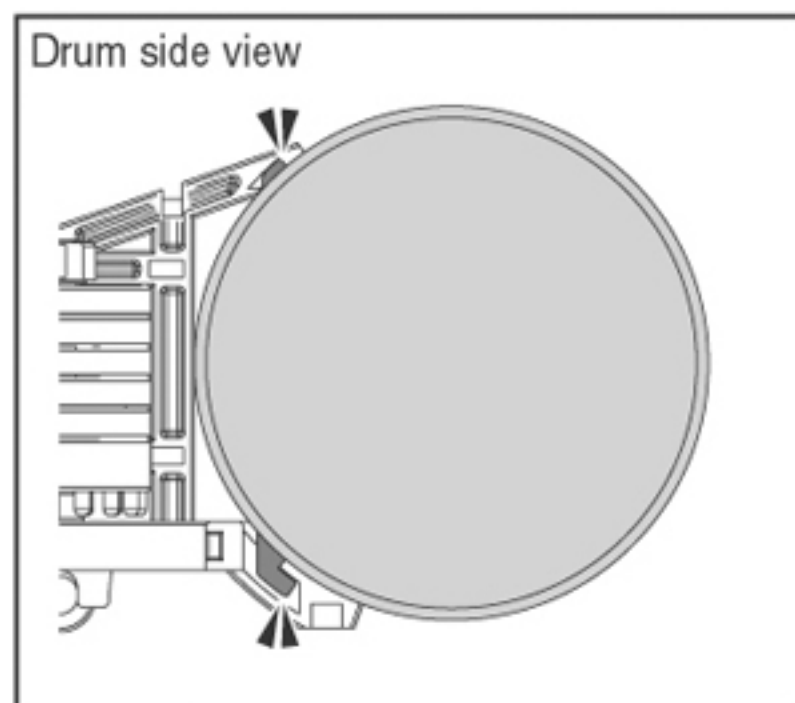

※ Strictly follow the assembly order as shown to assemble the drum.

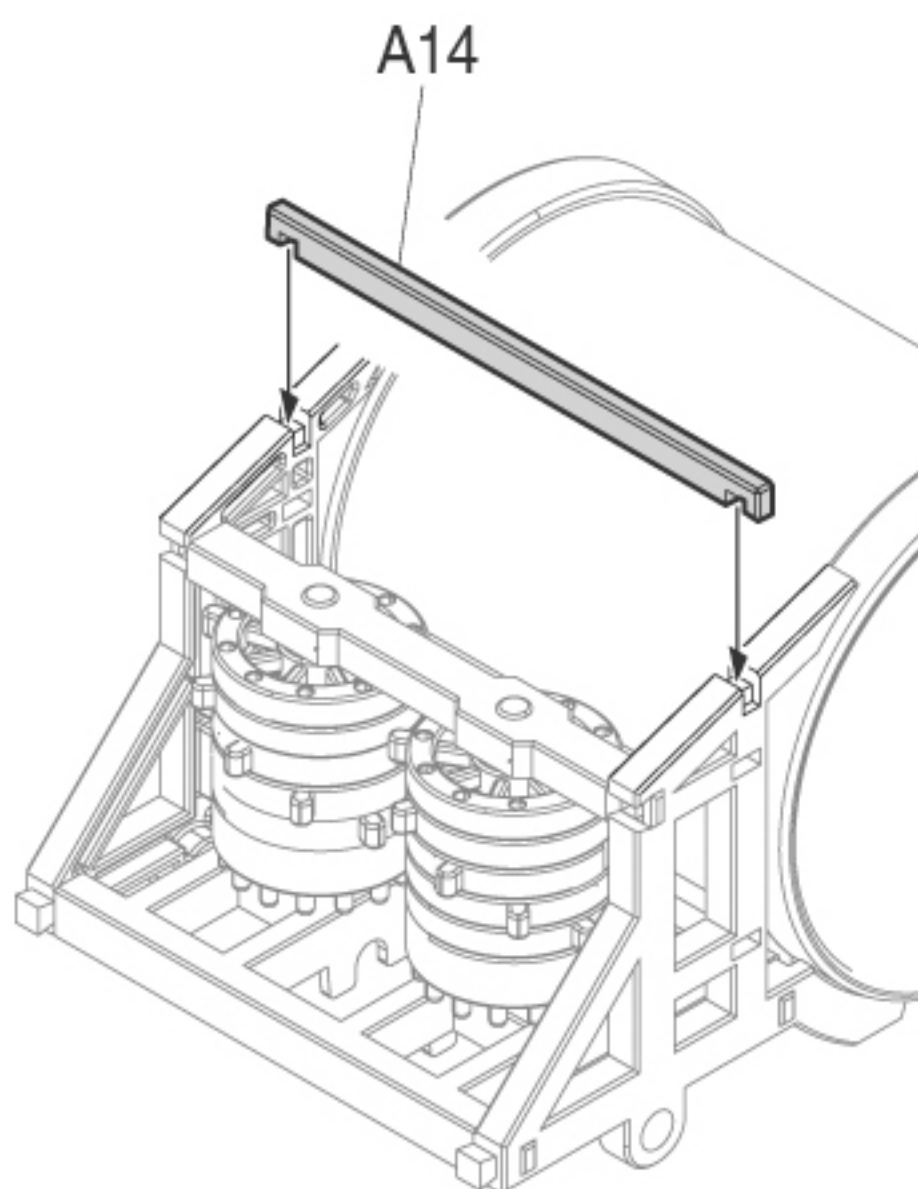

4

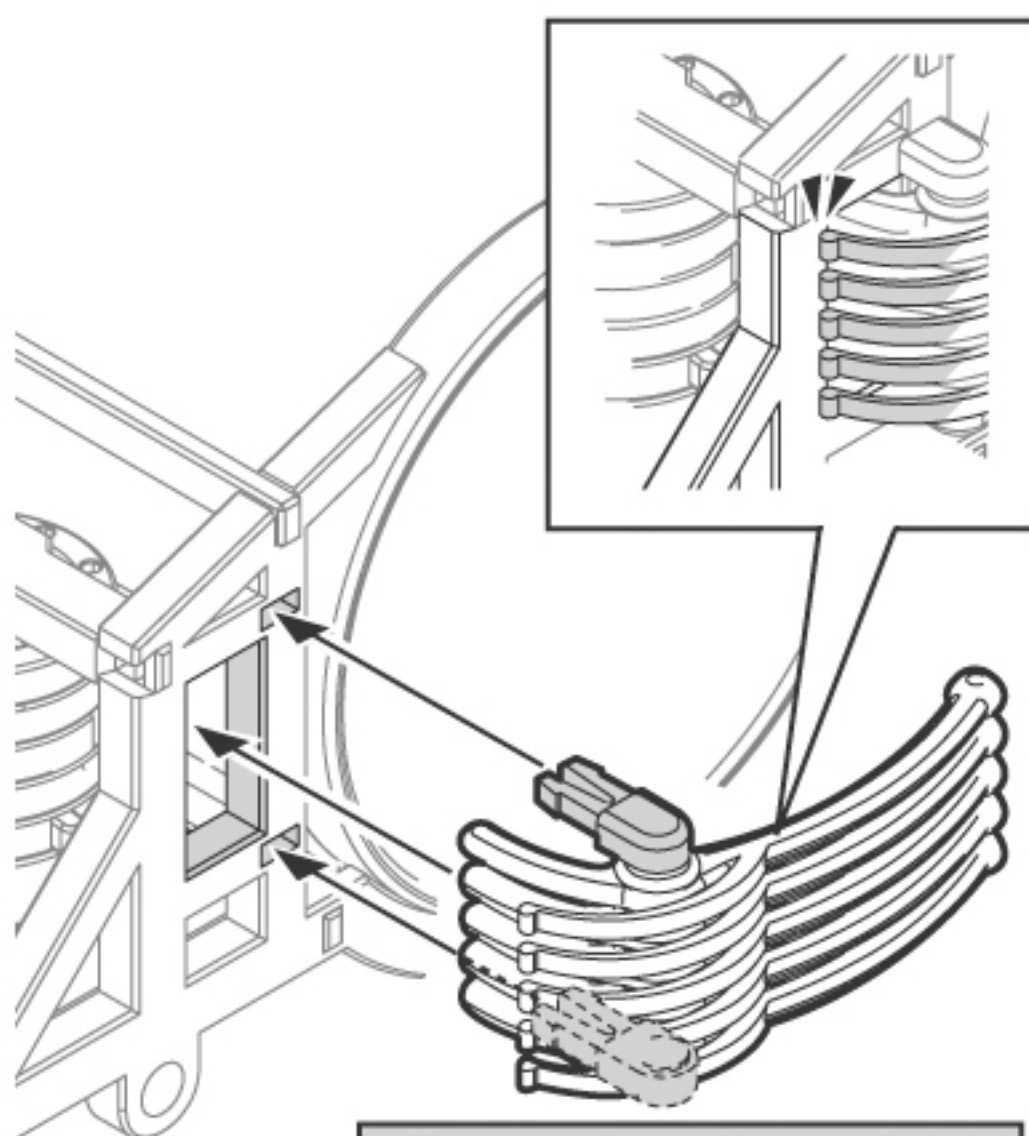
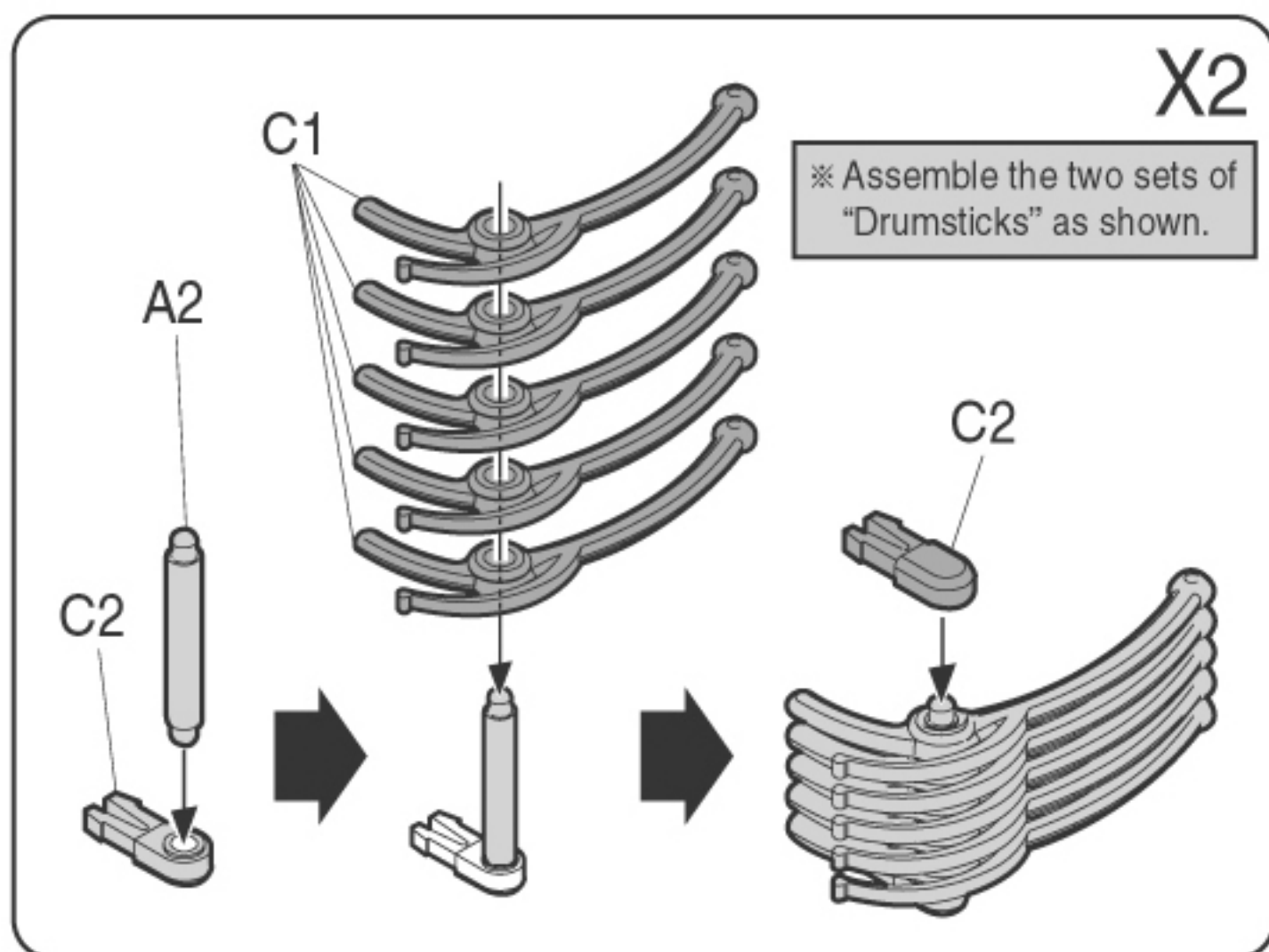

※ Line up and snap the completed Drumstick assembly into place. Repeat on opposite side of drum.

**5**

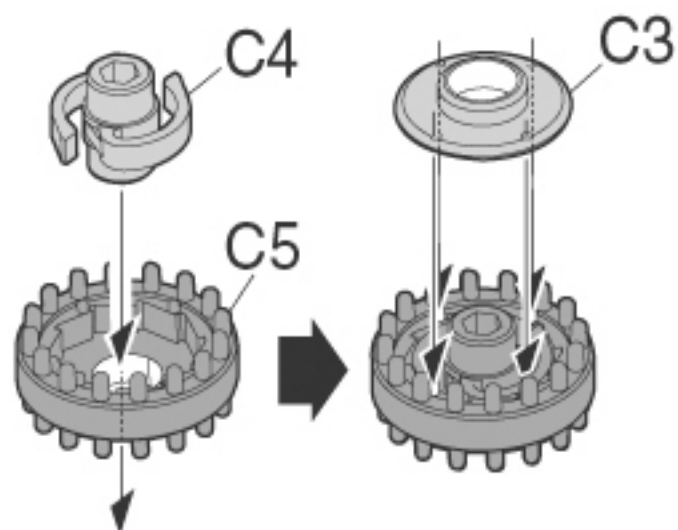

front view

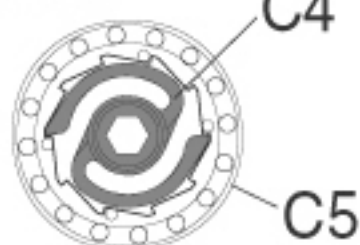

※ Item C4 is directional, Insert as shown in diagram, then line up holes in C3 and press fit.

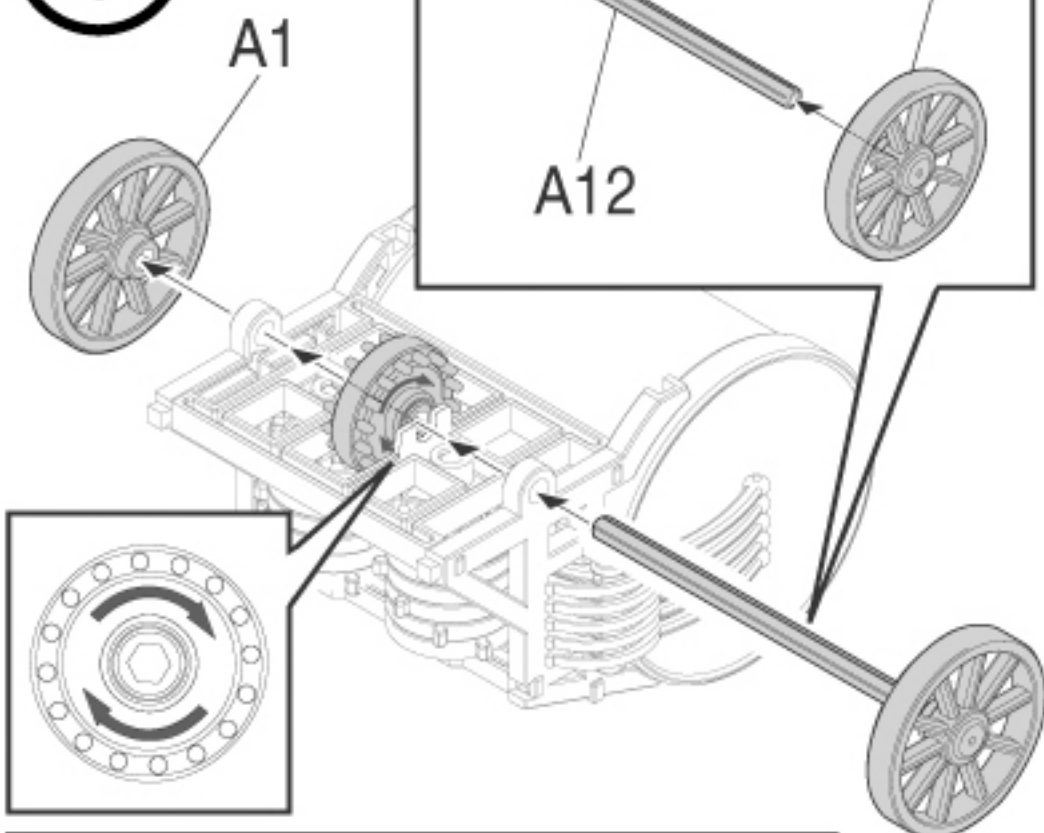

※ Item C5 is directional. Be sure to position it on the axle as shown.

**6**

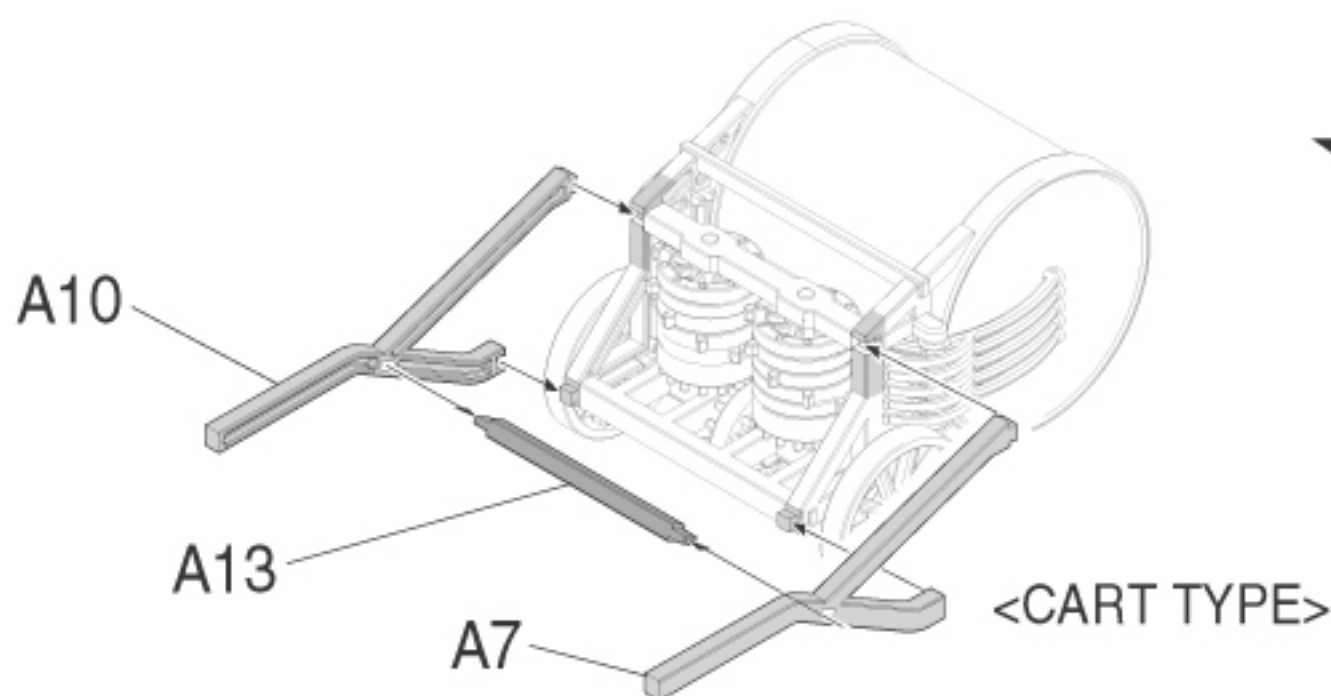

<CART TYPE>

※ Assemble the da Vinci Drum two different ways.

**7**

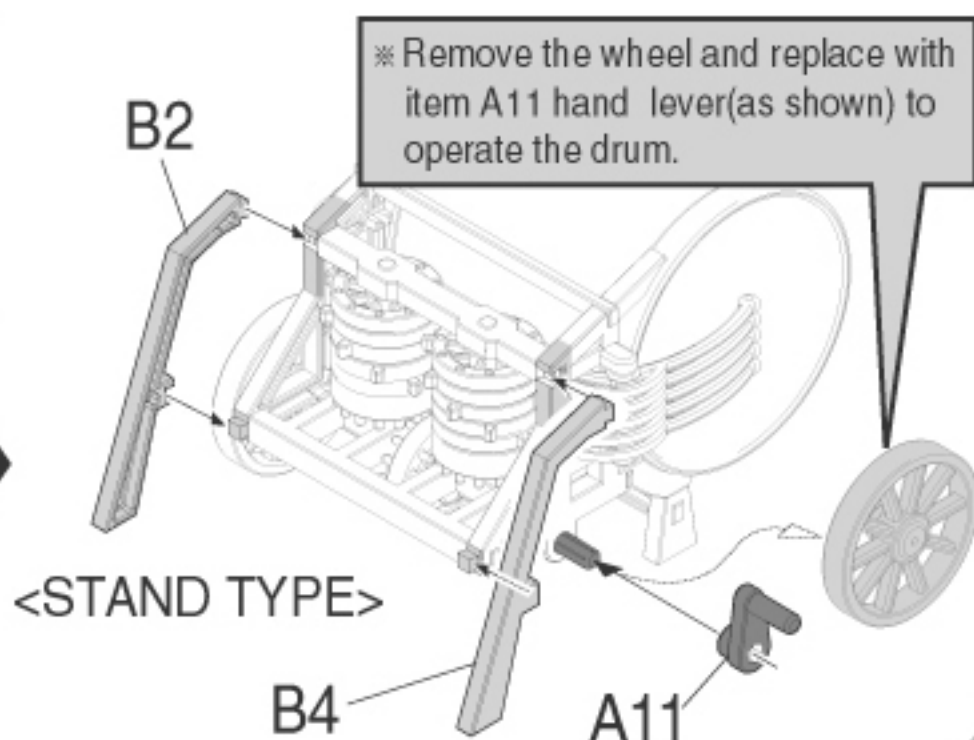
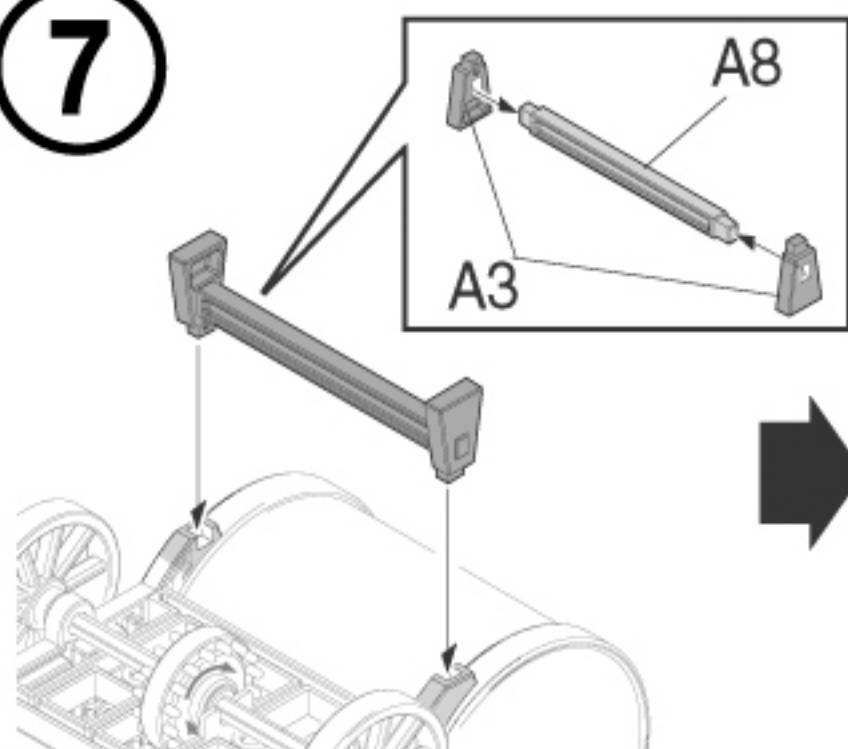

※ Remove the wheel and replace with item A11 hand lever(as shown) to operate the drum.

<STAND TYPE>

## ■ Finished Model Views

<CART TYPE>

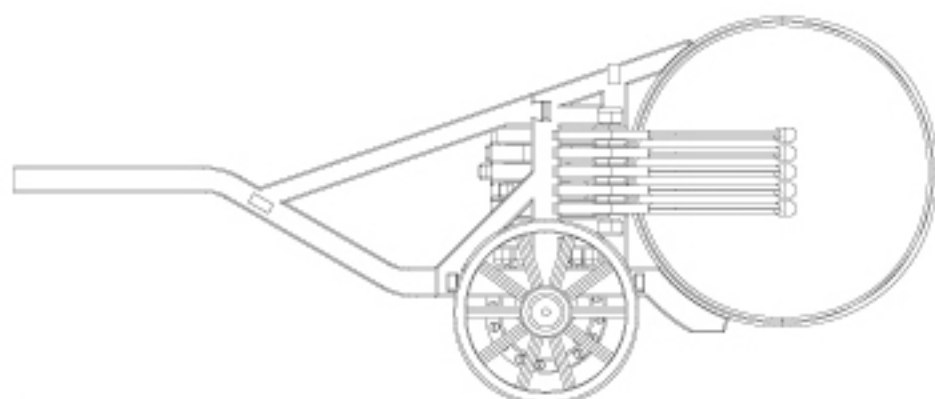

<STAND TYPE>

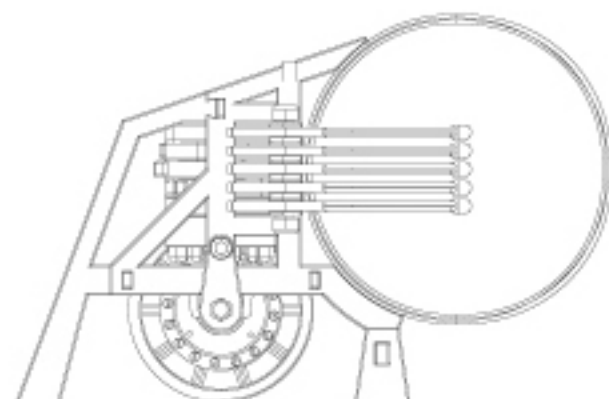

## ■ How to Operate

<CART TYPE>

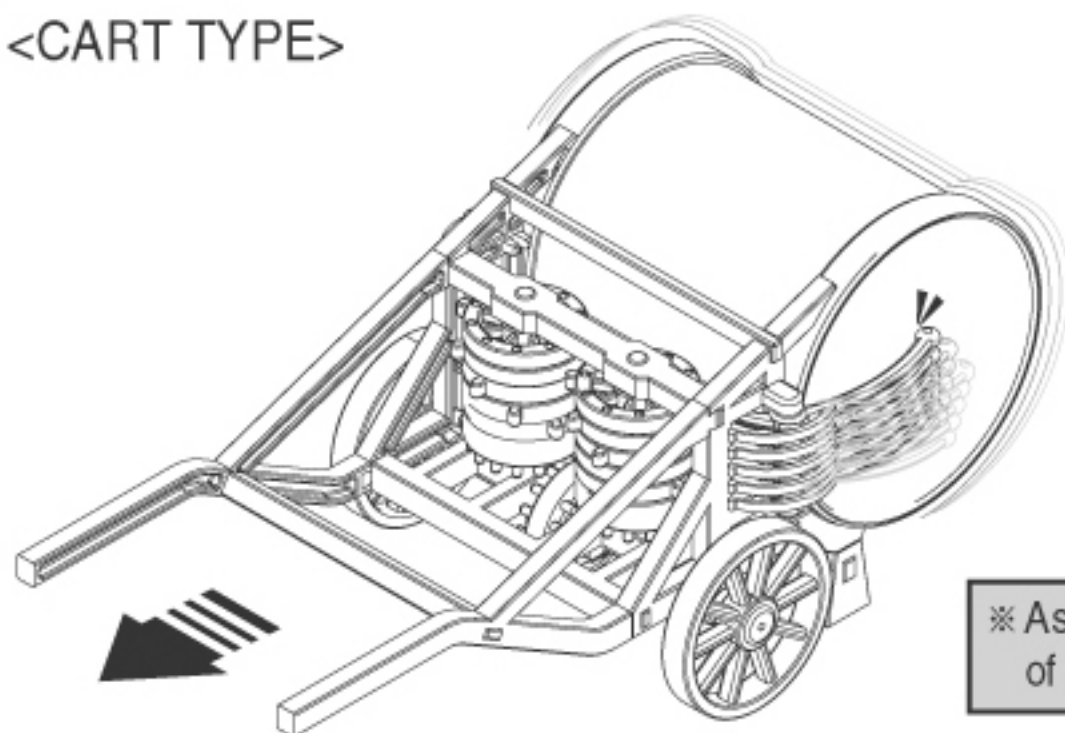

※ As shown, pull drum in the direction of the arrow to beat the drum.

<STAND TYPE>

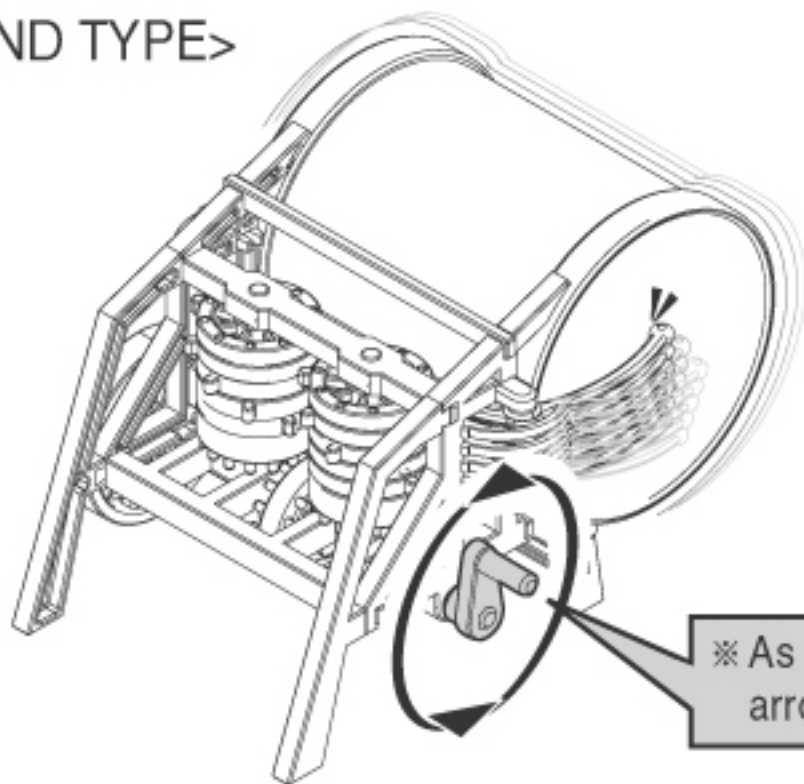

※ As shown, turn lever in the direction of the arrow(counter-clockwise) to beat the drum.