



## Pig, piglet & co.



There's always a lot going on at the farm. Cute little pigs are always around too! The small piglets are especially adorable. They also make lovely lucky charms for you to give away as presents.

Create your very own play toy farm with FIMO soft.



Get your free playtime pattern sheet at [www.staedtler.com/FIMO\\_soft\\_Kits\\_for\\_Kids\\_eng](http://www.staedtler.com/FIMO_soft_Kits_for_Kids_eng)

You can find our products in well-stocked sales outlets. Should you have any queries, please call our hotline: +49 (0)911 9365-888.

Have fun crafting!



### FIMO Shopping / material list



## The Pig

Space for your notes

---



---



---



---



#### You will need these STAEDTLER articles:

Product	Colour	Art.no.	Quantity	✓
FIMO soft	Flesh	8020-43	1	
FIMO soft	Chocolate	8020-75	1	
or Kits for Kids „FARM ANIMALS“	Set	8024 34	1	
or FIMO soft basic set	9 colours à 25 g	8023 10	1	
Modelling tools	--	8711	1	
Blades	--	8700 04	1	
Oven thermometer	--	8700 02	1	

Smooth work surface (glass or ceramic), toothpick



## Instructions: The pig



For the pig's body, shape a thick egg out of  $2\frac{3}{4}$  strips of flesh-coloured FIMO soft.



Make one half of the body pointed towards the end. Flatten the tip a little to form the snout.



For the legs, form an approx. 8 cm long sausage using the indicated quantity of FIMO soft. Divide it into four pieces of equal length. To give your pig a firm stand, you need to make the ends of the feet slightly thicker.

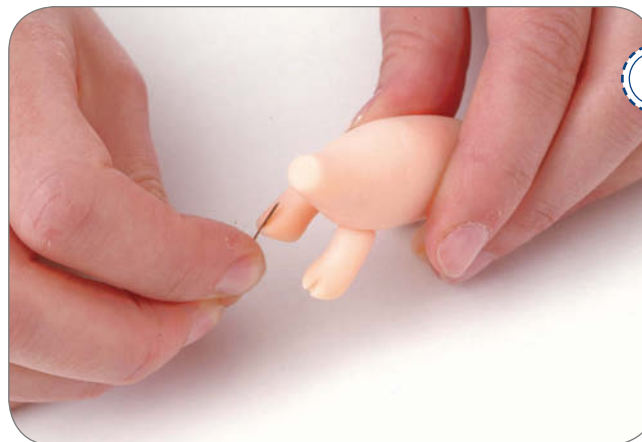

Position the four legs on the body and press on firmly. Make an indent for the toes.

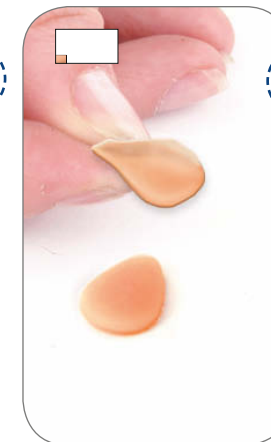

Cut a small ball in half, press the pieces flat and shape ears out of them. Then attach them firmly to the head.

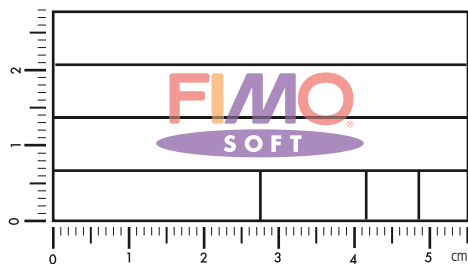

Thanks to the portioning aid, it's easy to cut your block of FIMO into the right portions.

## Instructions: The pig



Shape a thin tail out of a small piece of flesh-coloured FIMO soft and press it firmly onto the rear end of the pig.

You could also give your pig a few patches using a little brown.

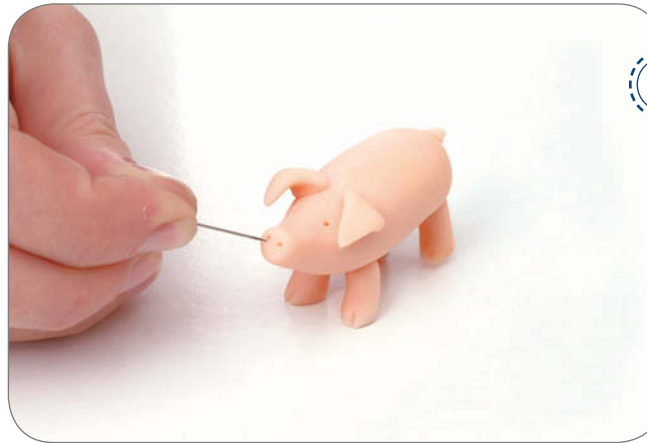

Finish off by carefully adding two nostrils and the eyes using a modelling stick or toothpick.

Next, the pig is hardened in the oven for 30 minutes at 110 °C before off to the farm it goes!



**Tip:** Interested in making more? Cats and dogs are to be found on farms too and, if you leave the horn off the unicorn, you can even turn your farm into a riding stables.