

**IMPORTANT! KEEP THIS MANUAL FOR FUTURE REFERENCE**

**INSTRUCTION MANUAL  
FOR USE OF CHILD RESTRAINT  
SYSTEM „4 MAX”**

**CAR SEAT  
4 MAX**

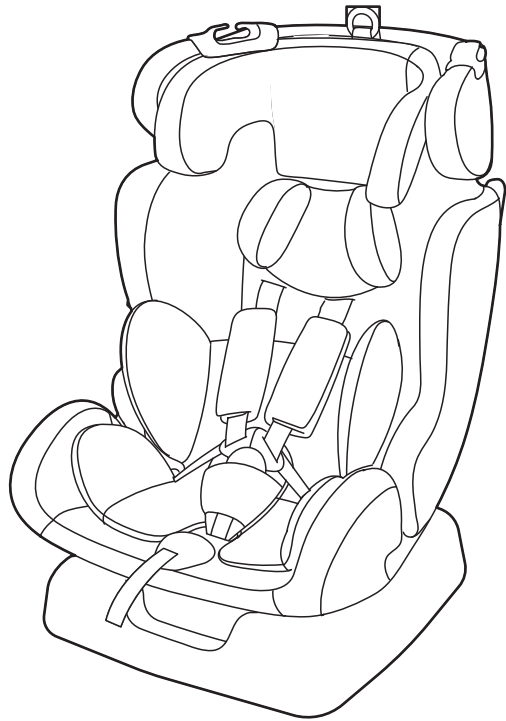

This child restraint system **chipolino** is designed and manufactured in compliance with the requirements of Regulation 44 of the United Nations Economic Commission for Europe concerning the safe transportation of children, the provisions of the product safety directive 2001/95/EU of the European Parliament and The Council and Directive 91/671/EEC "Compulsory use of seat belts and child restraints systems for child occupants of power driven vehicles" of the European Parliament and The Council.

## NOTICE

**GROUP 0+ (0-13 kg), GROUP I (9-18 kg), GROUP II (15-25kg) and GROUP III (22-36kg)**

1. This is a "UNIVERSAL" CHILD RESTRAINT. It is approved (№ E4-44R-044653), to Regulation No 44, 04 series of amendments, for general use in vehicles and it will fit most, but not all, car seats.
2. A correct fit is likely if the vehicle manufacturer has declared in the vehicle handbook that the vehicle is capable of accepting a "universal" child restraint for these age groups.
3. This child restraint has been classified as "universal" under more stringent conditions than those which applied to earlier designs which do not carry this notice.
4. If in doubt, consult either the child restraint manufacturer or the retailer.



**DO NOT FORGET THAT NO RESTRAINT SYSTEM CAN PROVIDE ABSOLUTE PROTECTION IN CASE OF A CRASH OR ROAD ACCIDENT! DRIVE WITH CARE WHEN THERE IS A CHILD IN YOUR VEHICLE!**

**IN ORDER TO ENSURE THE SAFETY OF YOUR CHILD, FOLLOW EXACTLY THE INSTRUCTIONS AND SAFETY RECOMMENDATIONS IN THIS MANUAL!**

**MISUSE OF THE CAR SEAT WILL CONTRIBUTE TO REDUCING ITS SECURITY AND SAFETY FEATURES! FAILURE OF THE GUIDELINES OF THIS INSTRUCTION INCREASES THE RISK OF SERIOUS INJURY OR DEATH!**

## PLACE OF THE CAR SEAT IN THE VEHICLE

THE CHILD RESTRAINT IS ONLY SUITABLE FOR USE IN VEHICLES, EQUIPPED WITH APPROVED LAP / 3-POINT/STATIC/WITH RETRACTOR SAFETY BELTS IN COMPLIANCE WITH ECE R16.

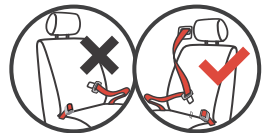

Do not place the restraint system "REARWARD FACING" on a seat equipped with air bag! This may result in death or serious injury! Review the instructions of the car seat for information about airbags and conditions of transportation of children.

Install only on FORWARD FACING vehicle seats!  
Do not place car seat on vehicle seats facing to the sides or rearward!

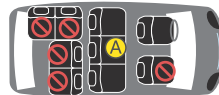

Do not use!

A To be used only 3-point diagonal/lap belt!

- **CAUTION! NEVER LEAVE YOUR CHILD UNATTENDED!**
- **CAUTION! THE CAR SEAT MUST BE INSTALLED ONLY ACCORDING TO THE DESCRIBED INSTRUCTIONS IN THIS MANUAL. IT IS DANGEROUS TO USE ANCHOR POINTS OTHER THAN THE ONES GIVEN IN THIS MANUAL!**
- **CAUTION! THE CAR SEAT SEAT SAFETY HARNESS (for groups 0+ and I) AND VEHICLE BELTS (for group II) MUST BE PROPERLY ADJUSTED ACCORDING TO CHILD'S HEIGHT, NOT TWISTED AND SNUG WELL AGAINST BABY'S BODY.**
- **CAUTION! THIS CHILD RESTRAINT SHOULD NOT BE MODIFIED OR ADAPTED WITH NEW FITTINGS, WITHOUT PREVIOUS AUTHORIZATION BY THE COMPETENT AUTHORITY.**
- **CAUTION! KEEP AWAY FROM FIRE!**
- Installation in the vehicle and securing the child in the car seat to be done only by adult!
- The hard parts and the parts of the child restraint made of plastic should be located and installed so that when the vehicle is in normal use, they can not be trapped by a sliding seat or in a door of the vehicle.
- The vehicle 3-point belt must be well tightened and fastened, not pinched in the door, twisted on the seat or other part of the vehicle, or to rub against sharp edges or parts.
- Do not allow the safety belts of the car seat and the vehicle to be twisted, frayed or torn, latches and locks (buckles) must be always in good order and firmly fixed.
- If you find uncertainty or defect in the construction, latches, straps or locking mechanisms of the car seat, discontinue usage until removal of the damaged parts and replacement with new ones.
- After a violent impact the car seat and belts may be damaged. therefore, it is recommended to replace the car seat with new one.
- Never use a second hand child restraint, it may have suffered structural damage, which may make the child restraint extremely dangerous.
- Do not use this car seat without its seat cover and do not replace it with a new one, unless supplied by the manufacturer. The fabric parts are integral parts of the restraint system and its safety features!
- Always make sure that you are not carrying any unsecured objects, especially on the back shelf, which, in case of an accident, may injure the car's occupants.
- Do not put additional pads except the ones supplied from the manufacturer! Placing additional pads may obscure the safety of your child.
- Do not use spare parts and other components not supplied by the manufacturer. The manufacturer assumes no responsibility for safety in the event that are used spare parts other than original.
- It is recommended to cover the car seat if the vehicle is parked under strong sun shine – extreme sun exposure will make the plastic to deteriorate and the fabric to fade. Please, check that the child restraint has not become too hot before placing your child seat.
- The car seat does not replace the child's cot or bed. When a child needs a sleep, you have to place him in a suitable baby stroller, baby crib or bed.
- Do not attach objects with long cords or strings on the car seat in order to avoid danger of suffocation!
- Never place a child seat on beds, couches or similar soft surfaces!
- Do not allow children to play with the product!
- Do not remove stickers and warnings – they contain important information!
- The packaging of the product must be kept out of the reach of children at the time of and after unpacking in order to avoid the risk of strangulation!

## PRODUCT FEATURES

- Child restraint while traveling in a vehicle designed for children weighing from 0 to 25 kg, groups 0+ (0-13 kg), I (9-18 kg), II (15-25 kg) and III (22-36 kg);
- For Group 0+ (0-13 kg) install the car seat in reward facing position, the car seat "facing backward";
- For groups I (9-18 kg), II (15-25 kg) and III (22-36 kg) install the car seat in forward facing position, the car seat "facing forward";
- 5-point safety belt on the car seat.
- The backrest can be adjust in 4 positions;
- Head rest height adjustment;
- Safety harness height adjustment.

## MAIN PARTS DIAGRAM

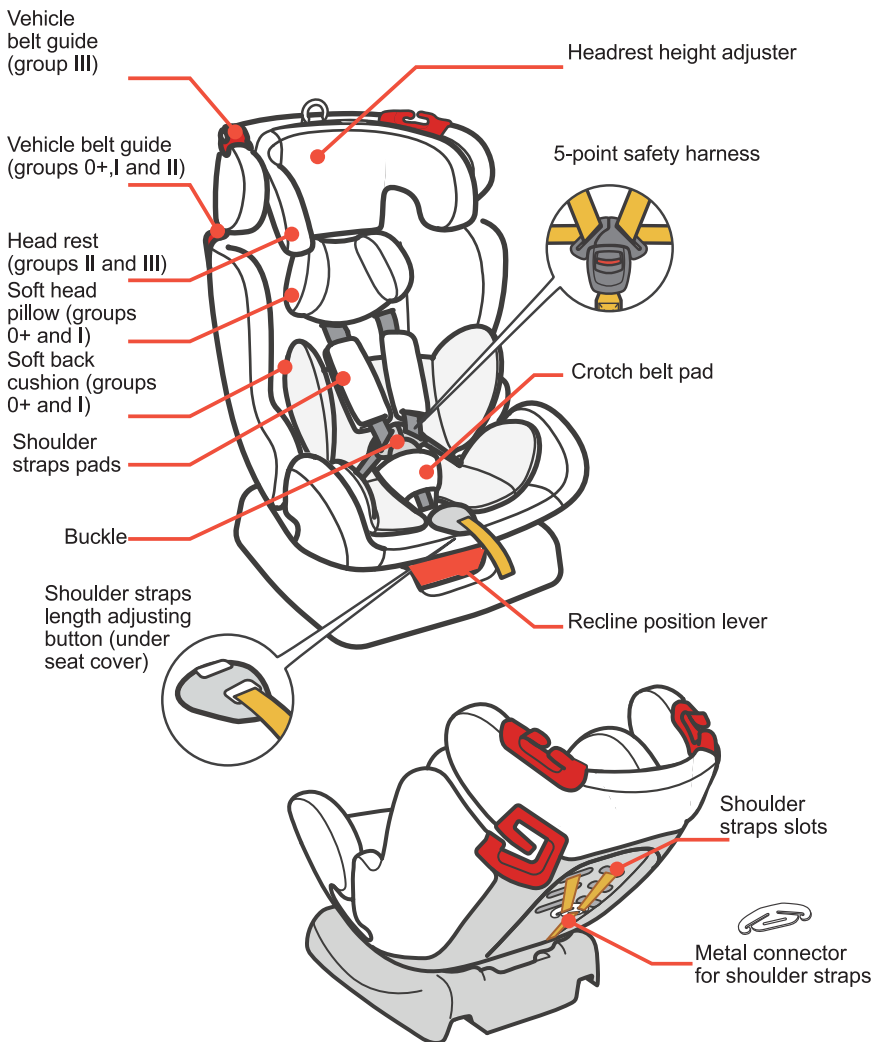

## INSTRUCTION FOR USE

### IMPORTANT!

- Follow exactly the instructions and safety recommendations in this manual.
- Check the security of fixing after each operation!
- ALWAYS CHECK THE SECURITY OF FIXING OF THE SAFETY BELTS!

1 – BACKREST RECLINE ADJUSTING  
2 – HEAD REST

### 3 – SAFETY BELT BUCKLE

### 4 – HEIGHT OF SHOULDER STRAPS

**IMPORTANT:** Shoulder straps must be at the level of the child's shoulders.

### 5 – LOOSENING AND TIGHTENING THE HARNESS

### 6 – REMOVAL OF SAFETY HARNESS

### 7 – ASSEMBLY OF SAFETY HARNESS

### 8 – INSTALLATION FOR GROUP 0+ (0-13 kg)

**CAUTION!** Place the car seat in a position facing "FACING BACKWARD"!

**CAUTION!** Set the backrest of the car seat in position with suitable recline position (fig.1). Overly upright position may impede breathing.

### 9 - INSTALLATION FOR GROUP I (9-18 kg)

**CAUTION!** Place the car seat in a position facing "FACING FORWARD"!. Secure the 5-point safety harness.

### 10 - INSTALLATION FOR GROUPS II (15-25kg) and GROUPS III (22-36kg)

**CAUTION!** Place the car seat in a position facing "FACING FORWARD"!. Secure the child with the 3-point vehicle belt.

**IMPORTANT!** When using the car seat for children with weight 15 - 36 kg (groups II and III), remove the safety 5-point harness following the instructions in fig. 6.

### 11 – REMOVAL OF THE FABRIC COVER

Remove the belts following the instructions in fig. 6 and remove the fabric cover.

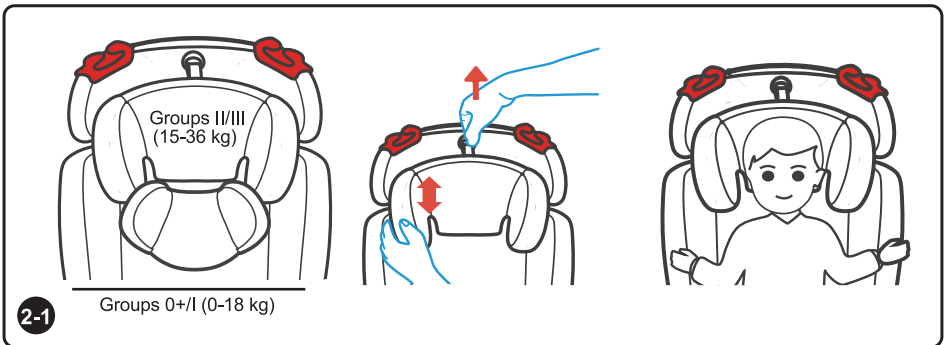
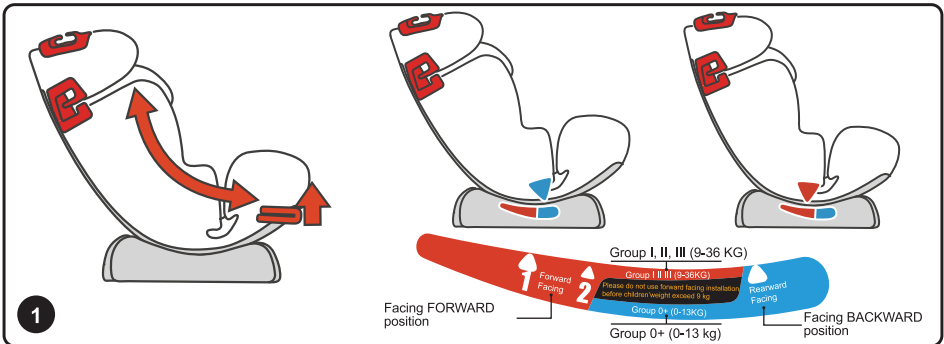

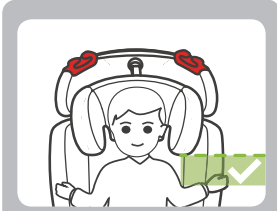

Correct position

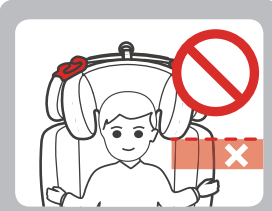

Too high

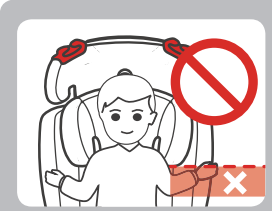

Too low

2-2

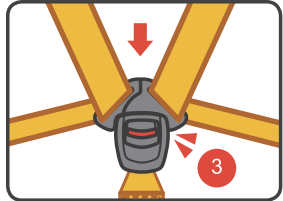
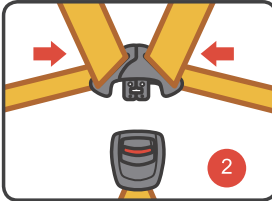
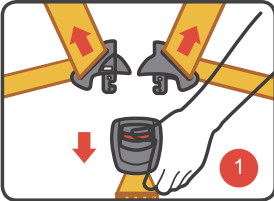

3

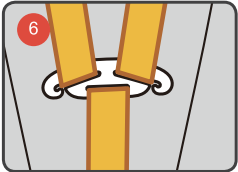
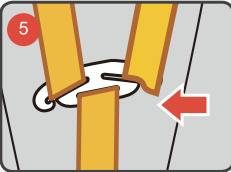
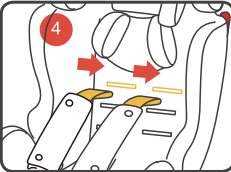
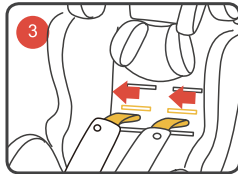
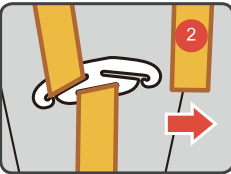
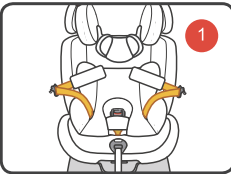

4

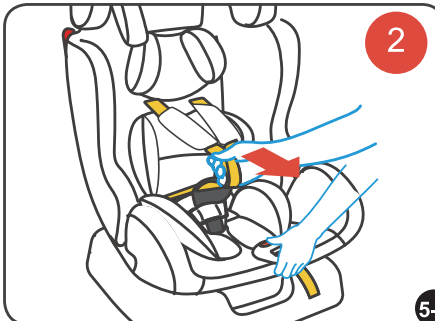
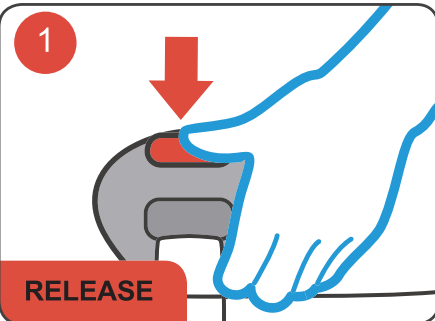

5-1

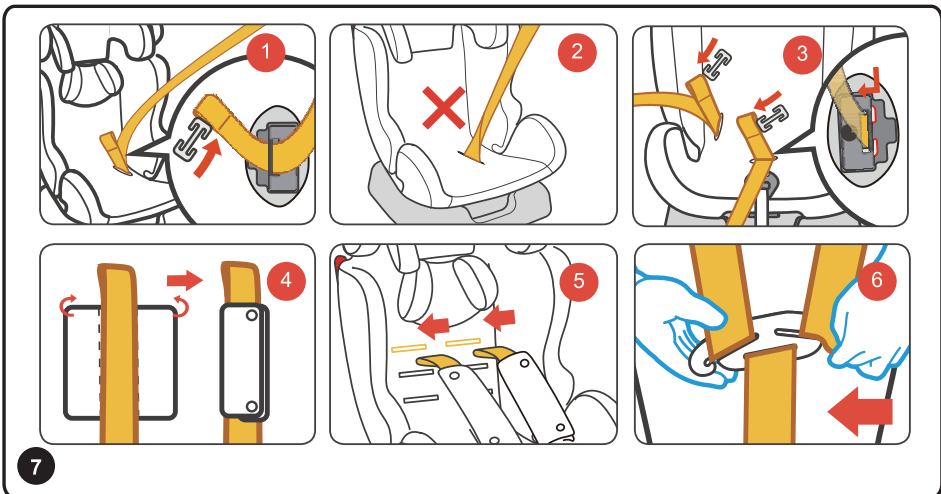
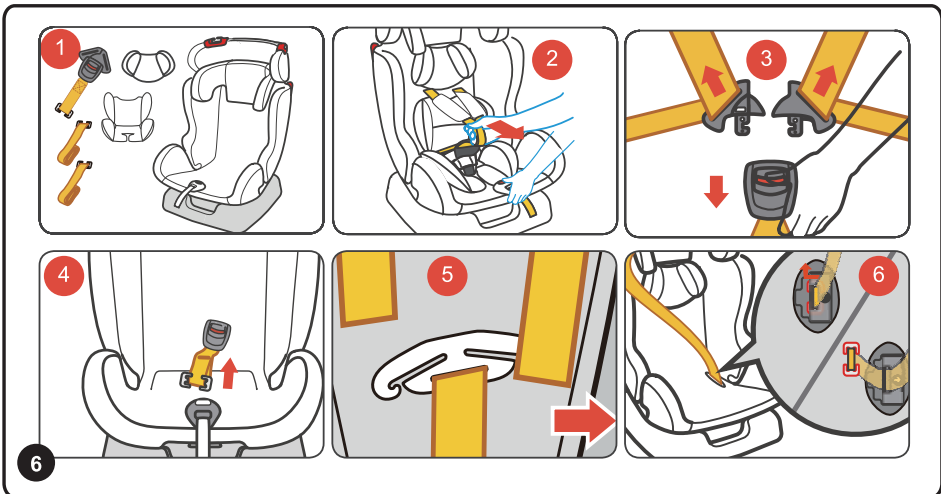
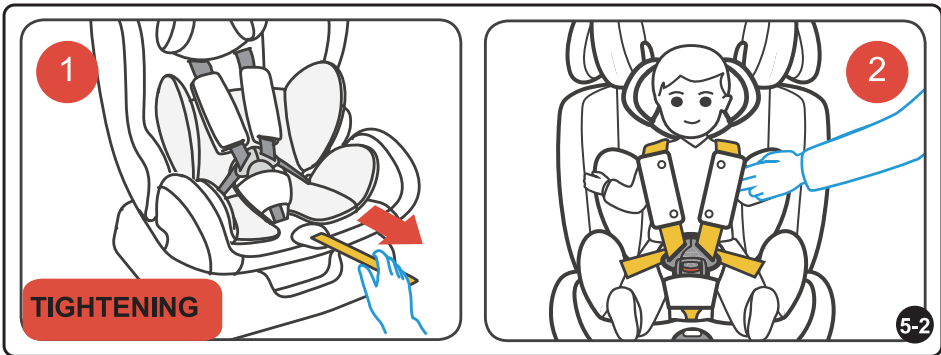

GROUP 0+ (0-13 kg)

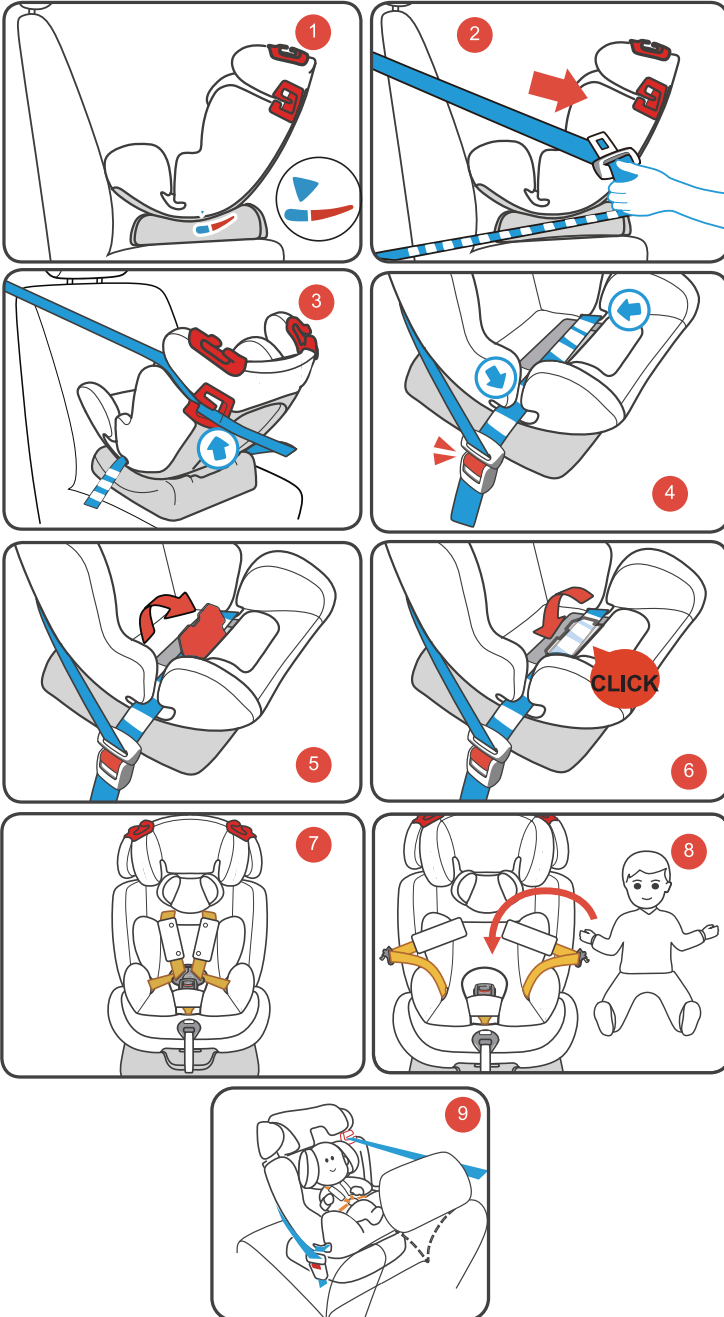



**GROUP I (9 -18 kg)**

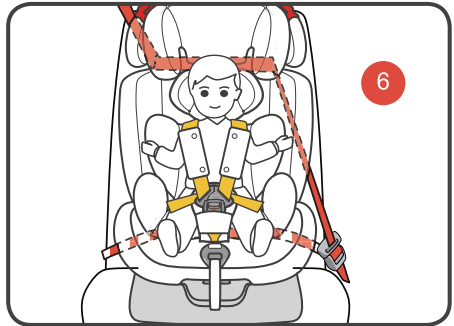
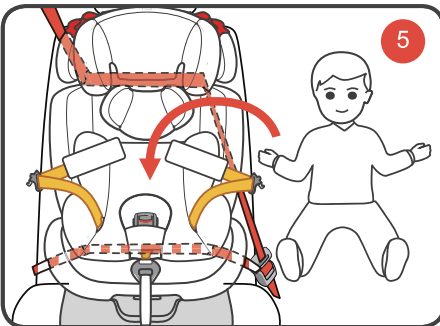
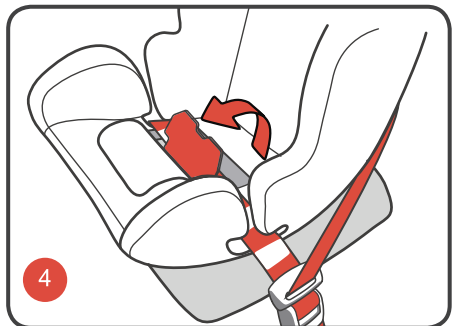
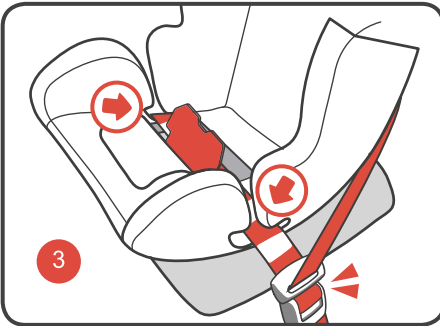
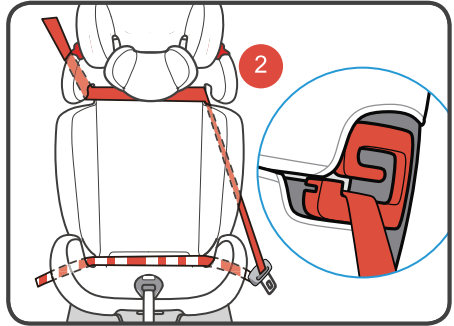
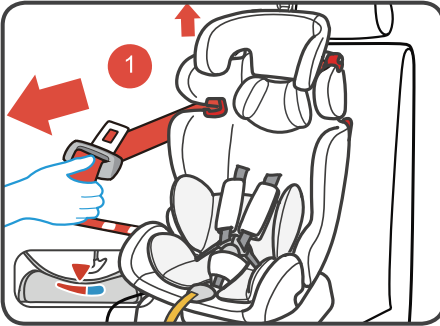

**GROUP II (15-25 kg) and GROUP III (22-36 kg)**

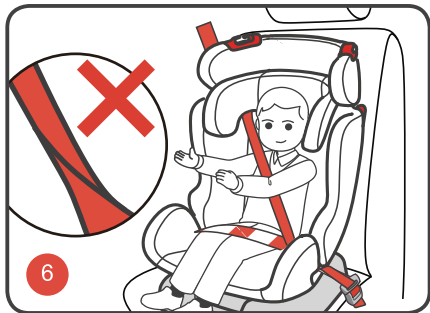
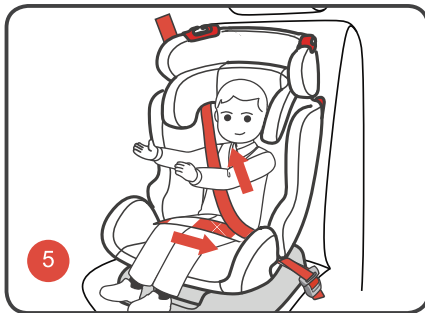
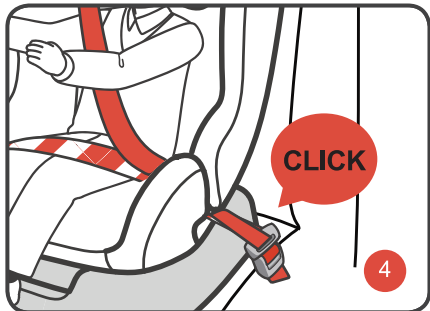
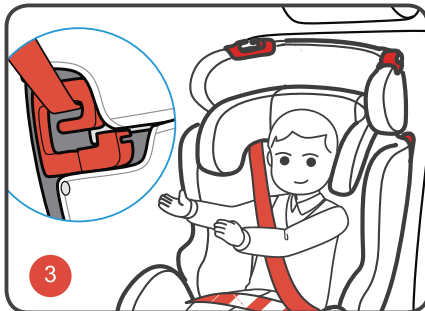
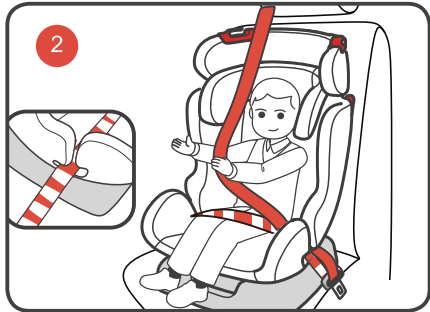
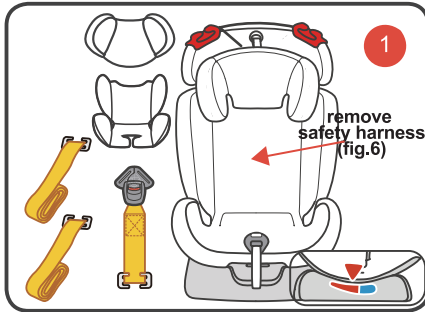

## CLEANING AND MAINTENANCE INSTRUCTIONS

- Clean the fabrics, plastic parts and metal parts with damp cotton cloth or sponge and mild soap.
- Upholstery may be hand washed at 30°C using mild detergent!
- Do not bleach! Do not tumble dry! Do not machine wash! Do not iron!
- Do not use abrasive, bleach or other aggressive detergents.
- Always after cleaning leave the car seat fully dry and after that use it or store it.
- Harnesses must be cleaned with damp cloth and mild soap!
- Do not wet or remove the stickers. They contain important information!
- Always store your car seat indoors – on dry and clean place. Do not expose to direct environment influence - sun, rain, moisture and high temperature intervals.
- Please, contact your authorized dealer for problems connected with the use or repair

**Fabric:**

**Outer:** 100% polyester

**Filling:** 100% polyester



**Used materials:** plastic, metal, textile.



Bulgaria, Plovdiv, Str. Golyamokonarsko shosse № 1  
[www.chipolino.com](http://www.chipolino.com)